



3340 Peachtree Road
Northeast



Space availability summary

WeWork @ 3340 Peachtree Road Northeast
Atlanta, GA

wework

[VIEW VIRTUAL TOUR](#)

2nd Floor 43,301 RSF

1st Floor 41,295 RSF

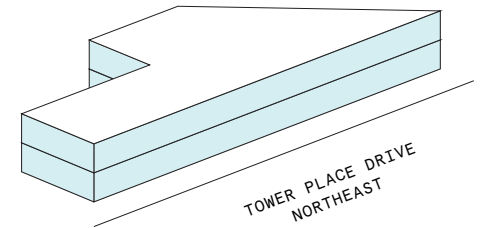
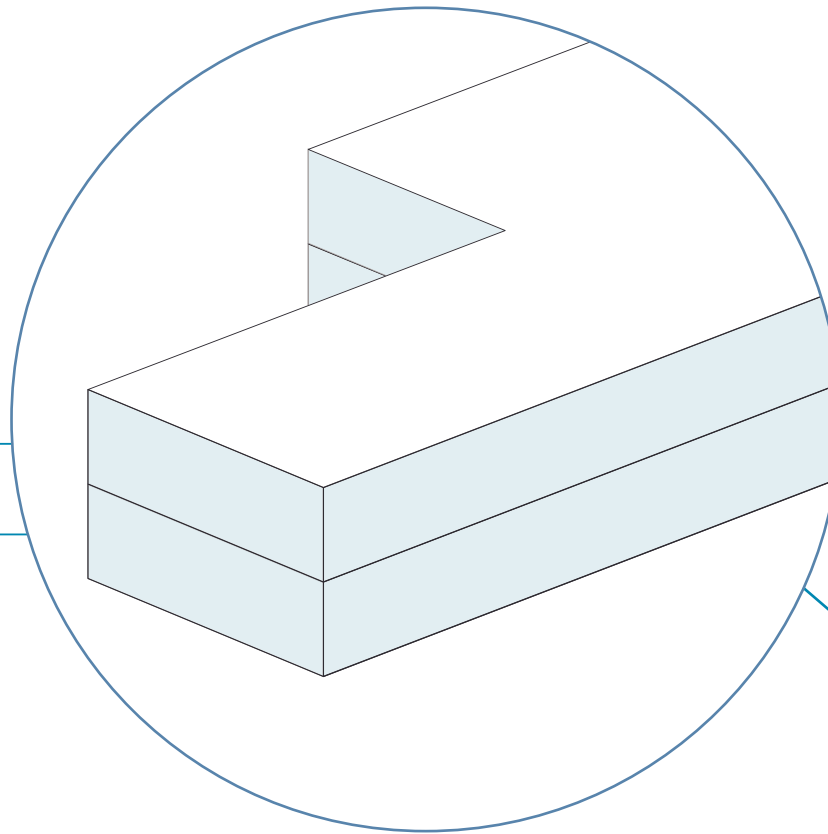

84,596 RSF

TOTAL WEWORK RSF

Tower Place 100

At a glance

Workspaces designed for productivity and creativity with flexible size & term

Dedicated, private offices available from 56 to 10,639 RSF

Move-in ready offices furnished & wired

2

TOTAL BUILDING FLOORS

30,433

TOTAL BUILDING SQ FT

All dimensions are approximate and subject to variances. It is your obligation to independently verify the particulars of the property. WeWork reserves the right to make changes.

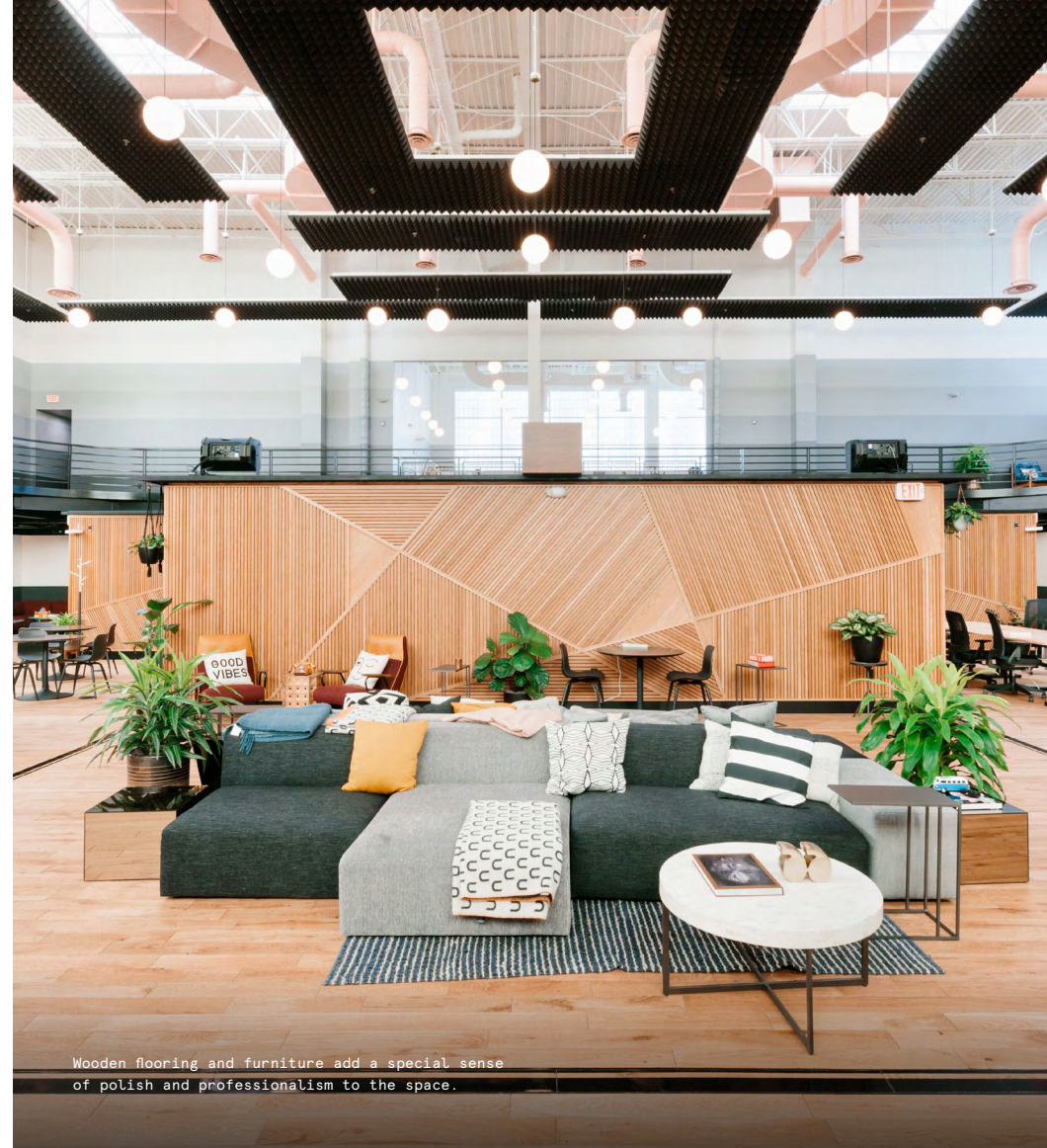

A modern and urban workspace in Buckhead

Located in the uptown part of Buckhead, a major commercial and financial hub that is a part of the greater Atlanta area, Tower Place 100 is a modern and chic workplace that allows members ease of access to an elegantly designed workspace in a highly desirable area.

Members will not only have access to the building's amenities, such as an outdoor bike rack, wellness room, and dog-friendly spaces, but they are also only a stone's throw away from a variety of condos, hotels, and other exciting attractions in the area.



A neutral and calming color palette dominates the design scheme of the workspace.



Much of the furniture within the space has been carefully curated by the WeWork team.

Modern, elegant, and thoughtfully designed

Tower Place 100 is a welcoming and inviting workspace that reflects the friendly spirit of the Buckhead area. The existing shell of the building, including its more industrial sections, has been blended with warm finishes and occasional pops of color to create a welcoming experience for all members.

- Natural wood is one of the design elements featured prominently throughout the space
- A large wood-covered event space allows members to host functions as needed
- All of the artwork is custom created in-house by the WeWork Arts and Graphics Team

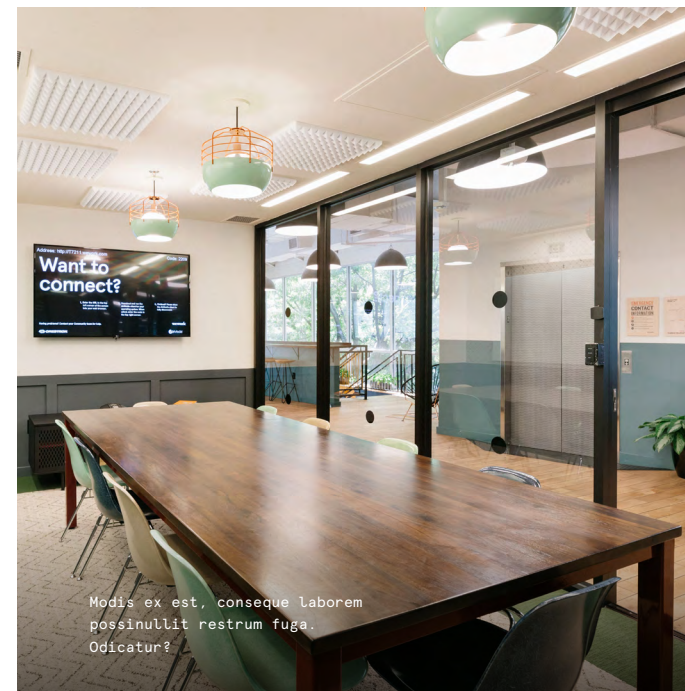
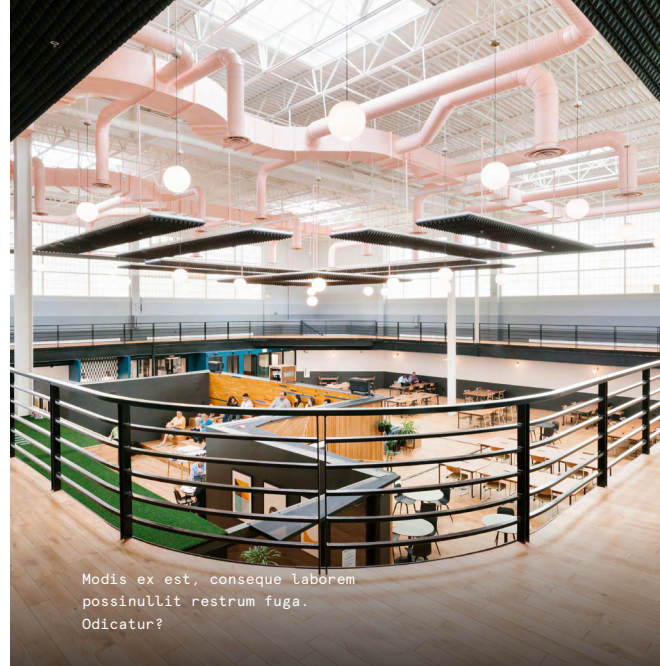

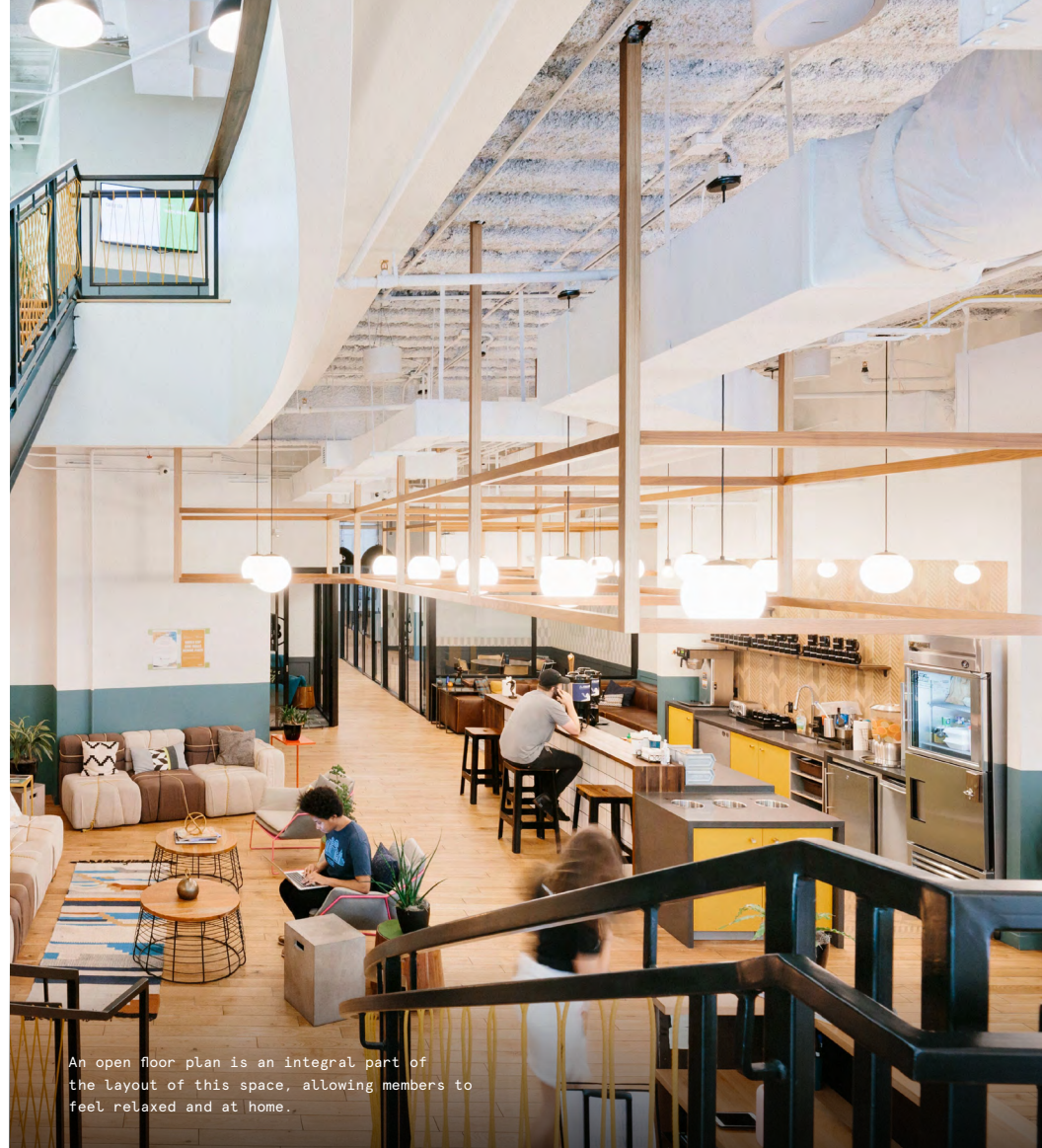

On-site amenities

- Electronic keycard access
- Stocked pantry
- US mail drop
- On-site staff
- Meeting rooms
- Phone booths
- Wellness/meditation room
- Recreational games
- Outdoor space
- Dog-friendly spaces
- On-site parking
- Access to car charging stations
- Supplemental HVAC and electric

Building specifications



Hours of operation

Monday – Friday: 8am–5pm



Security

24/7 on-site security



Fire strategy

Fully-sprinklered floors



Building history

Built in 1974
Renovated in 2022



Elevators

1 passenger elevator
1 freight elevator



Building size

2 stories
30,433 SF



HVAC

Monday – Friday: 8am–5pm
Saturday: 8am–1pm

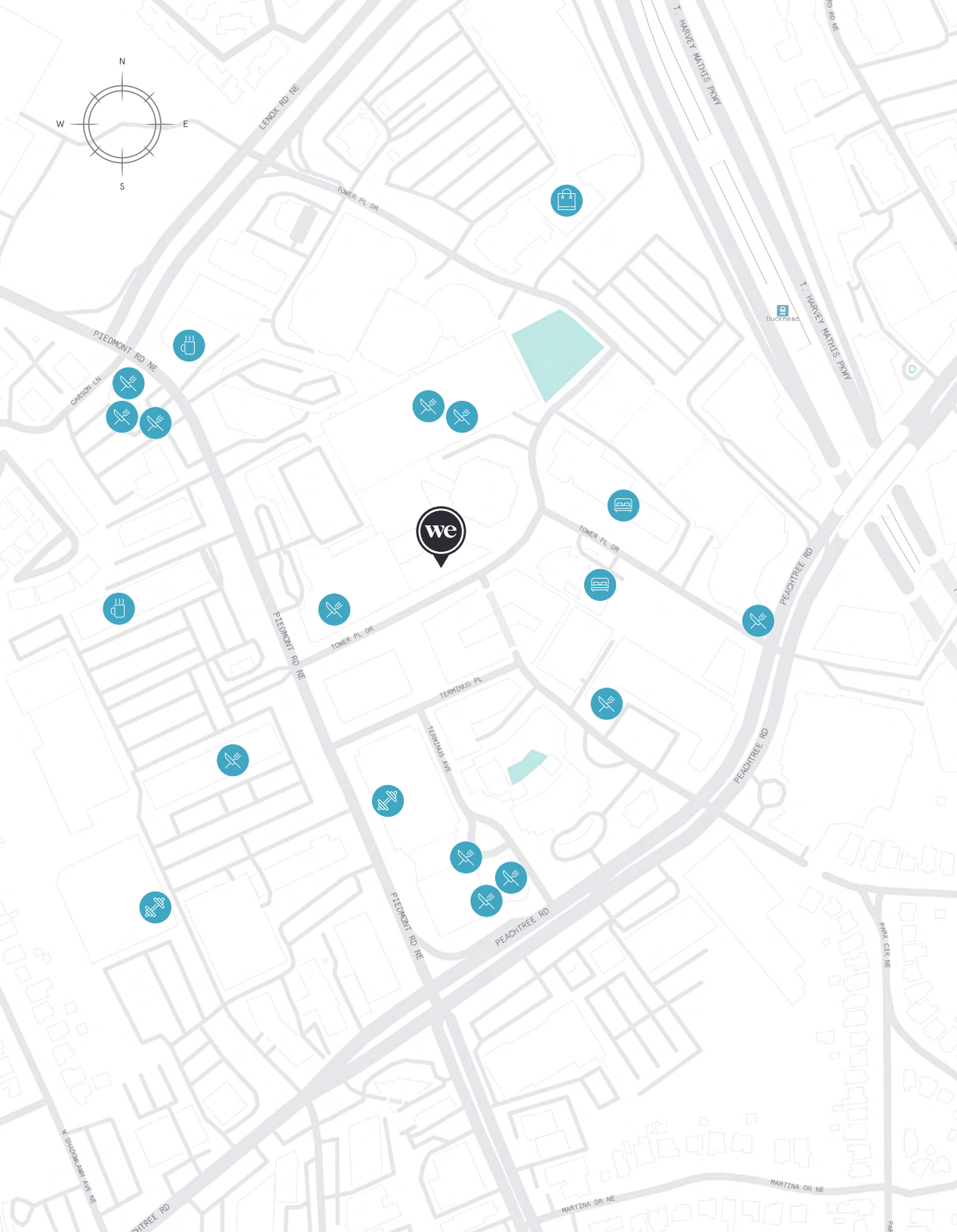







See Buckhead from an all new vantage point

Combining a welcoming atmosphere, a chic design style, excellent amenities, and a premier location in one of Buckhead's most popular areas, Tower Place 100 offers members the exciting opportunity to be only moments away from all of the attractions, bars, and restaurants that Buckhead has to offer. This location is also only a five minute walk to more than 10 different hotels.

Members will find such eateries as Cafe 100, Farm Burger, and Chipotle, as well as Buckhead Station, a popular local shopping complex with a variety of high-end stores.

Distance to WeWork

| | | | |
|---|---|-------|--------|
| Tower Place 100 Parking Garage |  | Walk | 2 min |
| Terminus Parking Garage |  | Walk | 3 min |
| Piedmont Road NE & Peachtree Road NE Stop |  | Walk | 5 min |
| Buckhead Marta Station |  | Walk | 6 min |
| Georgia 400 Highway |  | Drive | 3 min |
| Hartsfield-Jackson International Airport |  | Drive | 27 min |

1st Floor

41,295 RSF

5

MEETING ROOM(S)

7

SHARED WORKSPACE(S)

LEGEND

- MEETING ROOM
- SHARED WORKSPACE
- DEDICATED SPACE

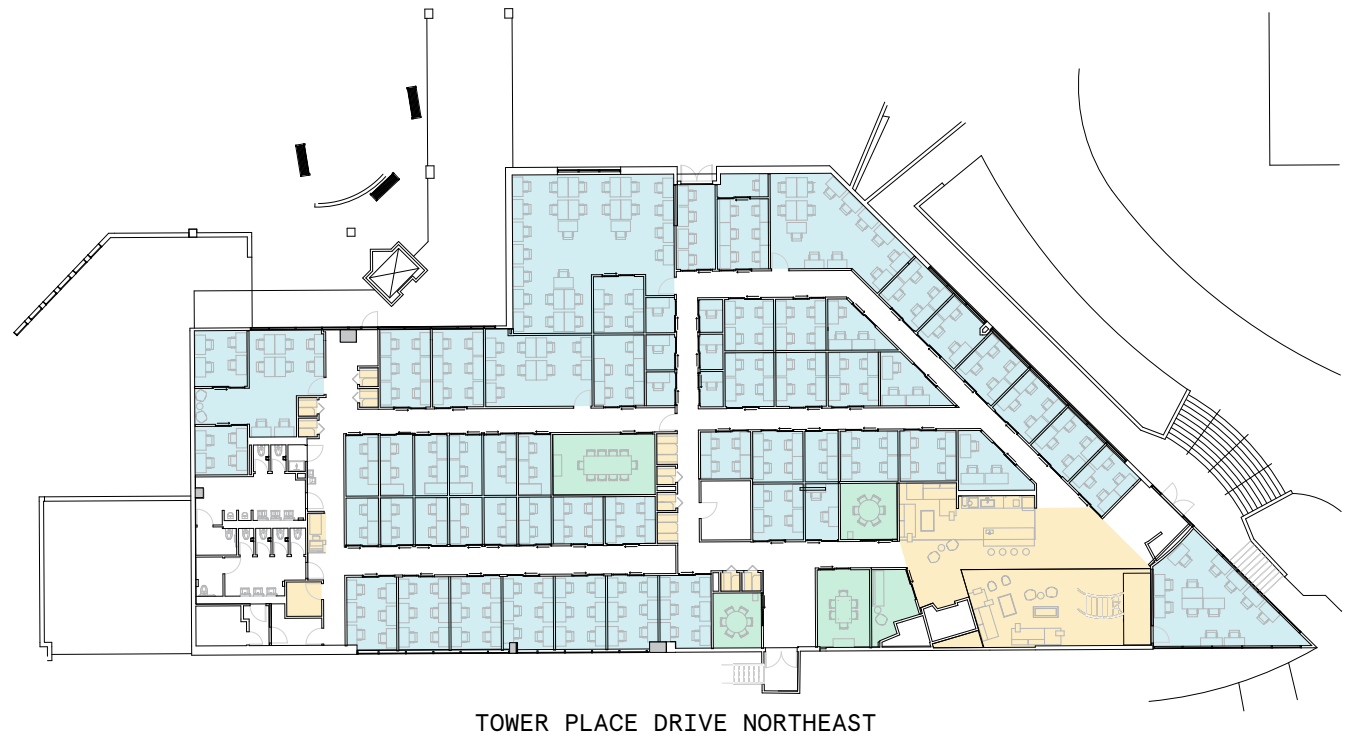

TOWER PLACE DRIVE NORTHEAST

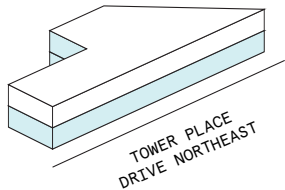

1st Floor

41,295 RSF

2,121 RSF Suite 1067

1

PRIVATE OFFICE(S)

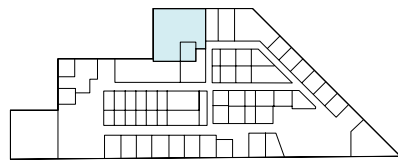
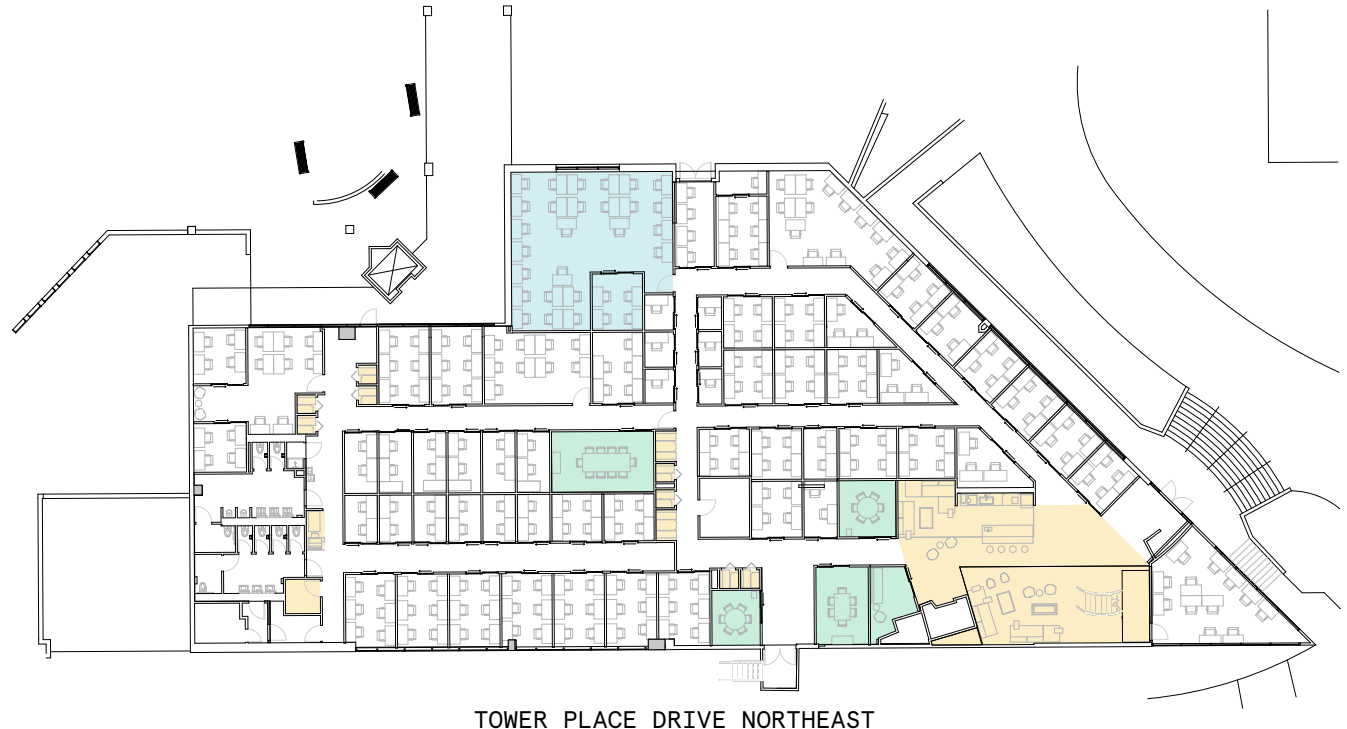

TOWER PLACE DRIVE NORTHEAST

Suite 1067

1st Floor

1

PRIVATE OFFICE(S)

2,121 RSF

RENTABLE AREA

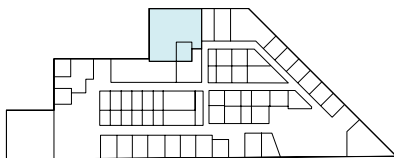

TOWER PLACE DRIVE NORTHEAST

2nd Floor

43,301 RSF





4

MEETING ROOM(S)

4

SHARED WORKSPACE(S)

LEGEND

-  MEETING ROOM
-  SHARED WORKSPACE
-  DEDICATED SPACE



TOWER PLACE DRIVE NORTHEAST

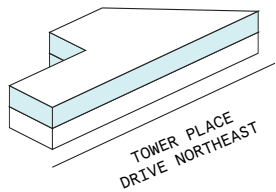

Contact

Complete the form [linked here](#) to book a tour or connect with one of our team members.



© 2023 WeWork. The WeWork trademark and related logos are the property of WeWork Companies LLC. Any reference to third-party names are for reference and informational purposes only and should not be considered an endorsement or association of WeWork or vice versa. Photographs contained herein may be representative examples of various WeWork locations and do not necessarily depict the WeWork location referenced. While reasonable efforts have been made to check the accuracy of the information contained here, WeWork, its officers, employees, directors, and representatives, make no warranty, express or implied, regarding the accuracy of the information and disclaim any liability arising from the use of the information contained herein. All dimensions are approximate and subject to variances. It is your obligation to independently verify the particulars of the property. WeWork reserves the right to make changes.