

# FOR LEASE

## 1.85 ACRE PAVED YARD + OFFICE & SHOP

24432-24600 PACIFIC HWY S | KENT, WA



PACIFIC HWY S

**NEWMARK**

**CAM WARREN**

cam.warren@nmrk.com  
425-362-1395

**TAYLOR HOFF, SIOR**

taylor.hoff@nmrk.com  
425-362-1388

**THAD MALLORY, SIOR**

thad.mallory@nmrk.com  
425-362-1410

# FOR LEASE

## 1.85 ACRE PAVED YARD + OFFICE & SHOP

24432-24600 PACIFIC HWY S | KENT, WA

### SITE PLAN

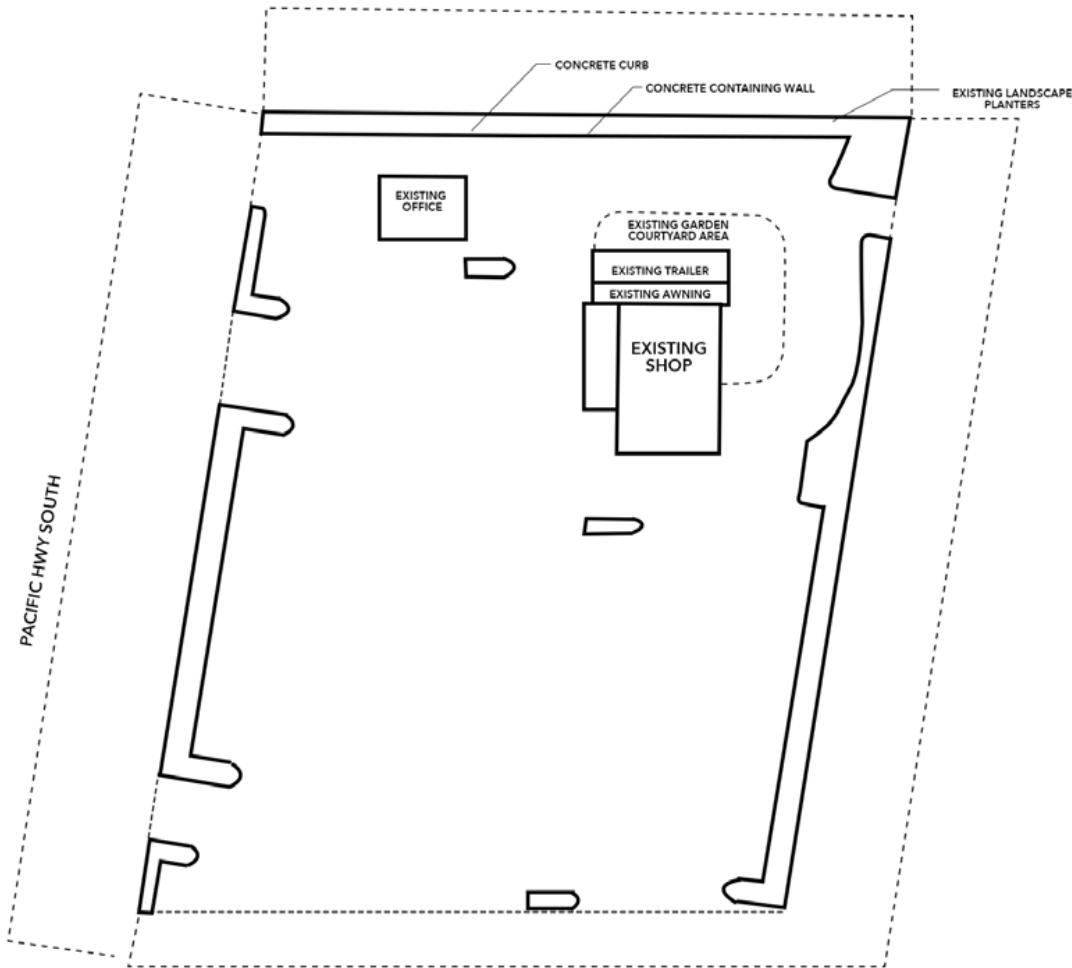

### BUILDING DETAILS

#### 1.85 AC PAVED YARD

±704 SF OFFICE BUILDING

±2,400 SF SHOP WITH TWO CAR LIFTS (3 GL DOORS)

±1,416 SF COVERED AWNING AREA

±1,140 SF COVERED OPEN SHOP AREA

±740 SF MODULAR OFFICE

### PROPERTY HIGHLIGHTS

- Fully fenced, paved, and lit site
- Excellent visibility along Pacific Highway with approx. 27,000 cars per day and quick access to area highways
- Flexible commercial manufacturing (CM) zoning
- Video security system
- Easy access to I-5 and Sea-Tac Int'l Airport

# NEWMARK



# FOR LEASE

## 1.85 ACRE PAVED YARD + OFFICE & SHOP

24432-24600 PACIFIC HWY S | KENT, WA

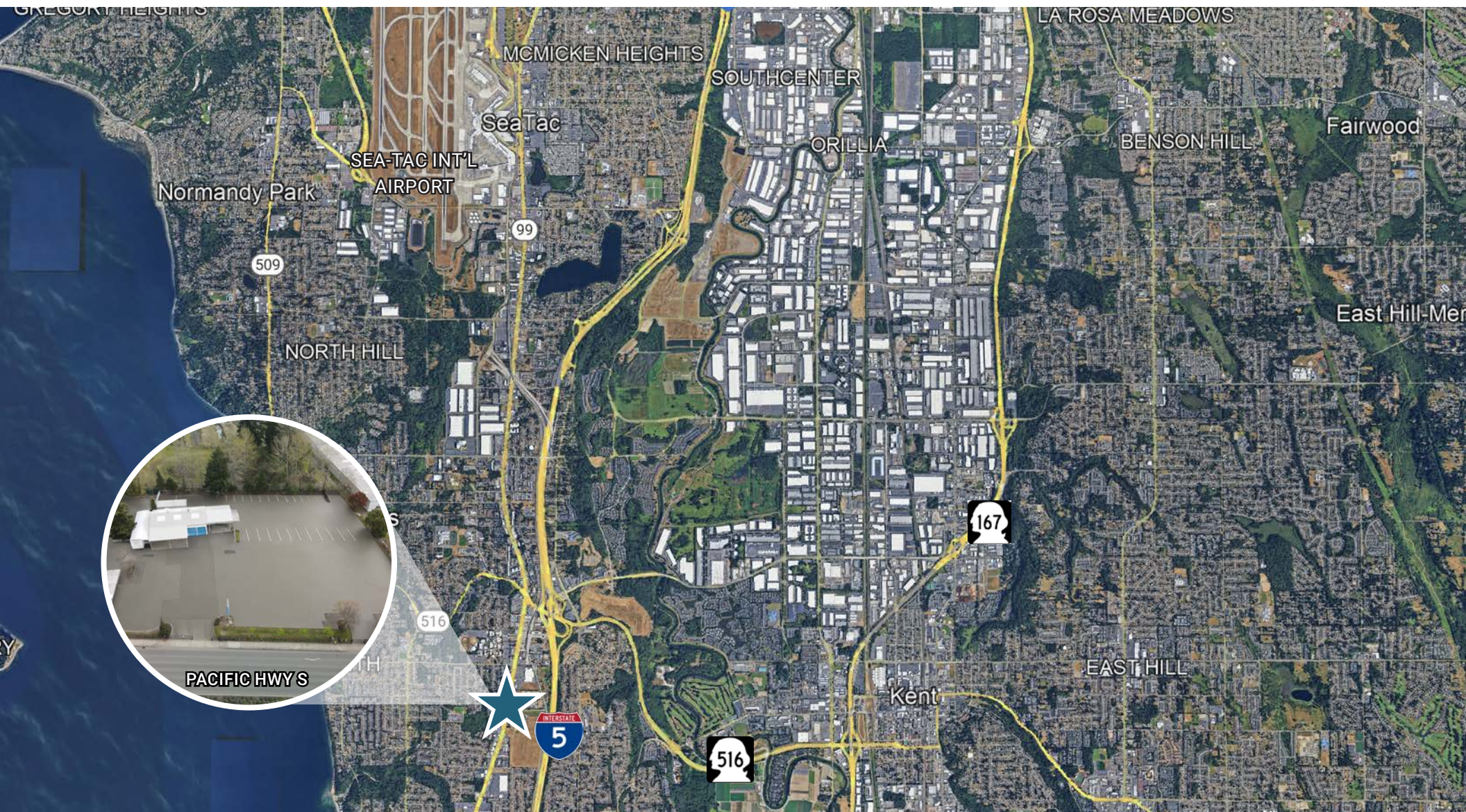

**NEWMARK**

The information contained herein has been obtained from sources deemed reliable but has not been verified and no guarantee, warranty or representation, either express or implied, is made with respect to such information. Terms of sale or lease and availability are subject to change or withdrawal without notice.