



# TIMPANOGOS

## TECH CENTER

---

PROVO, UTAH







# WHY UTAH





Utah is a thriving hub for business, innovation, and entrepreneurship. As the #1 Best State to Start a Business according to Wallet Hub, and boasting the #1 best economic outlook, Utah has established itself as a leader in economic growth. With a highly concentrated market for residents in their 20s, the state is attracting a young and ambitious population. Furthermore, Utah's risk capital and entrepreneurial infrastructure ranks #3 nationwide, making it an attractive destination

for startups and small businesses. Provo, has been recognized as the best performing city in the nation, cementing Utah's reputation as a hotbed for economic activity and innovation. Beyond its thriving economy, Utah is also home to breathtaking natural beauty, including five stunning national parks, as well as top-ranked universities and institutions including the top ranked nearby BYU in Provo and University of Utah in Salt Lake City, making it an ideal place to live, work, and play.





# PROPERTY OVERVIEW



ASKING RATE  
**\$18-22 FSC**

## Features

- Available suites range from 4,557 SF – 174,856 SF
- Abundant parking ratio available
- Superior access to I-15 via University Ave
- Abundance of natural light and magnificent mountain views throughout
- Quick and easy access to growing communities and talent
- Building exterior signage available to qualified Tenants
- Backup generators across the campus
- Numerous walking paths
- Abundant outdoor spaces available for group activities
- 24-hour security with regular patrols
- On-site property management
- Shopping at the Provo Towne Center Mall located across the street

## Campus Upgrades

- Class A finishes and landscape
- On-site cafeteria and coffee shop
- Expanded fitness center (8,800 SF)
- 4 Volleyball courts & 2 basketball courts
- Exclusive Shuttle Service
- Exterior upgrades to create a fully-integrated Office Campus
- Interior lobby remodeled in most buildings



# SITE PLAN



- |                   |                               |
|-------------------|-------------------------------|
| <b>BUILDING 1</b> | 34 East 1700 South            |
| <b>BUILDING 2</b> | 78 East 1700 South            |
| <b>BUILDING 3</b> | 122 East 1700 South           |
| <b>BUILDING 4</b> | 198 East 1070 South           |
| <b>BUILDING 5</b> | 1712 South East Bay Boulevard |
| <b>BUILDING 6</b> | 1656 South East Bay Boulevard |

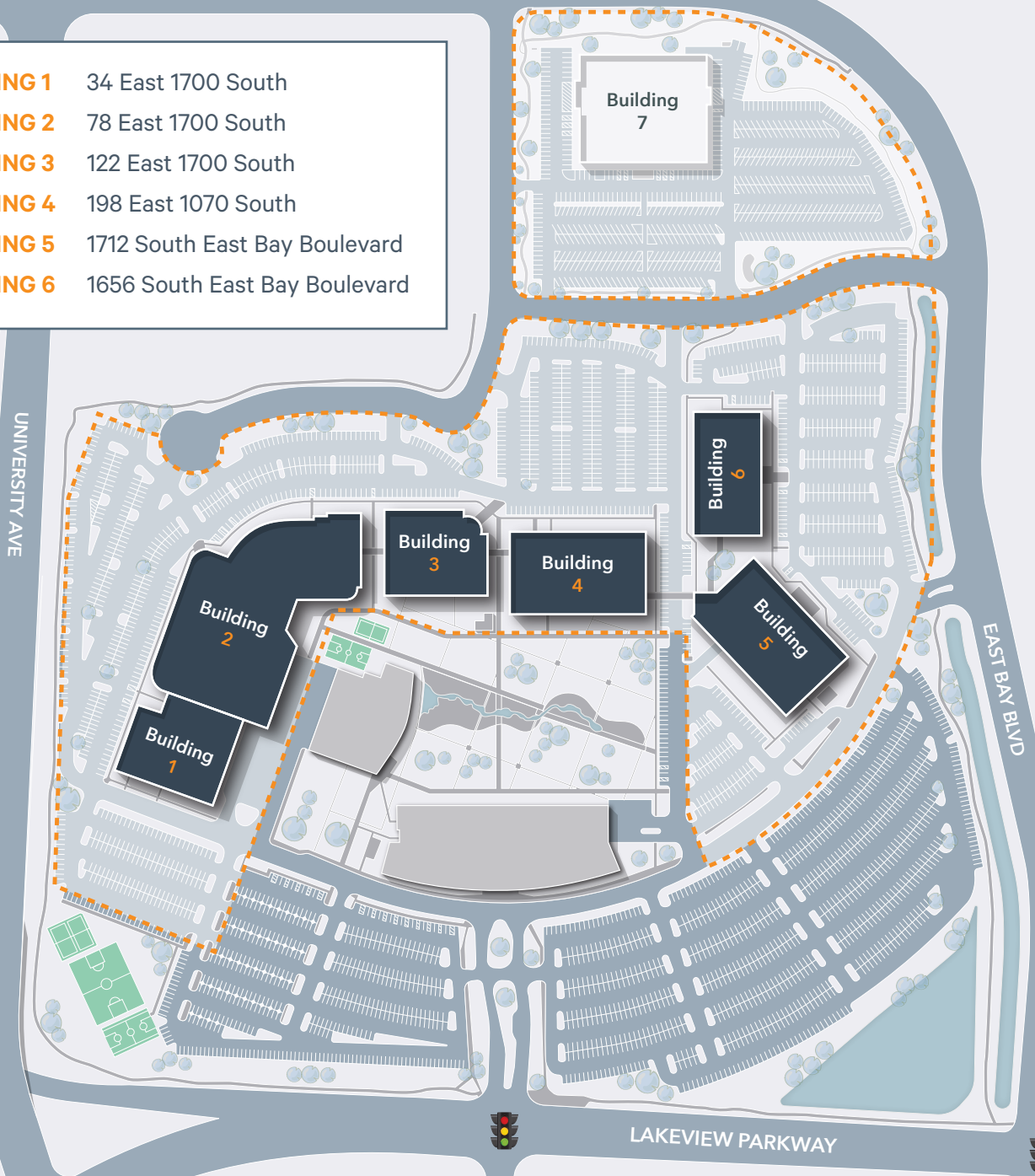





# DEMOGRAPHICS

Utah has been the fastest growing state in the US from 2020 to 2023 achieving a remarkable 23.9% population growth. Most of the state's population, over 2 million residents, resides in towns and cities along the Wasatch front with many growing technology and start-up firms choosing to reside between Provo and Lehi. With a median age of 31.4 compared to the national average of 38.5, Utah is a hotbed for young entrepreneurs and recent graduates looking for adventure in the Wasatch Mountains and exciting opportunities for work along the Front.

## Utah County at a Glance



**92.2%**

HIGH SCHOOL EDUCATION OR HIGHER



**24.4**

MEDIAN AGE



**719,174**

POPULATION





# TIMPANOGOS TECH CENTER

BUILDING 1 – 34 EAST 1700 SOUTH  
FIRST FLOOR



**TIMPANOGOS**  
TECH CENTER

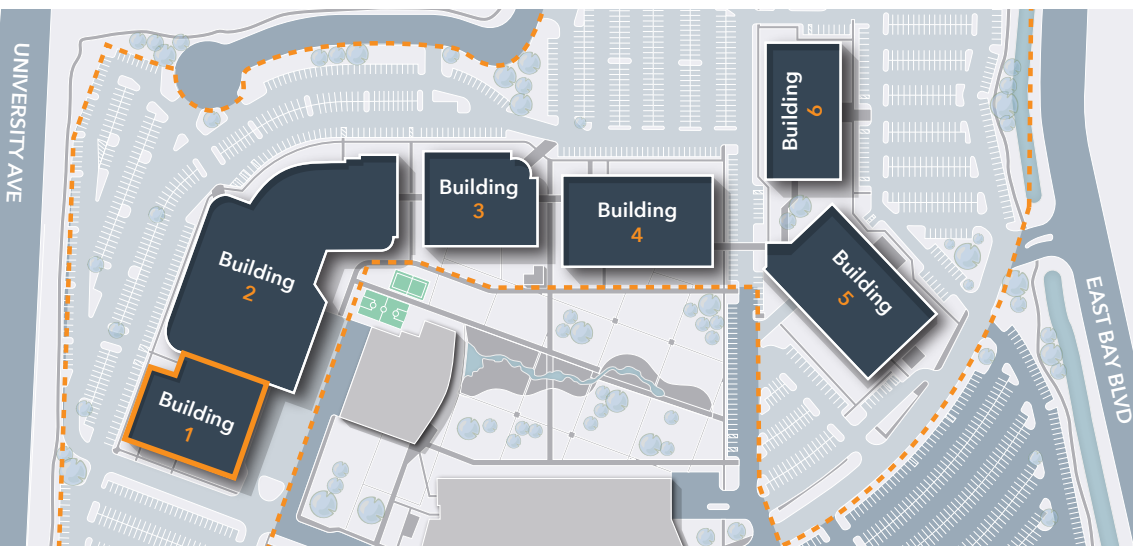



# TIMPANOGOS TECH CENTER

BUILDING 2 – 78 EAST 1700 SOUTH  
FIRST FLOOR



**TIMPANOGOS**  
TECH CENTER

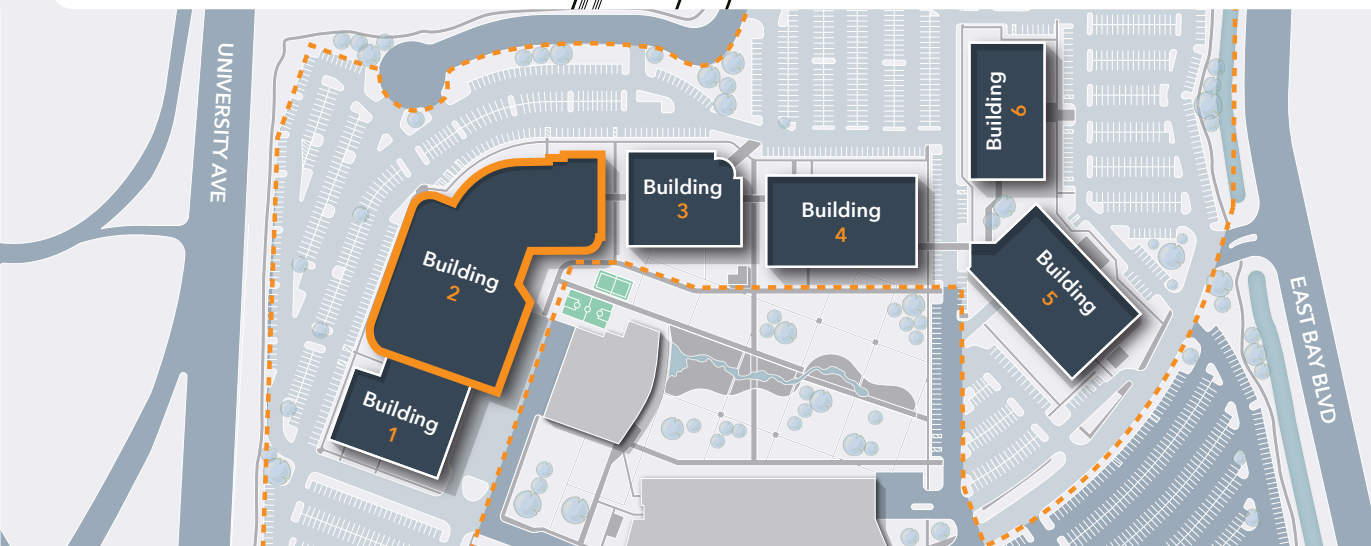
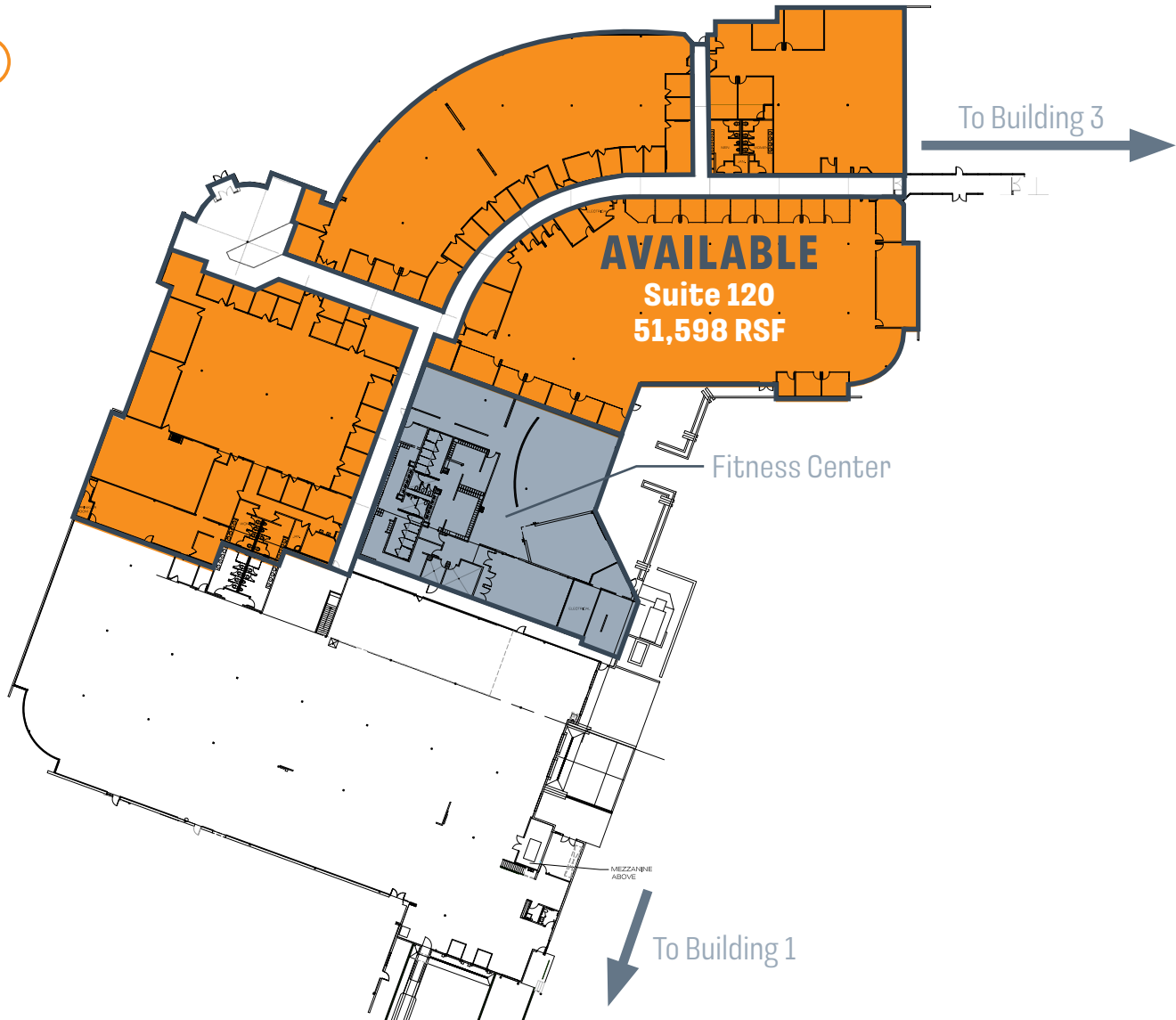



# TIMPANOGOS TECH CENTER

BUILDING 4 – 198 EAST 1700 SOUTH  
FIRST FLOOR



**TIMPANOGOS**  
TECH CENTER



To Building 3



To Building 5

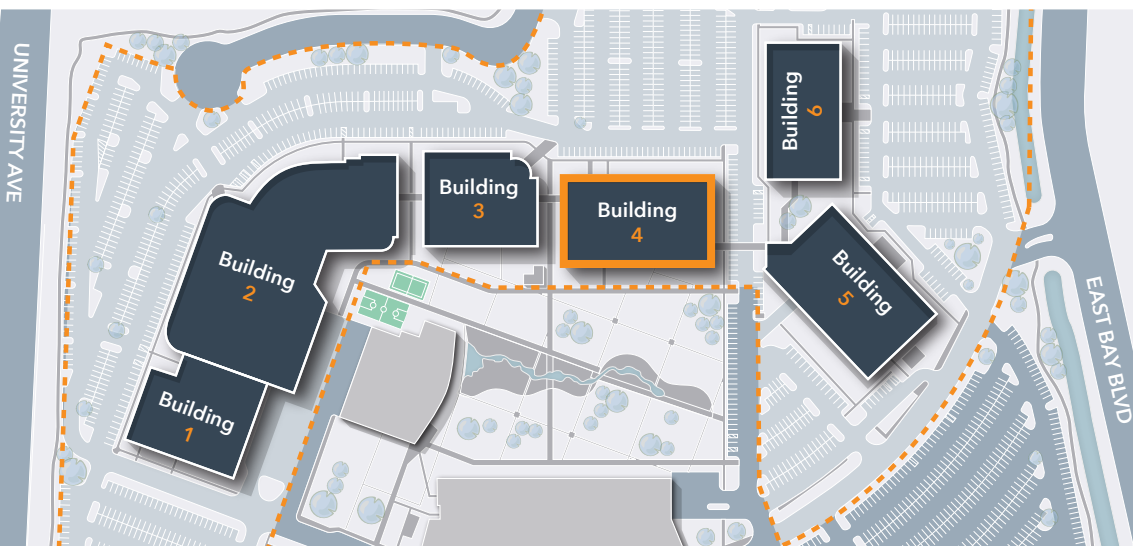



# TIMPANOGOS TECH CENTER

BUILDING 4 – 198 EAST 1700 SOUTH  
SECOND FLOOR



**TIMPANOGOS**  
TECH CENTER



To Building 3



To Building 5



UNIVERSITY AVE

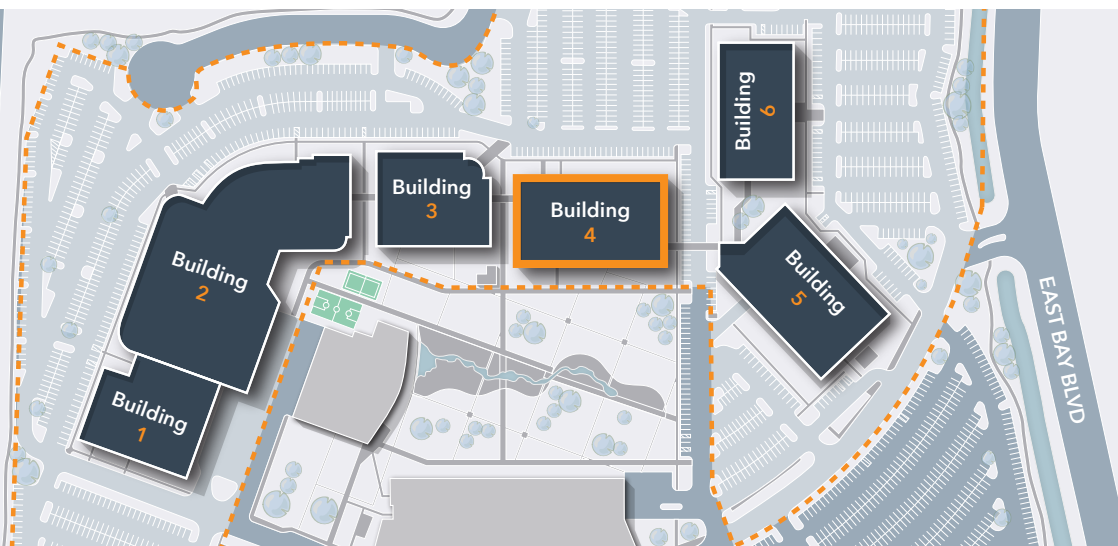



# TIMPANOGOS TECH CENTER

**BUILDING 5** – 1712 SOUTH EAST BAY BOULEVARD  
FIRST FLOOR



**TIMPANOGOS**  
TECH CENTER

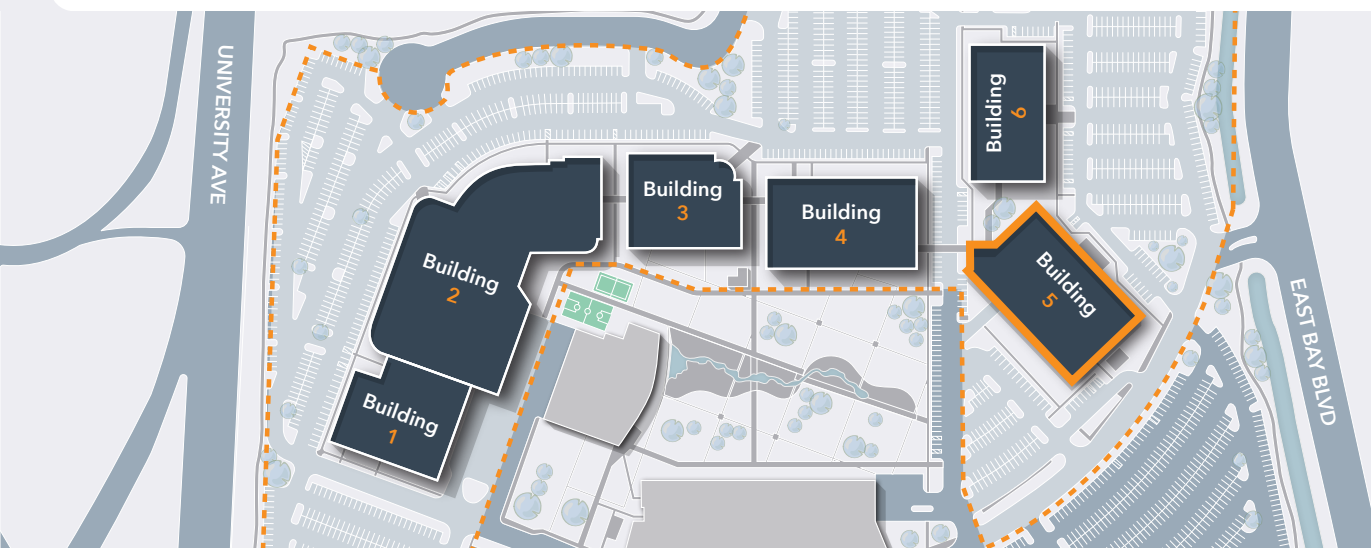
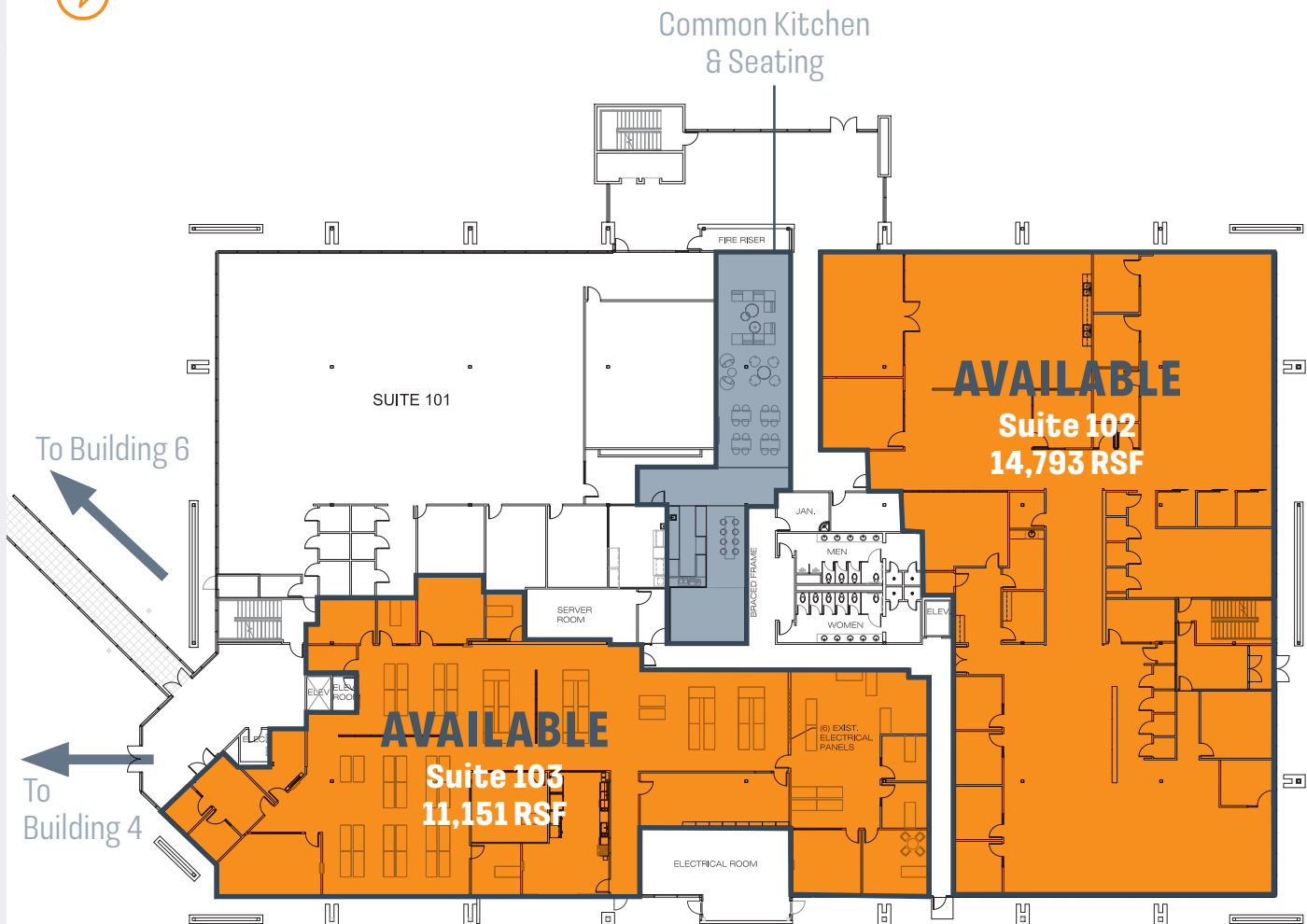



# TIMPANOGOS TECH CENTER

BUILDING 5 – 1712 SOUTH EAST BAY BOULEVARD  
THIRD FLOOR



**TIMPANOGOS**  
TECH CENTER

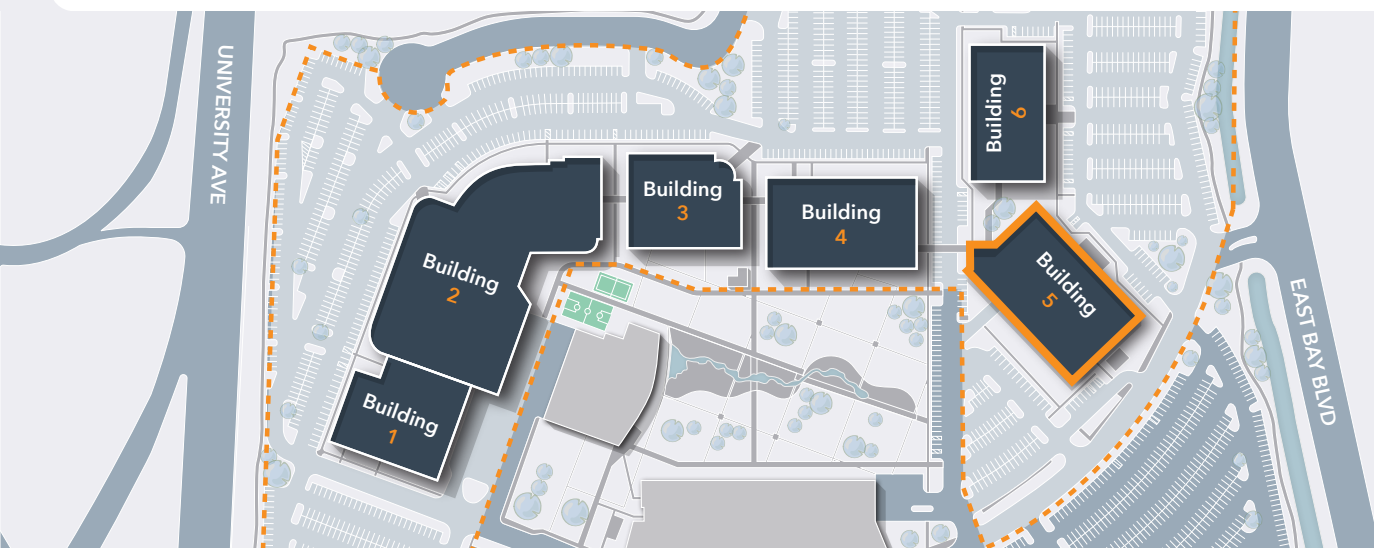



# TIMPANOGOS TECH CENTER

**BUILDING 6** – 1656 SOUTH EAST BAY BOULEVARD  
SECOND FLOOR



**TIMPANOGOS**  
TECH CENTER



To Building 5

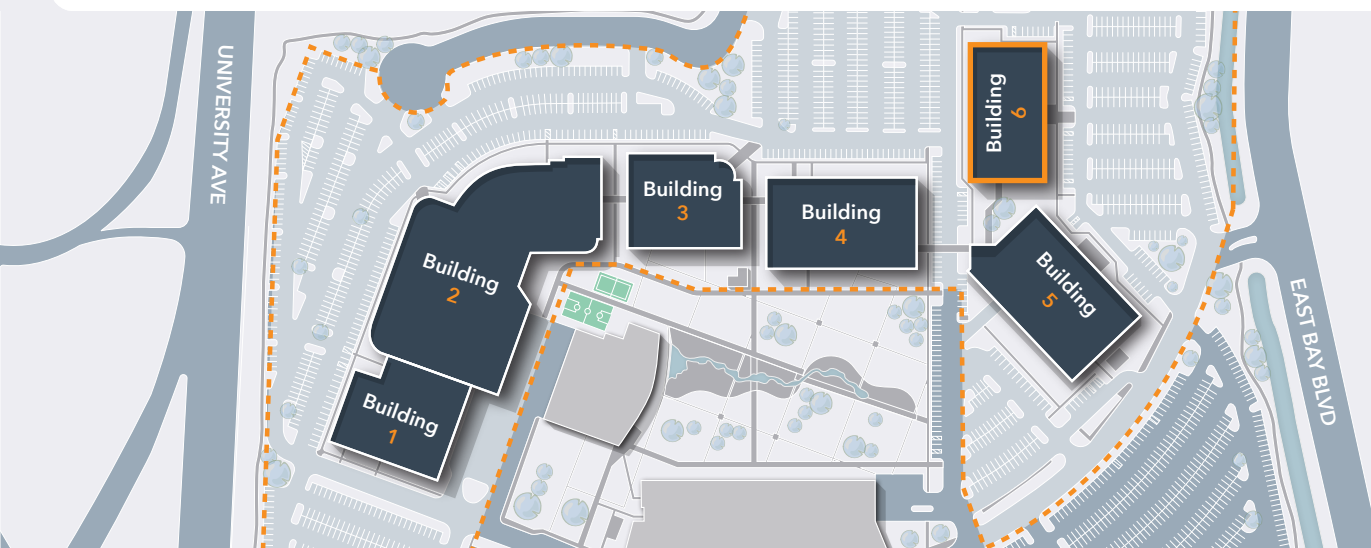

















# AMENITIES

## WITHIN 10 MILES RADIUS

### POPULAR FOOD OPTIONS

- |   |  |  |
|---|--|--|
| 1  | 6   | 11  |
| 2  | 7   | 12  |
| 3  | 8   | 13  |
| 4  | 9   | 14  |
| 5  | 10  | 15  |

### RETAILERS

- |   |
|---|
| 1  |
| 2  |
| 3  |
| 4  |

### HOTELS

- |   |
|---|
| 1  |
|---|

### FITNESS/SPORTS

- |   |
|---|
| 1  |
| 2  |

### HEALTH

- |   |
|---|
| 1  |
|---|

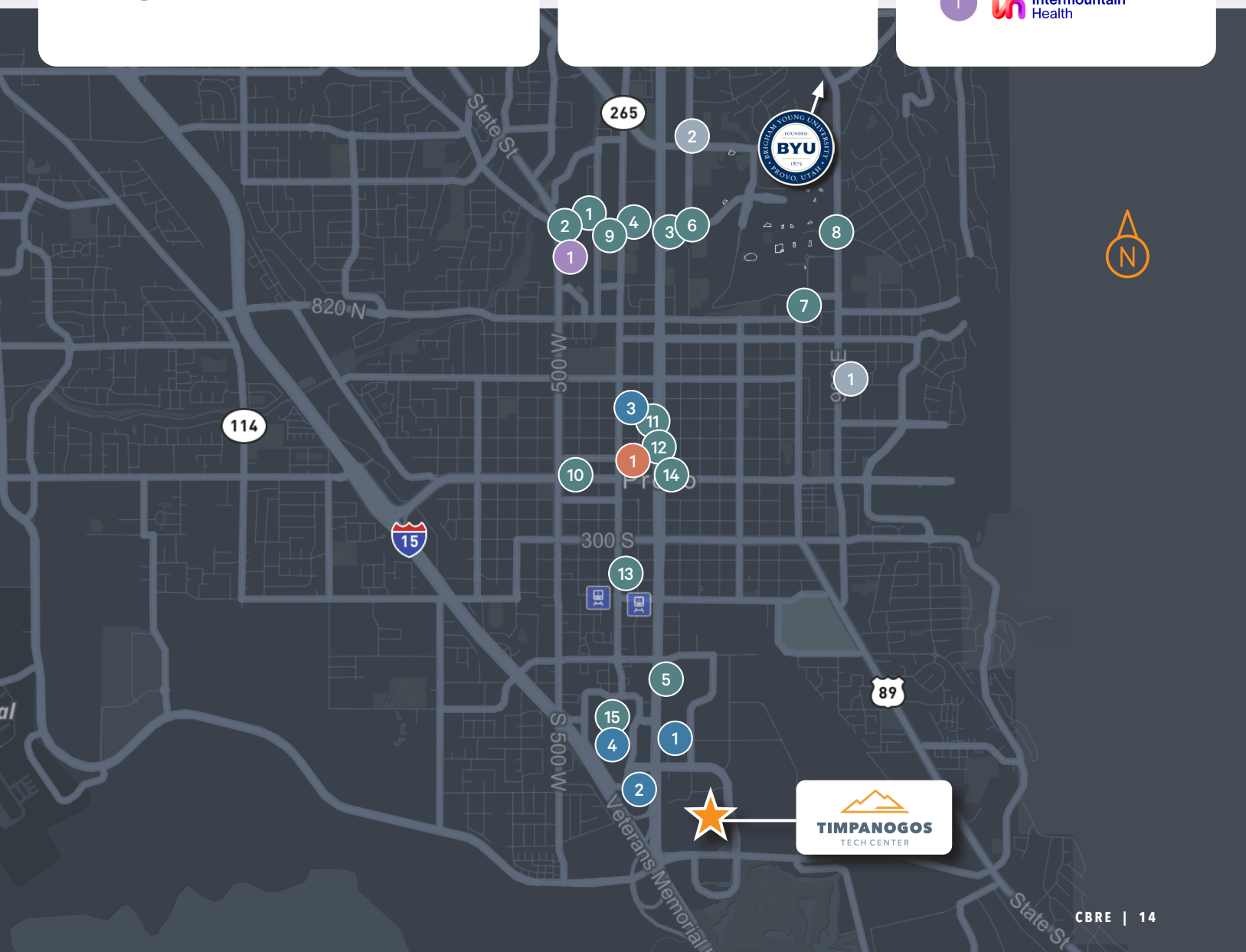

**TIMPANOGOS**  
TECH CENTER



# TRANSIT MAP







## Kreg Peterson

First Vice President  
kreg.peterson@cbre.com  
(801) 869-8092

## Eric Smith

Senior Vice President  
eric.smith@cbre.com  
(801) 869-8008

## Jillian Hanks

Vice President  
jillian.hanks@cbre.com  
(801) 869-8010

## Cole Bennee

Associate  
cole.bennee@cbre.com  
(801) 869-8098



# CBRE

© 2025 CBRE, Inc. All rights reserved. This information has been obtained from sources believed reliable, but has not been verified for accuracy or completeness. You should conduct a careful, independent investigation of the property and verify all information. Any reliance on this information is solely at your own risk. CBRE and the CBRE logo are service marks of CBRE, Inc. All other marks displayed on this document are the property of their respective owners, and the use of such logos does not imply any affiliation with or endorsement of CBRE. Photos herein are the property of their respective owners. Use of these images without the express written consent of the owner is prohibited.