

INDUSTRIAL LAND AVAILABLE

11900-12200 Dixie Highway | Louisville, KY 40272



**103± ACRES
ZONED CM**

**103± ACRES
LAND AVAILABLE**

**\$6,825,000
SALE PRICE**



MICHAEL TABOR | MTABOR@TRIOCPG.COM | (502) 454-4557
JUSTIN BAKER, SIOR | JBAKER@TRIOCPG.COM | (502) 454-0911
SETH EDENS, SIOR | SEEDENS@TRIOCPG.COM | (502) 553-4180



HIGHLIGHTS

- 103± acres ready for development
- Zoned CM
- Less than 1 mile from I-265
- 10 miles from I-64
- Adjacent to Louisville Riverport Rail Line
- Potential to build over 1 million SF of warehouses
- Sewer access on site



DISTANCE TO MAJOR REGIONAL U.S. CITIES

CINCINNATI	110 mi.
INDIANAPOLIS	125 mi.
NASHVILLE	168 mi.
COLUMBUS	217 mi.
ST. LOUIS	273 mi.
CHICAGO	307 mi.
DETROIT	312 mi.
MEMPHIS	379 mi.
ATLANTA	384 mi.
PITTSBURGH	399 mi.



65 13 Miles to I-65

264 10 Miles to I-264

71 25 Miles to I-71

265 2.4 Miles to I-265

64 18.1 Miles to I-64

16.2 Miles to SDF

16.1 Miles to UPS Worldport

16 Miles to Ford Louisville Assembly Plant

21 Miles to GE Appliance Park

PROPOSED BUILDING PLAN

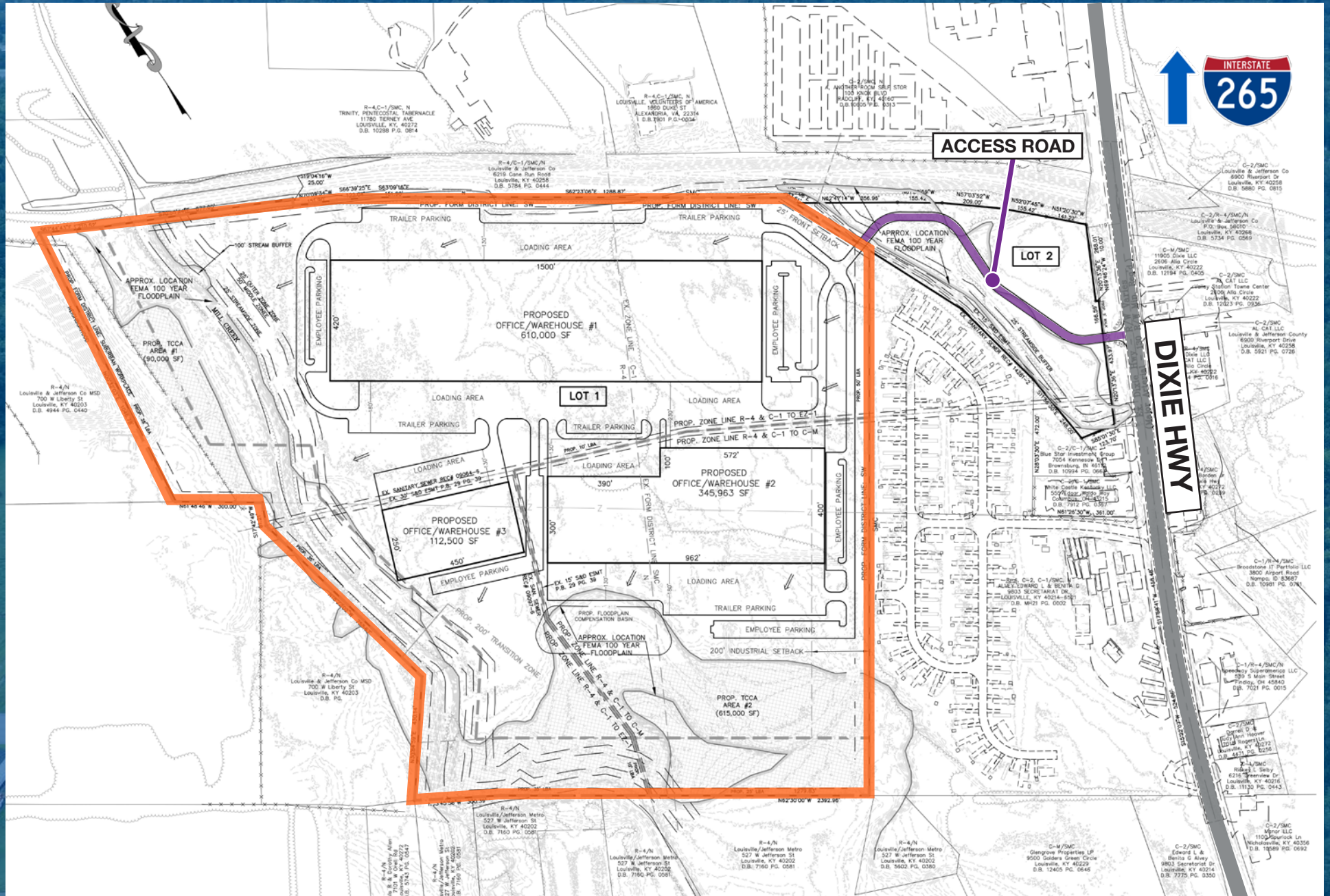

11900 Dixie Hwy | Louisville, KY 40272



**MICHAEL TABOR
PARTNER**

502 454 4557
MTABOR@TRIOCPG.COM

**JUSTIN BAKER, SIOR
PRINCIPAL BROKER, PARTNER**

502 454 0911
JBAKER@TRIOCPG.COM

**SETH EDENS, SIOR
PARTNER**

502 553 4180
SEEDENS@TRIOCPG.COM

