

Full Renovation Now Complete

For Sale
14,933 SF



300 Thor Place, Brea, California

PROPERTY FEATURES:

- Freestanding Industrial Building
- 1,900 SF (±) of Office Area
- Two (2) Ground Level Loading Doors (12' x 14')
- Eighteen Foot (18') Minimum Warehouse Ceiling Clearance
- Fully Fire Sprinklered
- LED Warehouse Lighting
- Skylights Throughout Warehouse Area
- Power: 600 Amps, 120/208 Volts, 3 Phase (Verify)
- Ample Parking (Approximately 30 Stalls)
- Business Park Environment
- Secure Cul-de-Sac Location
- Excellent Access to the Orange (57) Freeway
- **Full Renovation Completed, Including:**
 - **New Paint Interior & Exterior**
 - **Brand-New Office Area**
 - **New Lighting**
 - **New Landscaping**
 - **Parking Areas Fully Renovated with New Top Coat & Re-Striping**

Jeff Read

Executive Managing Director

t 949-608-2029

jeff.read@nrmk.com

CA RE Lic. #01040265

NEWMARK

300 THOR PLACE
BREA, CALIFORNIA

For Sale
14,933 SF

SITE PLAN

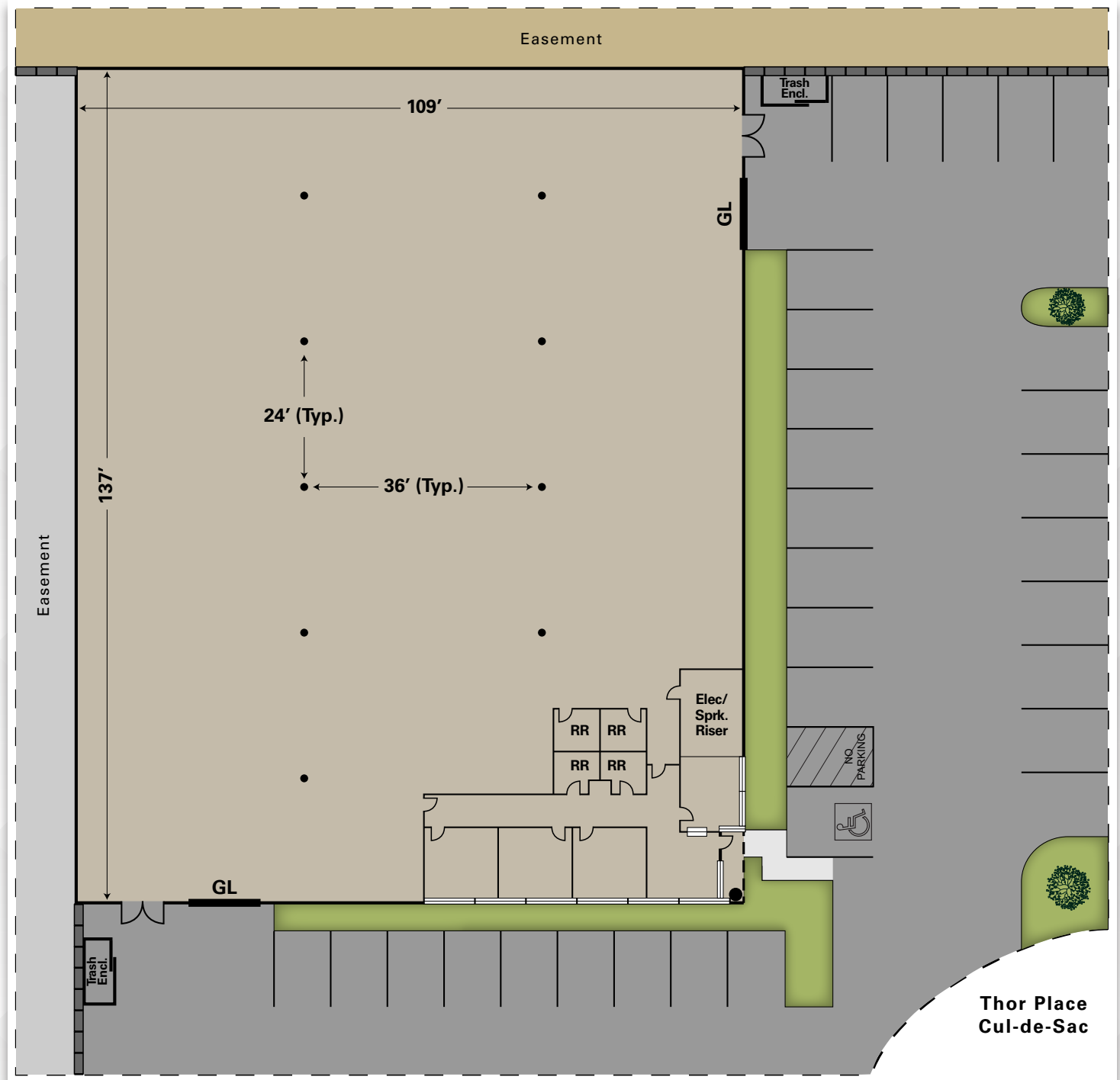

Corporate License #01355491

The distributor of this communication is performing acts for which a real estate license is required. The information contained herein has been obtained from sources deemed reliable but has not been verified and no guarantee, warranty or representation, either express or implied, is made with respect to such information. Terms of sale or lease and availability are subject to change or withdrawal without notice.

NEWMARK

300 THOR PLACE
BREA, CALIFORNIA

For Sale - 14,933 SF



New Office Finishes



Fully Renovated Warehouse



West Side Parking



North Side Parking

**300 THOR PLACE
BREA, CALIFORNIA**

For Sale

14,933 SF

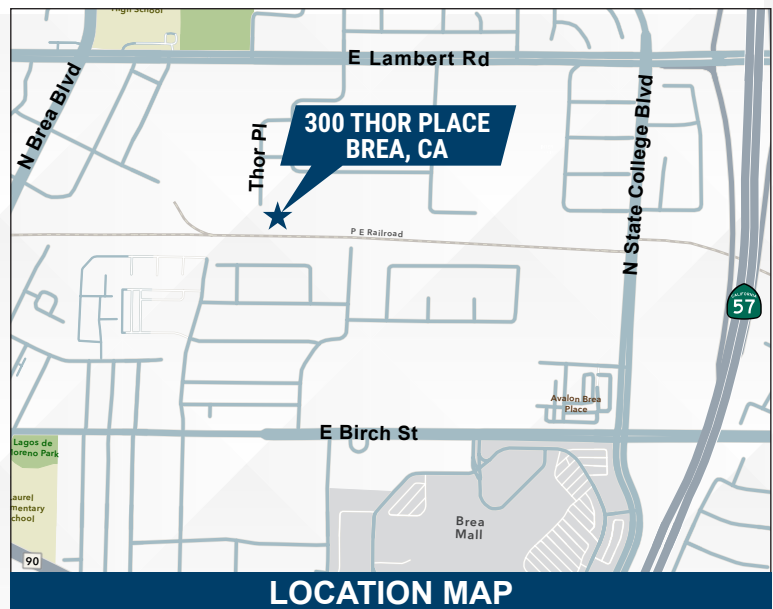

NEWMARK

Jeff Read jeff.read@nmrk.com CA RE Lic. #01040265

18401 Von Karman Avenue, Suite 150, Irvine, CA 92612