

1916 CONEY ISLAND AVE | \$3,000,000

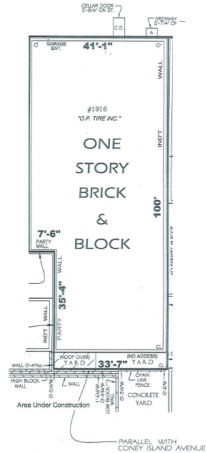

PROPERTY DESCRIPTION

Commercial property for sale. In the heart of Midwood, Brooklyn. Existing one story warehouse/tire shop.

18,446 sqft build-able for community facility use.

Owner user or development opportunity.

PROPERTY FEATURES

- Commercial/Development
- 41' X 100' Lot Size
- 3,843 GSF
- 12 Ft. ceiling
- C8-2, OP Zoning
- Delivered Vacant

JONATHAN LIB

Senior Managing Director
347-589-4811
JL@AlphaCRE.com

MEYER DAGMY

Director
718-249-3613
MD@AlphaCRE.com

