



**CUSHMAN &  
WAKEFIELD**

THE OVERLOOK

**Office / Retail  
FOR LEASE**

**5,306 SF Available in Athens**

**494 BAXTER ST**

**ATHENS, GA 30605**

1180 Peachtree Street NE Suite 3100  
Atlanta, GA 30309  
+1 404 875 1000

[cushmanwakefield.com](http://cushmanwakefield.com)

**FOR LEASE**  
494 Baxter St, Athens, GA 30605



**Signage & Front Door**



**Side Parking**

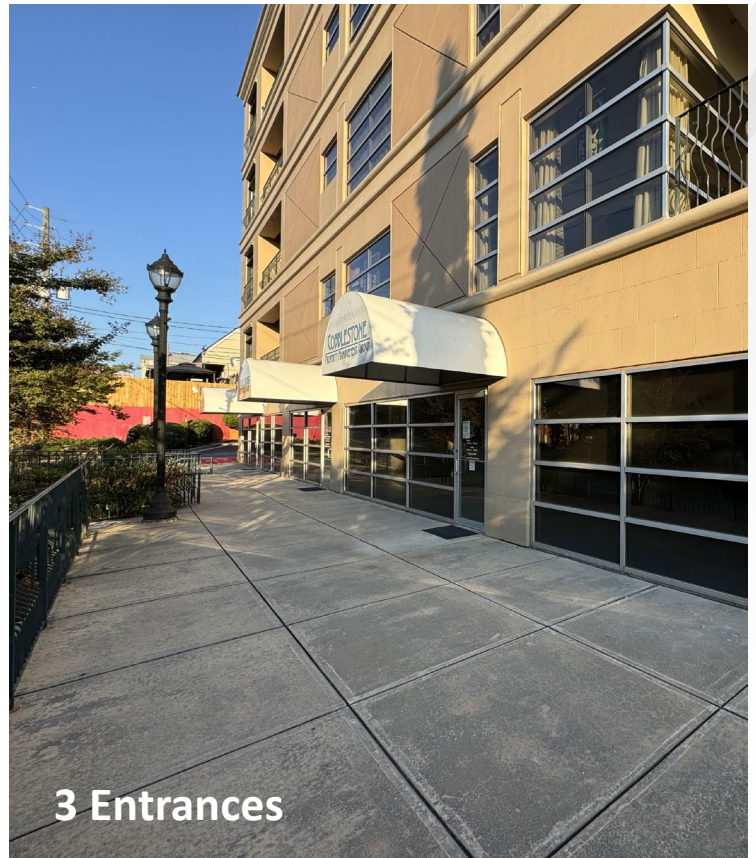

**3 Entrances**

**FOR LEASE**  
494 Baxter St, Athens, GA 30605



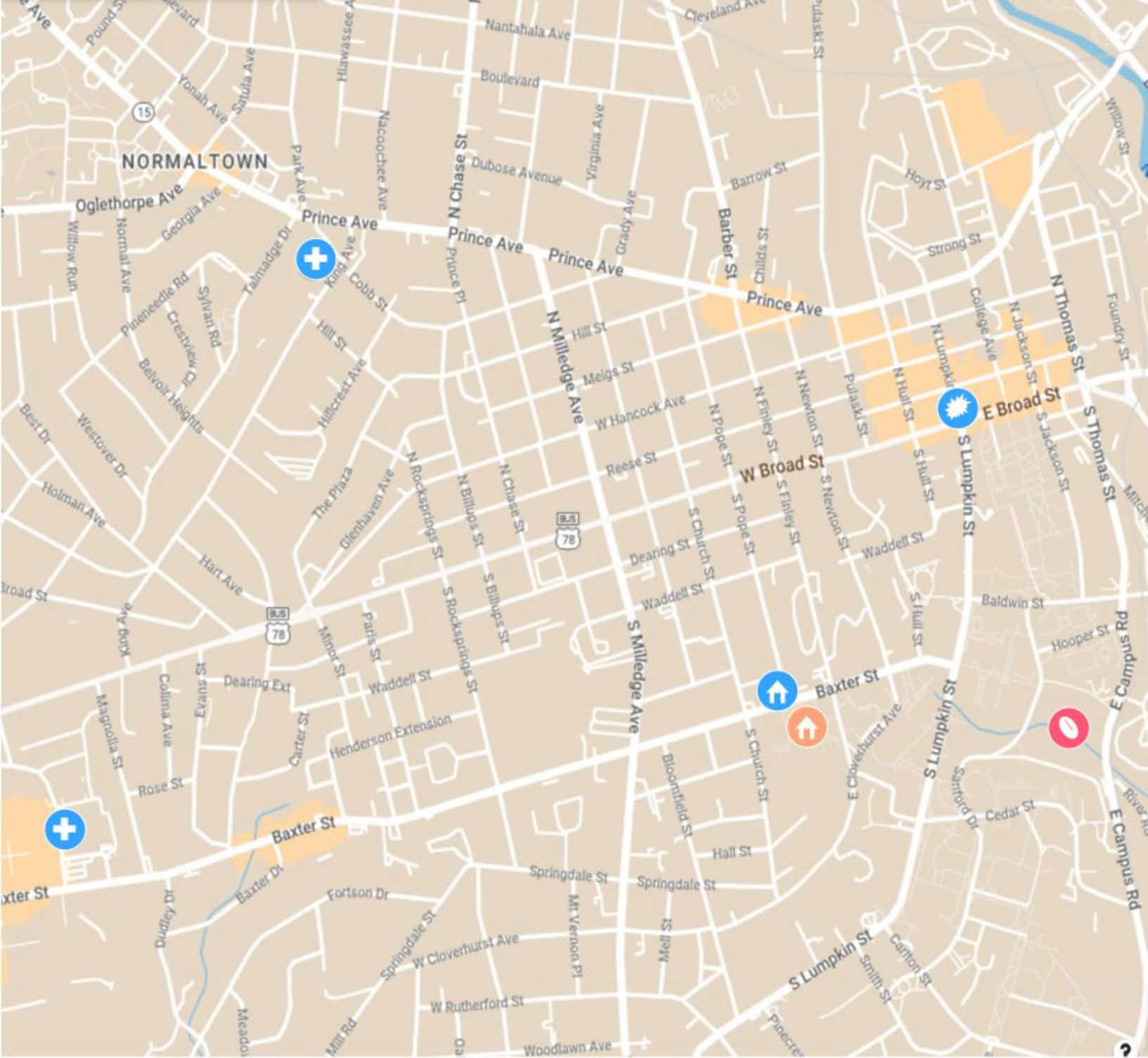

## AREA MAP



St. Mary's Hospital



Athen's Regional Medical Center



494 Baxter Street



UGA Dorms (Russel, Brumby, Creswell, and BDM)



Downtown Athens



UGA Sanford Stadium

**FOR LEASE**  
494 Baxter St, Athens, GA 30605



**1st Floor**  
**5,306 SF**

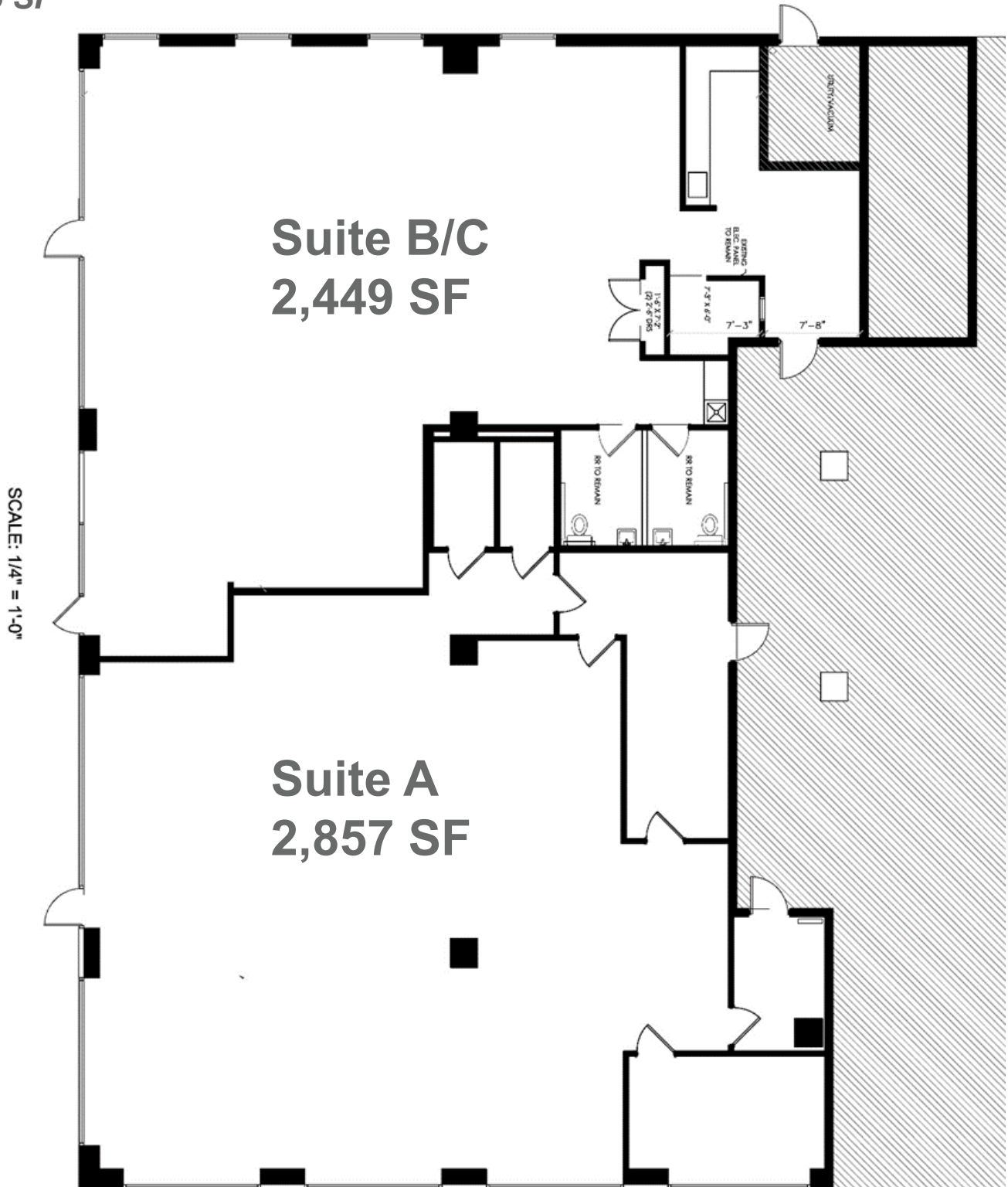

**FOR LEASE**  
494 Baxter St, Athens, GA 30605



## 1<sup>st</sup> Floor Availability in Prime Athens Location

- 5,306 SF on the 1st Floor
- \$25 NNN
- On UGA campus
- Located directly across the street from the UGA dorms
- Walkable to several campus buildings
- 21 designated commercial parking spots
- Wheelchair accessible
- Abundant natural light with large windows

For more information, please contact:

**Caroline Shore**

Associate

+1 404 693 3099

caroline.shore@cushwake.com

1180 Peachtree Street NE Suite 3100

Atlanta, GA 30309

+1 404 875 1000

[cushmanwakefield.com](http://cushmanwakefield.com)

©2023 Cushman & Wakefield. All rights reserved. The information contained in this communication is strictly confidential. This information has been obtained from sources believed to be reliable but has not been verified. NO WARRANTY OR REPRESENTATION, EXPRESS OR IMPLIED, IS MADE AS TO THE CONDITION OF THE PROPERTY (OR PROPERTIES) REFERENCED HEREIN OR AS TO THE ACCURACY OR COMPLETENESS OF THE INFORMATION CONTAINED HEREIN, AND SAME IS SUBMITTED SUBJECT TO ERRORS, OMISSIONS, CHANGE OF PRICE, RENTAL OR OTHER CONDITIONS, WITHDRAWAL WITHOUT NOTICE, AND TO ANY SPECIAL LISTING CONDITIONS IMPOSED BY THE PROPERTY OWNER(S). ANY PROJECTIONS, OPINIONS OR ESTIMATES ARE SUBJECT TO UNCERTAINTY AND DO NOT SIGNIFY CURRENT OR FUTURE PROPERTY PERFORMANCE.