



FOR LEASE

Downtown Office Space

890 MILL STREET, RENO, NV



COVERED PARKING



LOBBY

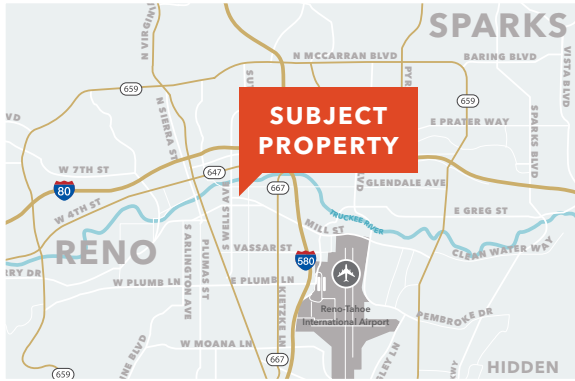

SUBJECT PROPERTY

Well Designed Office Building

SUZY KLASS
775.470.8859
suzy.klass@kidder.com
LIC N° S.0171097

EVAN MEYER
775.470.8869
evan.meyer@kidder.com
LIC N° S.0184765



This information supplied herein is from sources we deem reliable. It is provided without any representation, warranty, or guarantee, expressed or implied as to its accuracy. Prospective Buyer or Tenant should conduct an independent investigation and verification of all matters deemed to be material, including, but not limited to, statements of income and expenses. Consult your attorney, accountant, or other professional advisor.

KIDDER.COM

FOR LEASE

Downtown Office Space

890 MILL STREET, RENO, NV 89502

Features

PERFECT for medical or professional office

STATE-OF-THE-ART energy saving features with plenty of surface parking

OPEN sunny, offices with great mountain views

PRIME location near downtown and easy access to I-580 and Hwy 395

ACROSS from Renown Medical Center as well as the VA, Northern NV Medical Center and St Mary's all minutes away



AVAILABLE SPACE

Floor	Suite	RSF	Rental Rate
1st	100	1,326	\$1.70, FS
1st	101	999	\$1.70, FS
1st	102	1,354	\$1.70, FS
2nd	200	2,736	\$1.65, FS
2nd	203	744	\$1.65, FS
2nd	205	760	\$1.65, FS

SUZY KLASS

775.470.8859

suzy.klass@kidder.com

LIC N° S.0171097

EVAN MEYER

775.470.8869

evan.meyer@kidder.com

LIC N° S.0184765

KIDDER.COM



This information supplied herein is from sources we deem reliable. It is provided without any representation, warranty, or guarantee, expressed or implied as to its accuracy. Prospective Buyer or Tenant should conduct an independent investigation and verification of all matters deemed to be material, including, but not limited to, statements of income and expenses. Consult your attorney, accountant, or other professional advisor.