



Colliers

\$50 for Qualified Tour!



Office For Lease

Up to
77,729 SF
Total Available

Contact:

Rusty Lugo

Vice President
+1 801 947 8377
rusty.lugo@colliers.com



James Burgess
+1 801 262 3660
james@theburgessco.com

Colliers

111 S. Main St., Suite 2200
Salt Lake City, UT 84111
Main: +1 801 947 8300
colliers.com

Lease Rate Reduction!

10975 Sterling View Dr.
South Jordan, Utah, 84095

Property Highlights

- Lease Rate: ~~\$24.00 - \$26.00/SF~~
**\$22.50/SF, Full Service less
in-suite janitorial**
- Up to 77,729 SF Total Available
1st Floor: 32,982 SF
2nd Floor: 44,801 SF
- 8/1,000 Parking Ratio
- Abundant fiber connectivity
- On-site BBQ & picnic area
- Basketball court area

Accelerating success.

Floor Plan

1st Floor: *Up to 32,928 SF Available*

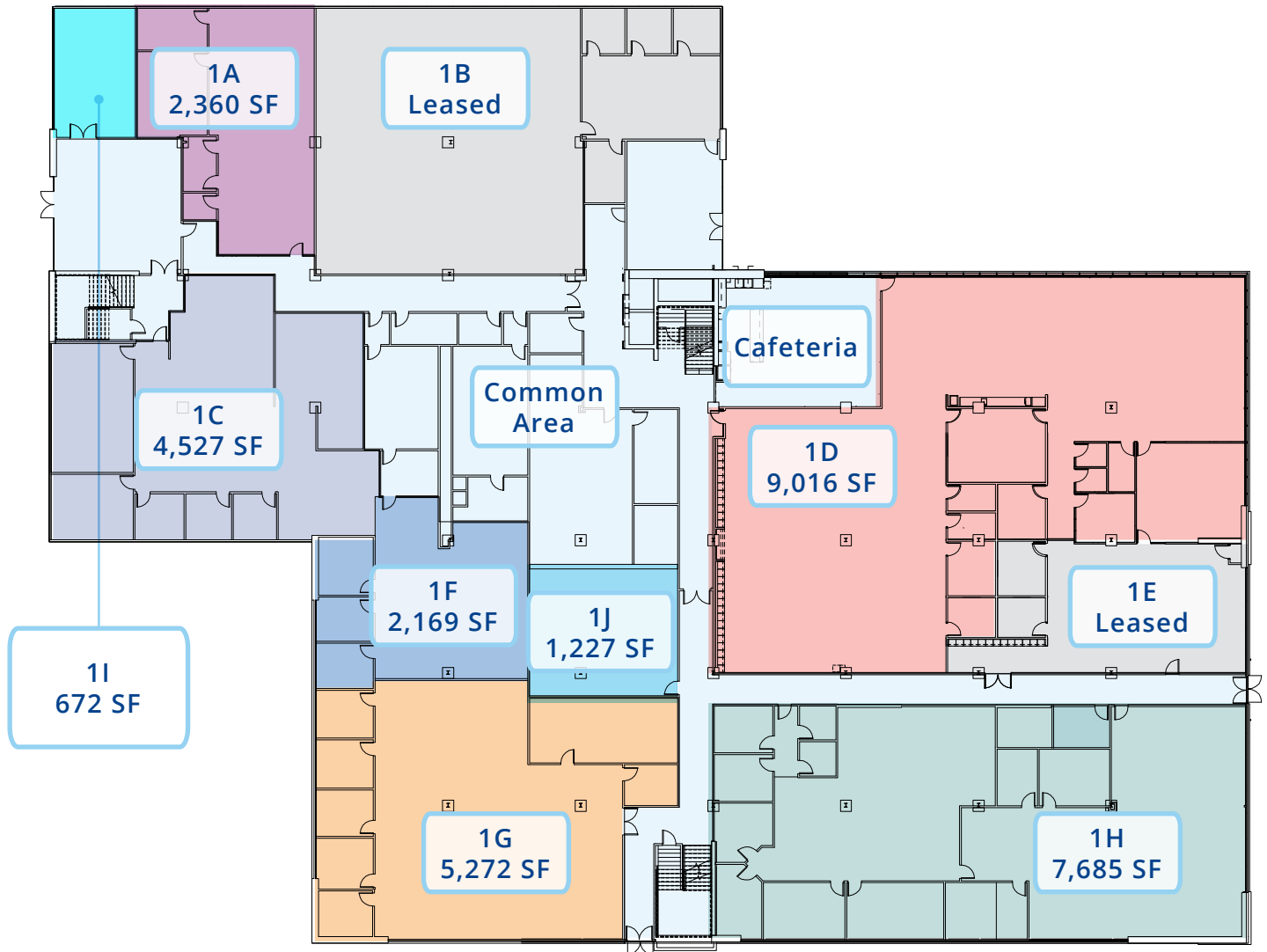

10975 Sterling View Dr. | For Lease

Up to
77,729 SF
Total Available

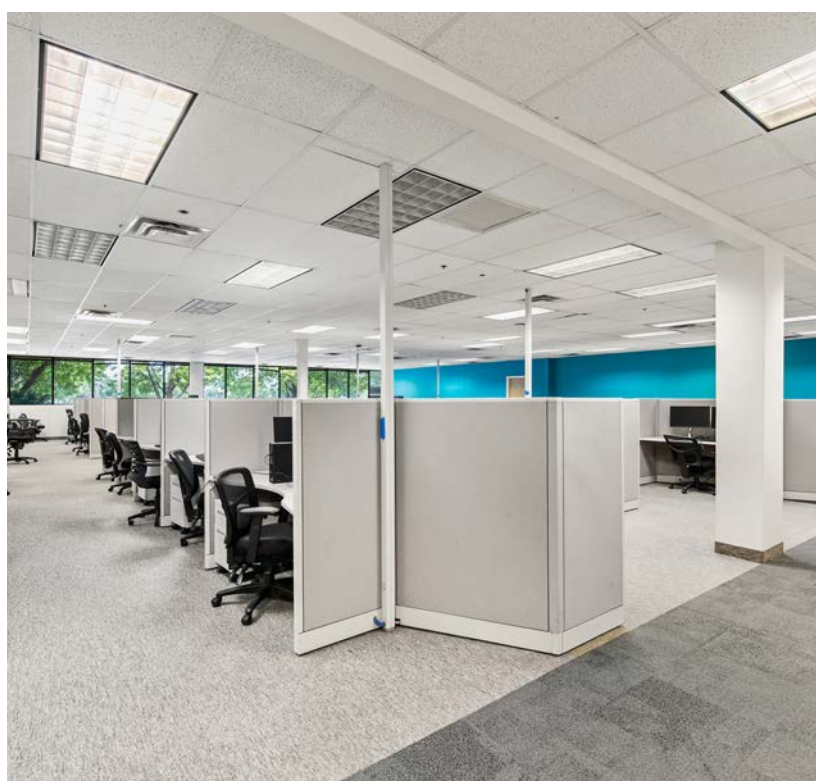
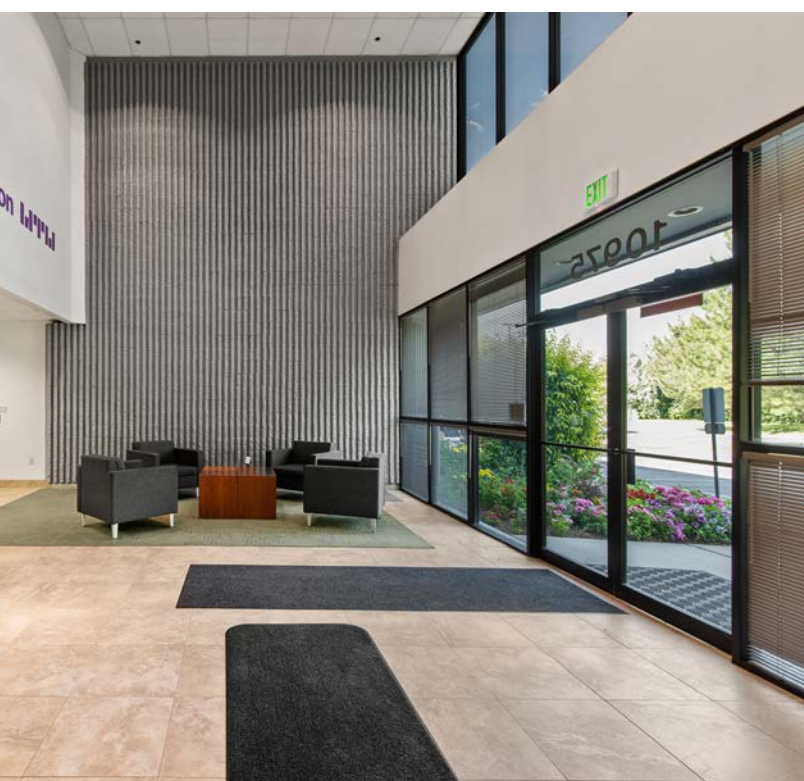

Floor Plan

2nd Floor: *Up to 44,801 SF Available*

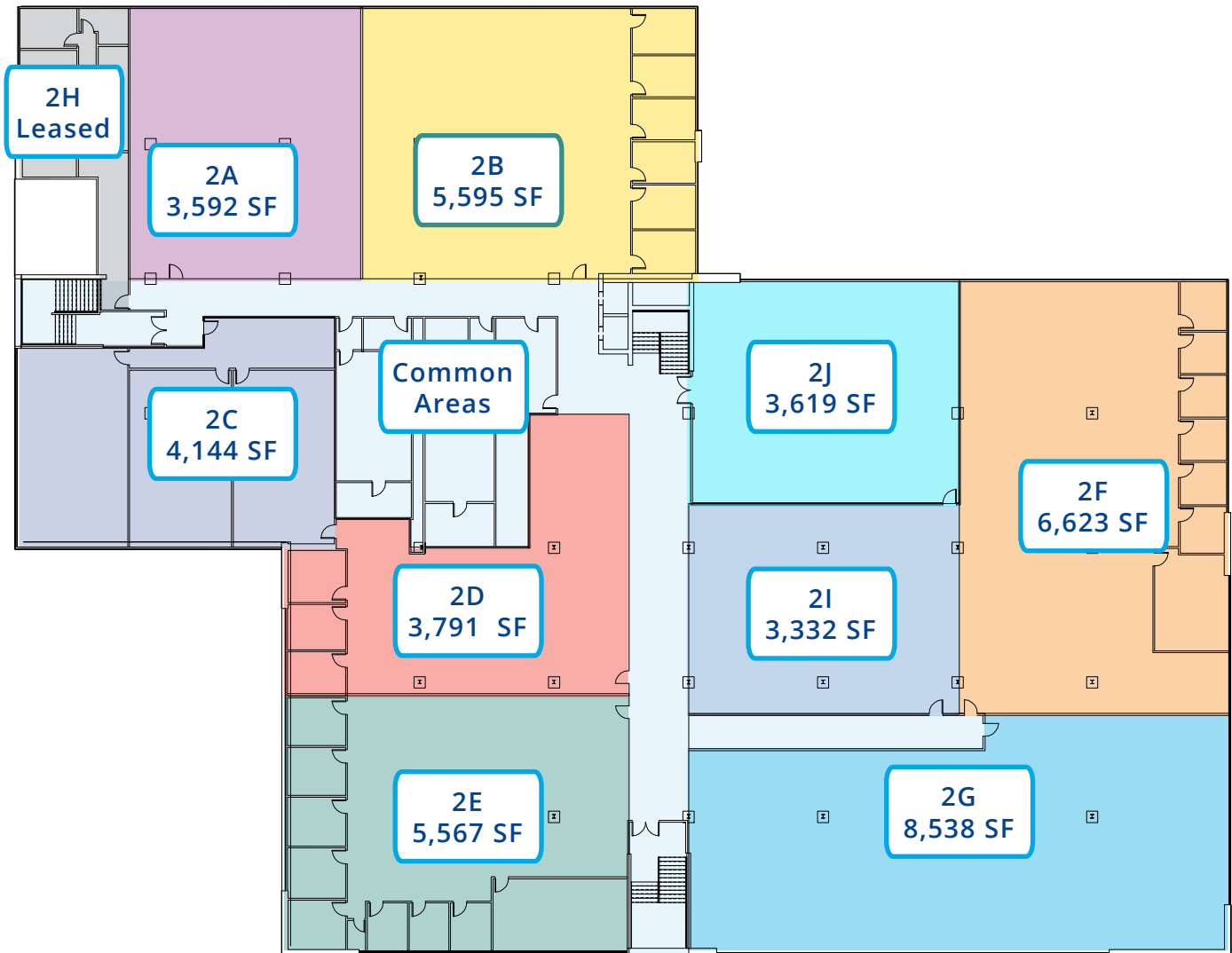

10975 Sterling View Dr. | For Lease

Up to
77,729 SF
Total Available





Colliers
 111 S. Main St., Suite 2200
 Salt Lake City, UT 84111
 Main: +1 801 947 8300
 colliers.com

Contact:
Rusty Lugo
 Vice President
 +1 801 947 8377
 rusty.lugo@colliers.com

 **The Burgess Company**
James Burgess
 +1 801 262 3660
 james@theburgessco.com

This document has been prepared by Colliers International for advertising and general information only. Colliers International makes no guarantees, representations or warranties of any kind, expressed or implied, regarding the information including, but not limited to, warranties of content, accuracy and reliability. Any interested party should undertake their own inquiries as to the accuracy of the information. Colliers International excludes unequivocally all inferred or implied terms, conditions and warranties arising out of this document and excludes all liability for loss and damages arising there from. This publication is the copyrighted property of Colliers International and/or its licensor(s). ©2025. All rights reserved.