

790 VAN NESS AVENUE

FOR LEASE | HARD CORNER GROUND FLOOR RETAIL SPACE

TCP
TOUCHSTONE
COMMERCIAL PARTNERS

CITIVISION
COMMERCIAL REAL ESTATE

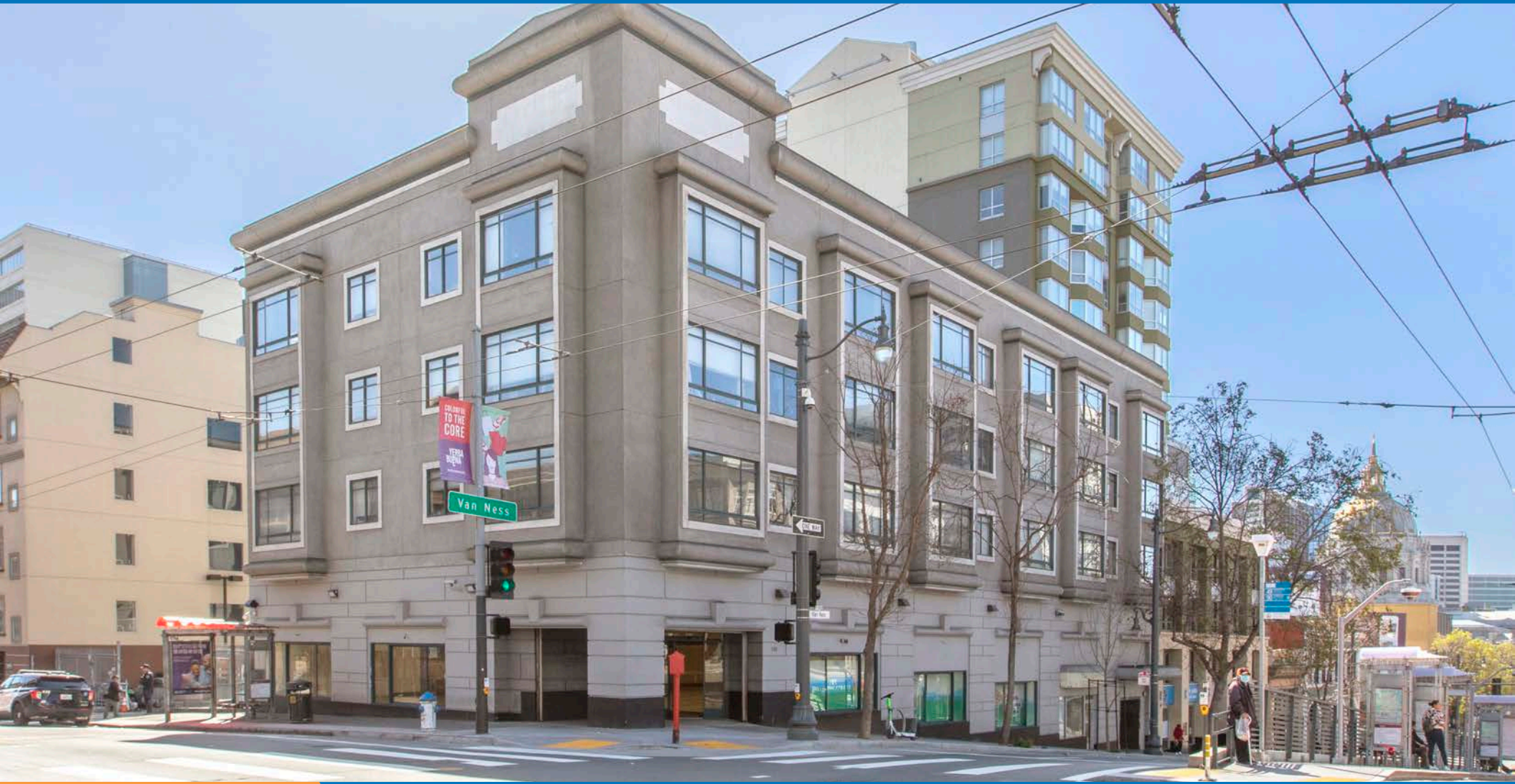

WWW.TCPRE.COM

JARON ELIOPOULOS jaron@tcpre.com
C 415.608.6336

CAMERON TU cameron@tcpre.com
C 510.919.8193

ZACH HAUPERT zhaupert@tcpre.com
D 415.539.1121 | C 415.812.1219

ED MAIELLO ed@citivisioncommercial.com
D 415.543.2002 C 415.407.3523

790 VAN NESS AVENUE

PROPERTY SUMMARY

ADDRESS

790 Van Ness Avenue, San Francisco, CA 94102

AVAILABLE SPACE

Ground Floor +/- 6,445 Square Feet

Lower Level +/- 3,050 Square Feet

TOTAL +/- 9,495 Square Feet

ZONING

RC-4 - Residential-Commercial, High Density

RENTAL RATE

Negotiable

AVAILABLE

Immediately

BUILDING ATTRIBUTES

- + Highly Visible Corner Location On Busy Van Ness Avenue
- + Parking Available
- + Conveniently Located Between Civic Center & CPMC/Sutter Health Campus
- + Two (2) Restrooms
- + Easily Accessible By Public Transportation



790 VAN NESS AVENUE

Floor Plans

Ground Floor

+/- 6,445 Square Feet

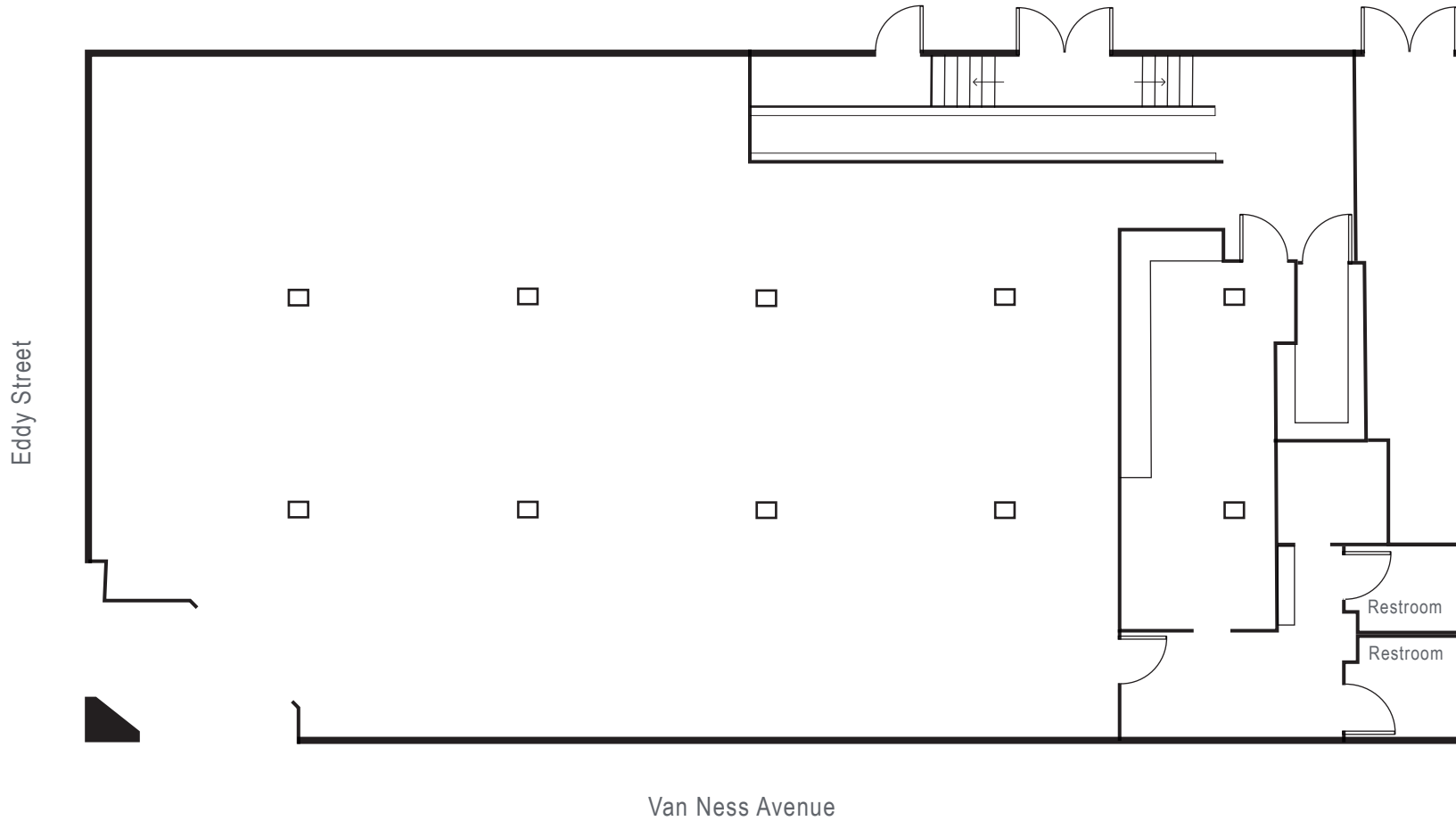

790 VAN NESS AVENUE

LOCATION OVERVIEW

Desirable Opera Plaza location, walkable to nearby amenities, public transportation and to surrounding neighborhoods.



04 MIN to Van Ness Ave &
O'Farrell Muni
14 MIN to Powell St Bart



011 MIN to Mission District
15 MIN to SOMA
17 MIN to Dogpatch District



09 MIN to 280 On-Ramp
09 MIN to 101 On-Ramp

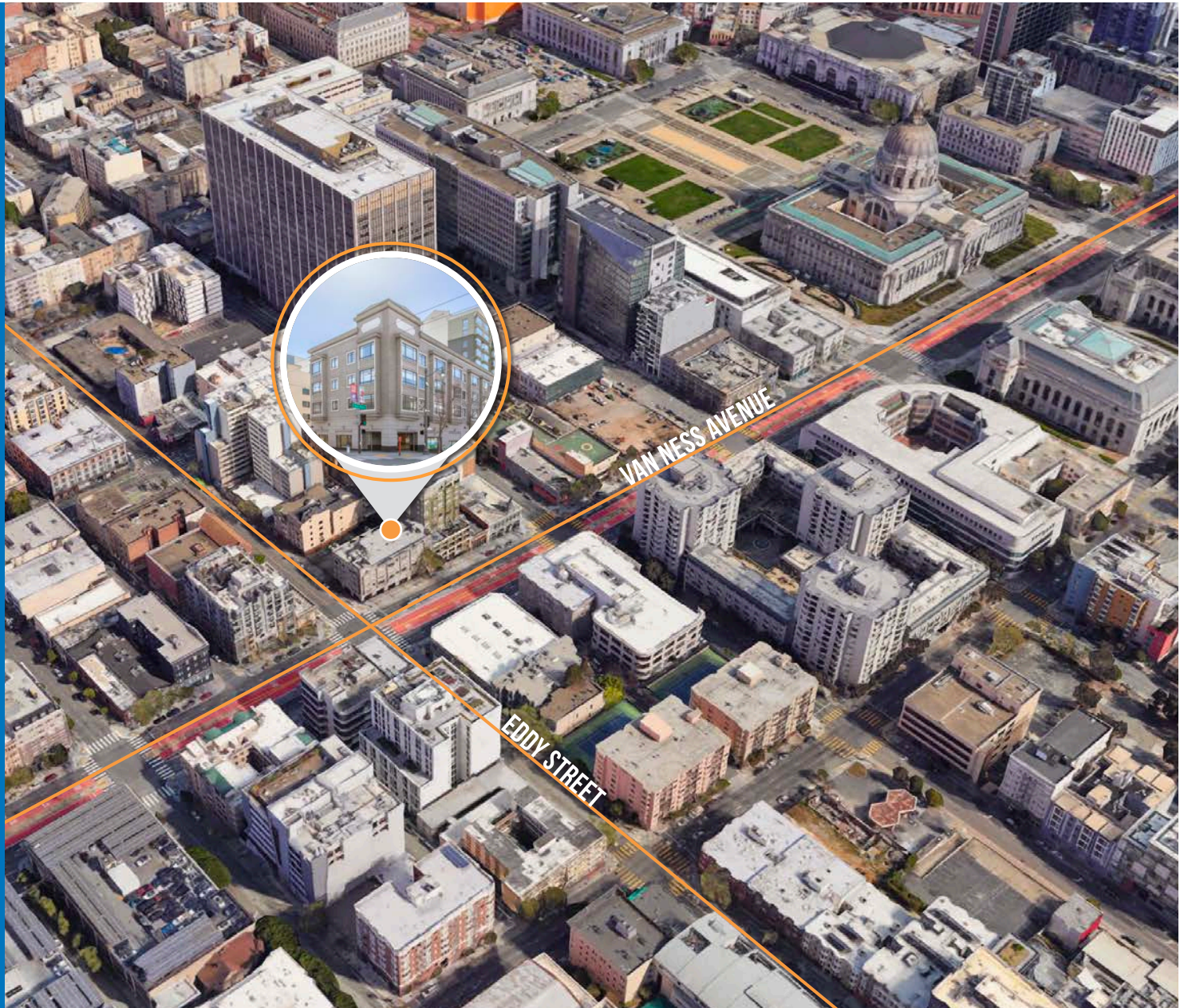

790 VAN NESS AVENUE

NEARBY AMENITIES

- 1.....CVS
- 2.....Hinata
- 3.....Opera Plaza Cinemas
- 4.....Peet's Coffee
- 5.....Max's Opera Cafe
- 6.....Brenda's French Soul Food
- 7.....Son and Garden
- 8.....Zen Yai
- 9.....City College of San Francisco
- 10.....Round Table Pizza
- 11.....MINI of San Francisco
- 12.....Music Exchange Piano Store
- 13.....Tesla
- 14.....Land Rover San Francisco
- 15.....Sutter Health - CPMC/PAMF
- 16.....Burger King
- 17.....Taco Bell
- 18.....Van Ness Market
- 19.....Salty's
- 20.....Books Inc.
- 21.....Emergency Dentist SF
- 22.....Unexpected Era Cafe
- 23.....Van Ness Cafe & Gyros
- 24.....Gladstone Market
- 25.....Metro by T-Mobile
- 26.....SF Federal Credit Union
- 27.....Sam's Bakery
- 28.....Bread & Butter Market & Deli
- 29.....Great American Music Hall
- 30.....Tobacco Barn

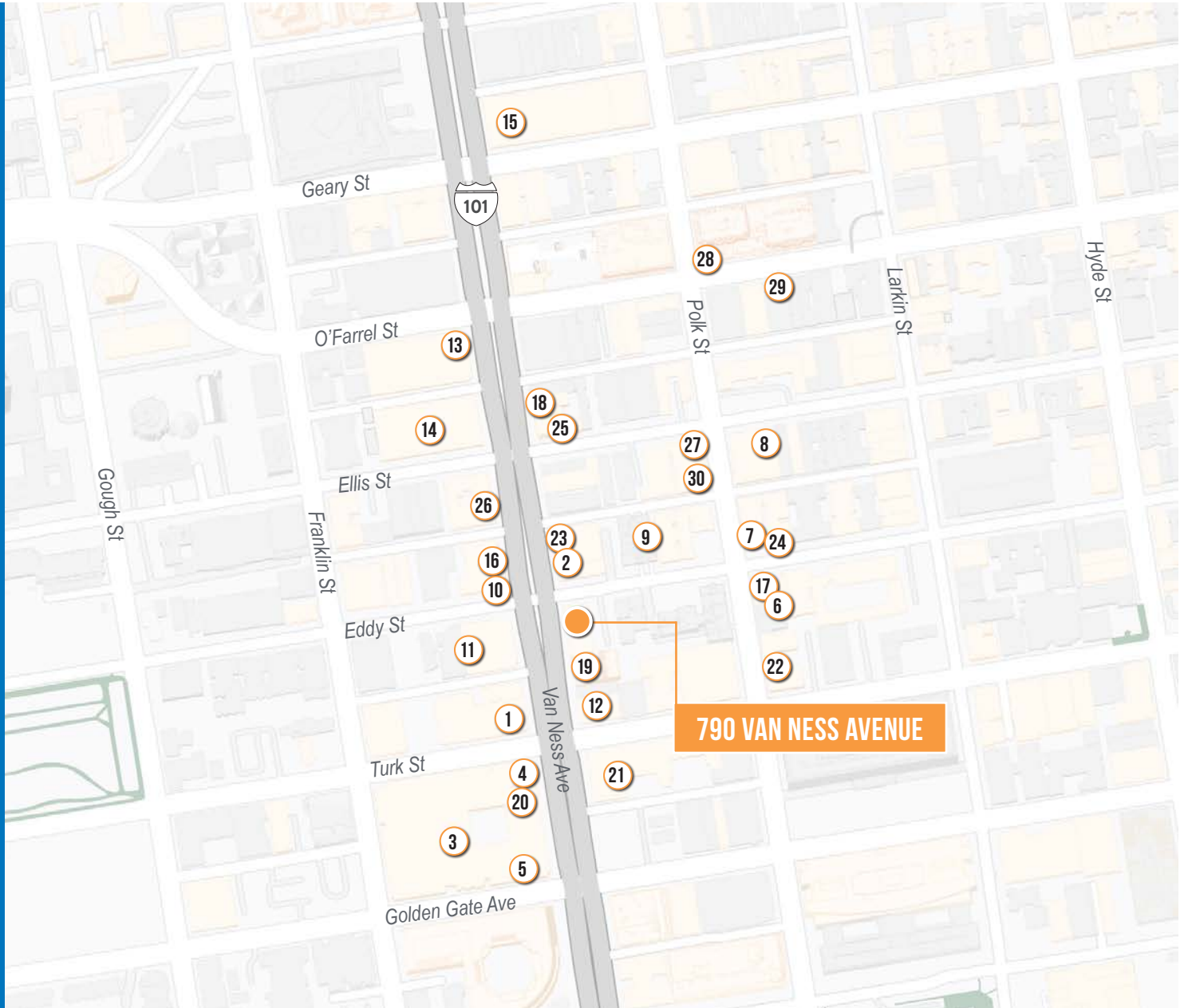

790 VAN NESS AVENUE

790 VAN NESS AVENUE



790 VAN NESS AVENUE



TCP
TOUCHSTONE
COMMERCIAL PARTNERS

JARON ELIOPOULOS

C 415.608.6336
jaron@tcp.com DRE # 01975155

CAMERON TU

C 510.919.8193
cameron@tcp.com DRE # 02100436

ZACH HAUPERT

D 415.539.1121 C 415.812.1219
zhaupert@tcp.com DRE # 01822907

ED MAIELLO

D 415.543.2002 C 415.407.3523
ed@citivisioncommercial.com DRE # 00974529

CITIVISION
COMMERCIAL REAL ESTATE

This document has been prepared by Touchstone Commercial Partners for advertising and general information only. Touchstone Commercial Partners makes no guarantees, representations or warranties of any kind, expressed or implied, regarding the information including, but not limited to, warranties of content, accuracy and reliability. Any interested party should undertake their own inquiries as to the accuracy of the information. Touchstone Commercial Partners excludes unequivocally all inferred or implied terms, conditions and warranties arising out of this document and excludes all liability for loss and damages arising there from. This publication is the copyrighted property of Touchstone Commercial Partners and/or its licensor(s). ©2023. All rights reserved.