

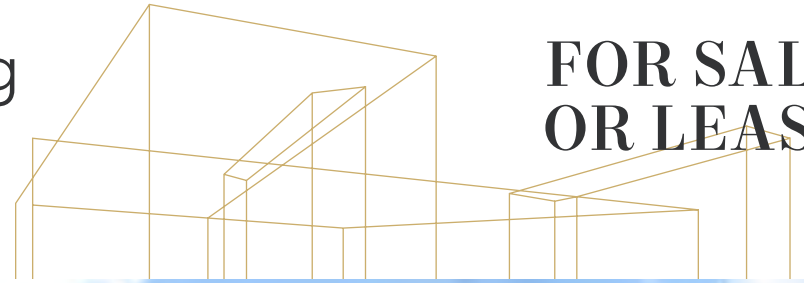

22,707 SF Industrial Building Divisible to 17,707 SF

1205 AVENIDA CHELSEA, VISTA, CA 92081

FOR SALE OR LEASE



**Kidder
Mathews**

For leasing
information
contact

JIM BENSON
760.822.7428
jim.benson@kidder.com
LIC N° 01204845

This information supplied herein is from sources we deem reliable. It is provided without any representation, warranty, or guarantee, expressed or implied as to its accuracy. Prospective Buyer or Tenant should conduct an independent investigation and verification of all matters deemed to be material, including, but not limited to, statements of income and expenses. Consult your attorney, accountant, or other professional advisor.

1205 AVENIDA CHELSEA

22,707 SF Freestanding Industrial Building

FOR SALE OR LEASE | SECURED YARD | GRADE-LEVEL LOADING | DIVISIBLE FLOOR PLAN



22,707 SF FREESTANDING two-story industrial building with 20% office space

FLOOR PLAN DIVISIBLE to 17,707 SF

STORAGE MEZZANINE / potential future open office space

4,500 SF secured & fenced yard

SITUATED ON 1.20 AC of land (52,272 SF)

1,600AMPS, 120-208V, 4W 3-Phase Power

YEAR BUILT 1998

CLEAR HEIGHT 22'

FOUR (4) grade level roll-up doors (12' x 12')

36 PARKING SPACES (expandable into yard area)

FIRE SPRINKLERS .33/3,000 SF

RLI Zoning

DATE AVAILABLE July 1, 2024

LEASE RATE: \$1.35 / SF NNN

SALE PRICE: SUBMIT OFFER

KIDDER.COM

This information supplied herein is from sources we deem reliable. It is provided without any representation, warranty, or guarantee, expressed or implied as to its accuracy. Prospective Buyer or Tenant should conduct an independent investigation and verification of all matters deemed to be material, including, but not limited to, statements of income and expenses. Consult your attorney, accountant, or other professional advisor.

km Kidder Mathews

1205 AVENIDA CHELSEA

22,707 SF Freestanding Industrial Building

FOR SALE OR LEASE | SECURED YARD | GRADE-LEVEL LOADING | DIVISIBLE FLOOR PLAN

Site Plan

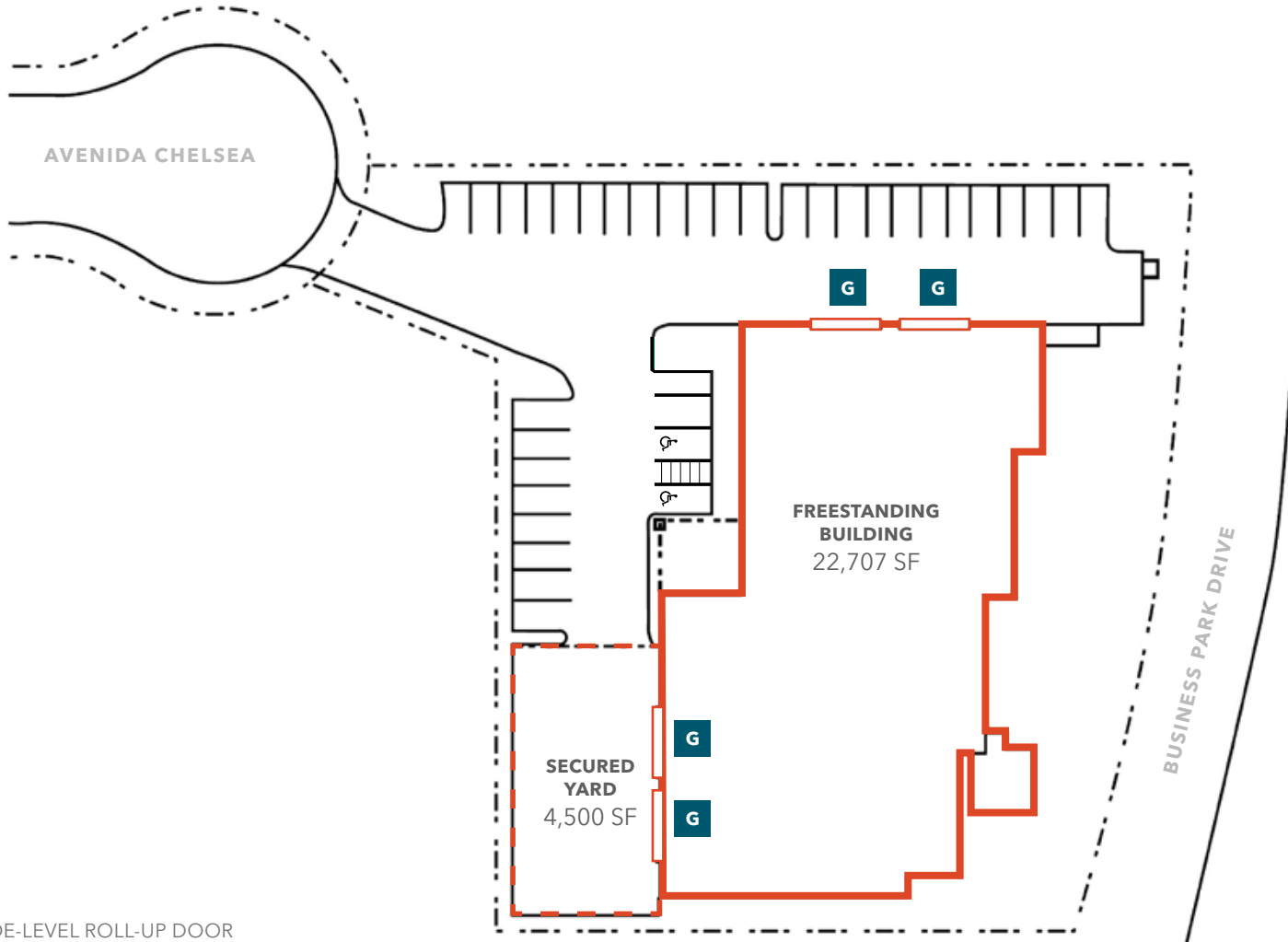

G GRADE-LEVEL ROLL-UP DOOR

KIDDER.COM

This information supplied herein is from sources we deem reliable. It is provided without any representation, warranty, or guarantee, expressed or implied as to its accuracy. Prospective Buyer or Tenant should conduct an independent investigation and verification of all matters deemed to be material, including, but not limited to, statements of income and expenses. Consult your attorney, accountant, or other professional advisor.

km Kidder Mathews

1205 AVENIDA CHELSEA

22,707 SF Freestanding Industrial Building

FOR SALE OR LEASE | SECURED YARD | GRADE-LEVEL LOADING | DIVISIBLE FLOOR PLAN

Floor Plan | Single-Tenant Option

±22,707 SF

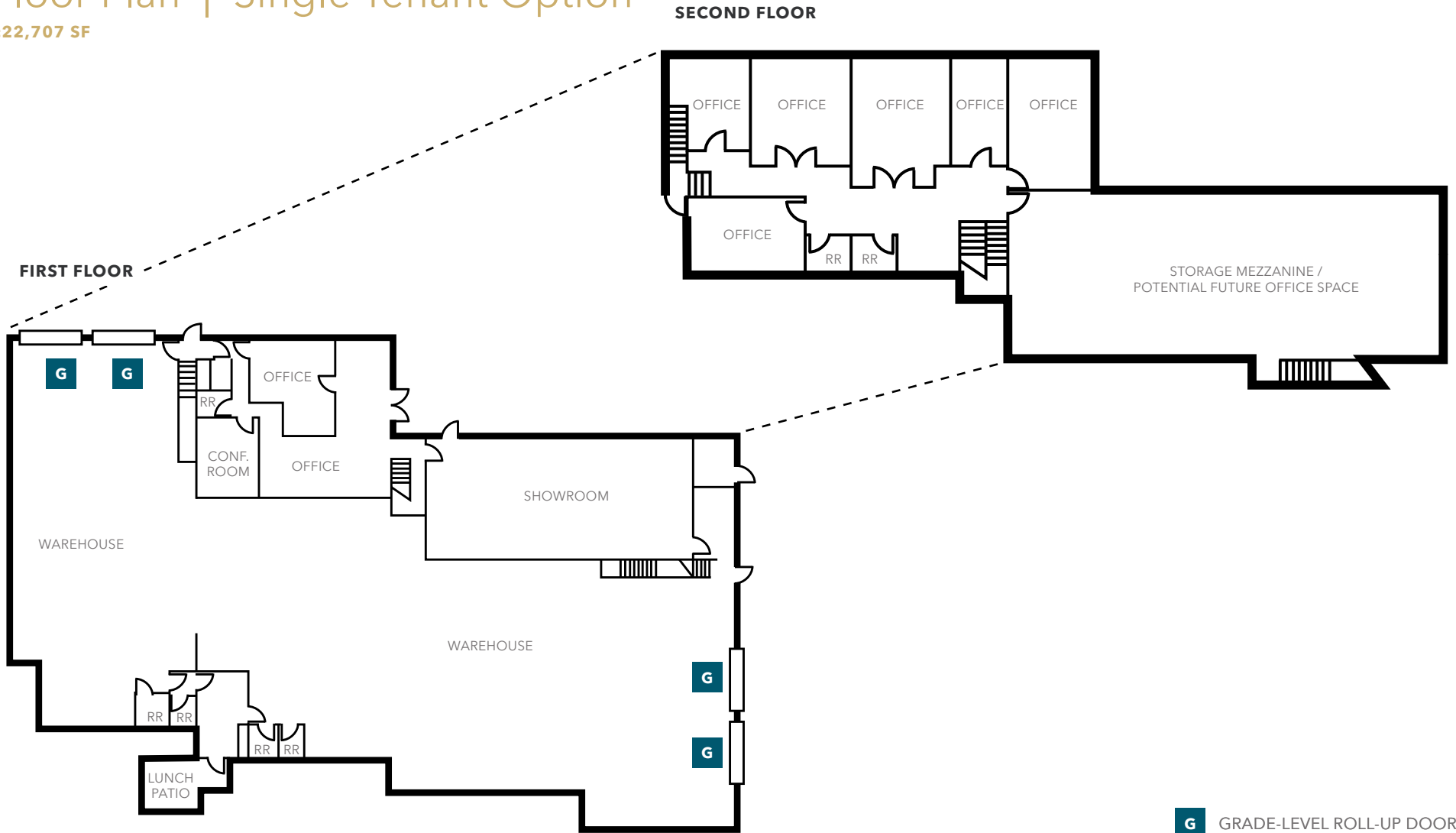

G GRADE-LEVEL ROLL-UP DOOR

KIDDER.COM

This information supplied herein is from sources we deem reliable. It is provided without any representation, warranty, or guarantee, expressed or implied as to its accuracy. Prospective Buyer or Tenant should conduct an independent investigation and verification of all matters deemed to be material, including, but not limited to, statements of income and expenses. Consult your attorney, accountant, or other professional advisor.

km Kidder Mathews

1205 AVENIDA CHELSEA

22,707 SF Freestanding Industrial Building

FOR SALE OR LEASE | SECURED YARD | GRADE-LEVEL LOADING | DIVISIBLE FLOOR PLAN

Floor Plan | Divisibility Option

±17,707 SF

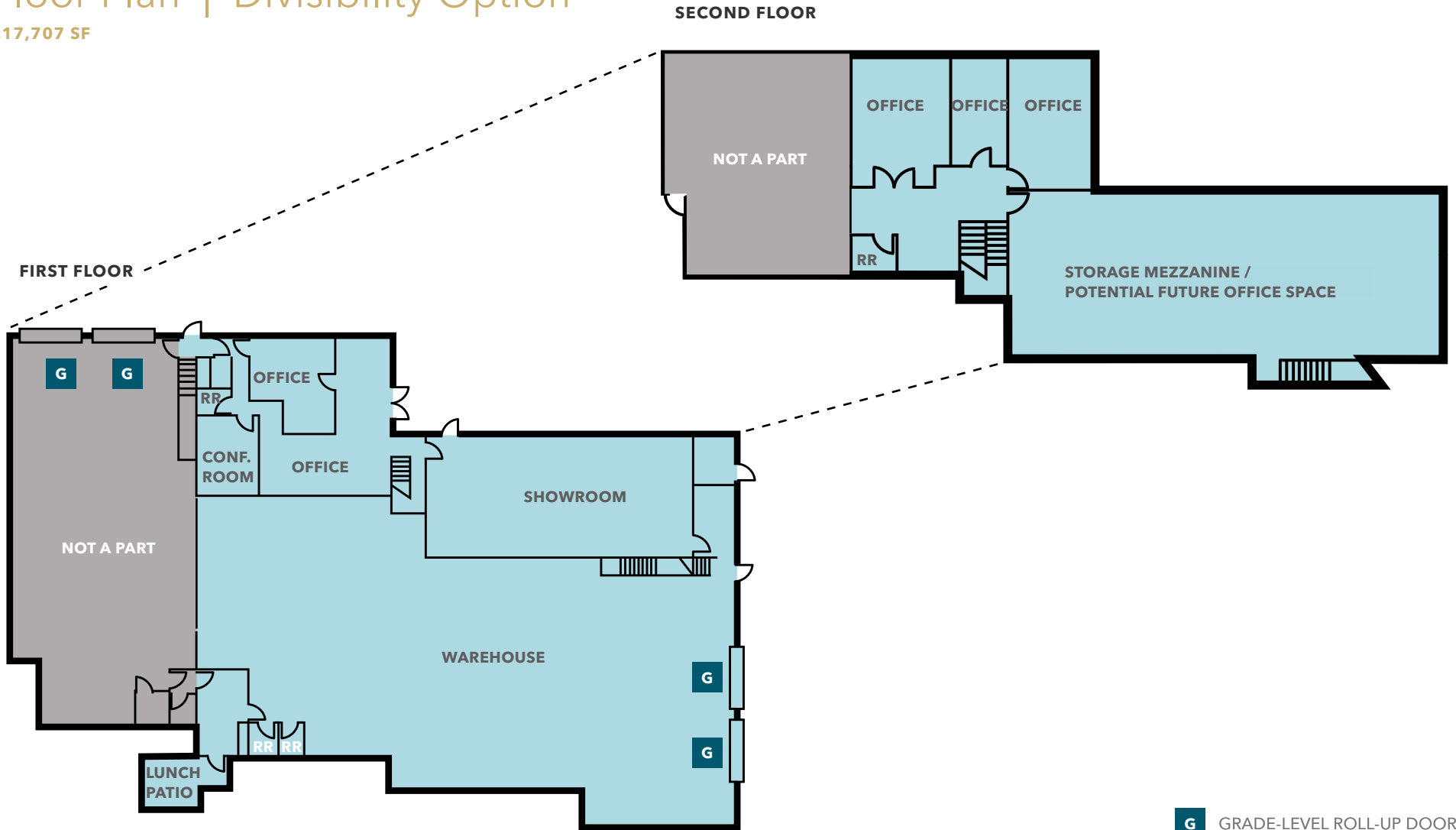

KIDDER.COM

This information supplied herein is from sources we deem reliable. It is provided without any representation, warranty, or guarantee, expressed or implied as to its accuracy. Prospective Buyer or Tenant should conduct an independent investigation and verification of all matters deemed to be material, including, but not limited to, statements of income and expenses. Consult your attorney, accountant, or other professional advisor.

G GRADE-LEVEL ROLL-UP DOOR

km Kidder Mathews

1205 AVENIDA CHELSEA

22,707 SF Freestanding Industrial Building

FOR SALE OR LEASE | SECURED YARD | GRADE-LEVEL LOADING | DIVISIBLE FLOOR PLAN

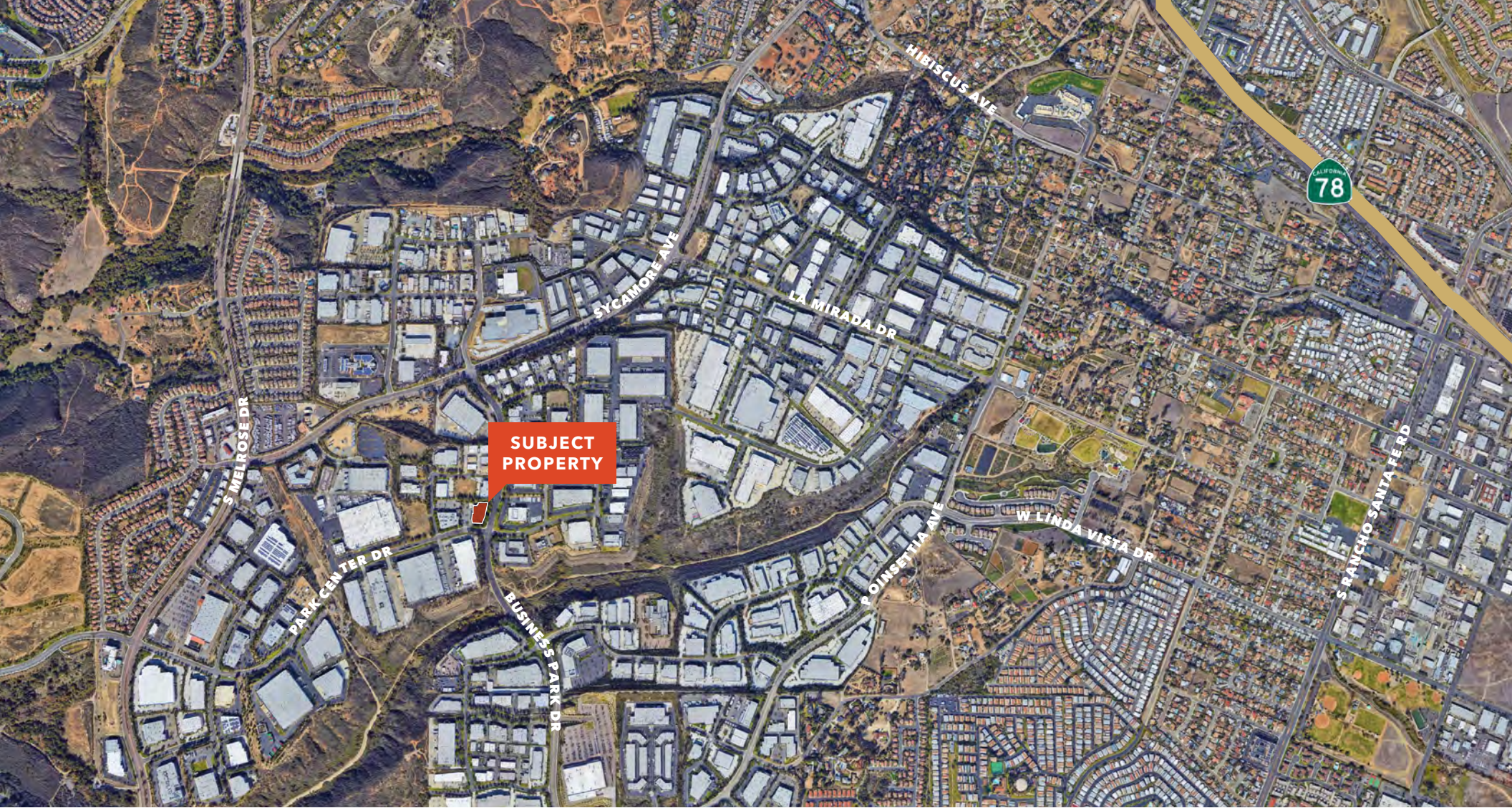

[KIDDER.COM](https://www.kidder.com)

This information supplied herein is from sources we deem reliable. It is provided without any representation, warranty, or guarantee, expressed or implied as to its accuracy. Prospective Buyer or Tenant should conduct an independent investigation and verification of all matters deemed to be material, including, but not limited to, statements of income and expenses. Consult your attorney, accountant, or other professional advisor.

 **Kidder
Mathews**