

850 S. La Brea is a new 53-unit mixed use development in the heart of Mid-Wilshire. This gem includes 3 commercial spaces on the ground floor. One restaurant space (at 1,000 SF), one personal service space (at 1,250 SF) and one retail space (at 819 SF). Bright, airy, open floorplans lead way to a modern, yet elegant design. Busy corner with high foot traffic and vehicle traffic, proximity to shops and restaurants, office and apartment buildings, easy access to freeways.

Introducing 850 La Brea! Brand new development in the heart of Mid-Wilshire

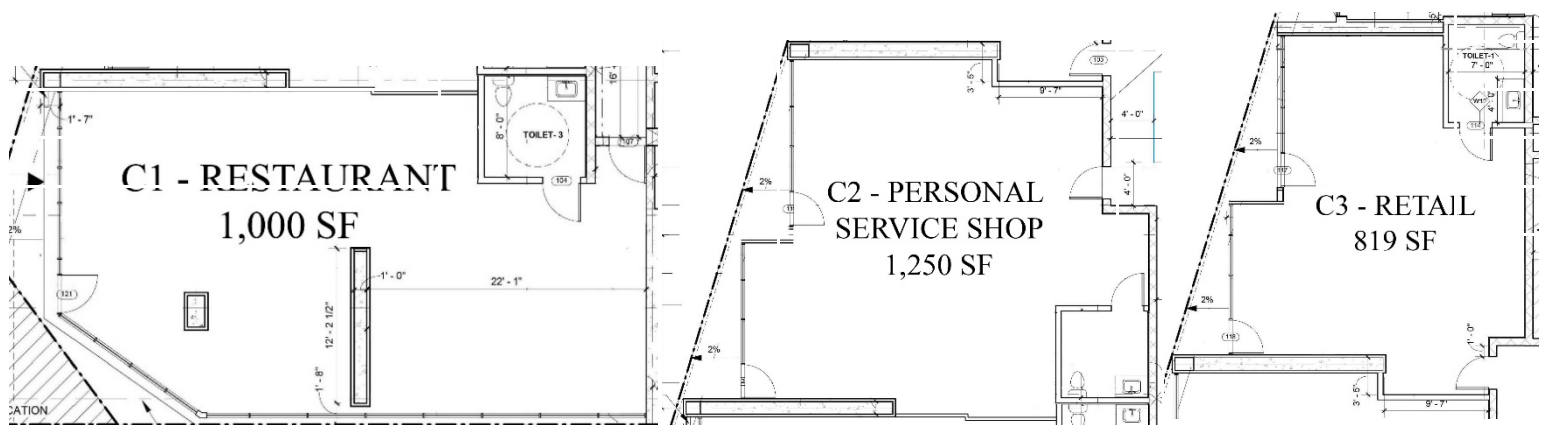

850 South La Brea Ave., Los Angeles, CA. 90036

SPECS

| Space 1 | Space 2 | Space 3 |
|--|--|--|
| Restaurant | Personal Service (hair salon, etc.) | Retail |
| Premises: 1,000 SF | Premises: 1,250 SF | Premises: 819 SF |
| Rent: \$6 NNN | Rent: \$6 NNN | Rent: \$6 NNN |
| Parking: 8 shared spaces behind space | Parking: 8 shared spaces behind space | Parking: 8 shared spaces behind space |

Please text to arrange a private viewing **310-773-4334**