

## TWO-STORY, 145,000 SF CLASS A OFFICE SPACES AVAILABLE FROM 2,000 TO 53,109 SF



Premier two-story, multi-tenant office space with top-tier amenities and features. Prime location just minutes from I-41/I-43, Austin Straubel International Airport, Lambeau Field, and all of Green Bay and De Pere's retail, dining, and entertainment options. The beautiful setting on over 25 acres, top tier amenities, flexible leasing options and high visibility of this building will elevate any business.

### Property Highlights

**Strategic Location:** Minutes from I-41/I-43, Austin Straubel International Airport, Lambeau Field, and all of Green Bay's retail, dining, and entertainment options

**Top-Tier Amenities:** Fitness center with a sauna and pickleball courts, plus a café, outdoor patio and walking trails

**Flexible Leasing Options:** Spaces available from 1,500 to 100,000 SF, ideal for businesses of all sizes

### Property Features

- Beautiful setting on over 25 acres
- Class A aesthetics and design
- Two-story building with elevator access
- Ample parking
- Highly visible monument and pylon signage options
- Advanced fire safety systems
- Loading dock

For leasing, contact:

**LAUREN LEROY** | 920.888.7446 | [lauren@parkplace-holdings.com](mailto:lauren@parkplace-holdings.com)

3500 Packerland Dr.  
De Pere, WI 54115  
[www.parkplace-holdings.com](http://www.parkplace-holdings.com)

## TWO-STORY, 145,000 SF CLASS A OFFICE SPACES AVAILABLE FROM 2,000 TO 53,109 SF

1ST FLOOR PLAN

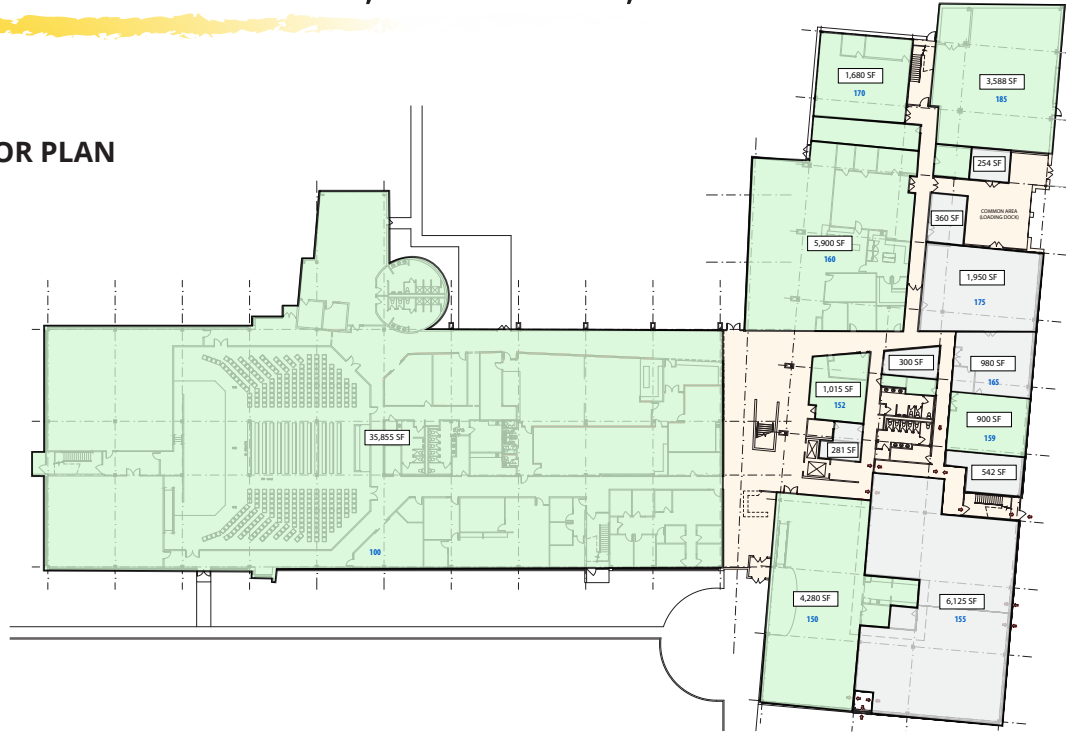

2ND FLOOR PLAN

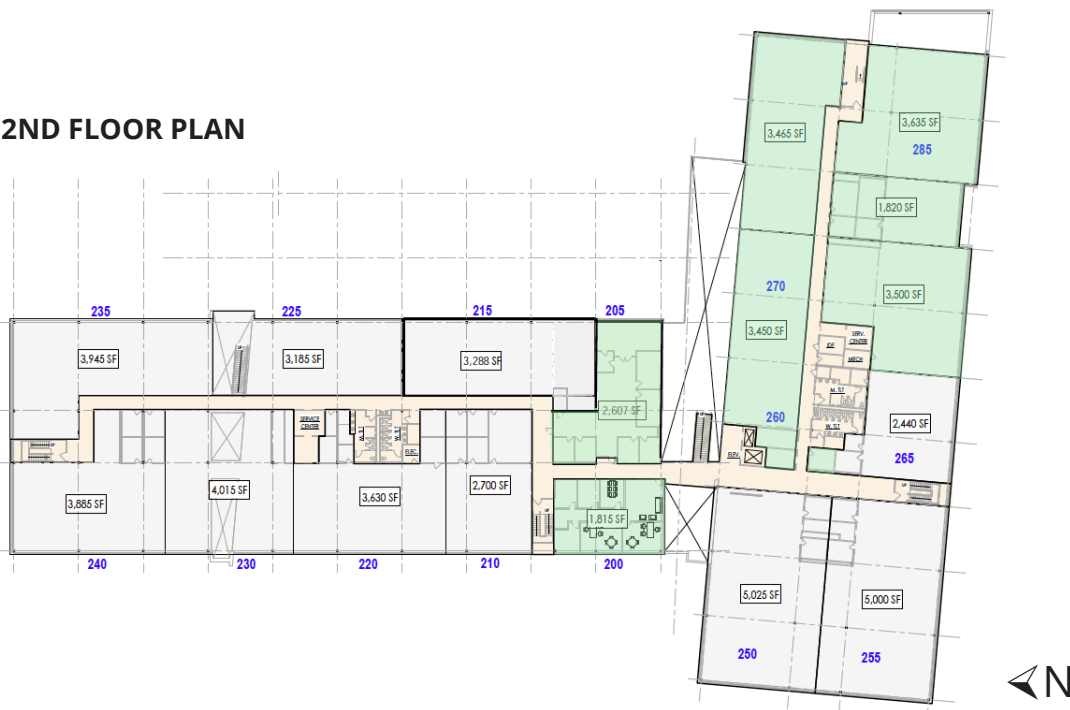

For leasing, contact:

**LAUREN LEROY** | 920.888.7446 | [lauren@parkplace-holdings.com](mailto:lauren@parkplace-holdings.com)

3500 Packerland Dr.  
De Pere, WI 54115  
[www.parkplace-holdings.com](http://www.parkplace-holdings.com)