



54 MALUNIU

RETAIL FOR LEASE
KAILUA, HAWAII



Rendering is for illustrative purposes only, may not be accurately depicted and may be changed at any time.



A KAILUA GEM

Nestled in the heart of Kailua, this boutique commercial space benefits from its proximity to world famous beaches and a vibrant local community. The surrounding neighborhood exudes a laid-back yet upscale vibe, drawing in residents and tourists alike.

Kailua's main thoroughfare, known for its boutique shops, cafes, and art galleries, is where this property finds its home. Nearby businesses include Whole Foods Market, Foodland and Target.



Rendering is for illustrative purposes only, may not be accurately depicted and may be changed at any time.



PROPERTY SUMMARY

Area	Kailua
TMK Number	1-4-3-031-027
Available Space	Space 2 (780 SF)
Base Rent	Upon Request
Operating Expenses	\$0.80 psf/mo
Term	3-7 years
Zoning	B-2

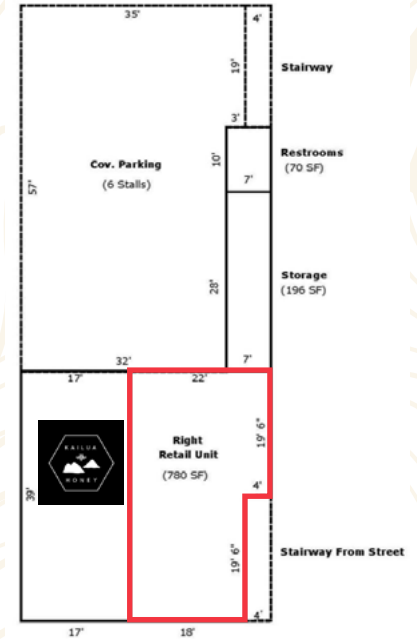



Aikahi Park Shopping Center

SAFeway

Demographics	1-Mile	3-Mile	5-Mile
Population	16,771	49,114	98,102
Households	6,233	17,016	31,258
Avg HH Income	\$152,877	\$174,533	\$159,718
Bachelor Degree+	24.4%	27.0%	24.6%

54 MALUNIUI

Kailua Town

Foodland Times

WHOLE FOODS MARKET *Longs Drugs*

UFC GYM *Down to Earth*

Kailua Beach Center

TARGET

Windward T&C Plaza I

SAFeway

Windward T&C Plaza II

BEDMART

Firestone



Kaleheo Ave

Kuulei Rd

Ulunui Rd

Oneawa St



PROPERTY HIGHLIGHTS

- Prime location within Kailua town and in close proximity to unique eateries, retail, office buildings and residential community
- Flexible layout suited for a cafe, art gallery, wellness studio or boutique
- Highly visible space that can appeal to visitors and locals
- Ample street parking available

Rendering is for illustrative purposes only, may not be accurately depicted and may be changed at any time.



Rendering is for illustrative purposes only, may not be accurately depicted and may be changed at any time.

CONTACT

Janna Frash (S)
Associate Vice President
Office Services Division
Lic# RS-80222
808 230 3794
janna.frash@colliers.com

Emalia Pietsch (S)
Senior Vice President
Retail Services Division
Lic# RS-70893
808 523 9710
emalia.pietsch@colliers.com



220 S. King Street, Suite 1800
Honolulu, Hawaii 96813
808 524 2666
colliers.com