

# INDUSTRIAL BUILDING AVAILABLE

350 S ANDERSON ST | LOS ANGELES, CA 90021

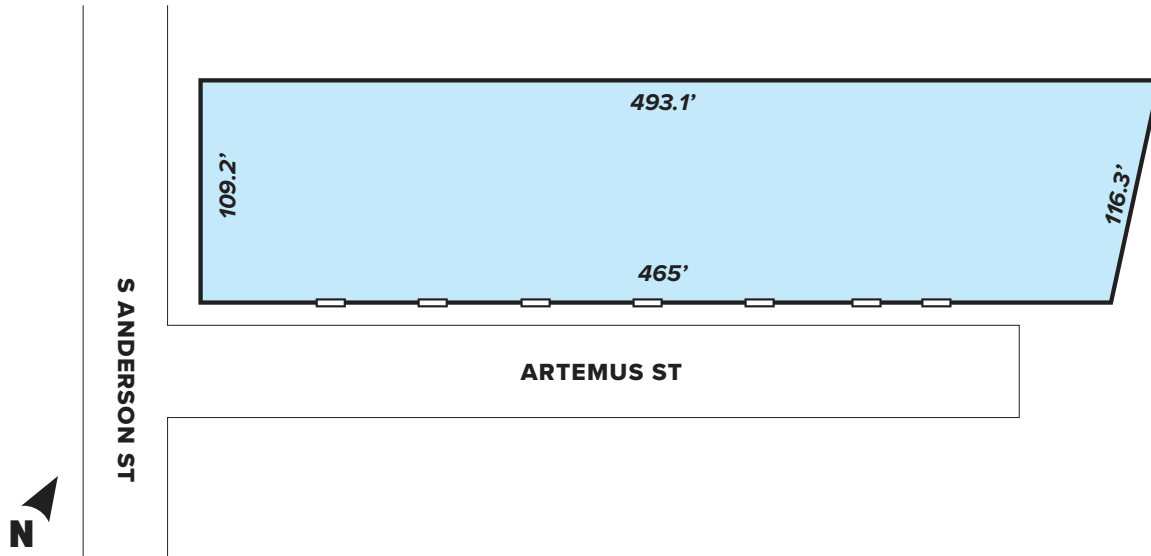

## BASEMENT

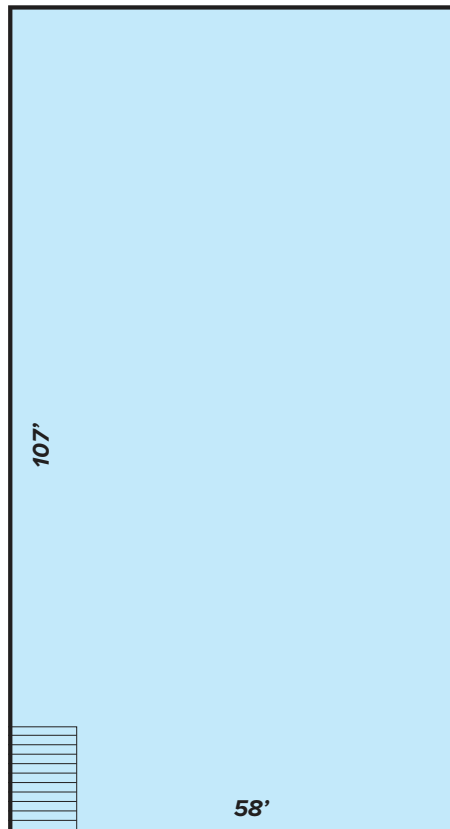

## MEZZANINE

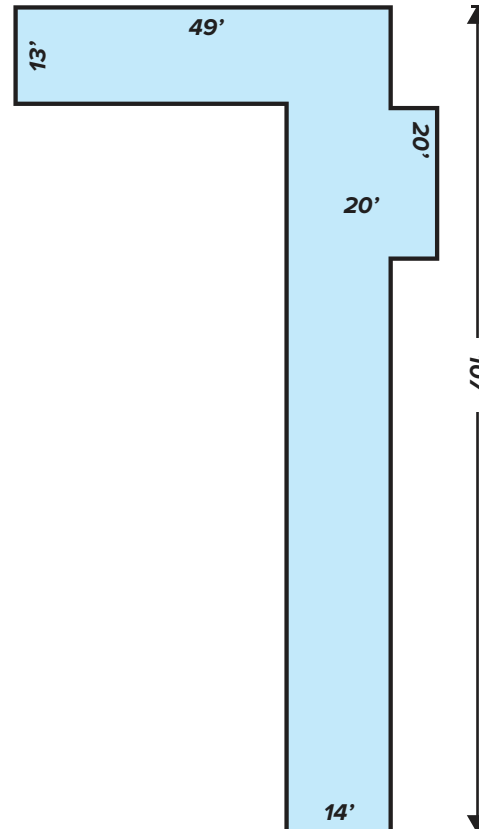

<b>BUILDING SF</b>	53,260
<b>BASEMENT SF</b>	6,206
<b>MEZZANINE SF</b>	2,073
<b>TOTAL SF</b>	61,539

**NOTE:** Drawing not to scale. All measurements and sizes are approximate. Lessee to Verify

FOR MORE INFORMATION, PLEASE CONTACT

### JACK R. CLINE, JR.

President | LIC NO 00854279  
e jcline@lee-associates.com  
c 213.590.3512

### EVAN JURGENSEN

Senior Vice President | LIC NO 01967347  
e ejurgensen@lee-associates.com  
o 323.922.3733