

# RETAIL FOR LEASE



15334 WHITTIER BOULEVARD  
WHITTIER, CA 90603

## Property Features:

- One Remaining Unit, Suite 3: 2,033 Square Feet
- Great for Office or Retail
- High Traffic Location; Monument Signage
- Premier Retail Destination in Whittier
- Adjacent to Whittwood Towne Center: Target, Kohl's, Old Navy Anchored Center
- Brand New Development Including Home Goods and ULTA Across Whittier Boulevard

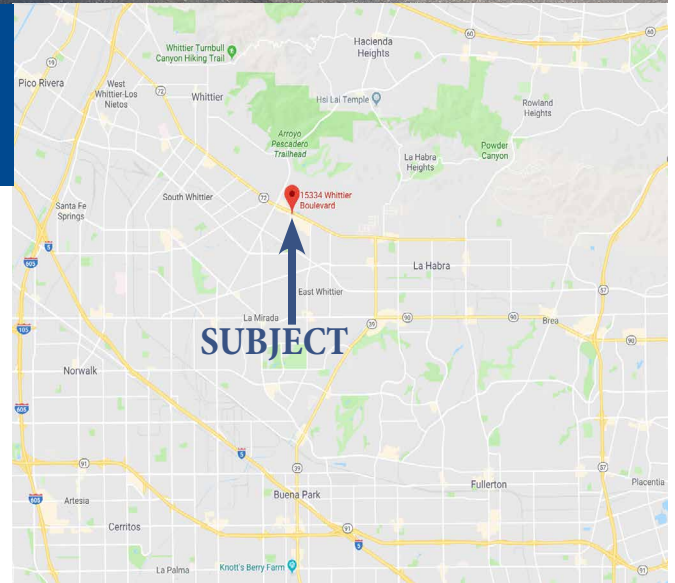

For More Information, Contact:

**Tyler Portman**

Direct: (562) 762 - 3152

[tyler@gmpropertiesinc.com](mailto:tyler@gmpropertiesinc.com)

**Dustin Wheelan**

Direct: (562) 762 - 3120

[dustin@gmpropertiesinc.com](mailto:dustin@gmpropertiesinc.com)

**Ben Greer, CCIM**

Direct: (562) 762 - 3104

[ben@gmpropertiesinc.com](mailto:ben@gmpropertiesinc.com)



The information contained herein was obtained from sources we believe to be accurate, but is for information purposes only. Potential tenants are advised to verify and perform its own due diligence. GM Properties or the Owner does not represent or warrant any of this information. CalBRE #01238514