

NOTES:

1. THE BOUNDARY DATA SHOWN HEREON IS BASED ON A CURRENT FIELD SURVEY.
2. THIS PLAT REPRESENTS A SURVEY OF THE EXTERIOR BOUNDARIES OF THE PARCEL(S) SHOWN HEREON AND THERE IS NO INTENT TO EXTINGUISH OR COMBINE ANY EXISTING PARCELS OF RECORD.
3. NO TITLE REPORT FURNISHED. NO EASEMENTS SHOWN. THIS PROPERTY IS SUBJECT TO ANY CONDITIONS, UTILITIES, EASEMENTS AND/OR COVENANTS THAT MAY EXIST.

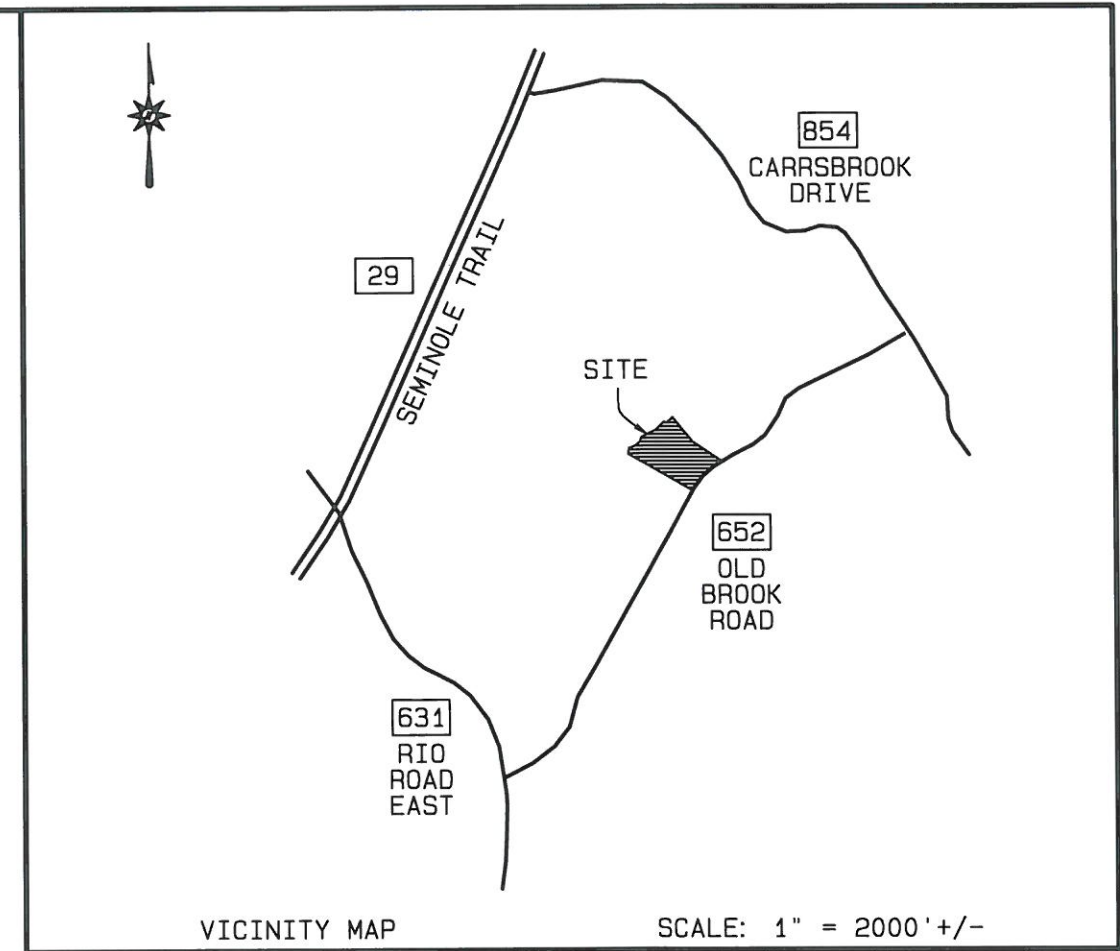

BOUNDARY SURVEY PLAT  
7.96 ACRES  
THE PROPERTY OF THE MINTER FAMILY REVOCABLE LIVING TRUST  
LOCATED ON STATE ROUTE 652 (OLD BROOK ROAD)  
RIO MAGISTERIAL DISTRICT  
ALBEMARLE COUNTY, VIRGINIA  
SCALE: 1" = 100'      DATE: SEPTEMBER 6, 2023  
REVISED: SEPTEMBER 26, 2023  
(ONLY TO SHOW CEMETERY)

FOR:  
THE MINTER FAMILY REVOCABLE LIVING TRUST

ROGER W. RAY & ASSOC., INC.  
663 BERKMAR COURT  
CHARLOTTESVILLE, VIRGINIA 22901  
TELEPHONE: (434) 293-3195  
RAYSURVEYING.COM



GL

