

# FORD ROAD CANTON, MICHIGAN

LAND FOR SALE  
20.00 Acres Available

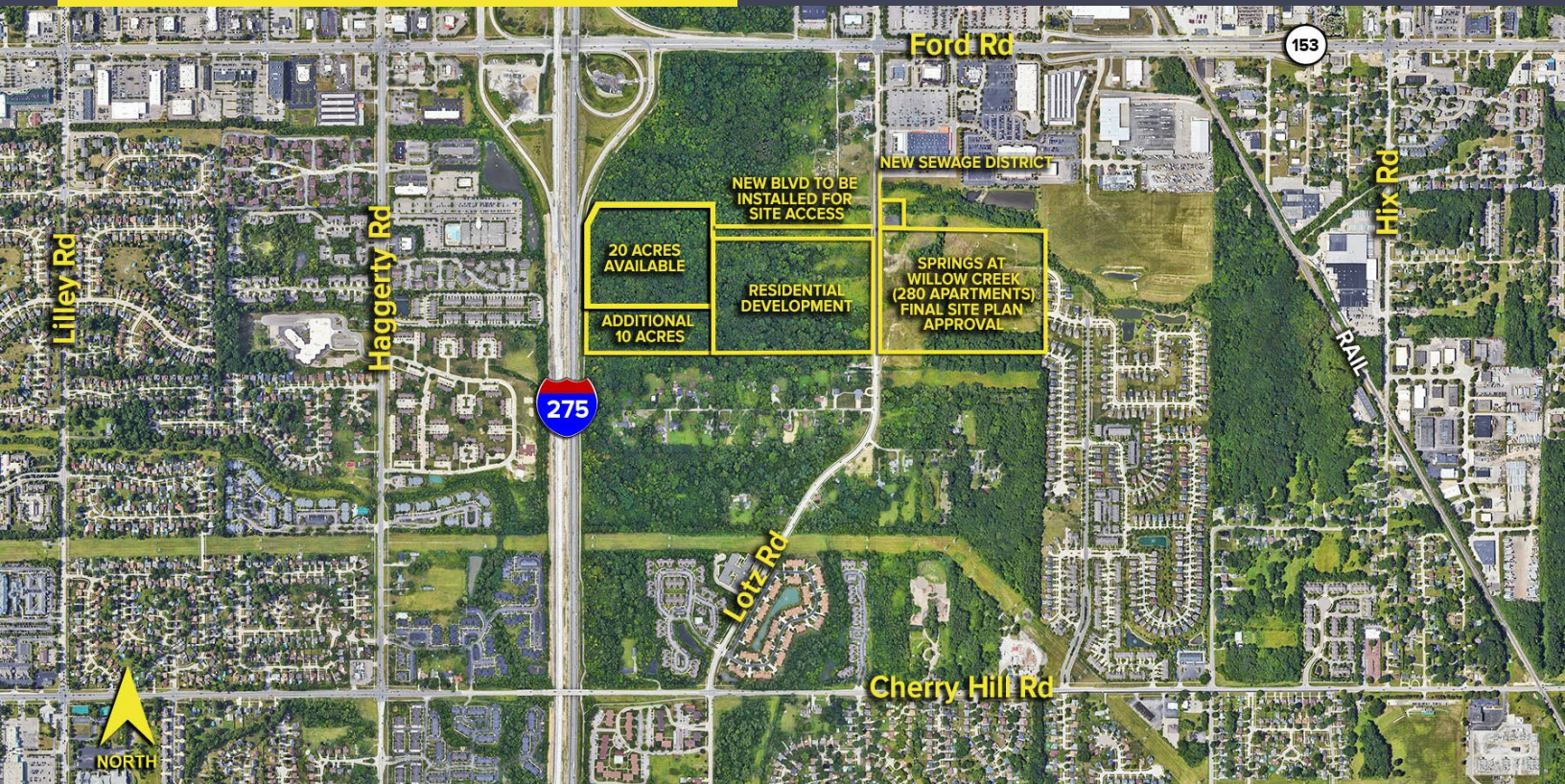

**SIGNATURE  
ASSOCIATES**  
KNOW SIGNATURE | KNOW RESULTS



## PROPERTY FEATURES

- 20.00 acres available
- Zoned Mid-Rise Development
- Significant I-275 frontage
- High Ford Road visibility
- Adjacent to proposed 55-acre development including, a new hotel, Chick-fil-A, & Portillo's
- Perfect for residential development
- Sale price: \$2,100,000 (\$105,000/acre)



For more information, please contact:

**DRAKE FILIPPIS**

(248) 799 3161

[dfilippis@signatureassociates.com](mailto:dfilippis@signatureassociates.com)

**KRIS PAWLOSKI**

(248) 359 3801

[kpawlowski@signatureassociates.com](mailto:kpawlowski@signatureassociates.com)

**SIGNATURE ASSOCIATES**

One Towne Square, Suite 1200

Southfield, MI 48076

[www.signatureassociates.com](http://www.signatureassociates.com)

Information is subject to verification and no liability for errors or omissions is assumed. Price is subject to change and listing withdrawal.

# Ford Road – Canton, Michigan

## Land For Sale

20.00  
Acres  
AVAILABLE

### Site Plan

