

FOR SUBLEASE
64,800 SF



PROLOGIS LAS VEGAS CORPORATE CENTER
DISTRIBUTION - BUILDING 7

4031 INDUSTRIAL CENTER DR, NORTH LAS VEGAS, NV 89030

PROPERTY DESCRIPTION

4031 Industrial Center Dr., Ste. 700-703 is a $\pm 64,800$ SF rear-loaded, fully sprinklered office/warehouse suite. The space includes seventeen (17) dock-high doors, three (3) ramp-to-grade doors, and 277/480V 3-phase power (to be verified). The suite features multiple office pods totaling $\pm 4,509$ SF, along with ample auto parking.

HIGHLIGHTS

- Sublease through 12/31/2026
- $\pm 64,800$ SF rear-loaded distribution warehouse
- Four (4) office pods totaling $\pm 4,509$ SF
- 24' minimum clear height
- ESFR sprinkler system
- Scrim insulation at roof deck
- 277/480V, 3-phase power (to be verified)
- Seventeen (17) dock-high doors
- Three (3) ramp-to-grade doors
- Situated on a ± 5.32 -acre parcel
- M-2 zoning (City of North Las Vegas)





AREA DESCRIPTION

Strategically positioned in the heart of North Las Vegas within Prologis' Las Vegas Corporate Center #7, 4031 Industrial Center Dr. offers excellent access to the I-15/Craig Road interchange and is less than 30 minutes from the Las Vegas Strip and Harry Reid International Airport.

LOCATION MAP
64,800 SF

SITE PLAN

64,800 SF

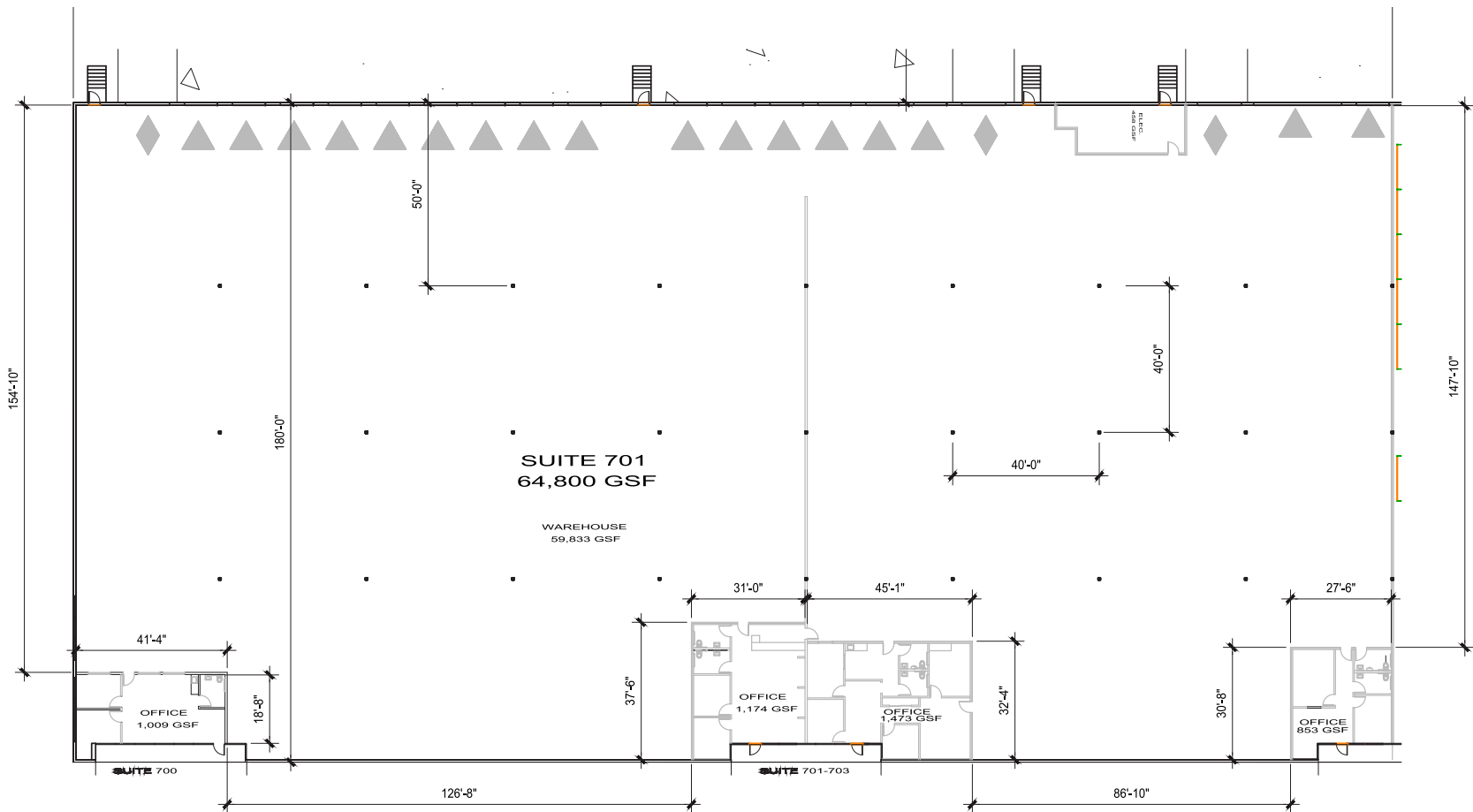

FOR MORE INFORMATION **PLEASE CONTACT**

ALMA E. CUEVAS, SIOR

Managing Director
+1 702 303 4412
alma.cuevas@cushwake.com
LIC #S.0180089.LLC

JASON GRIFFIS, SIOR

Managing Director
+1 702 205 3861
jason.griffis@cushwake.com
LIC #S.0178374

CAMILA ROSALES

Director
+1 702 609 3567
camilla.rosales@cushwake.com
LIC #S.0183916

MICHAEL SCHER

Senior Associate
+1 702 688 6893
michael.scher@cushwake.com
LIC #S.0189923

10845 Griffith Peak Dr., Suite 160
Las Vegas, NV 89135
+1 702 796 7900
cushmanwakfield.com



©2025 Cushman & Wakefield. All rights reserved. The information contained in this communication is strictly confidential. This information has been obtained from sources believed to be reliable but has not been verified. NO WARRANTY OR REPRESENTATION, EXPRESS OR IMPLIED, IS MADE AS TO THE CONDITION OF THE PROPERTY (OR PROPERTIES) REFERENCED HEREIN OR AS TO THE ACCURACY OR COMPLETENESS OF THE INFORMATION CONTAINED HEREIN, AND SAME IS SUBMITTED SUBJECT TO ERRORS, OMISSIONS, CHANGE OF PRICE, RENTAL OR OTHER CONDITIONS, WITHDRAWAL WITHOUT NOTICE, AND TO ANY SPECIAL LISTING CONDITIONS IMPOSED BY THE PROPERTY OWNER(S). ANY PROJECTIONS, OPINIONS OR ESTIMATES ARE SUBJECT TO UNCERTAINTY AND DO NOT SIGNIFY CURRENT OR FUTURE PROPERTY PERFORMANCE.