

THE LOGAN

5110 TELEGRAPH AVE.

Join Whole Foods and Amazon Locker - Now Open!

Retail Spaces Remaining: 2,235 SF / Can Be Demised Into Two Spaces: 963 SF and 1,272 SF
Includes Sidewalk Seating and Covered Patio Areas

THE
LOGAN

5110

CHROMATA
RETAIL

beta.

ADDRESS 5110 Telegraph Avenue

AVAILABLE SPACE 963 SF / 1,272 SF or 2,235 SF

RENTAL RATE Negotiable

NEIGHBORHOOD HIGHLIGHTS

As one of the hottest neighborhoods in Oakland, the thriving Temescal District was where the revitalization of Oakland's storied food scene took off. Restaurants such as Pizzaiolo, Burma Superstar and Bakesale Betty are long-time favorites joined more recently by Hawking Bird, Cholita Linda and Marufuku Ramen, along with an array of bars, tap rooms and local shops.

Temescal is a highly sought after area between Uptown and Rockridge, and continues to develop with high density mixed-use residential and retail.

This project's 204 residential apartments over a 27,500 SF Whole Foods further enhance Temescal's dynamic mix of both national and locally owned retailers and restaurants.



SITE PLAN

Retail 1: 3,600 SF - LEASED - Amazon Locker

Retail 2: 963 SF / 1,272 SF or 2,235 SF

Retail 3: 27,500 SF - LEASED - Whole Foods

Walk Score: 91

Transit Score: 66

Bike Score: 96

Pedestrian thoroughfare through the project

Easy freeway access to HWY 24 / I-880

8 Min walk to Rockridge BART

10 Min walk to MacArthur BART



SPECS

- Corner of Telegraph and Claremont Ave.
- Great window frontage
- 12' ceilings
- Patio space available

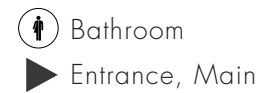
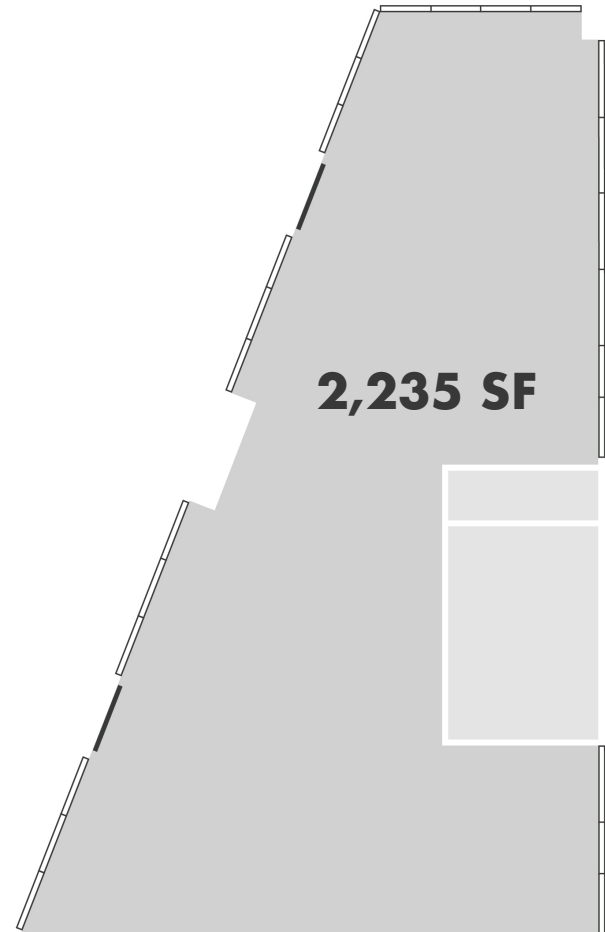
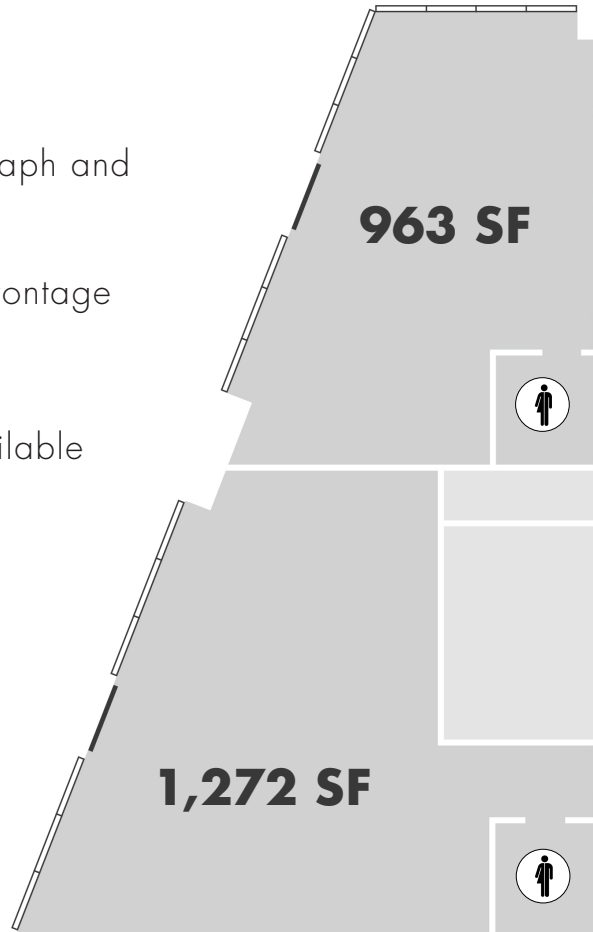

**RESTAURANTS + RETAIL
& RESIDENTIAL**

- Whole Foods (at site)
- Bakesale Betty
- Rose's Taproom
- Cholita Linda
- Peets
- Noah's Bagels
- Rockridge Market Hall
- Julio Empanada Kitchen
- FOB Kitchen
- Pizzaiolo
- Burma Superstar
- Safeway
- Shoe Palace

- 4700 Telegraph - 48 Units
- Temescal Apartments - 130 Units
- MacArthur Station - 657 Units
- The Amador - 25 Units
- Temescal MUSE - 24 Units

DEMOGRAPHICS

Lively neighborhood surrounded by restaurants, shopping and residential with more than 1,200 units in planning

2020 Daytime population /
3 Miles: 331,343

2020 Estimated Population /
3 Miles: 283,413



Jamie Flaherty-Evans
510-334-8606
jamie@chromataRE.com
DRE Lic # 01432663

Solomon Ets-Hokin
510-427-0096
Solomon.EtsHokin@betaagency.com
DRE Lic #01248264

CHROMATA
RETAIL
beta.

