

# FORMER MCDONALD'S



## FOR LEASE

5432 Portage Road / Portage, MI



RETAIL OPPORTUNITY

# FORMER MCDONALD'S



## Address

5432 Portage Road  
Portage, MI 49002

## Features

At the signalized intersection of Portage Road and Winters Drive, is a freestanding former McDonald's. The current building was completely updated in 2018 and comes equipped with a drive-thru. Pylon signage available.

## Availability

5,268 SF  
1.37 AC

With the property being located directly across from the entrance to the Battle Creek/Kalamazoo International Airport, it sees over 20,000 cars per day.

Opportunities include leasing the current building or ground leasing the 1.37 acre parcel.

## Area Tenants



## Demographics (2024)

	1 MILE	3 MILES	5 MILES
POPULATION	2,605	46,557	124,548
HOUSEHOLDS	1,118	20,164	51,149
AVG HOUSEHOLD INCOME	\$84,644	\$83,628	\$90,078
DAYTIME POPULATION	4,203	63,665	160,371

# FORMER MCDONALD'S

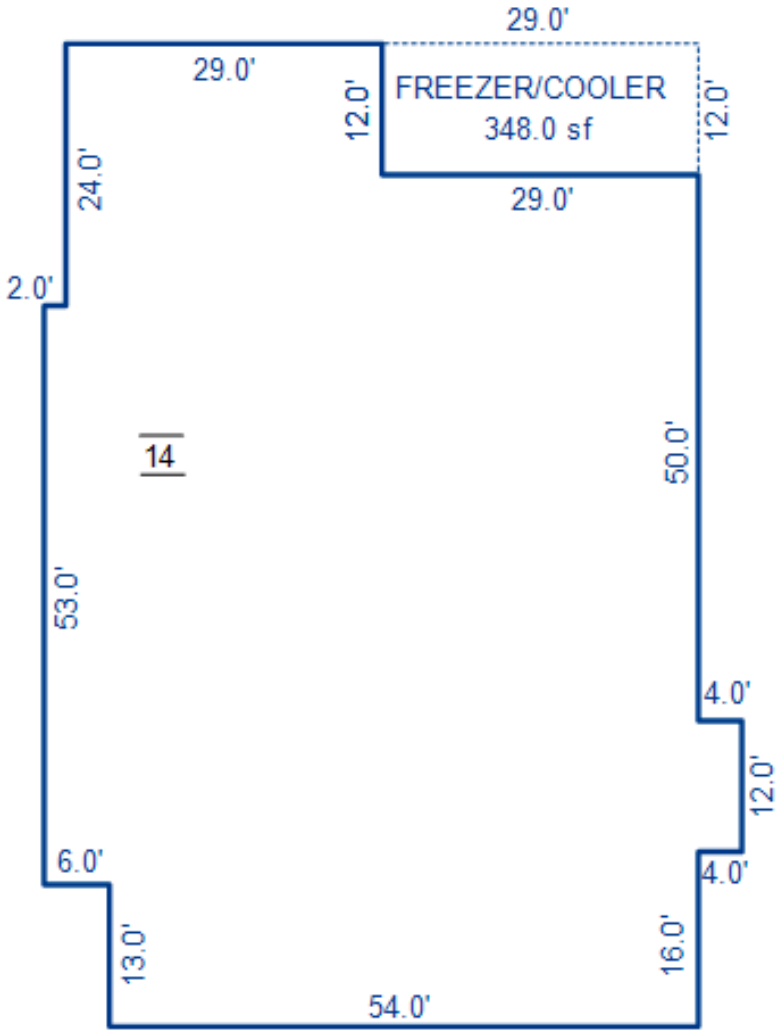



# FORMER MCDONALD'S



Field's FABRICS  
AdvisaCare Home Health & Hospice  
Angelo's ITALIAN EATERY  
BIGGBY COFFEE  
COSMO PROF



# FORMER MCDONALD'S





# FORMER MCDONALD'S



George  
Sheena

Mid-America Real Estate -  
Michigan, Inc.  
T: 248.855.6800  
[GSheena@MidAmericaGrp.com](mailto:GSheena@MidAmericaGrp.com)

Jared  
Gell

Mid-America Real Estate -  
Michigan, Inc.  
T: 248.855.6800  
[JGell@MidAmericaGrp.com](mailto:JGell@MidAmericaGrp.com)



38500 Woodward Ave, Suite 100  
Bloomfield Hills, Michigan 48304  
248.855.6800  
[MidAmericaGrp.com](http://MidAmericaGrp.com)

CONTACT