

PENN TOWNSHIP FLEX/OFFICE SPACE FOR LEASE

2224 BOYD ROAD, EXPORT, PA

Rendering



BUILDING FEATURES:

- BRAND NEW BUILDING w/ spaces in Shell Condition
- 3,500 - 8,000 SF Available
- Use: Flex/Office/Warehouse
- Zoning: Industrial Commerce
- Available 2nd Quarter of 2025
- Corner Exposure
- Penn Township
- Rates start at \$15/SF, NNN

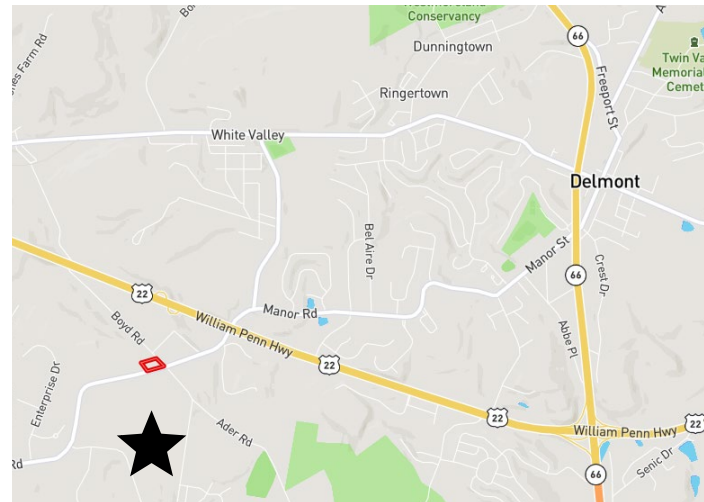

**Guardian
Realty**
Solutions, LLC

Cynthia L. Whiteman
Sales Associate
412.297.3567 mobile
cwhiteman@gcmsi.com
RS357888

Christina M. Bucciero
President/Broker of Record
412.445.5134 mobile
cbucciero@gcmsi.com
RM #423313 RB #068430

www.guardianrealtysolutions.com

*No warranty or representation express or implied, is made as to the accuracy of the information contained herein, and same is submitted subject to errors, change of price, rental or other conditions, withdrawal without notice, and to any special listing condition, imposed by our principals. All photography is used with permission and licensed specifically for Guardian Realty. All logo usage is only to identify the owner of the logo, and that the logo is not authorized by, sponsored by, or associated with the trademark owner.

Guardian Realty Solutions, LLC | 412.829.0900 | #610, 4530 William Penn Hwy, Murrysville, PA 15668

FLEX/OFFICE SPACE FOR LEASE

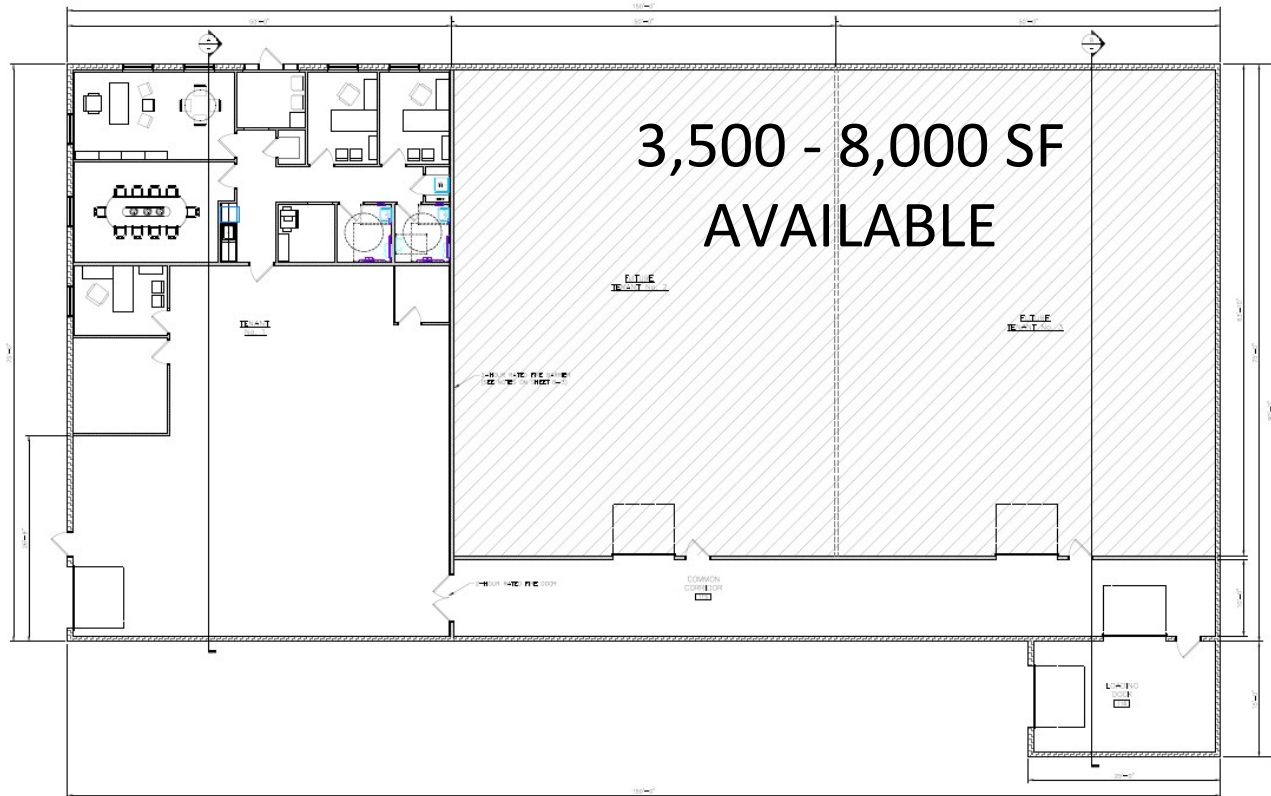

LEGEND:
MECHANICAL ROOMS (M.R.)
ELECTRICAL ROOMS (E.R.)
PLUMBING ROOMS (P.R.)
CONFERENCE ROOM (C.R.)
RESTROOMS (R.)
STORAGE ROOMS (S.R.)
LOBBY (L.)
RECEPTION AREA (R.A.)
CORRIDOR (C.)
STAIRWELL (S.W.)
ELEVATOR (E.)
ELECTRICAL PANEL (E.P.)
PLUMBING FIXTURES (P.F.)
MECHANICAL EQUIPMENT (M.E.)
FURNITURE (F.)
GLASS PARTITION (G.P.)



PROPOSED OVERALL FLOOR PLAN
SCALE: 1/4" = 1'-0"

YOUNG & ASSOCIATES
ENGINEERS + SURVEYORS
2075 South 6th Street
Murrysville, PA 17055-4002
Tel: 717-861-2000
Fax: 717-861-2000
www.youngassociates.com

PRELIMINARY 2/4/15

NOT FOR CONSTRUCTION

SHILLING TENANT BUILDING

PREPARED FOR: GCM S.I. CASSELL, LLC
SUPERVISOR: CONSTRUCTION MANAGEMENT SERVICES, INC.
DRAWN BY: SHILLING, WATSON & ASSOCIATES, P.A.

NO.	DESCRIPTION	DATE
1	SHEET	02/03/15
2	DATE	02/03/15
3	SCALE	N/A
4	SHEET	N/A
5	DATE	N/A
6	SCALE	N/A
7	SHEET	N/A

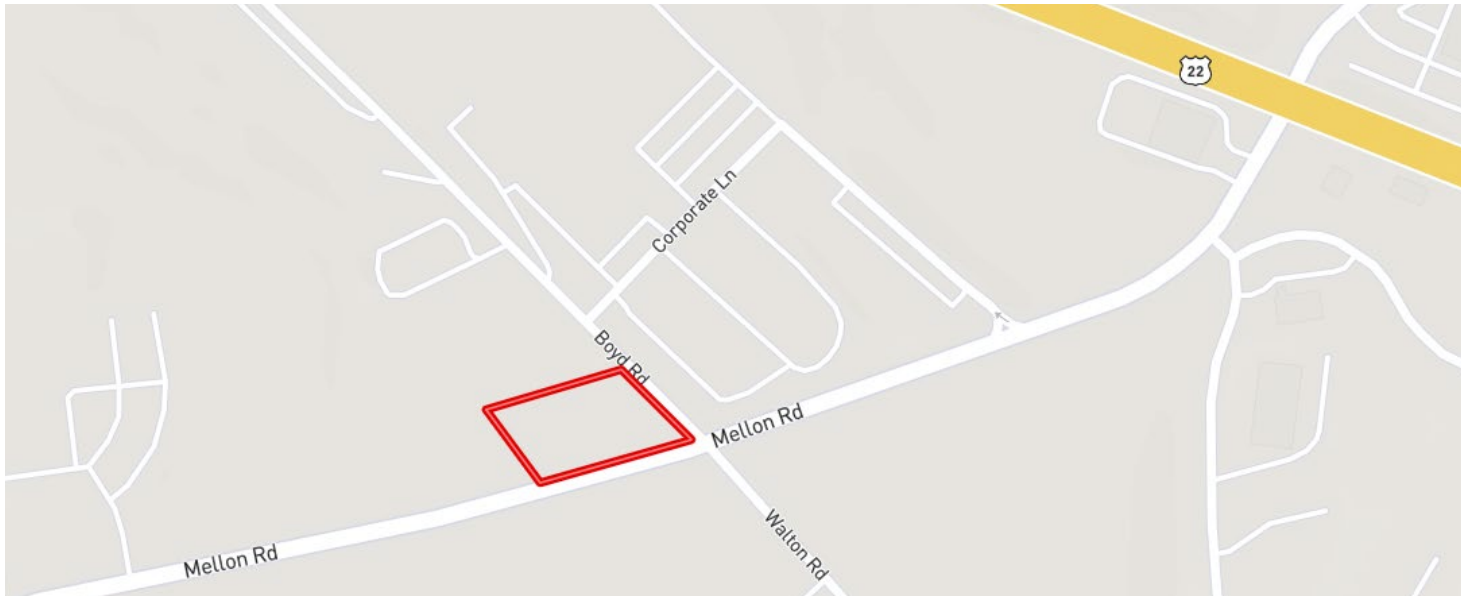

Cynthia L. Whiteman
Sales Associate
412.297.3567 mobile
cwhiteman@gcmsi.com
RS357888

Christina M. Bucciero
President/Broker of Record
412.445.5134 mobile
cbucciero@gcmsi.com
RM #423313 RB #068430

www.guardianrealtysolutions.com

*No warranty or representation express or implied, is made as to the accuracy of the information contained herein, and same is submitted subject to errors, change of price, rental or other conditions, withdrawal without notice, and to any special listing condition, imposed by our principals. All photography is used with permission and licensed specifically for Guardian Realty. All logo usage is only to identify the owner of the logo, and that the logo is not authorized by, sponsored by, or associated with the trademark owner.

Guardian Realty Solutions, LLC | 412.829.0900 | #610, 4530 William Penn Hwy, Murrysville, PA 15668