



OAKHURST
REALTY
PARTNERS

FOR LEASE

GIBSON

Reynoldstown
Corner Retail Space

982 Memorial Drive, Atlanta, GA 30316

For more information contact:

Todd Semrau | tsemrau@oakrep.com | (404) 371-4100



Property Highlights



205 modern apartment homes



1,700 SF of prime retail space



500 square foot wraparound patio



Automatic garage door



Tall ceiling (18 ft.)



18 on site retail parking spaces



**Across the street from Madison Yards
and Atlanta Dairies**



One block from Eastside Beltline



**Pedestrian friendly – walk score of 87
according to walkscore.com**



12 miles from Atlanta Airport



**Convenient access to I-20 and
Memorial Drive**



**Rare opportunity to
lease corner retail space
fronting Memorial Drive**

Reynoldstown - It's All Here

Located in one Atlanta's most sought after neighborhoods, The Gibson features 205 modern apartment homes with walkable access to dining, nightlife and shopping. Surrounded by indie restaurants, entertainment venues, and the Eastside Beltline, Reynoldstown is hip, diverse and active - making The Gibson an ideal site for retailers who want to engage the Gen Z and Millennial demographic.



A Patio to See and Be Seen

- Expansive outdoor area
- Lawn and event space
- Garage door offers indoor/outdoor access
- Ideal place to relax with friends







FOR LEASE

THE GIBSON: Reynoldstown

RETAIL PLAN

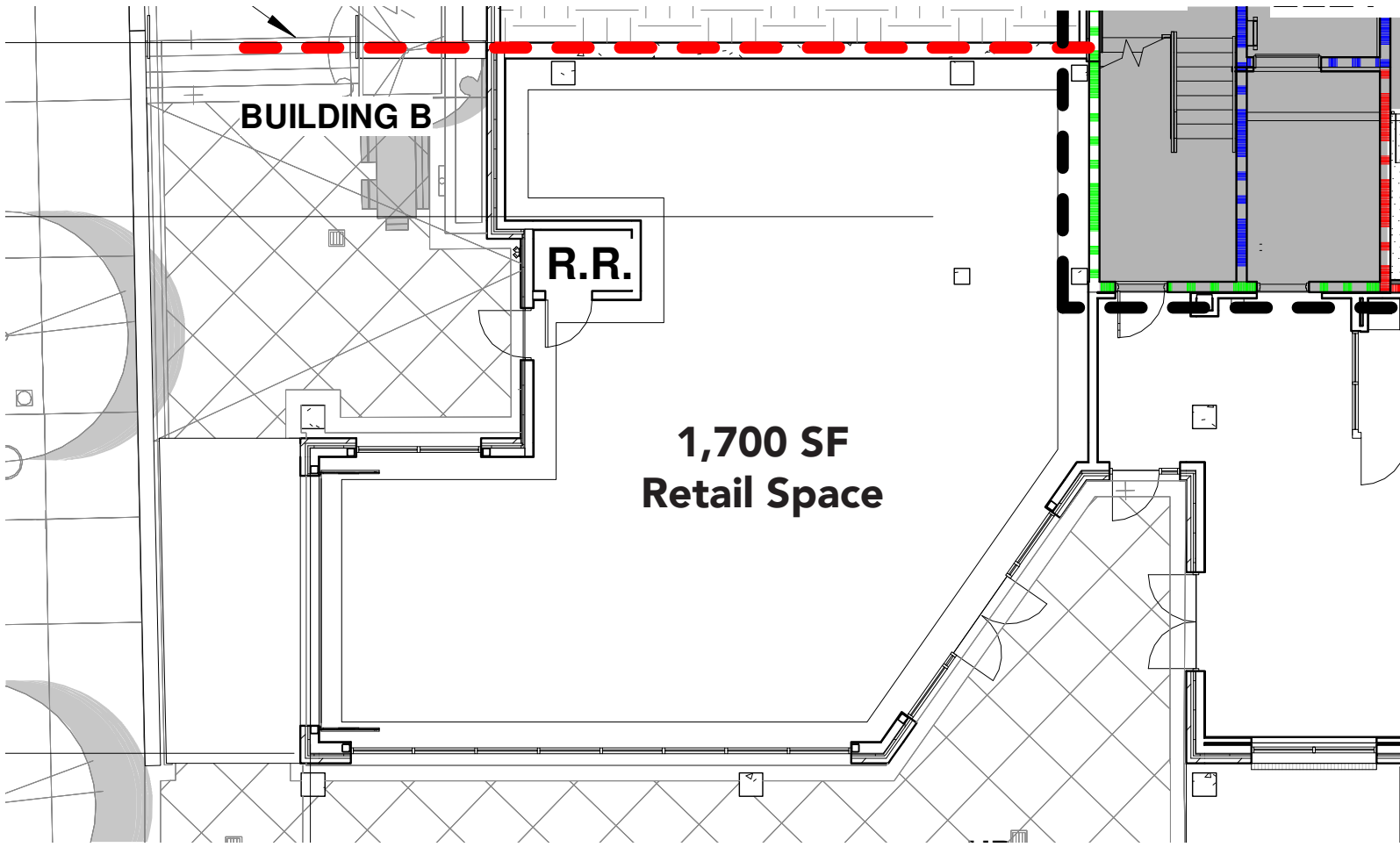

FOR LEASE

THE GIBSON: Reynoldstown



AREA ATTRACTIONS & RESTAURANTS

Restaurants

1. Muchacho
2. Three Taverns Imaginarium
3. Homegrown
4. Grindhouse
5. Agave
6. Carroll Street Cafe
7. Six Feet Under
8. Gunshow

Mixed-use

1. Atlanta Dairies
2. The Eastern
3. Madison Yards
4. Empire Stein Steel
5. A&P Lofts
6. Krog Street Market

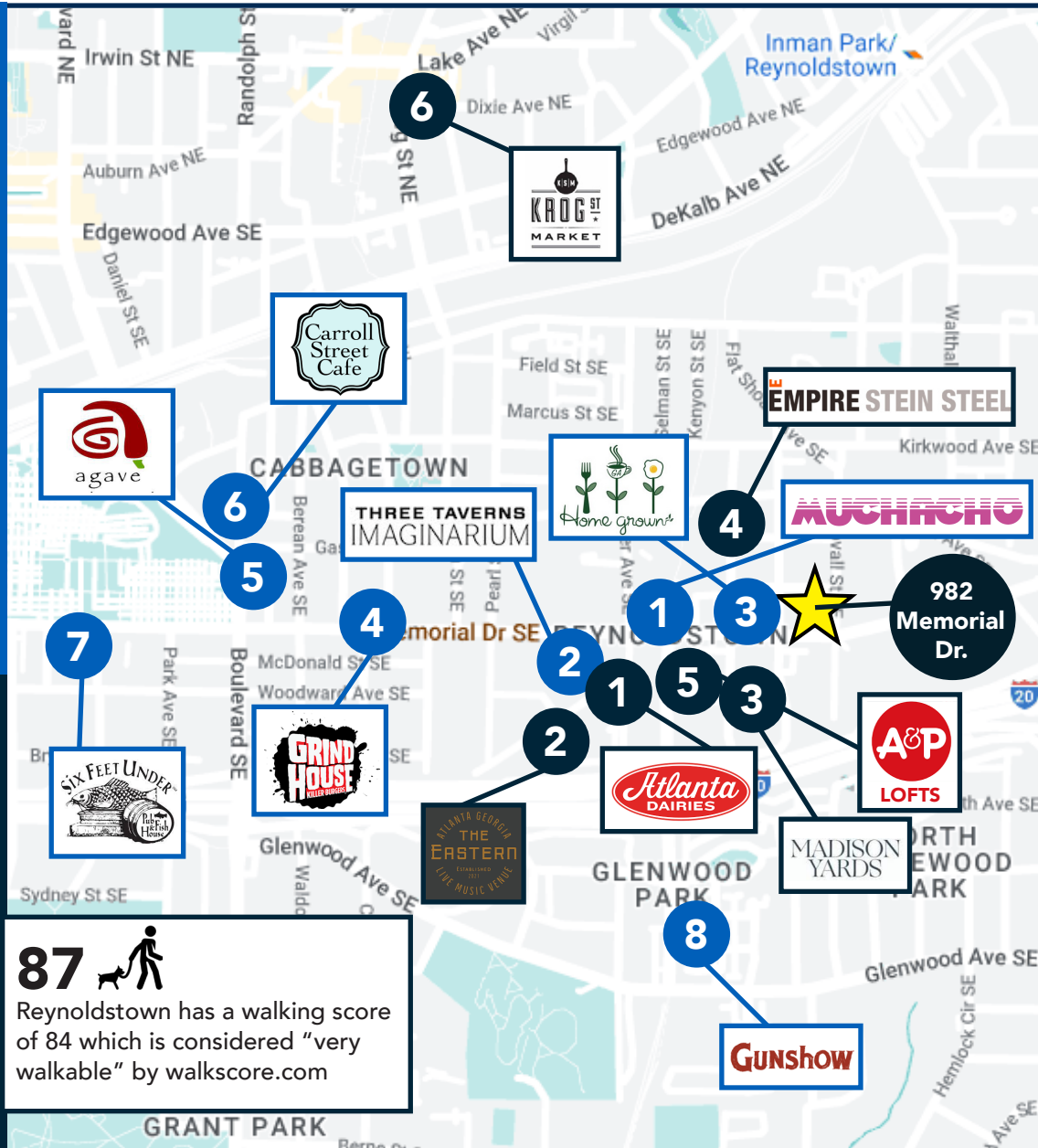

87 
 Reynoldstown has a walking score of 84 which is considered "very walkable" by walkscore.com

Within 1 Mile



21,505
 Population



\$147,179
 Average Household Income



11,575
 Total Households



12,300
 Cars Per Day

Memorial Drive Corridor



The main connection between Atlanta and Stone Mountain, the Memorial Drive corridor has ferried travelers from the city to the suburbs for decades.

- » In total, there has been \$1.5BN in development along Memorial Drive.
- » The beltline sees 1.7M Visitors per year.
- » The Memorial Drive Corridor has seen 2,164 multi-family units and 300 townhomes delivered in the last 5 years.
- » 30 new food and beverage establishments.

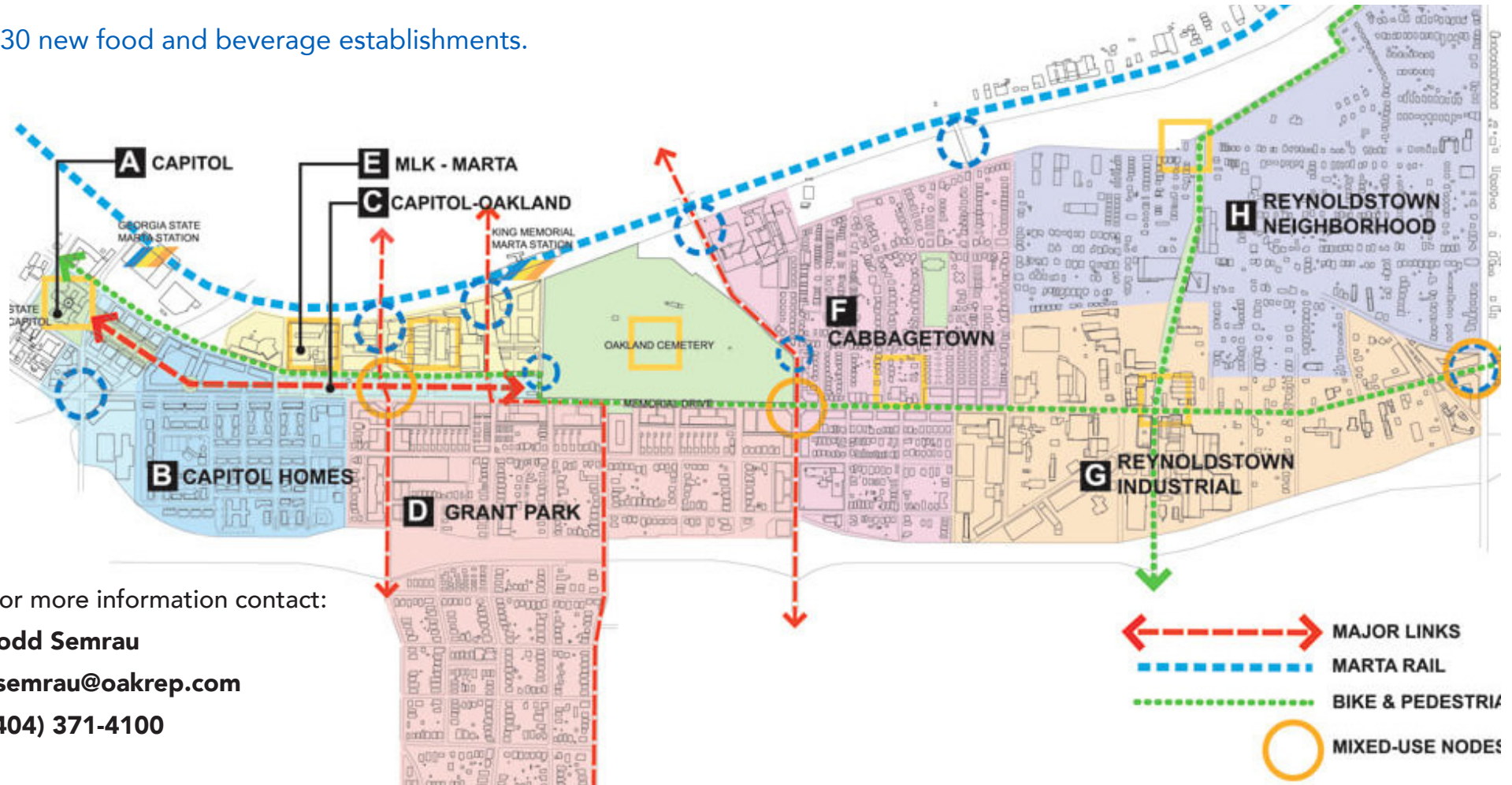

For more information contact:

Todd Semrau

tsemrau@oakrep.com

(404) 371-4100

