

8400 RONDA DRIVE
CANTON, MICHIGAN

INDUSTRIAL FOR LEASE
50,636 Square Feet Available



**SIGNATURE
ASSOCIATES**
KNOW SIGNATURE | KNOW RESULTS



PROPERTY FEATURES

- 50,636 square feet available
- 2,400 square feet office
- 20' – 23' clear height
- (3) 14'x14' grade level doors
- (3) truckwells
- Zoned Light Industrial
- Heavy power
- Great access to I-275 via Ann Arbor & Ford Road Exits
- New LED lights in both shop & office
- Very clean building / immediate access
- Lease Rate: \$6.95/sq.ft. NNN



For more information, please contact:

JOE HAMWAY
(248) 948 0113

jhamway@signatureassociates.com

GREG HUDAS
(248) 799 3162

ghudas@signatureassociates.com

SIGNATURE ASSOCIATES
One Towne Square, Suite 1200
Southfield, MI 48076
www.signatureassociates.com

8400 Ronda Drive – Canton, Michigan

Industrial For Lease

50,636
Square Feet
AVAILABLE

Interior Photos

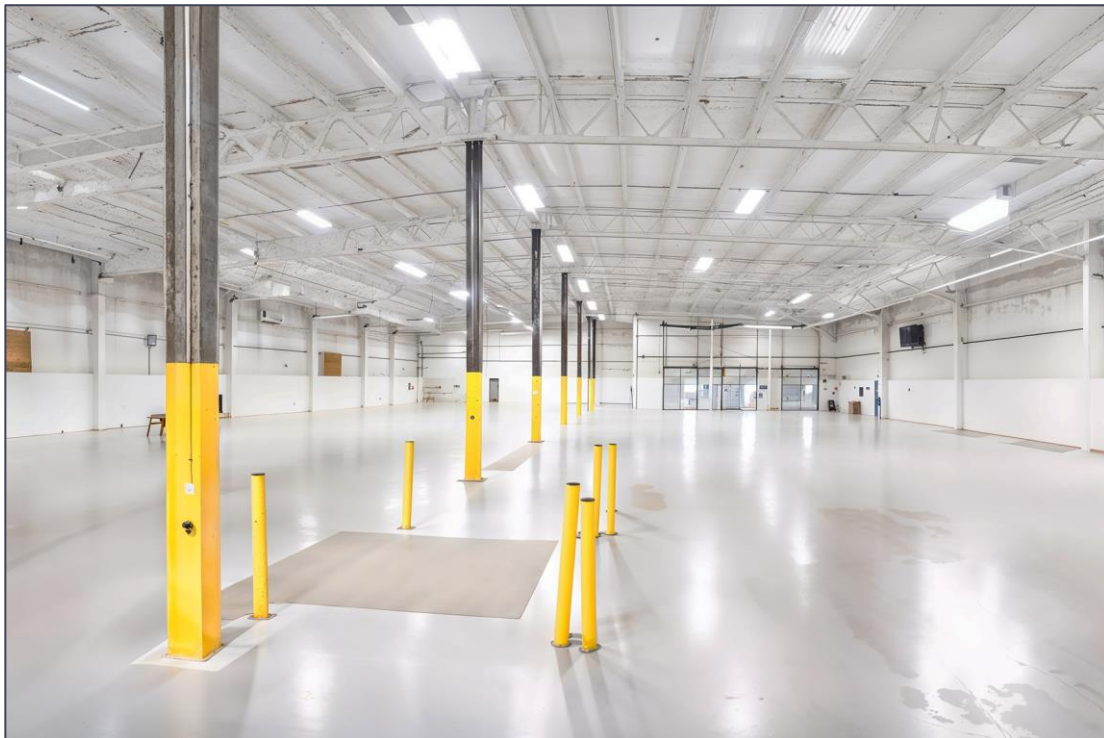

For more information, please contact:

JOE HAMWAY

(248) 948 0113

jhamway@signatureassociates.com

GREG HUDAS

(248) 799 3162

ghudas@signatureassociates.com

SIGNATURE ASSOCIATES

One Towne Square, Suite 1200

Southfield, MI 48076

www.signatureassociates.com

8400 Ronda Drive – Canton, Michigan

Industrial For Lease

50,636
Square Feet
AVAILABLE

Interior Photos



For more information, please contact:

JOE HAMWAY

(248) 948 0113

jhamway@signatureassociates.com

GREG HUDAS

(248) 799 3162

ghudas@signatureassociates.com

SIGNATURE ASSOCIATES

One Towne Square, Suite 1200

Southfield, MI 48076

www.signatureassociates.com

8400 Ronda Drive – Canton, Michigan

Industrial For Lease

50,636
Square Feet
AVAILABLE

Site Plan

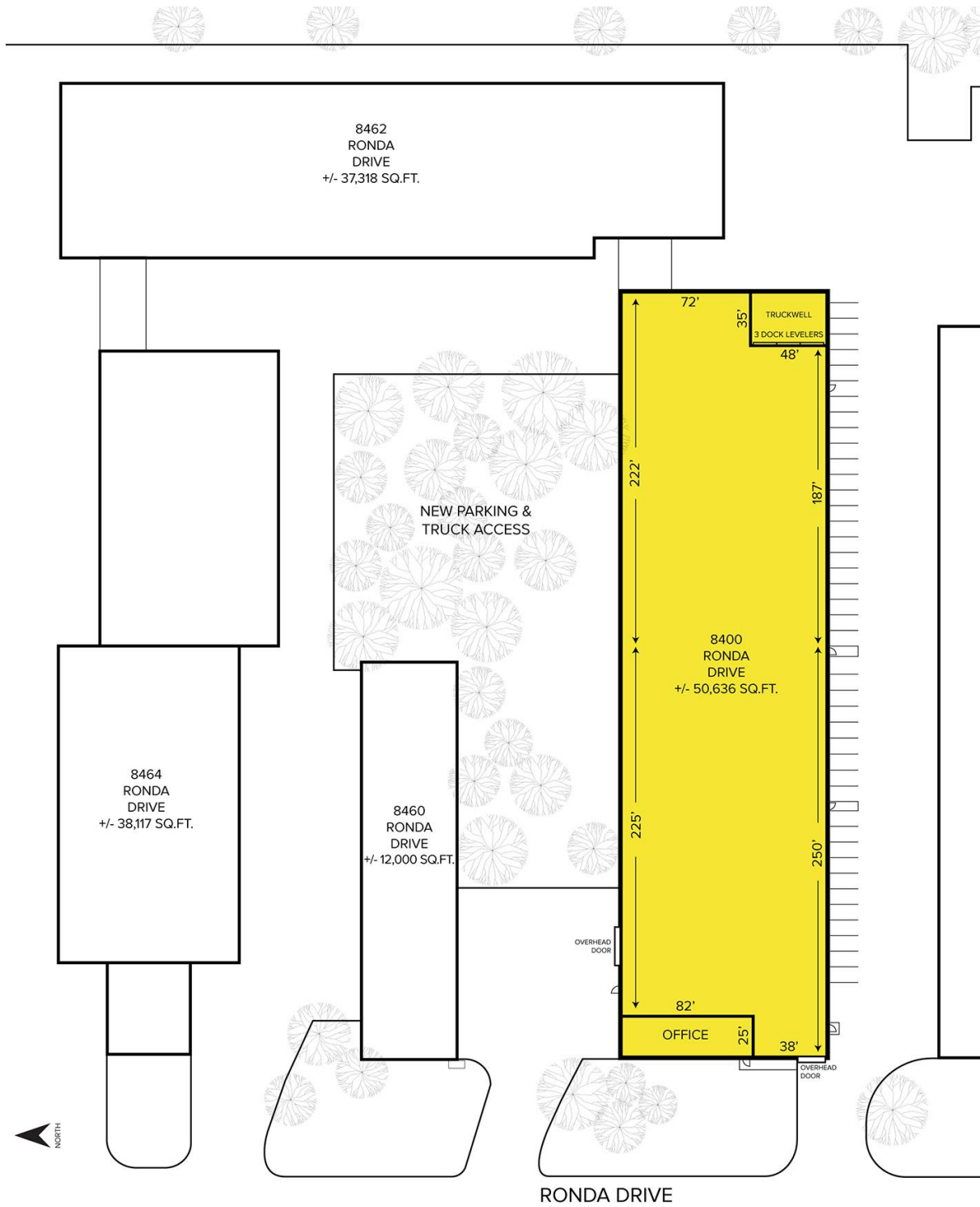

For more information, please contact:

JOE HAMWAY
(248) 948 0113

jhamway@signatureassociates.com

GREG HUDAS
(248) 799 3162

gHUDAS@signatureassociates.com

SIGNATURE ASSOCIATES
One Towne Square, Suite 1200
Southfield, MI 48076
www.signatureassociates.com

8400 Ronda Drive – Canton, Michigan

Industrial For Lease

50,636
Square Feet
AVAILABLE

Aerial



For more information, please contact:

JOE HAMWAY

(248) 948 0113

jhamway@signatureassociates.com

GREG HUDAS

(248) 799 3162

ghudas@signatureassociates.com

SIGNATURE ASSOCIATES

One Towne Square, Suite 1200

Southfield, MI 48076

www.signatureassociates.com