

# ***Flatiron Restaurant For Lease or Sale***

***32 East 21<sup>st</sup> Street***

***Between Broadway / Park Avenue So***

***Approx 4,000 rsf Ground***

***Currently a Built Restaurant***

***Approx 300 rsf Mezzanine***

***Retail Coop w/ Low Maintenance***

***Approx 2,000 rsf Basement***

***16' Ceilings on Ground***

**Currently operating as Harding's NYC do not go by unannounced or talk to patrons or employees. Shown by appointment only.** This is a fully built restaurant with a total of approximately 6,300 rsf between ground, mezzanine and lower level. Vented w/ precipitator and a gas line in place, private dining room, 4 restrooms, dramatic historic details throughout and a current occupancy of 140 but possibly more. Existing tenant in place till end of 2024 and ownership open to lease or sell the coop. Asking rent/price available upon request.



*For More Information Contact:*

**Jeffrey Angel**  
**212-719-7017**

**Jeffrey.angel@resnewyork.com**

**Sam Khoury**  
**929-370-7772**

**samk@resnewyork.com**



The information contained herein has been provided by sources that we deem reliable. However, no expressed or implied warranties are made as to the accuracy of the information and it should not be relied upon in any way. All information contained herein should be independently verified prior to anyone entering into an form of legal binding agreement to purchase, lease or otherwise procure the premises or situation presented herein. Information is subject to change or withdrawal without notice and may contain errors and/or omissions.

# 32 East 21<sup>st</sup> Street

## Location Highlights

Amazing Flatiron location around the corner from Madison Square Park and just off of Broadway. Very strong mix of food & beverage operators in the area as well as major office/residential tenants. Close to the 6 train at 23<sup>rd</sup> and Park and R,W at 23<sup>rd</sup> & Broadway. *Neighbors Include: Giorgio's of Gramercy ♦ Chica & the Don ♦ Tend Flatiron ♦ Cha Cha Matcha ♦ Cosme Mexican ♦ Lysee ♦ Morton Williams ♦ Le Pain Quotidien*

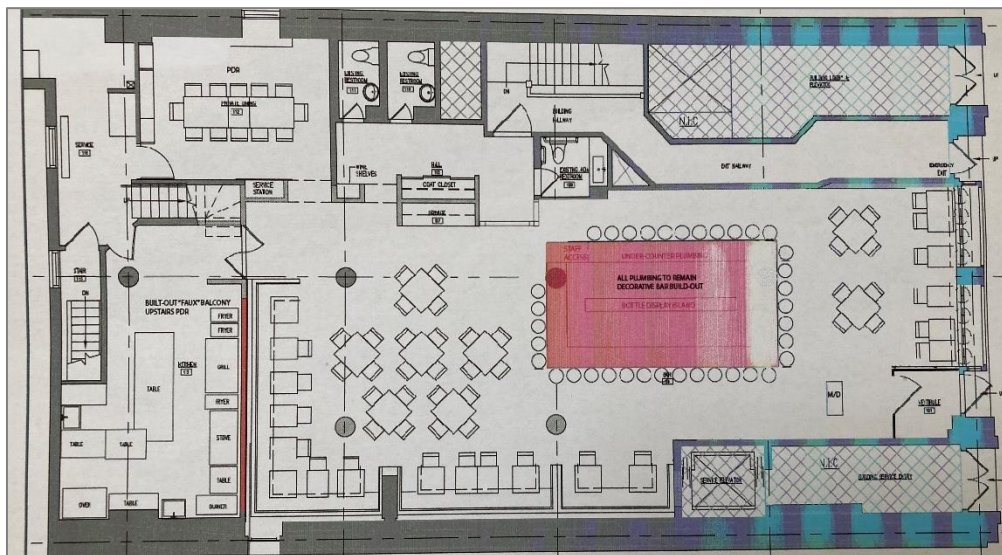

For More Information Contact:

**Jeffrey Angel**  
**212-719-7017**  
[Jeffrey.angel@resnewyork.com](mailto:Jeffrey.angel@resnewyork.com)

**Sam Khoury**  
**929-370-7772**  
[samk@resnewyork.com](mailto:samk@resnewyork.com)



The information contained herein has been provided by sources that we deem reliable. However, no expressed or implied warranties are made as to the accuracy of the information and it should not be relied upon in any way. All information contained herein should be independently verified prior to anyone entering into an form of legal binding agreement to purchase, lease or otherwise procure the premises or situation presented herein. Information is subject to change or withdrawal without notice and may contain errors and/or omissions.