

For Sale/Lease

Class A Office

35,658 SF | Negotiable



8924 E 35th St N

Wichita, Kansas 67226

Property Highlights

- 35,658 SF Class A Call Center
- Located just north of K-96 in the Comotara Business Park.
- Close proximity to Jabara Municipal Airport and the National Center for Aviation Training.
- Adjacent to notable businesses: Kansas Heart Hospital, Clear Channel Communications, Lab Corp., POET Biofuels, and Kansas Spine Hospital.

Property Description

- Spacious open workspace flooded with natural light
- On-site fitness center featuring locker rooms
- Underground storm shelter for safety during emergencies, complemented by a 400 KVA generator for reliable backup power.
- Ample parking with 243 spaces available
- 275 cubes for versatile workspace arrangements
- Secure data center equipped with battery backup, redundant HVAC, and fire suppression systems

OFFERING SUMMARY

Available SF	35,658 SF
Lot Size	6.9 Acres
Building Size	35,658 SF

For more information

Patrick Ahern, SIOR, CCIM

O: 316 847 4914

pahern@naimartens.com



1330 E. Douglas Ave.,
Wichita, KS 67214
316 262 0000 tel
naimartens.com



For Sale/Lease

Class A Office

35,658 SF | Negotiable



For Sale/Lease

Class A Office

35,658 SF | Negotiable

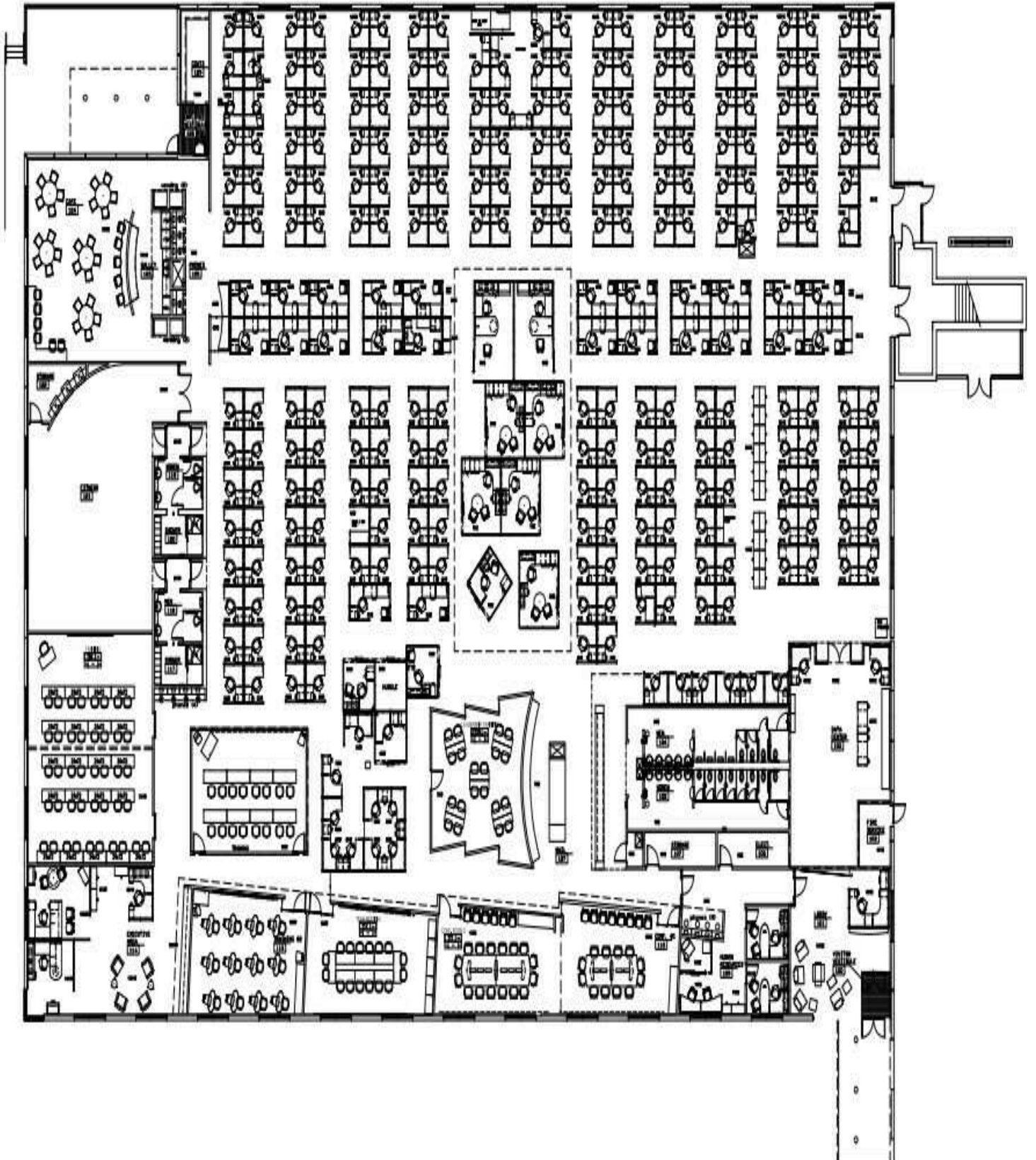

For Sale/Lease

Class A Office

35,658 SF | Negotiable

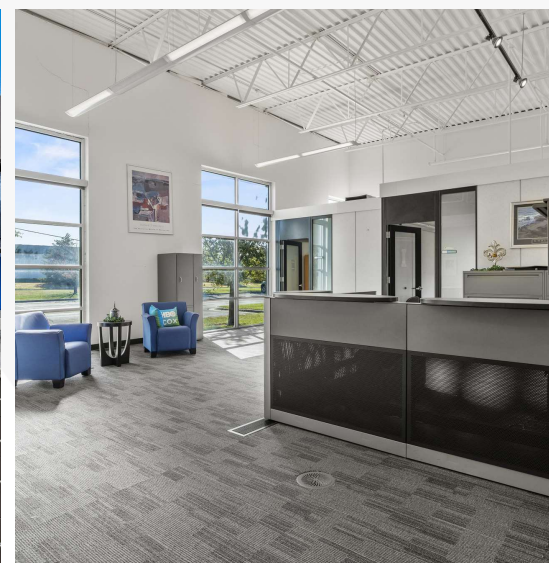

For Sale/Lease

Class A Office

35,658 SF | Negotiable

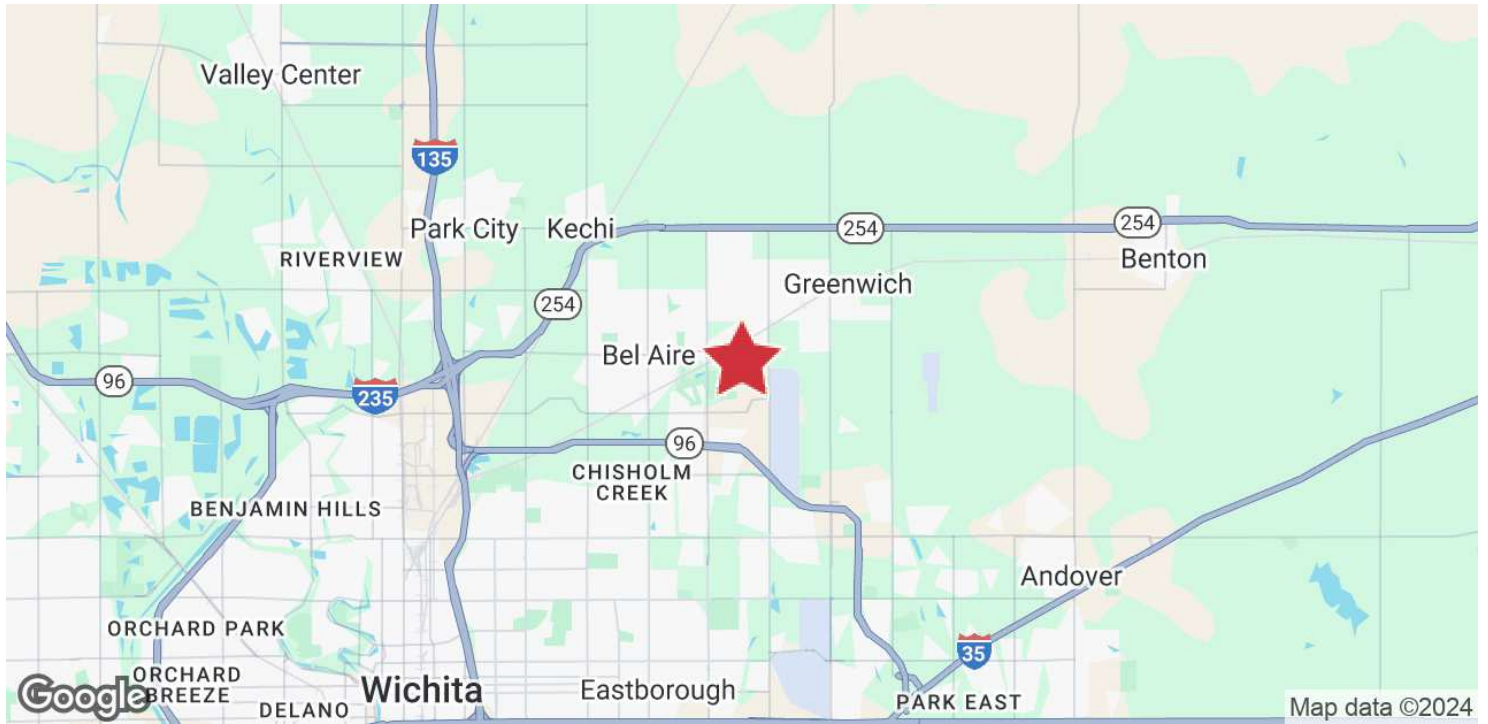

8924 E 35th St N

Wichita, Kansas 67226

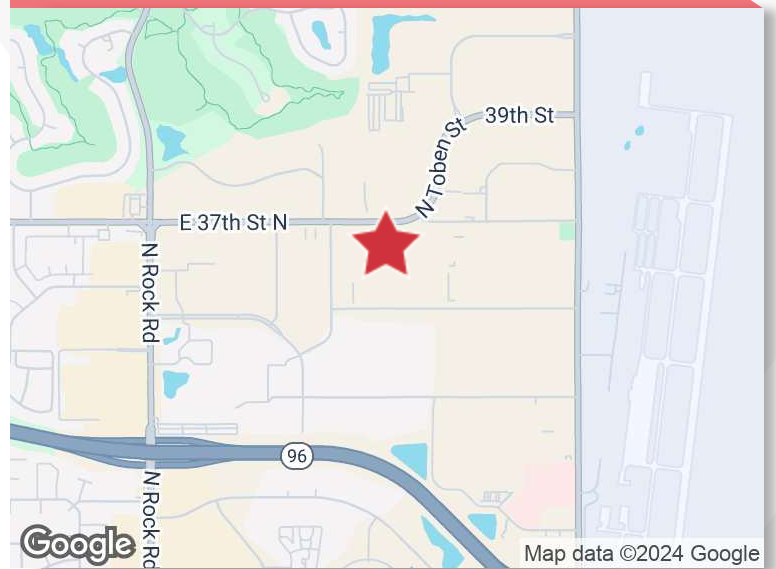
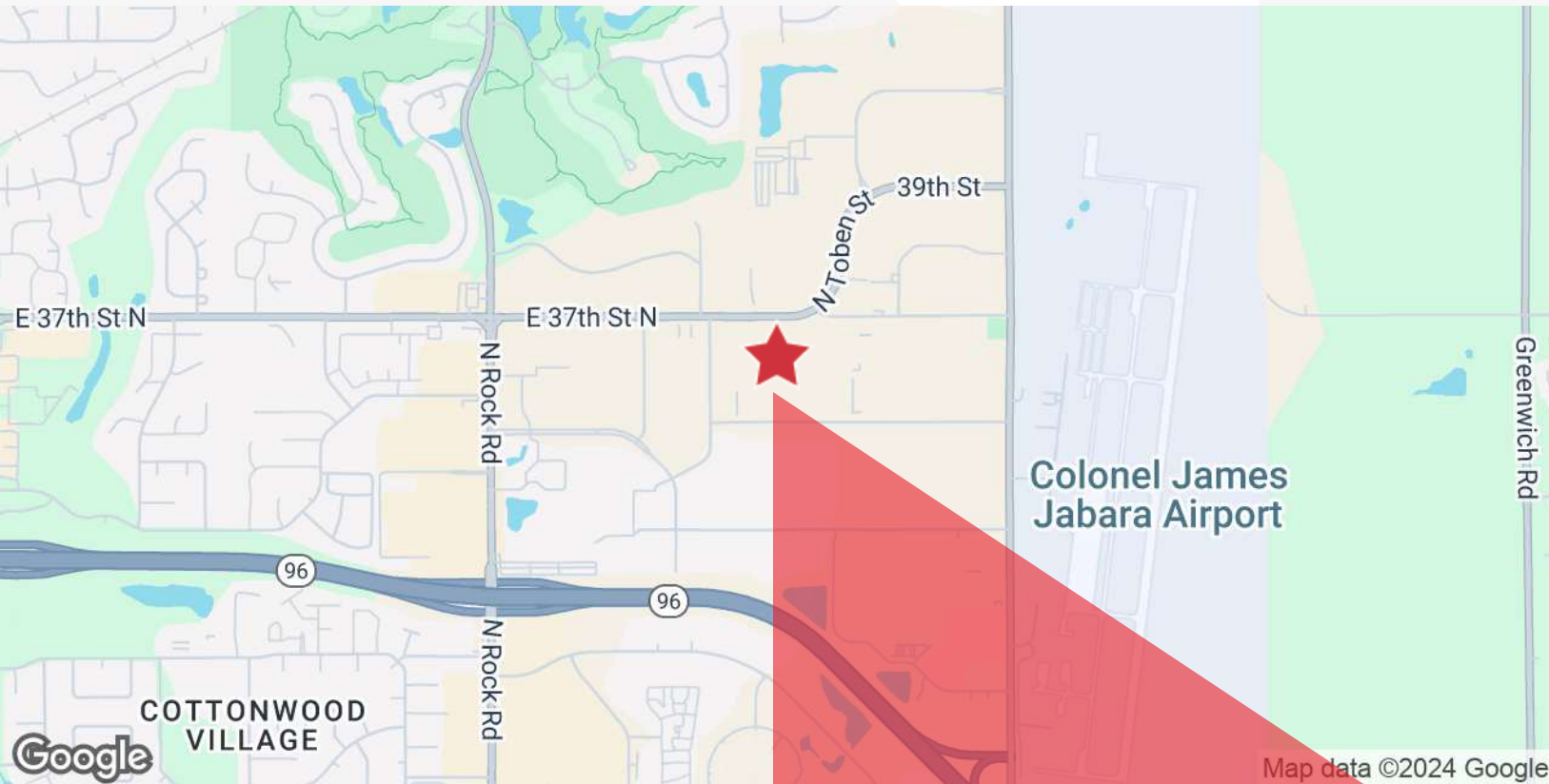

For more information

Patrick Ahern, SIOR, CCIM

O: 316 847 4914 | pahern@naimartens.com