

**525  
EXECUTIVE BLVD  
ELMSFORD, NY**

**FOR SUB-LEASE**



### PROPERTY INFORMATION

Welcome to 525 Executive Blvd, Elmsford, NY. We exclusively represent this prime sub-let now available for Office, Lab, or Warehouse in this highly sought-after professional building. Nestled in the heart of Westchester County, this divisible office space offers an ideal blend of functionality, convenience, and modern amenities, making them perfect for businesses looking to thrive in a professional setting.

- Modern finishes and fixtures
- High-speed internet access
- Ample parking for employees and clients
- Loading Dock
- HVAC system ensuring a comfortable work environment year-round
- Secure building with 24/7 access and surveillance
- Close proximity to public transportation options
- Convenient access to major highways (I-287, Saw Mill River Parkway)
- Nearby amenities including restaurants, cafes, and retail store

**Combined Divisible Spaces available for lease**

**Space Size 4425 SQFT**

**Unit 1: Office at 1550 SQFT**

**Unit 2: Office at 2875 SQFT**

**Call for more information.**

### CONTACTS

PAUL MOULINS  
Managing Director  
PMoulins@kw.com  
C: 914-714-3777

# 525 EXECUTIVE BLVD, ELMSFORD, NY



## CONTACTS

PAUL MOULINS  
Managing Director  
PMoulins@kw.com  
C: 914-714-3777



760 WHITE PLAINS RD, SCARSDALE, NY 10583 | 2300 EASTCHESTER RD, BRONX, NY 10469 | O: 914-902-8700 | KWCOMMERCIALNEWYORK.COM

The information contained herein has been obtained through sources deemed reliable but cannot be guaranteed as to its accuracy. Any information of special interest should be obtained through independent verification

# 525 EXECUTIVE BLVD, ELMSFORD, NY

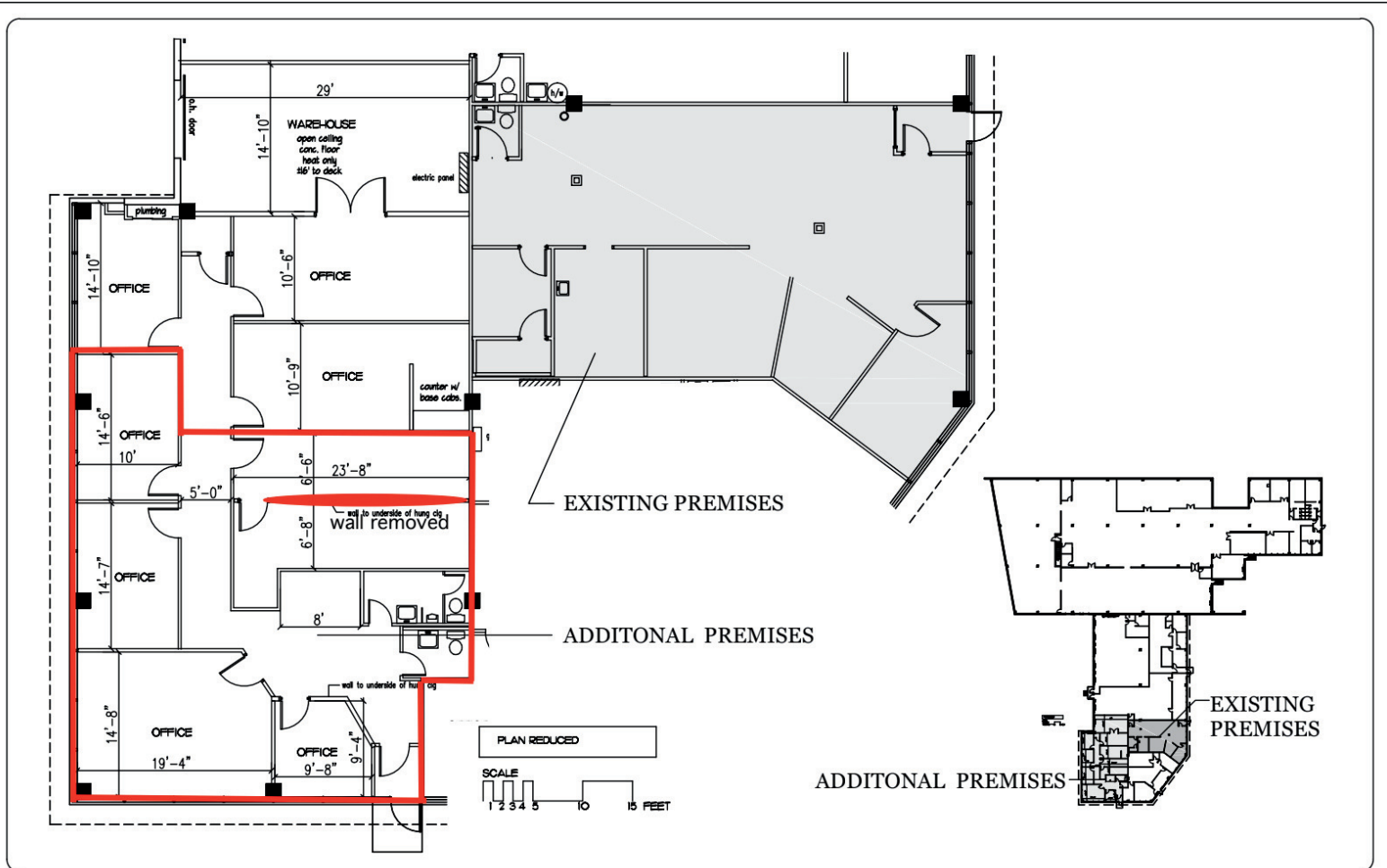

CROSS WESTCHESTER EXECUTIVE PARK  
525 EXECUTIVE BLVD  
ELMSFORD, NEW YORK

## GENERAL NUTRACEUTICAL TECH SK1

15 APR 19  
LOWER LEVEL



### CONTACTS

PAUL MOULINS  
Managing Director  
PMoulins@kw.com  
C: 914-714-3777



DIVISION OF KELLER WILLIAMS REALTY GROUP

760 WHITE PLAINS RD, SCARSDALE, NY 10583 | 2300 EASTCHESTER RD, BRONX, NY 10469 | O: 914-902-8700 | KWCOMMERCIALNEWYORK.COM

The information contained herein has been obtained through sources deemed reliable but cannot be guaranteed as to its accuracy. Any information of special interest should be obtained through independent verification.