

LAND DIVISION SPLITS

OVERALL CALCULATIONS:
 CONTIGUOUS PARENT PARCEL 61.38 ACRES

1ST 10 ACRES: 4 SPLITS
 EACH WHOLE 10 ACRES: 5 SPLITS
 BONUS SPLITS: 2 SPLITS
 TOTAL SPLITS: 11 SPLITS

SPLITS SHOWN HEREON: 6 SPLITS
 SPLITS REMAINING: 5 SPLITS

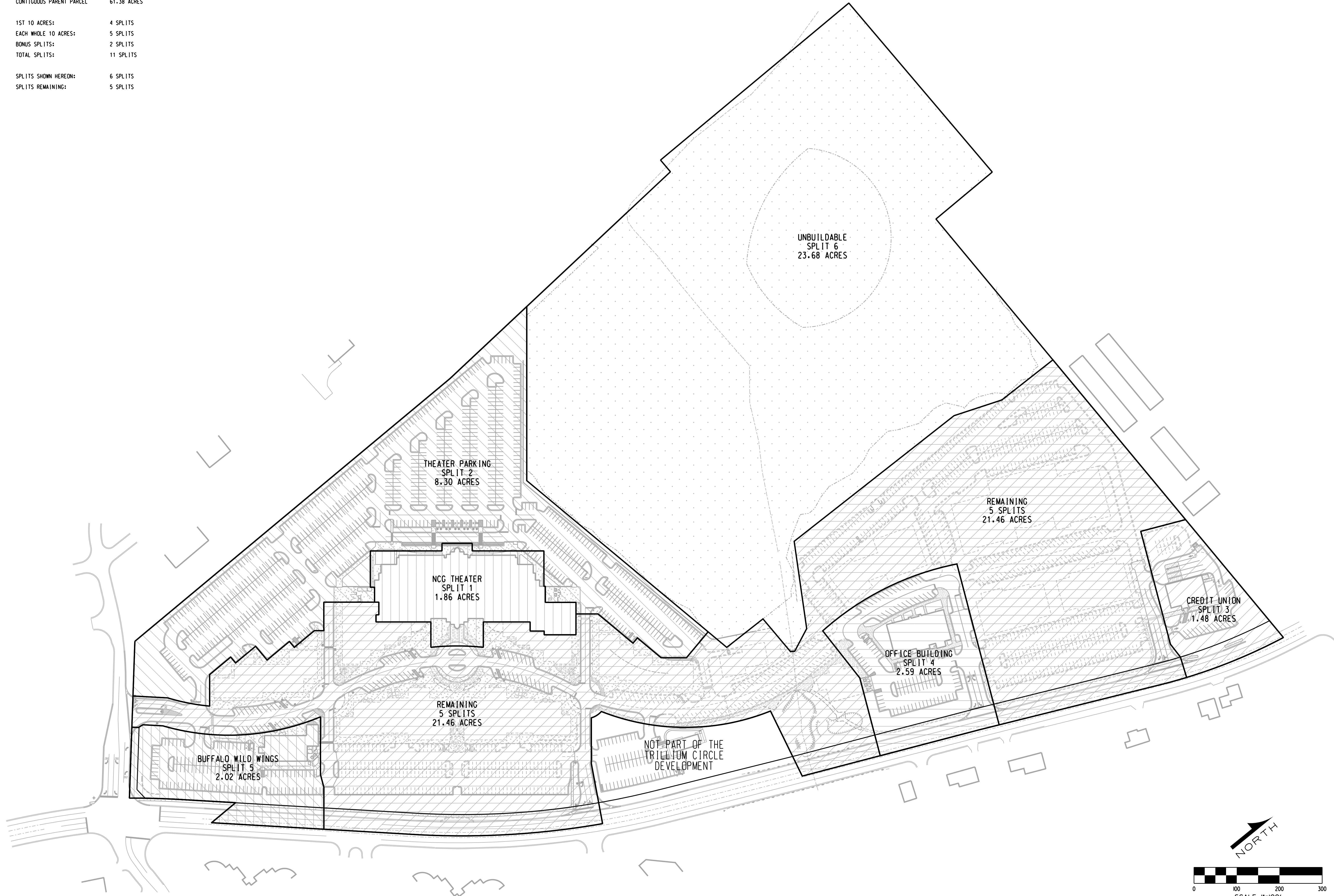

DRAWN: MCHURO DESIGNED: CHECKED: BRZEZINSKI FIELD CREW:	NO.:	DATE:	SUBJECT:
	130406	07-15-19	TO OWNER
	REVISION OR ISSUE		
	SEAL		

TRILLIUMCIRCLE
 VILLAGE • GARDENS • MARKET
 IMAX THEATER (PARKING EXPANSION)
 GRAND BLANC TOWNSHIP, GENESEE COUNTY, MICHIGAN

LAND DIVISIONS (EXISTING & PROPOSED)

Griggs Quaderer, Inc.
 8308 OFFICE PARK DRIVE
 GRAND BLANC, MI 48439
 WWW.GQINCORP.COM
 PH: (810) 695-0154
 FX: (810) 695-0158

CIVIL ENGINEERING • LAND SURVEYING
 SITE PLANNING

15th ANNIVERSARY
 2004 - 2019

PHASE: CONCP

JOB NO.: 130406

SPLITS