

Class A Office Opportunity

6400 WESTOWN PARKWAY
WEST DES MOINES, IA 50266



Floor Plans

First Floor



Second Floor

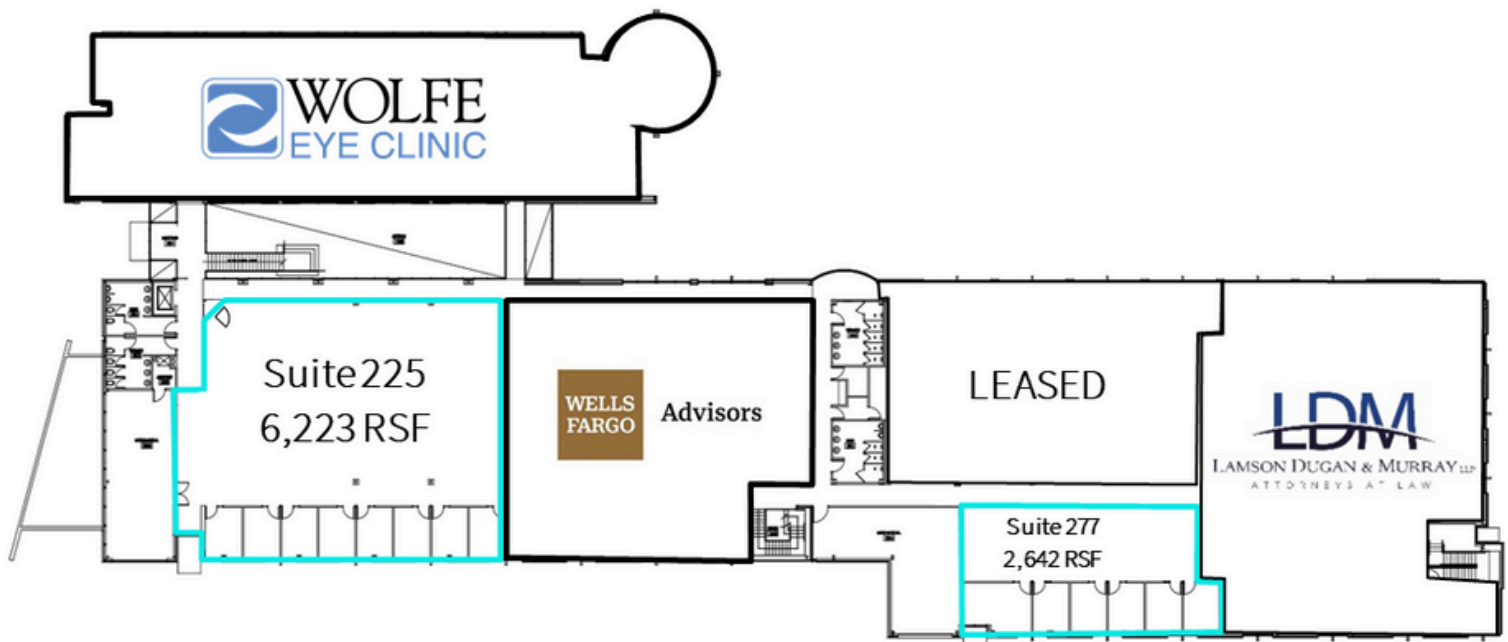

Availability

Lease Rate: \$18.00 NNN

Est. OPEX: Available upon request

TI Allowance: With long-term lease

Available: Immediately

1st Floor:

Suite 100: LEASED

Suite 150: LEASED

Suite 175: LEASED

2nd Floor:

Suite 200: LEASED

Suite 225: 6,223 RSF

Suite 250: LEASED

Suite 275: LEASED

Suite 276: LEASED

Suite 277: 2,642 RSF

Amenities

- New/shared conference room
- New state of the art fitness center
- Shower & locker room
- Multi-story, glass atrium common area
- Collaborative/meeting area in main atrium
- Mix of executive offices & open areas
- Significant IT infrastructure in place
- Natural light throughout
- Beautiful lake views
- Shared outdoor patio
- Access to pond with walking trail around
- Ample free parking
- Interstate monument signage
- Easy freeway access
- Access to bus stops & transit
- Restaurants, hotels, & shopping nearby



6400 Westtown Parkway

West Des Moines | Iowa | 50266



Justin Lossner, CCIM, SIOR

justin.lossner@jll.com

+1 515 371 0846

Lucas Hedstrom

lucas.hedstrom@jll.com

+1 515 564 9269

Owned by:

MDM

Managed by:



jll.com/des-moines

Jones Lang LaSalle Americas, Inc.



The information contained herein has been given to us by the owner of the property or other sources we deem reliable. We have no reason to doubt its accuracy, but we do not guarantee it. All information should be verified prior to purchase or lease. Jones Lang LaSalle Brokerage, Inc. is a licensed broker in the State of Iowa.