



WAREHOUSE/STORAGE FOR SUBLEASE

2507 SOUTH 300 WEST, SALT LAKE CITY, UT 84115

LEASE RATE: \$0.70 PSF NNN



PROPERTY INFORMATION

- ✓ 18,000 - 68,000 SF Available For Sublease
 - 18,000 SF Unit
 - 50,000 SF Unit
- ✓ 147,958 Sq. Ft. Total
- ✓ 4.79 Acres
- ✓ Year Built: 1969
- ✓ Ten (10) Dock High Doors
- ✓ Multiple Private Offices, Open Work Areas
- ✓ Breakroom, Kitchen, And Multiple Restrooms
- ✓ Power: 3-Phase 400A/120 - 208V
- ✓ Clearance: 23'
- ✓ Parking: 0.71/1,000 SF
- ✓ Sprinklers: Dry

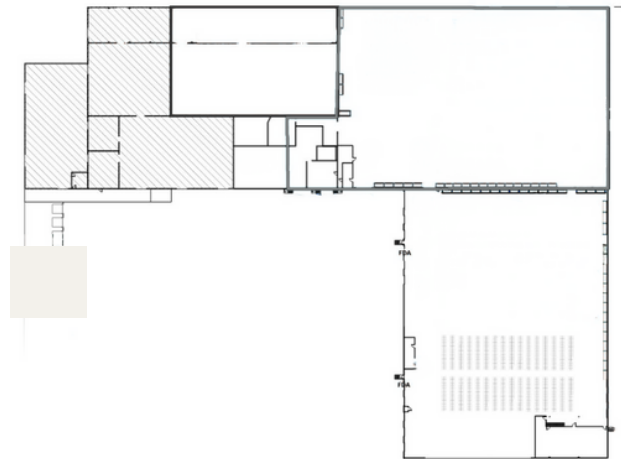

CONTACT US

JUSTIN WELCH

✉ justin@cresutah.com

PRINCIPAL BROKER

☎ 801.718.8842 🌐 www.cresutah.com

Call Us 
801.876.6070



WAREHOUSE/STORAGE FOR SUBLEASE

2507 SOUTH 300 WEST, SALT LAKE CITY, UT 84115



This information is given with the understanding that all negotiations and/or real estate activity related to the property described above shall be conducted through this CRES office. The above information while not guaranteed, was obtained from sources we believe to be reliable.

CONTACT US

Call Us
801.876.6070 

JUSTIN WELCH
✉ justin@cresutah.com

PRINCIPAL BROKER
☎ 801.718.8842  www.cresutah.com



WAREHOUSE/STORAGE FOR SUBLEASE

2507 SOUTH 300 WEST, SALT LAKE CITY, UT 84115

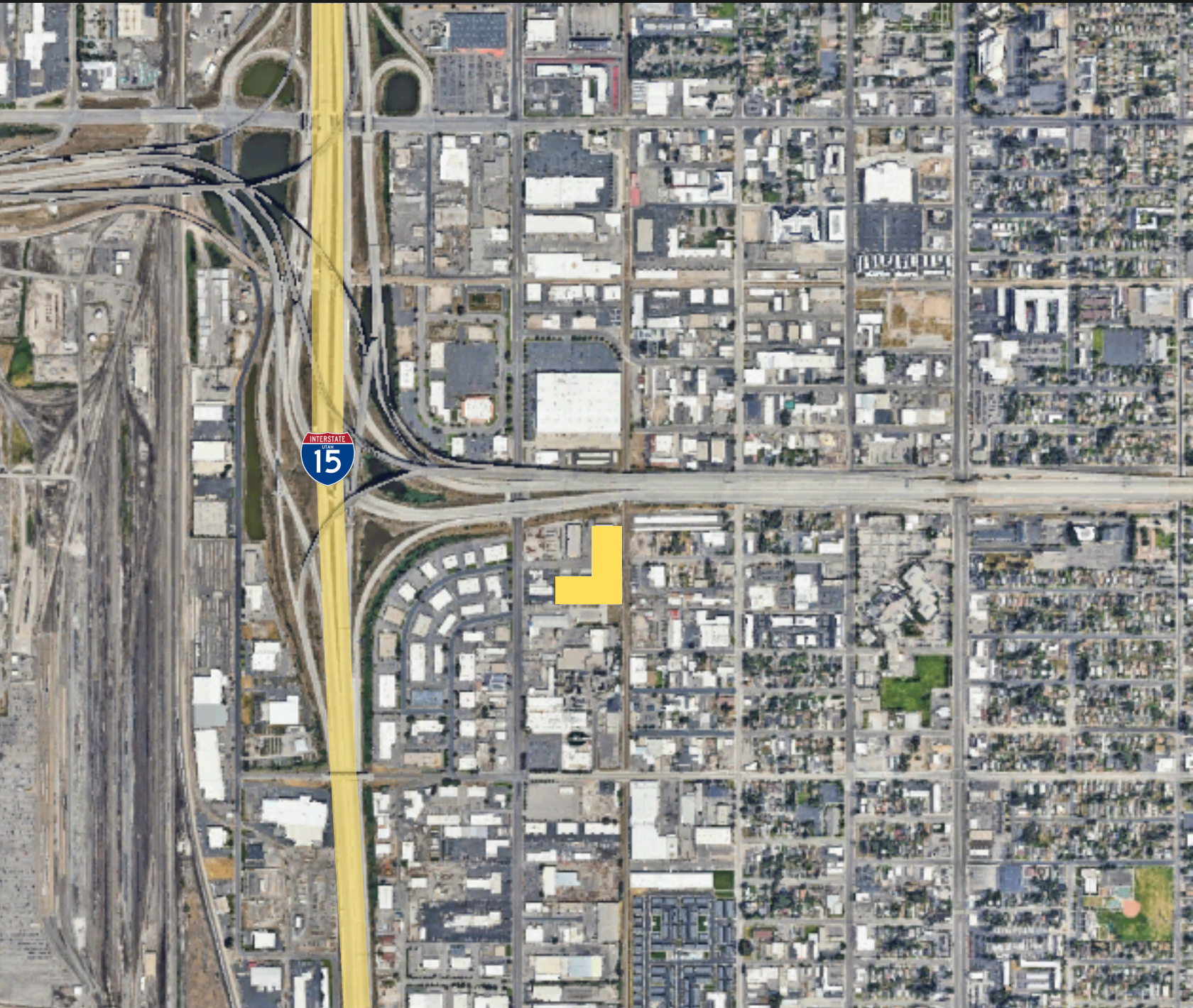

This information is given with the understanding that all negotiations and/or real estate activity related to the property described above shall be conducted through this CRES office. The above information while not guaranteed, was obtained from sources we believe to be reliable.

CONTACT US

Call Us
801.876.6070 

JUSTIN WELCH
✉ justin@cresutah.com

PRINCIPAL BROKER
☎ 801.718.8842  www.cresutah.com