

**AVAILABLE FOR LEASE**  
**2727 FIRE ROAD**  
EGG HARBOR TWP, NEW JERSEY

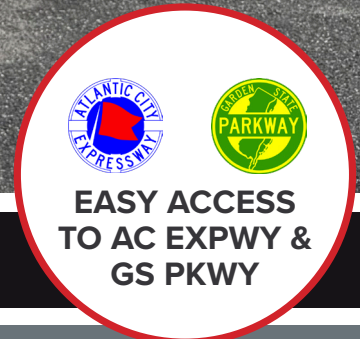

**LEASE NOW AT INCREDIBLE RATE: \$9.50 PSF NNN**



**4,500± SF REMAINING FOR LEASE | 4,500± SF JUST LEASED!**

**CONTACT**

**JONATHAN KLEAR**

+1 856 433 1801

jonathan.klear@naimertz.com



## PROPERTY DETAILS

2727 FIRE ROAD EGG HARBOR TWP, NJ



SPACE AVAIL

**4,500±  
SQ. FEET**



CEILING  
HEIGHT

**20'  
CLEAR**



LOADING

**1 DRIVE-IN  
(10'x14')**

### BUILDING DETAILS

- 9,000+/- SF office/flex building
- 1,000 SF of office
- 8,000 SF of warehouse
- 20' clear ceiling at eaves
- Two (2) drive-in overhead doors:
  - (1) 10'x14' and (1) 12'x14'
- 80'x100' clear span
- 200 amp, 208/120 Volt, 3 Phase Service
- Natural gas
- Well water/on site septic
- Multiple parking spaces



### CONTACT

**JONATHAN KLEAR**

+1 856 433 1801

jonathan.klear@naimertz.com

**NAIMertz**

# FLOORPLAN

2727 FIRE ROAD EGG HARBOR TWP, NJ

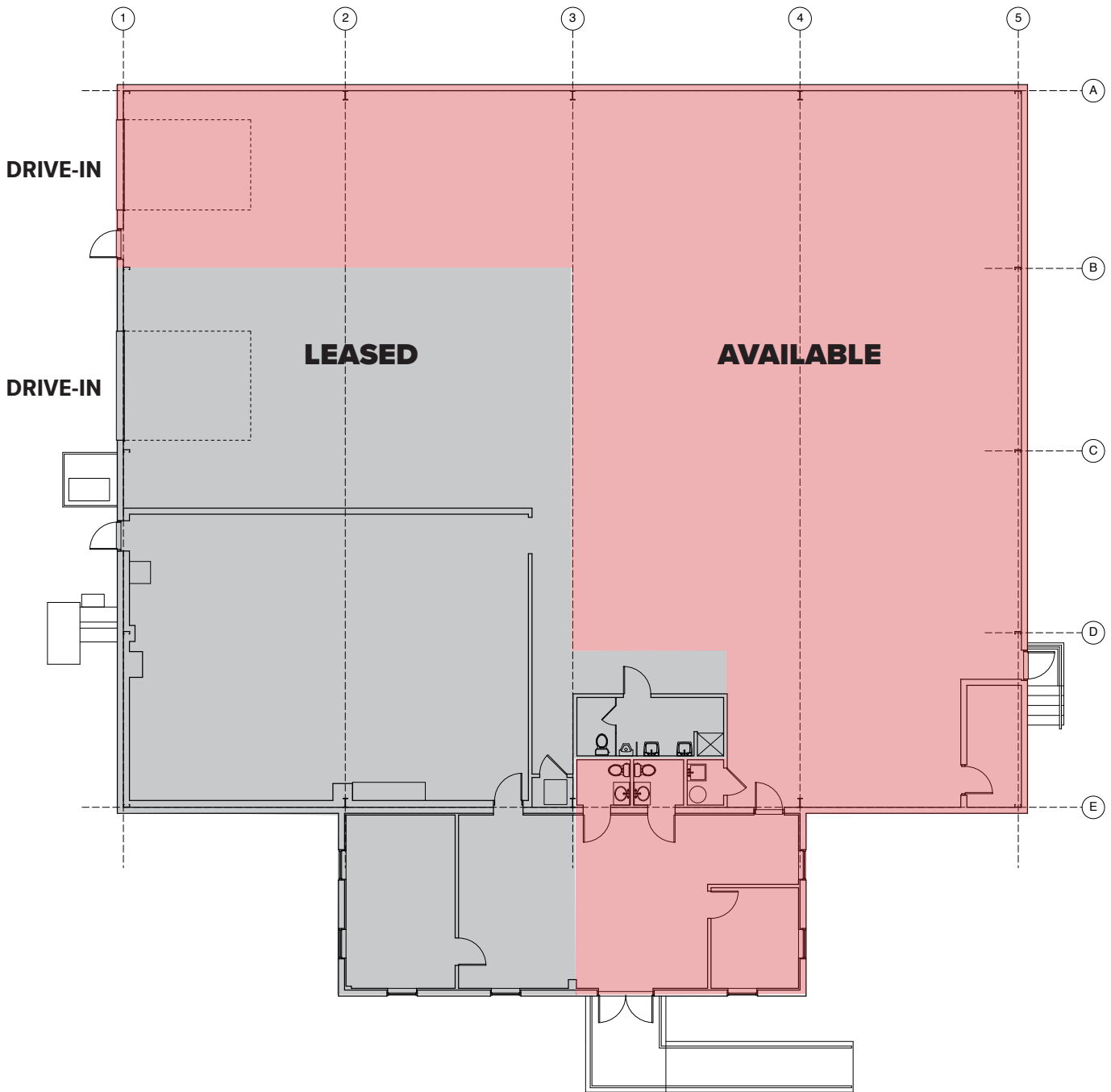

## CONTACT

**JONATHAN KLEAR**

+1 856 433 1801

jonathan.klear@naimertz.com

**Naimertz**

# LOCATION INFORMATION

2727 FIRE ROAD EGG HARBOR TWP, NJ



## DISTANCE TO:

Garden State Parkway	0.8 mi
Atlantic City Expressway	1.3 mi
Atlantic City	7.5 mi
Philadelphia	53 mi
New York City	119 mi

## CONTACT

**JONATHAN KLEAR**

+1 856 433 1801

jonathan.klear@naimertz.com

**NAIMertz**