

# 31

## ALEXANDRIA WAY

ALEXANDRIA  
CENTER® FOR  
LIFE SCIENCE  
DURHAM

LAB / OFFICE  
AVAILABLE  
IMMEDIATELY



ALEXANDRIA®  
*Building the Future of Life-Changing Innovation®*



AMPHITHEATER



TREEHOUSE  
CONFERENCING



exos



# FLOOR PLANS

**FOURTH FLOOR**  
LAB / OFFICE  
AVAILABLE  
IMMEDIATELY

DELIVERED  
Q2 2025

MOVE-IN READY

## FOURTH FLOOR Spec Lab

[VIEW PHOTOS](#)

**SUITE 420 (5,587 RSF)**

**SUITE 460 (6,564 RSF)**

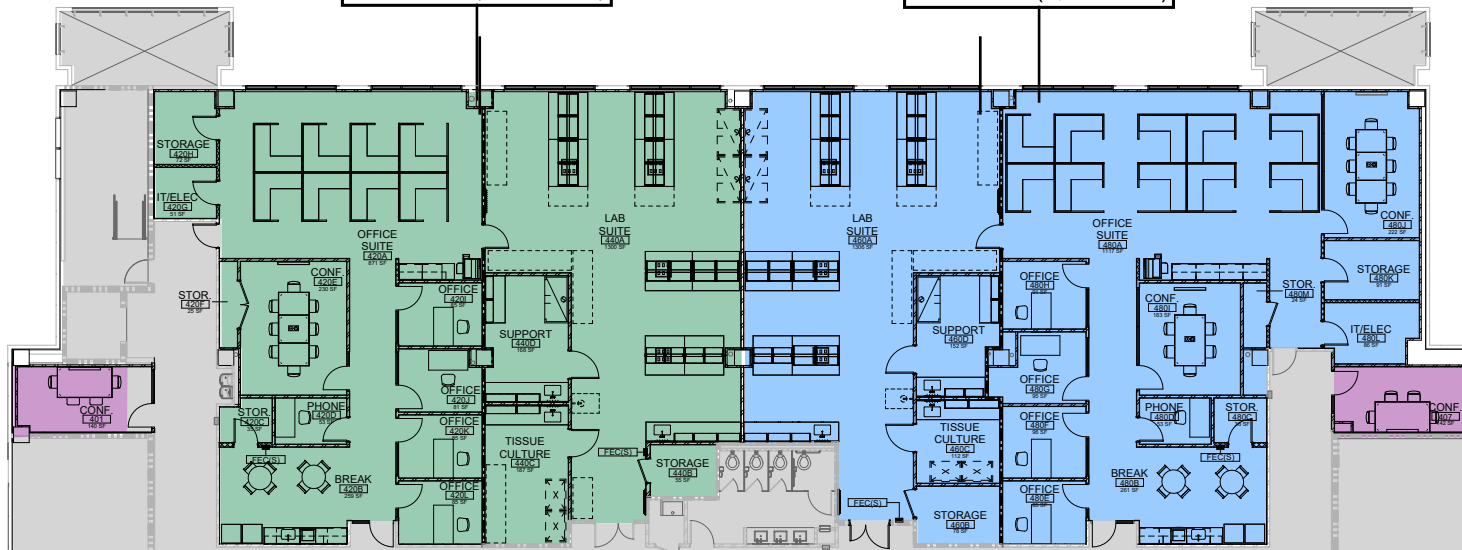

**SUITE 430 (6,730 RSF)**

**SUITE 490 (6,470 RSF)**

[VIEW PHOTOS](#)

# PHOTOS

**FOURTH FLOOR**  
LAB / OFFICE  
AVAILABLE  
IMMEDIATELY

DELIVERED  
Q2 2025



LAB



LAB SUPPORT ROOM



OPEN OFFICE



OFFICES & HALLWAY



BREAK ROOM



OPEN OFFICE

◀ [BACK TO FLOOR PLAN](#)



# PHOTOS

**FOURTH FLOOR**  
LAB / OFFICE  
AVAILABLE  
IMMEDIATELY

DELIVERED  
Q2 2025



LAB



LAB



OPEN OFFICE



OFFICES & HALLWAY



BREAK ROOM



OPEN OFFICE & CONFERENCE ROOM

◀ [BACK TO FLOOR PLAN](#)



# LOCATION INNOVATION TALENT CAPITAL

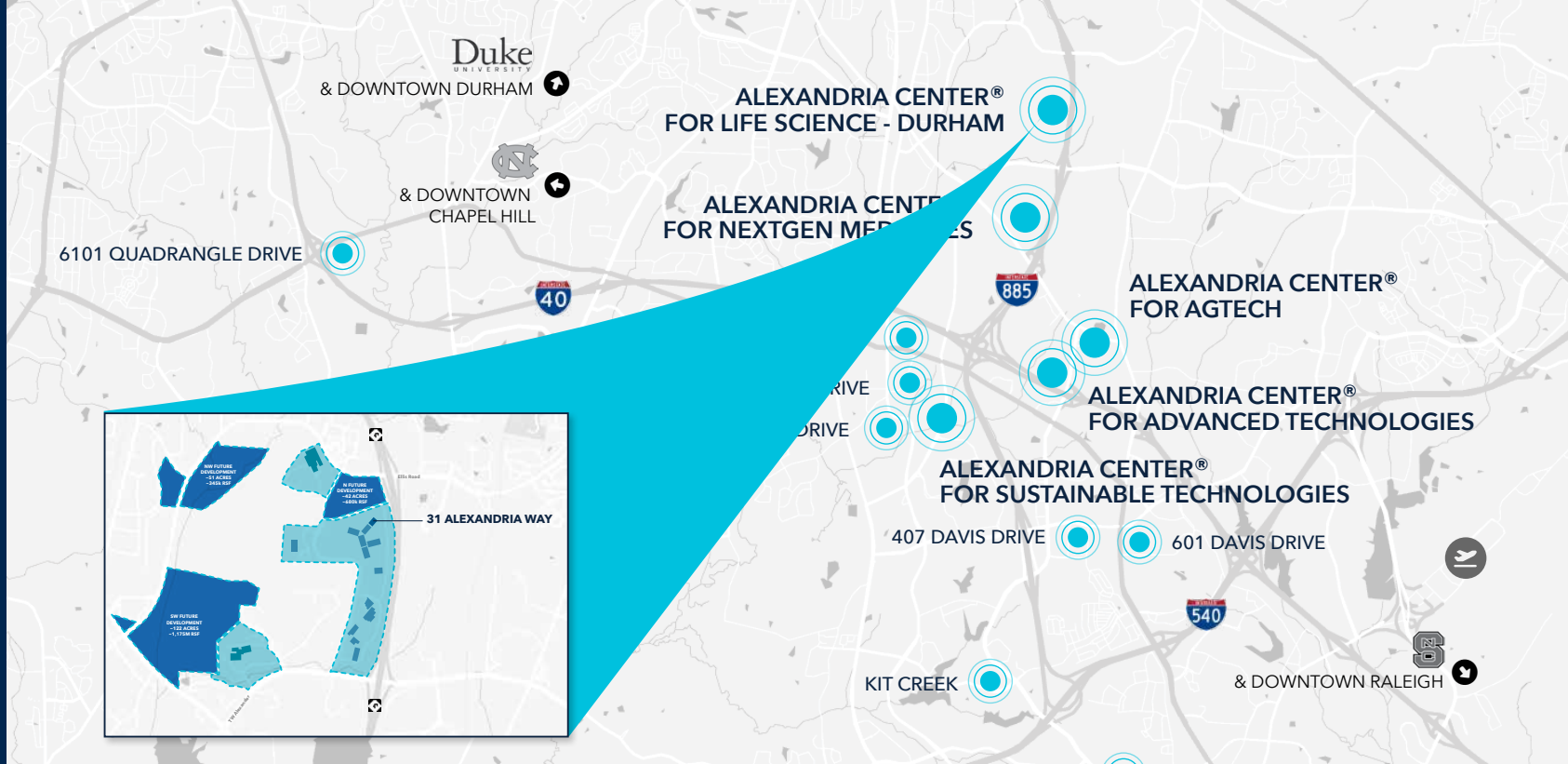

ALEXANDRIA®

*Building the Future of Life-Changing Innovation®*

Alexandria Real Estate Equities, Inc. (NYSE:ARE), an S&P 500® urban office REIT, is the first and longest-tenured owner, operator, and developer uniquely focused on collaborative life science, technology and agtech campuses in AAA innovation cluster locations, including Greater Boston, San Francisco Bay Area, New York City, San Diego, Seattle, Maryland, and Research Triangle. Alexandria has a longstanding and proven track record of developing Class A properties clustered in life science, technology, and agtech campuses that provide our innovative tenants with highly dynamic and collaborative environments that enhance their ability to successfully recruit and retain world-class talent and inspire productivity, efficiency, creativity, and success. For more information, please visit [www.are.com](http://www.are.com).

## CONTACT

Alexandria Real Estate Equities, Inc., 12 Davis Drive, Research Triangle Park, NC 27709

**RT LEASING**  
M: 984.259.2870  
[rtleasing@are.com](mailto:rtleasing@are.com)

**H. LEE CLYBURN, SIOR**  
M: 919.649.5996  
[lee.clyburn@cbre.com](mailto:lee.clyburn@cbre.com)

**BRIAN CARR, CCIM**  
M: 919.274.0595  
[brian.carr@cbre.com](mailto:brian.carr@cbre.com)