

Available SF 71,800 SF

Industrial For Lease

Building Size 71,800 SF



Property Name: Prologis South Bay Industrial Center 3
Address: 737 W Artesia Blvd, Compton, CA 90220
Cross Streets: W Artesia Blvd/S Wilmington Ave

Freeway Frontage with Great Visibility
7,691 Square Feet of Refurbished Offices
10 Dock High Truck Positions - 1 Ground Level Door
New LED Warehouse Lights
Professional Prologis Ownership/Management

Lease Rate/Mo: TBD
Lease Rate/SF: TBD
Lease Type: NNN / Op. Ex: \$0.31
Available SF: 71,800 SF
Minimum SF: 71,800 SF
Prop Lot Size: 3.45 Ac / 150,282 SF
Term: 5 Years
Sale Price: NFS
Sale Price/SF: NFS
Taxes: \$79,170 / 2024
Yard: Fenced / Paved
Zoning: MH

Sprinklered: Yes
Clear Height: 22'
GL Doors/Dim: 1
DH Doors/Dim: 10
A: 800 V: 277/480 O: 3 W: 4
Construction Type: TILT UP
Const Status/Year Blt: Existing / 1975R19
Whse HVAC: No
Parking Spaces: 70 / **Ratio:** 1.0:1
Rail Service: No
Specific Use: Warehouse/Distribution

Office SF / #: 7,691 SF / 4
Restrooms: 3
Office HVAC: Heat & AC
Finished Ofc Mezz: 0 SF
Include In Available: No
Unfinished Mezz: 0 SF
Include In Available: No
Possession: Now
Vacant: Yes
To Show: Call broker
Market/Submarket: Carson/Compton
APN#: 7318-013-022

Listing Company: CBRE - El Segundo

Agents: [Greg Dyer 310-363-4953](#), [Tres Reid 310-363-4948](#), [Caroline Reid 310-947-4219](#)
Listing #: 43329098

Listing Date: 09/09/2025

FTCF: CB300N000S000

Notes: Prologis clear lease 2025. OpEx estimated at \$0.31 PSF. Free standing building. 2 truck positions via exterior dock. .33 gpm/3,000 SF calculated sprinkler system. Lessee to verify all specifications.



Unlock the full potential of your warehouse with one strategic, single-source partner.

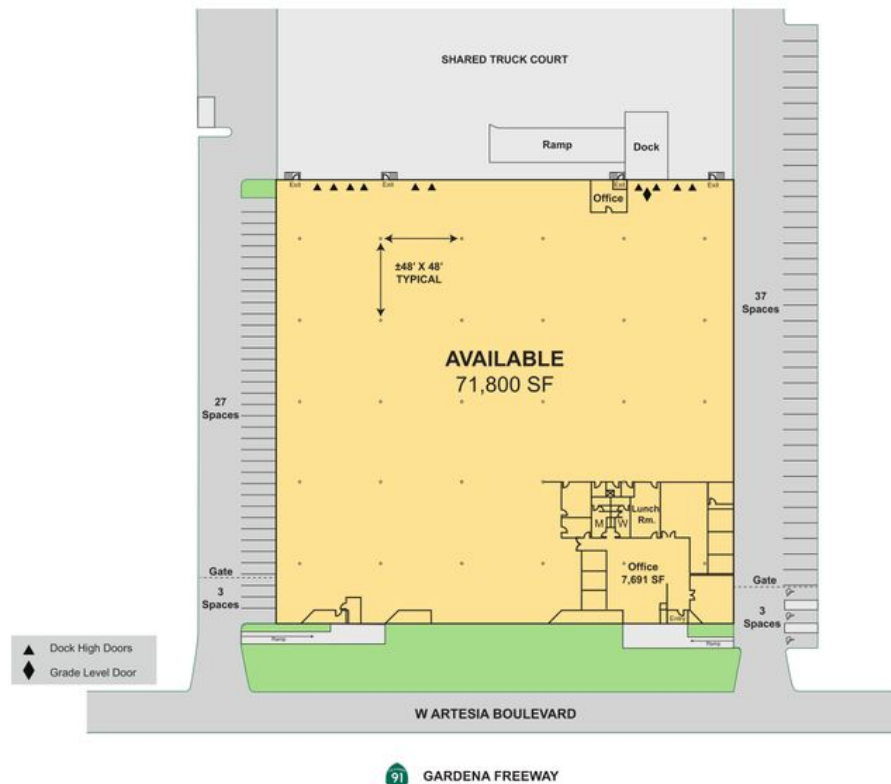

CBRE

CBRE

Tres Reid

tres.reid@cbre.com

ph +1 310 363 4948

2221 Rosecrans Ave., Ste. 100

El Segundo, CA 90245

Lic. 00975748

CBRE

Greg Dyer

greg.dyer@cbre.com

ph +1 310 363 4953

2221 Rosecrans Ave., Ste. 100

El Segundo, CA 90245

Lic. 01199659

CBRE

Caroline Reid

caroline.reid@cbre.com

ph +1 310 947 4219

2221 Rosecrans Ave., Ste. 100

El Segundo, CA 90245

Lic. 02188038

Prologis

Lisa Reddy

lreddy@prologis.com

ph +1 562 345 9206

2141 Rosecrans Ave., Ste. 1151

El Segundo, CA 90245

Lic. 01327922

All rights reserved. No warranty or representation, expressed or implied, is made as to the accuracy of the information contained herein, and same is submitted subject to error and omissions.