

# INDUSTRIAL/FLEX FOR LEASE

## 1113 NORTH POINT RD

1113 North Point Rd, Dundalk, MD 21222

Available: 1,500 SF



COMMERCIAL REAL ESTATE SERVICES



### LISTING DATA

**AVAILABLE SF:** 1,500 SF

### PROPERTY INFORMATION

**SUBMARKET:** Baltimore County East

### BUILDING DATA

**TOTAL BUILDING SF:** 16,500 SF

**YEAR BUILT:** 1983

**ZONING:** BR (Baltimore County)

### PROPERTY HIGHLIGHTS

- Unit D: 1,500 SF - Heated with one bathroom & one oversized 12'h x 12'w drive in door
- Ceiling Height: 15'
- 75+ parking spaces
- Built up roof | Concrete floor | Ceiling hung heating system
- Automotive allowed
- Close proximity to I-695, I-895, & I-95

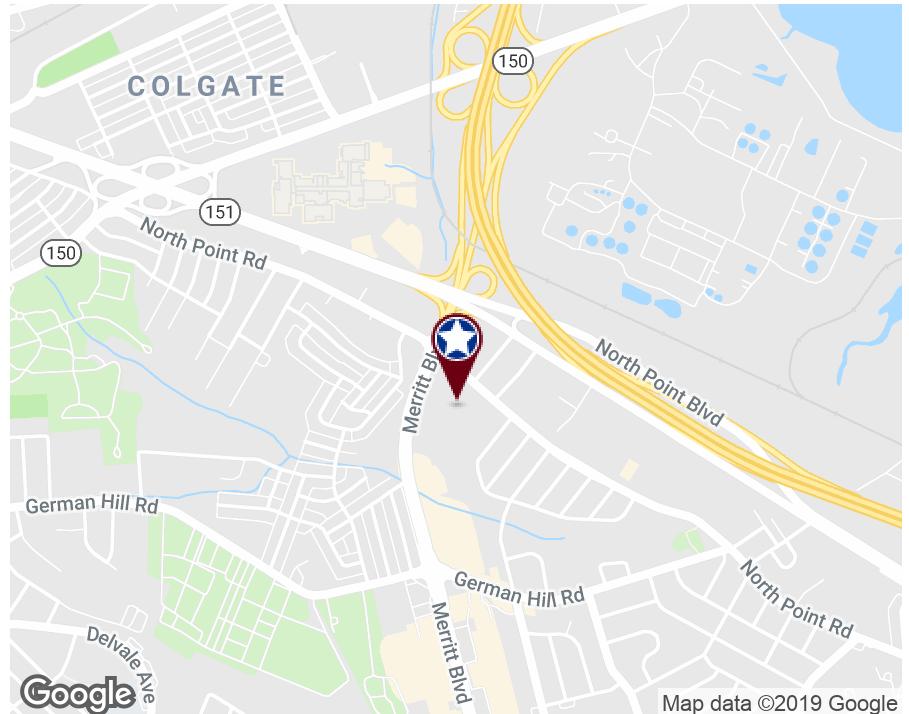

**Allan Riorda, SIOR**  
President & Principal  
443.741.4040  
ariorda@lee-associates.com

**Marley Welsh**  
Senior Associate  
443.741.4050  
mwelsh@lee-associates.com

All information furnished regarding property for sale, rental or financing is from sources deemed reliable, but no warranty or representation is made to the accuracy thereof and same is submitted to errors, omissions, change of price, rental or other conditions prior to sale, lease or financing or withdrawal without notice. No liability of any kind is to be imposed on the broker herein.

# INDUSTRIAL/FLEX FOR LEASE

## 1113 NORTH POINT RD

1113 North Point Rd, Dundalk, MD 21222

Available: 1,500 SF

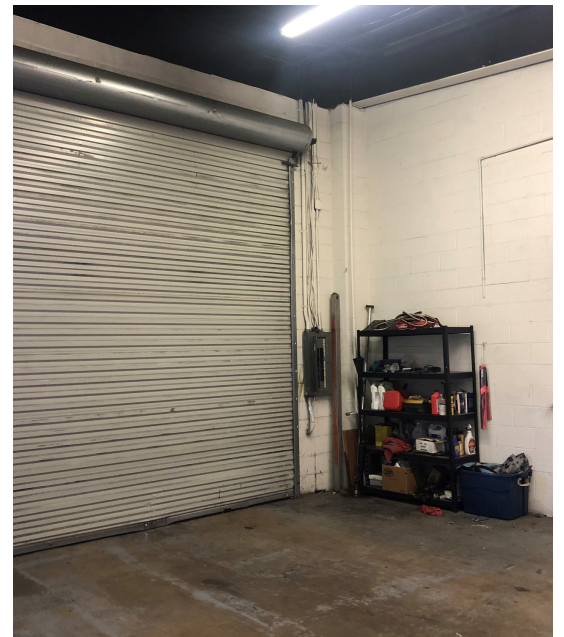

**Allan Riorda, SIOR**  
President & Principal  
443.741.4040  
ariorda@lee-associates.com

**Marley Welsh**  
Senior Associate  
443.741.4050  
mwelsh@lee-associates.com

All information furnished regarding property for sale, rental or financing is from sources deemed reliable, but no warranty or representation is made to the accuracy thereof and same is submitted to errors, omissions, change of price, rental or other conditions prior to sale, lease or financing or withdrawal without notice. No liability of any kind is to be imposed on the broker herein.