

U.S. Highway 90 ROW

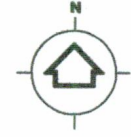

Point of Beginning
concrete monument found the
intersection of the east margin of
Victor Street and the south
margin of U.S. Highway right-of-way

PAINTED LINE FOR
AT&T CABLE

SERVICE ROAD
ASPHALT SURFACED

24.3

N 82°07'00" E
97.44ft
CONCRETE PARKING
CONCRETE CURB
"X" MARK IN CONCRETE

SCALE: 1" = 60'

CLASS "B" SURVEY

REFERENCE BEARING-
SOUTH MARGIN OF U.S. HIGHWAY
RIGHT-OF-WAY AS PER DEED
BOOK 1086 PAGE 741

METAL LID FOR
UNDERGROUND
UTILITY

MAGNOLIA

FIRE HYDRANT

Property owner
J&K Investments of
Mississippi Inc.

PAINTED LINE
FOR GAS COMPANY

S 07°36'18" E 309.08ft

VICTOR STREET
ASPHALT SURFACED

containing 0.82 acres or
35760.05 square feet
more or less.

Title Commitment File Number 2013-04-015
(revised)
prepared by Chicago Title Company,
agent for First American Title
Insurance Company.
effective date - January 13, 2014

1.6ft

CHAINLINK
FENCE

SMH
CLEANOUT

FIRE HYDRANT

CONCRETE
MONUMENT

26.0ft
IRON ROD
SET

Property owner
J&K Investments of Mississippi Inc.

Legal Description:

A parcel of land situated in the City of Pascagoula, Jackson County, Mississippi,
Section 1, Township 8 South, Range 6 West, and being situated in Part of Lot
75 of Sidoine Krebs Tract, and more particular described as follows,
to wit:

Drawing Name:
Ihop-Pascagoula-final.dgn

Beginning at a concrete monument found the intersection of the east margin of Victor Street
and the south margin of U.S. Highway 90 right-of-way, thence run North 82 degrees 07 minutes
00 seconds East along the right-of-way a distance of 97.44 feet to an "X" mark set in concrete;
thence South 07 degrees 36 minutes 18 seconds East a distance of 309.08 feet to a concrete
monument; thence South 82 degrees 26 minutes 43 seconds West a distance of 134.17 feet
to an iron rod set on the east margin of Victor Street; thence North 00 degrees 48 minutes
34 seconds West along the east margin a distance of 310.68 feet to the Point of Beginning;
containing 0.82 acres or 35760.05 square feet more or less.

INFORMATION PROVIDED
BY CLIENT

BY GRAPHIC PLOTTING ONLY

ZONE " X "
MAP NUMBER 28059C 0431 G
EFFECTIVE DATE 3/16/2009

Certification:

To EH Pascagoula Holdings, LLC, a Delaware limited liability company, Chicago Title Company,
and First American Title Insurance Company: This is to certify that this survey was actual
made on the ground as per record description and is correct; there are no encroachments either
way across property lines except as shown; all dimensions and other data shown hereon are true
and correct to the best of my knowledge and belief.

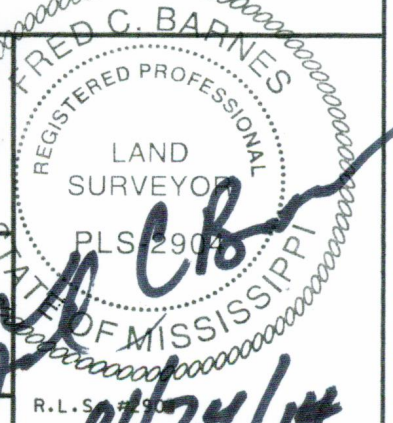

DESCRIPTION:

A parcel of land situated in the City of Pascagoula, Jackson County, Mississippi,
Section 1, Township 8 South, Range 6 West, and referenced in Deed Book 1223,
Page 496 and in Book 1086, Page 741.

The property described and depicted is one and the same as the property described
in the deed to NPC International, Inc., recorded in Deed Book 1223 at Page 496