

**42274 RIO NEDO
TEMECULA, CA 92590**

**FOR LEASE
± 975—2152 SF FLOORPLANS
INDUSTRIAL UNITS**



JACKIE BEAUCHAMP

(951) 684-1251 | jbeauchamp@mcgre.com

DRE License # #01461175 | #01899258



**MARTIN
COMMERCIAL
GROUP**

Commercial Real Estate Services

WWW.MCGRE.COM

**42274 RIO NEDO
TEMECULA, CA 92590**

**FOR LEASE
± 975—2152 SF FLOORPLANS
INDUSTRIAL UNITS**

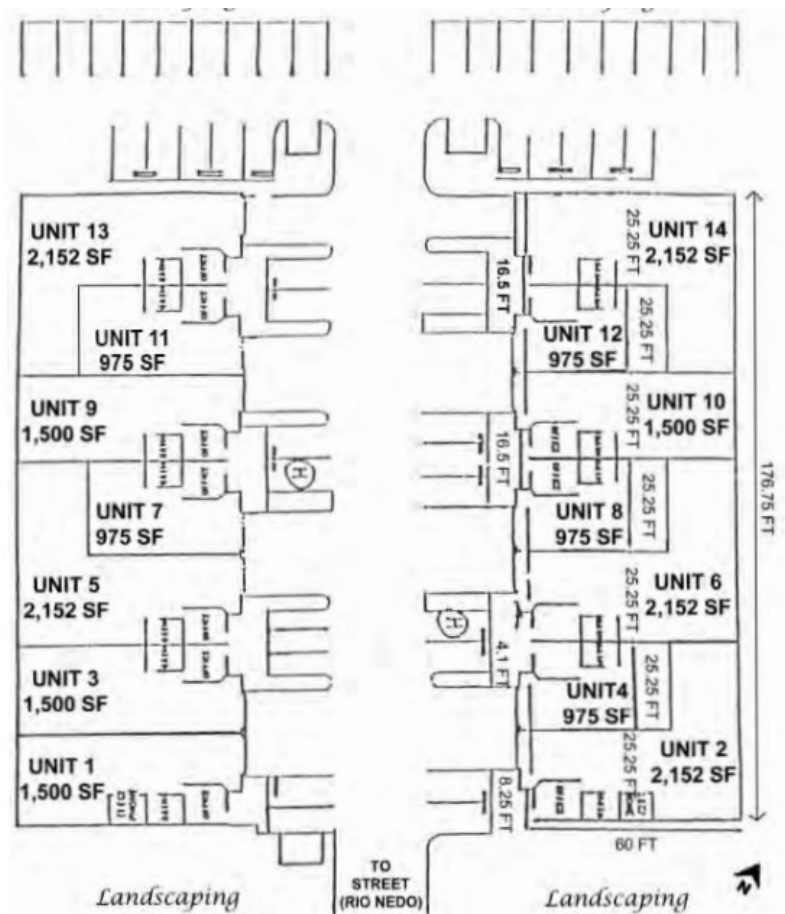

PROPERTY HIGHLIGHTS

- 21,685 SF Multi-Tenant Complex
- 14 Suites Ranging from 975-2152 SF
- Office/Warehouse Combinations
- 10x12 Roll Up Grade Level Doors
- LI Zoning (Verify)
- No CAM fees, Water/On-Site Trash Generated Included
- CALL AGENT TO SHOW!



**MARTIN
COMMERCIAL
GROUP**
Commercial Real Estate Services

The information contained herein has been obtained from sources we deem reliable. While we have no reason to doubt its accuracy, we do not guarantee it.

CORPORATE OFFICE: 1495 E. WARNER AVENUE ~ SANTA ANA, CA 92705
Orange County 714-241-1141
Inland Empire: 951-684-1251

42274 RIO NEDO TEMECULA, CA 92590

FOR LEASE
± 975—2152 SF FLOORPLANS
INDUSTRIAL UNITS

Example Interior Photos, do not always reflect exact suites available for lease



The information contained herein has been obtained from sources we deem reliable. While we have no reason to doubt its accuracy, we do not guarantee it.

CORPORATE OFFICE: 1495 E. WARNER AVENUE ~ SANTA ANA, CA 92705
Orange County 714-241-1141
Inland Empire: 951-684-1251

**42274 RIO NEDO
TEMECULA, CA 92590**

**FOR LEASE
± 975—2152 SF FLOORPLANS
INDUSTRIAL UNITS**

AVAILABILITY

SUITE	SQ. FT.	BASE RENT	CAM	DESCRIPTION	AVAIL. DATE
Suite 3	1,500	\$2,325.00 (1.55MG)	No CAM Water & On-Site Trash Included	1 Office, Warehouse & Restroom, 1 Grade Level Loading Door (10x12)	10/15/2025

The information contained herein has been obtained from sources we deem reliable. While we have no reason to doubt its accuracy, we do not guarantee it.

CORPORATE OFFICE: 1495 E. WARNER AVENUE ~ SANTA ANA, CA 92705
Orange County 714-241-1141
Inland Empire: 951-684-1251