

TENANT SCHEDULE			
GROSS AREA	NET AREA	NO.	TENANT NAME
3,704	3,271	300	BURGESS & NIPLE
2,212	1,953	301	AVAILABLE
3,400	3,002	302	GSA
1,125	994	310	FULL CIRCLE INVESTMENTS
1,257	1,110	312	SUEBERT & ASSOCIATES
4,018	3,548	320	UPMC
90	90	S-7	MCPC
291	257	BUILDING SYSTEMS	
16,097	-	TOTAL RENTABLE FLOOR AREA	
-	14,225	TOTAL USEABLE FLOOR AREA	
-	1,872	COMMON FLOOR AREA	
605	605	VERTICAL PENETRATIONS	
16,702	16,702	GROSS MEASURED AREA	

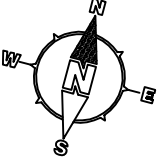
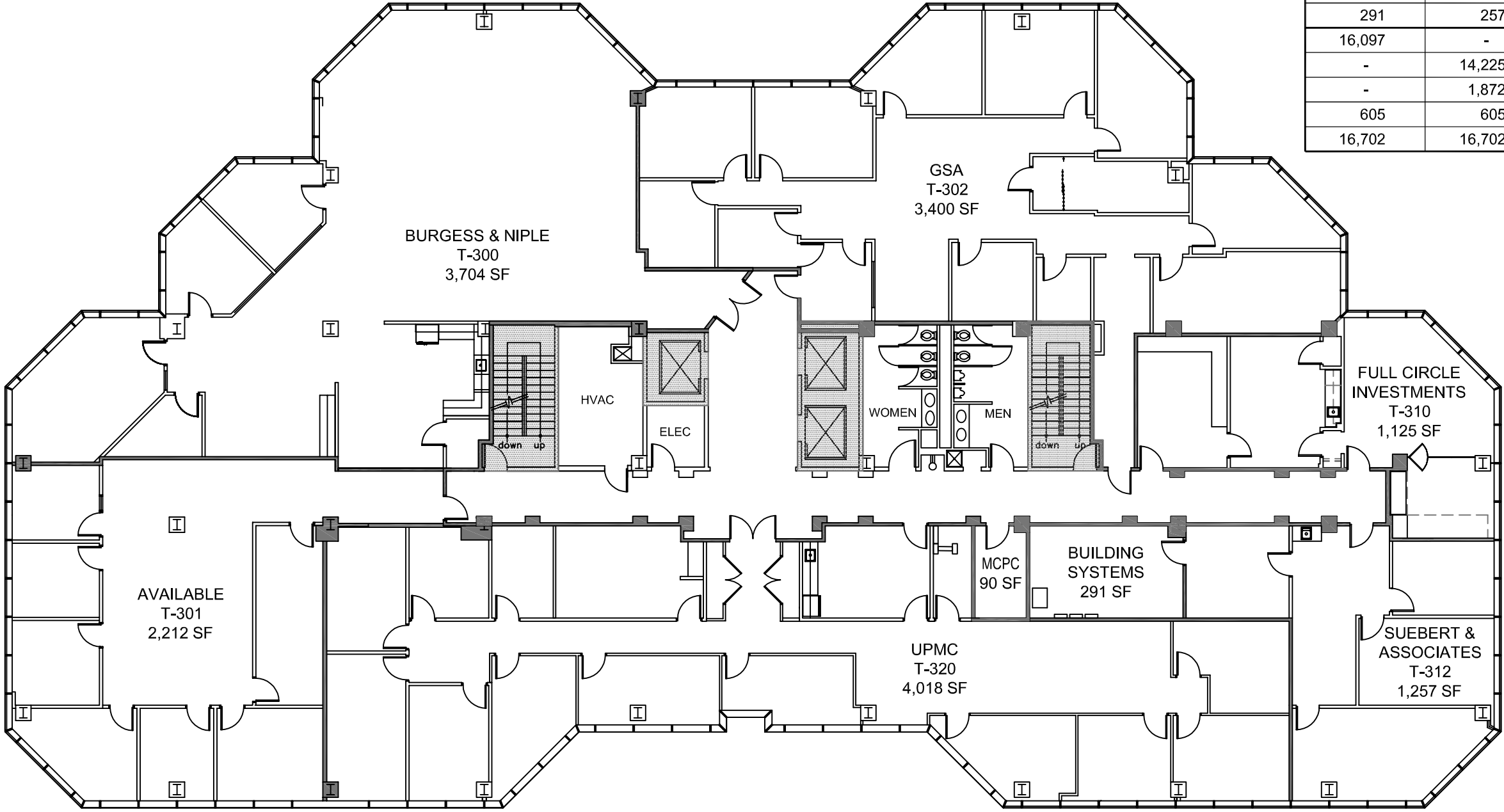

**THIRD FLOOR PLAN**  
SCALE: 1/16"=1'-0"

THIS DRAWING SHOWS APPROXIMATE LOCATIONS OF THE DEMISED PREMISES. LANDLORD RESERVES THE RIGHT TO CHANGE THE NAME AND LOCATIONS OF OTHER TENANTS, NUMBER OF ROOMS, PARKING ARRANGEMENTS, ENTRANCES, SERVICE AREAS, ETC.

**GARY MATCZAK ARCHITECTS**  
4509 WEST RIDGE ROAD  
ERIE, PA. 16506  
814-836-8500

100 STATE STREET  
100 STATE STREET  
ERIE, PENNSYLVANIA 16507



THIRD FLOOR PLAN

NO.	DATE	REVISION

**3**

PROJECT NO.	2030
DATE	13 OCT 2023