

FOR LEASE ±59,600 SF INDUSTRIAL BUILDING

2210 DAVIE AVENUE
COMMERCE, CA 90040

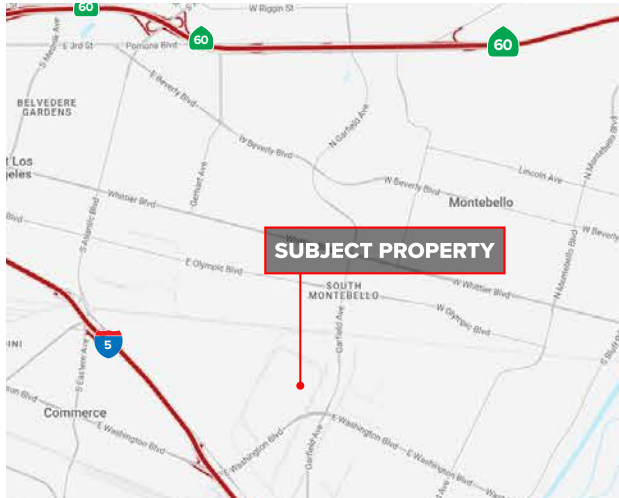

RENOVATIONS UNDERWAY



PRICING SUMMARY:

LEASE RATE ▶
\$53,044/MO
(\$0.89 PER SF NNN; OPEX: \$0.10)

PROPERTY HIGHLIGHTS



**VERSATILE
MANUFACTURING
DISTRIBUTION
BUILDING**



HEAVY POWER



20' CLEARANCE



**5 DOCK HIGH
1 GROUND LEVEL**



**CENTRALLY
LOCATED IN
THE HEART OF
COMMERCE**



**GREAT ACCESS TO
5 & 710 FREEWAYS**

Peter D. Bacchi SIOR

Executive VP, Principal | LIC NO 00946253
pbacchi@lee-associates.com
323.767.2022

Lottie Zha

Principal Broker | LIC NO 02059248
rslottiezha@gmail.com
626.773.6477

Lee & Associates | Los Angeles Central
5675 Telegraph Rd, Ste 300, Commerce, CA 90040

300 East Bonita Ave, Unit 3576, San Dimas, CA 91773

LEE & ASSOCIATES
COMMERCIAL REAL ESTATE SERVICES

IA IG BACCI-TSAPARIAN-GORMLY
INDUSTRIAL GROUP

LEE-ASSOCIATES.COM
CORP ID 01125429

The information contained herein is obtained from sources believed to be reliable. However, we have not verified it and make no guarantees, warranties or representations as to the completeness or accuracy thereof. The presentation of this property is used for example and is submitted subject to errors, omissions, change of price or conditions, and is subject to prior sale, lease or withdrawal without notice.

±59,600 SF Industrial Building

2210 DAVIE AVE • COMMERCE

PROPERTY SITE PLAN

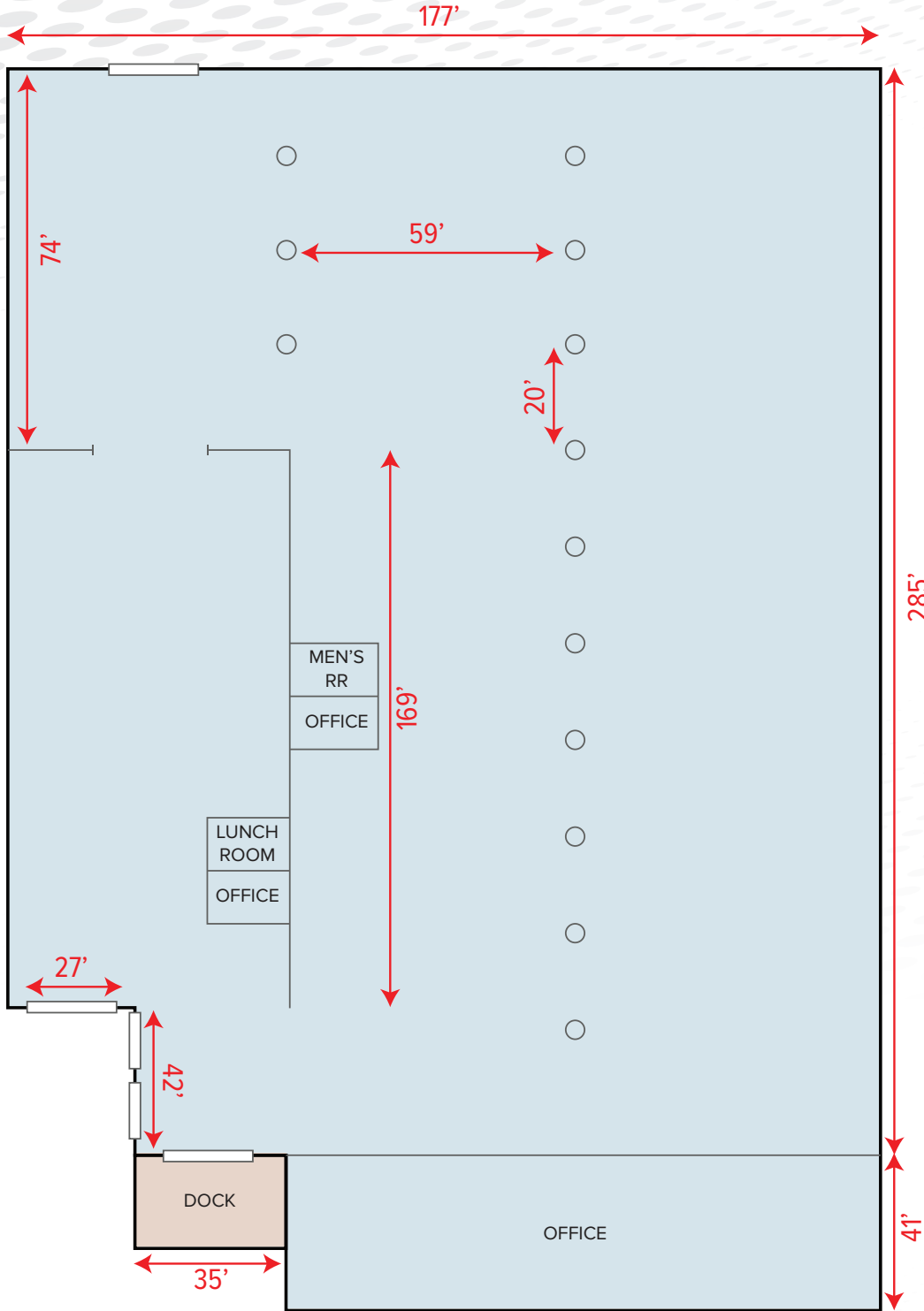

NOTE: Drawing not to scale. All measurements and sizes are approximate.

Peter D. Bacchi SIOR

Executive VP, Principal | LIC NO 00946253
pbacchi@lee-associates.com
323.767.2022

Lottie Zha

Principal Broker | LIC NO 02059248
rslottiezha@gmail.com
626.773.6477

Lee & Associates | Los Angeles Central
5675 Telegraph Rd, Ste 300, Commerce, CA 90040

300 East Bonita Ave, Unit 3576, San Dimas, CA 91773



LEE-ASSOCIATES.COM
CORP ID 01125429

The information contained herein is obtained from sources believed to be reliable. However, we have not verified it and make no guarantees, warranties or representations as to the completeness or accuracy thereof. The presentation of this property is used for example and is submitted subject to errors, omissions, change of price or conditions, and is subject to prior sale, lease or withdrawal without notice.

±59,600 SF Industrial Building

2210 DAVIE AVE • COMMERCE

PROPERTY PHOTOS



Peter D. Bacci SIOR
Executive VP, Principal | LIC NO 00946253
pbacci@lee-associates.com
323.767.2022

Lottie Zha
Principal Broker | LIC NO 02059248
rslottiezha@gmail.com
626.773.6477

Lee & Associates | Los Angeles Central
5675 Telegraph Rd, Ste 300, Commerce, CA 90040

300 East Bonita Ave, Unit 3576, San Dimas, CA 91773

LEE & ASSOCIATES
COMMERCIAL REAL ESTATE SERVICES

IA IG BACCI • TSAPARIAN • GORMLY
INDUSTRIAL GROUP

LEE-ASSOCIATES.COM
CORP ID 01125429

The information contained herein is obtained from sources believed to be reliable. However, we have not verified it and make no guarantees, warranties or representations as to the completeness or accuracy thereof. The presentation of this property is used for example and is submitted subject to errors, omissions, change of price or conditions, and is subject to prior sale, lease or withdrawal without notice.