



For Lease

# Industrial Facility on ±2.01 Acres with I-3 Zoning

## 5310 S Harding St Indianapolis, IN 46217

### Property Highlights

- ±19,168 SF Building
- Recently updated warehouse and office finishes
- 4 Drive-in doors
- 2 Dock-high loading positions (exterior platform)
- 20' Clear height
- Crane-served with 7.5-ton & 2.0-ton bridge cranes
- ±2.01 Acres
- Zoned I-3 (Outdoor storage permitted)
- Immediate access to I-465 & I-69, offering excellent connectivity to Indy's interstate systems
- Abundant access to skilled labor
- Available for occupancy Q4 2024

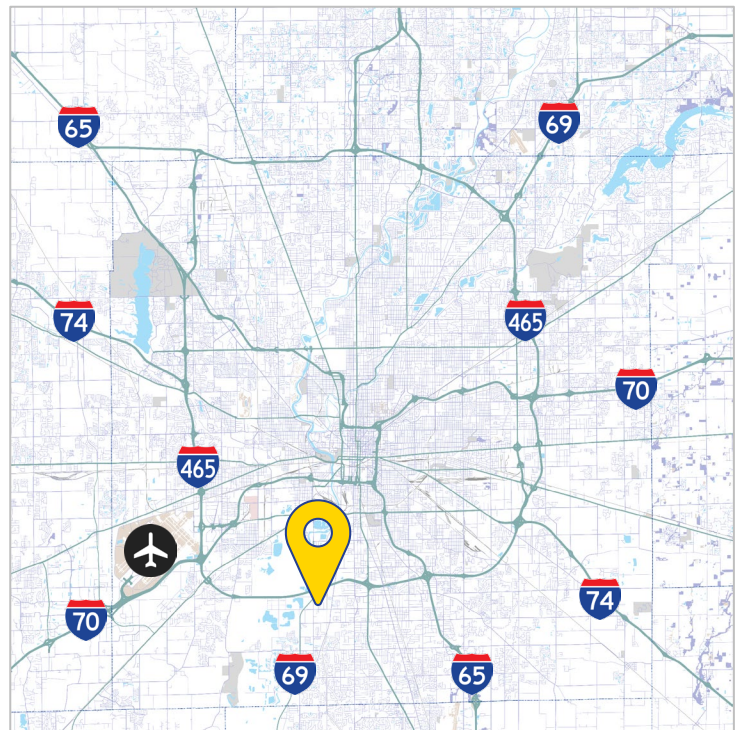

Korey Ryan, SIOR  
+1 765 520 6662  
[korey.ryan@colliers.com](mailto:korey.ryan@colliers.com)

Colliers Indianapolis  
[colliers.com](http://colliers.com)

# Property Specifications

Building SF	±19,168 SF
Office SF	±5,081 SF
Clear Height	20'
Drive-in Doors	4
Dock Doors	2 Dock-high loading positions (exterior platform)
Lighting	LED fixtures
Power	1,200 amp   240 V   3-phase
Cranes	7.5-Ton bridge crane 2.0-Ton bridge crane
Land	±2.01 Acres

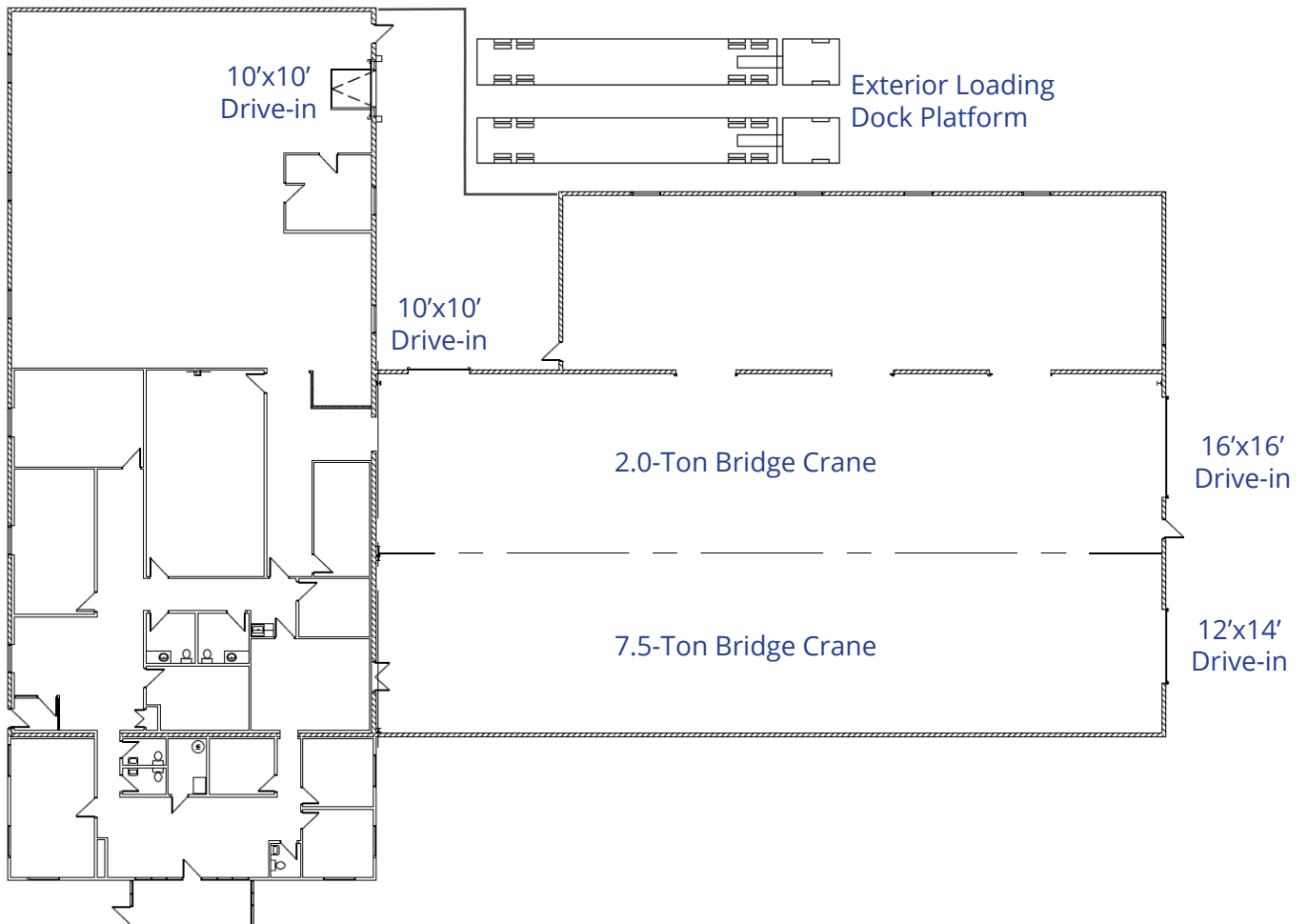



## Location

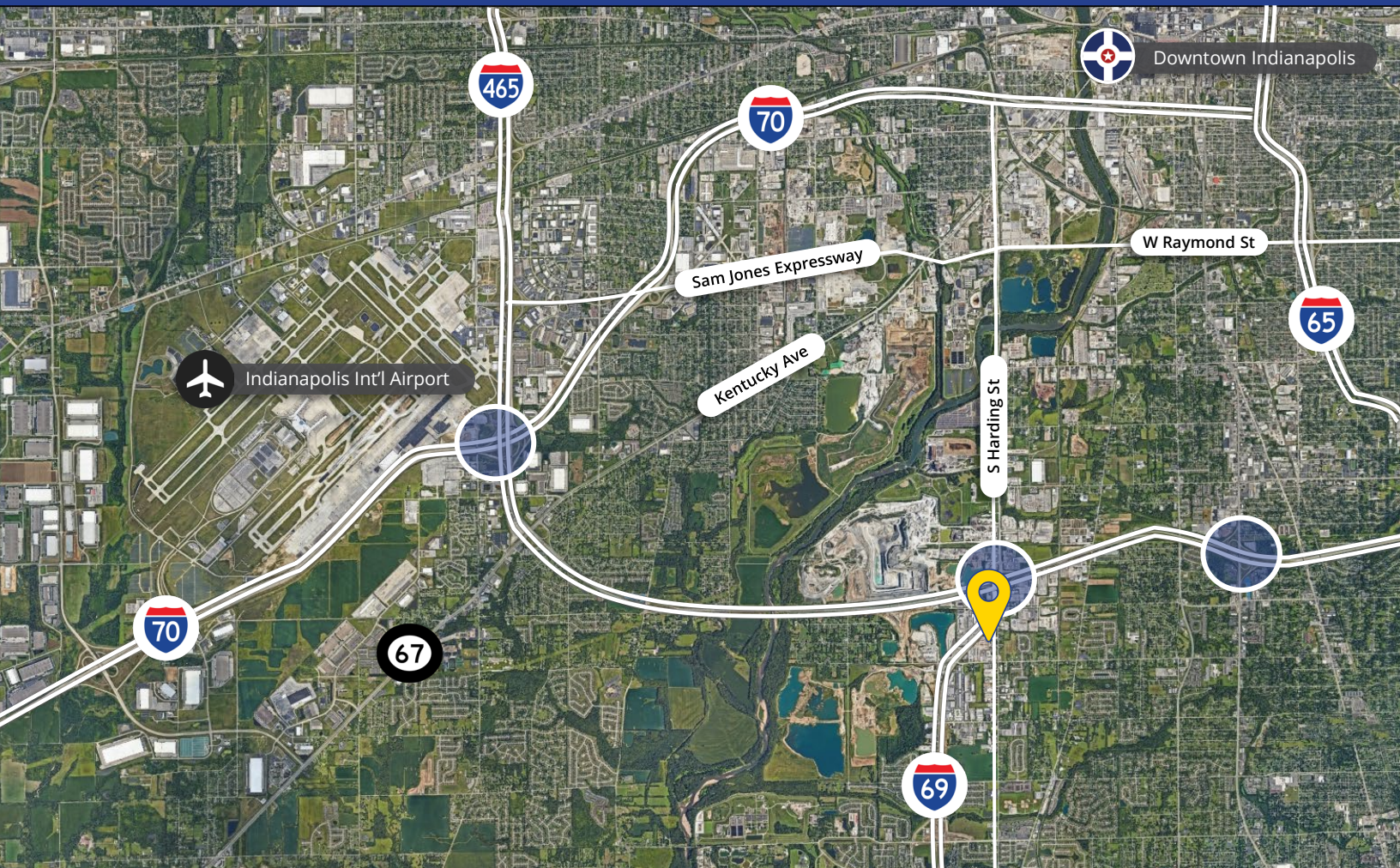

# Why Indy



## INDIANAPOLIS INT'L AIRPORT

- 2<sup>nd</sup> largest FedEx air hub worldwide
- Serves as FedEx's national aircraft maintenance operations
- 8<sup>th</sup> largest cargo airport in U.S
- 11<sup>th</sup> year named "Best Airport in North America"



## INDIANA AIRPORTS — LOGISTICS NETWORK

- Commercial/Freight users have 5 airports to access
- GCIA – a key economic driver in NW Indiana, awarded \$6M federal grant to expand/upgrade its air cargo infrastructure



- IND** Indianapolis Int'l Airport
- EW** Evansville Regional Airport
- FWA** Fort Wayne Int'l Airport
- GCIA** Gary/Chicago Int'l Airport
- SBN** South Bend Int'l Airport



## INDIANA ROADS — UNRIVALED CONNECTIVITY

- 8 interstates intersect the state making Indiana #1 in U.S. in pass-thru highways
- I-65 and I-70, both considered major NAFTA logistic corridors & part of the IFDC network (*Inland Freight Distribution Cluster*)
- 40+ major cities & 75% of U.S. population within 1-day drive
- 5<sup>th</sup> busiest state for commercial freight traffic



## INDIANA RAIL — A STRONG TRACK RECORD

- 3 Class 1 systems pass thru — CSXT, Canadian National, Norfolk Southern, plus 39 Class II & Class III railroads
- 4<sup>th</sup> in U.S. in number of railroads operating — 7<sup>th</sup> in carloads handled — 10<sup>th</sup> in millions of tons handled
- Indiana's freight traffic flow forecast to increase 60% by 2040
- Extensive transloading capabilities via privately-owned Indiana Rail Road Co., a 500-mile railroad logistics provider with national rail network access via Chicago/Indy gateways

“Over the last decade, Indiana has ranked as a Top-10 performer in landing corporate facility investment projects in the nation.”

2022 – *Site Selection Magazine*



## INDIANA PORTS — UNMATCHED ACCESS TO BIG INDUSTRY

- 3 international maritime ports provide global access to the world's most productive industrial & agricultural regions
- Bringing \$7.8B per year to Indiana's economy, handling over 25M tons of cargo yearly

- NW** Burns Harbor
- SE** Jeffersonville
- SW** Mt Vernon

\*sources: Forbes Magazine, Site Selection Magazine, Business Facilities

Korey Ryan, SIOR  
+1 765 520 6662  
korey.ryan@colliers.com

**1<sup>st</sup>**  
in U.S. for manufacturing output

**1<sup>st</sup>**  
best state to start a business

**2<sup>nd</sup>**  
# Manufacturing Jobs (% of workforce)

**3<sup>rd</sup>**  
leading state in biotechnology exports