

FITNESS / MEDICAL / OFFICE SPACE

2 WEST 86TH STREET

South West corner of West 86th Street and Central Park West

MANHATTAN

UPPER WEST SIDE | NY

8,000 SF*

For Lease

*Divisible



SPACE DETAILS

GROUND FLOOR

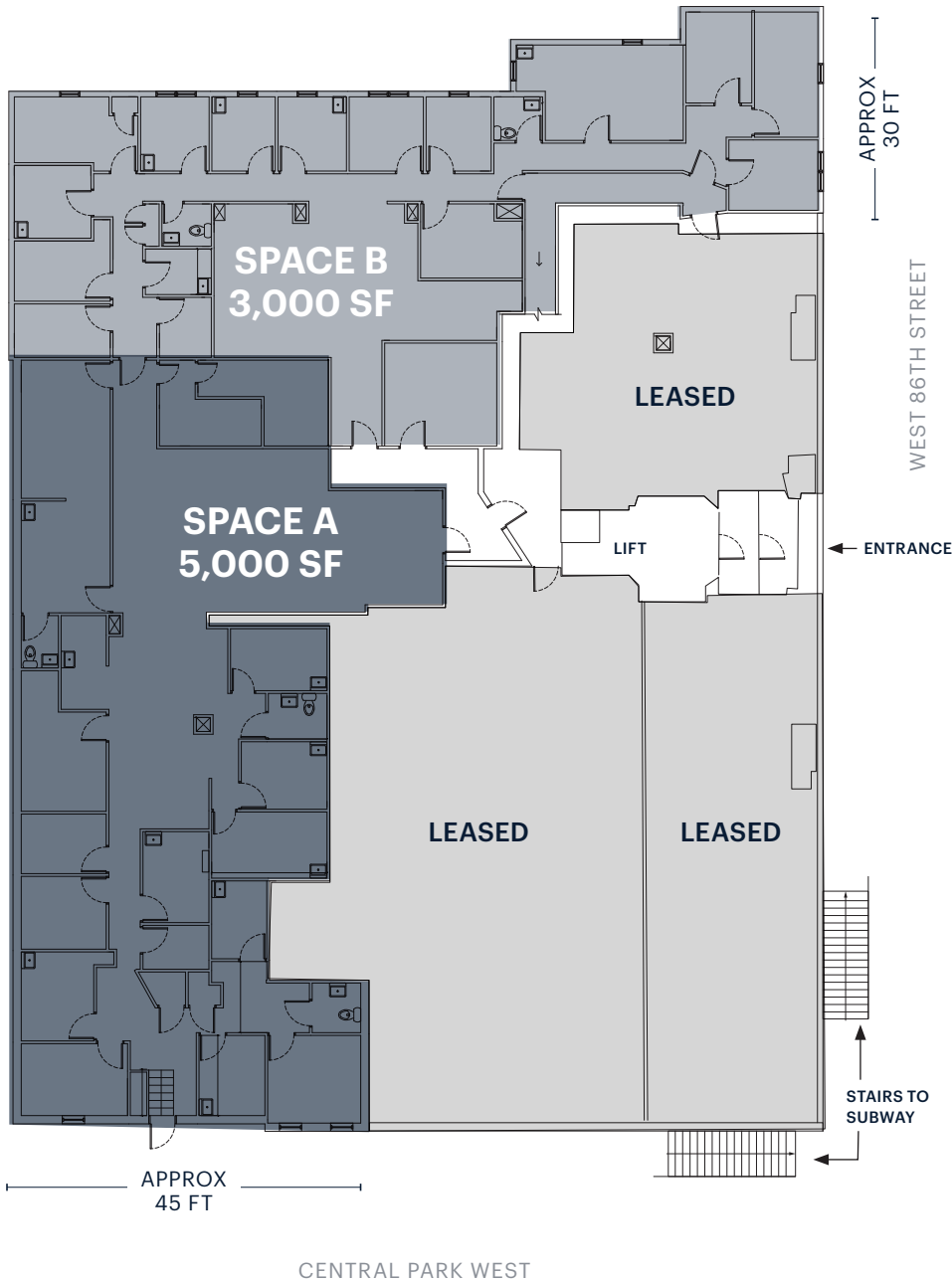

LOCATION

South West corner of West 86th Street and Central Park West

SIZE

Ground Floor 8,000 SF*
 SPACE A 5,000 SF
 SPACE B 3,000 SF

* Divisible

FRONTAGE

Central Park West,
 West 86th Street (combined) 75 FT

CEILING HEIGHTS

Ground Floor 10 FT

STATUS

Vacant

TERM

Negotiable

POSSESSION

Immediate

RENT

Upon request

NEIGHBORS

Quest Diagnostics, EOS Sleep Lab

COMMENTS

Built-out medical space
 Signage on marquee
 Central Park West frontage

TRANSPORTATION

2023 Ridership Report

Subway Station

Annual 2,486,809 **B C**
 Weekday 7,976
 Weekend 8,473

Service Bus

Annual 4,051,779 **M86**

INTERIOR PHOTOS



AREA RETAIL

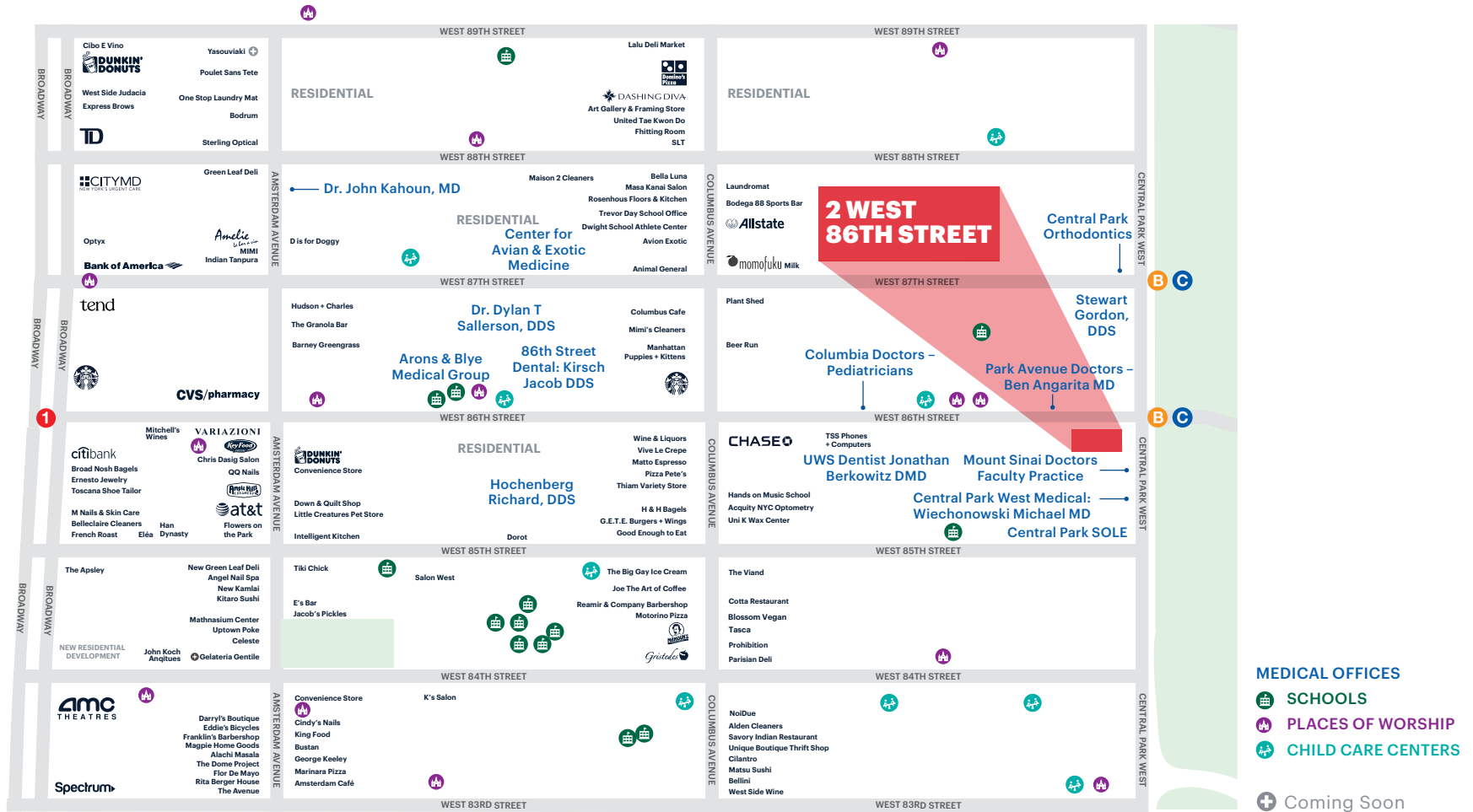

CONTACT EXCLUSIVE AGENTS

ABRAHAM R DAYAN
 adayam@ripcony.com
 212.230.5886

DOUG KLEIMAN
 dkleiman@ripcony.com
 646.827.9980

RIPCO
 REAL ESTATE

150 East 58th Street
 15th Floor
 New York, NY 10115
 212.750.6565

Please visit us at ripcony.com for more information

This information has been secured from sources we believe to be reliable, but we make no representations as to the accuracy of the information. References to square footage are approximate. Tenant or Buyer must verify the information and bears all risk for any inaccuracies.