



# 5115 Copper NE

Office, Retail or Service Building

Albuquerque  
5115 Copper Ave. NE



Demographics	1 Mile	3 mile	5 mile
Population	14,222	115,430	262,930
Med. Income	\$43,165	\$38,892	\$42,679
Day Population	12,955	98,058	221,606

Please contact us for leasing opportunities

### Available

- Commercial + Executive Office Space
- Suite A | 1,645 SF | \$2,275/Month
- Suite H | 320 SF | \$395/Month
- Suite N | 650 SF | \$675/Month

### Features

- Easy access to and from I-40.
- Excellent street exposure.
- Cannabis friendly.
- Locally owned and managed.
- Free Wi-Fi.



#### Contact

Brighton Pope  
 505.884.3578  
 Brighton.Pope@PetersonProperties.net

[PetersonProperties.net](http://PetersonProperties.net)  
 /petersonpropertiesllc  
 /petersonpropertiesllc  
 /peterson.properties



### Site Plan

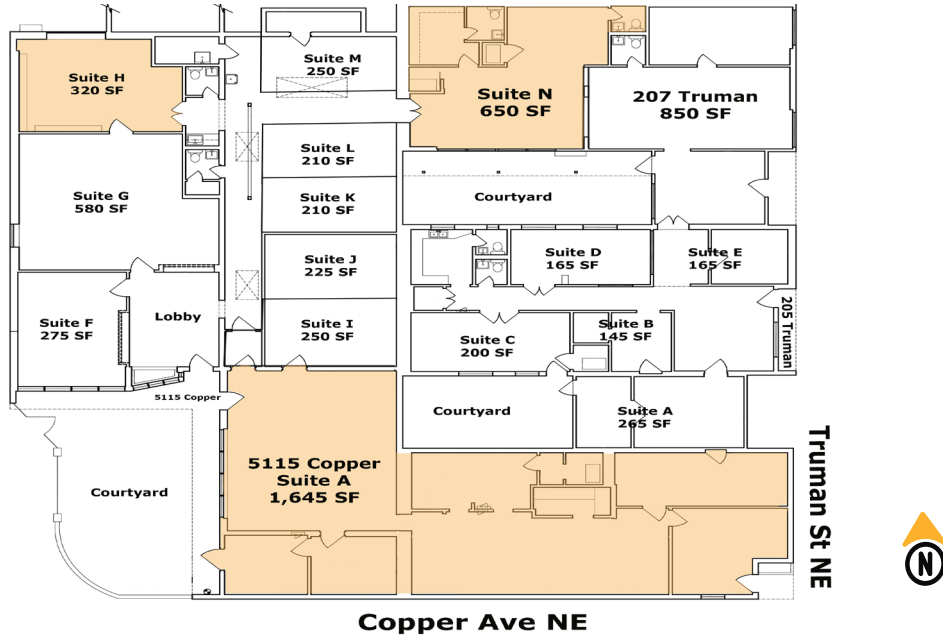

Please contact us for leasing opportunities



### Aerial Map

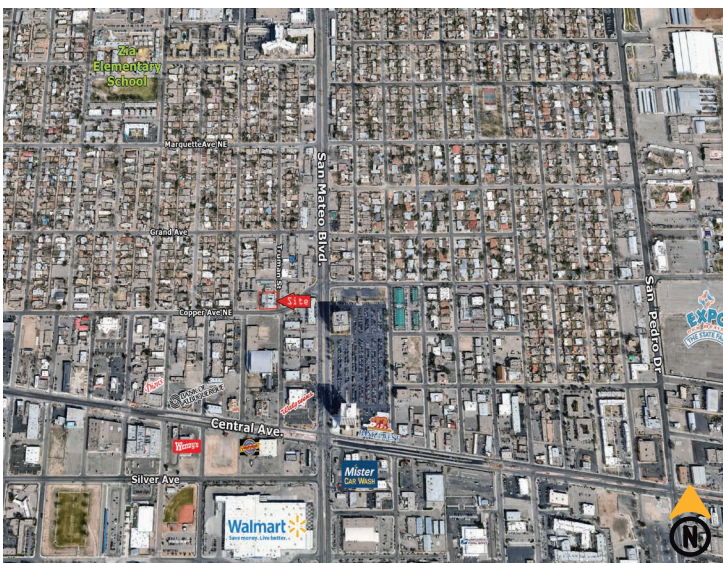

### 5115 Copper Ave. NE Albuquerque, NM 87110

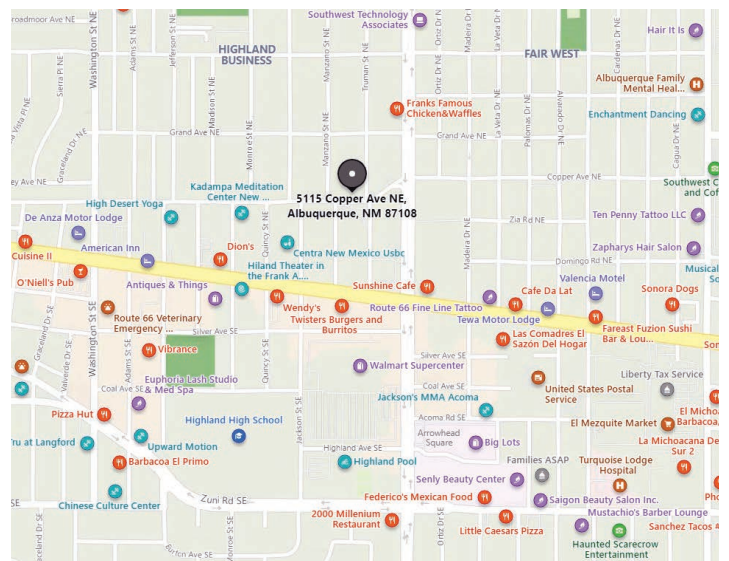

**Contact us**  
 Brighton Pope | 505.884.3578 | Brighton.Pope@PetersonProperties.net

