



VALUE INSIGHT
REALTY
REAL ESTATE ADVISORY GROUP

FOR LEASE

NE corner: Little Farm Blvd
and Old Hwy 2 | Trenton
NEW COMMERCIAL DEVELOPMENT

EBGAMES™

GLOBAL PET FOODS
eat.play.love.



OSHKOSH
Bigosh

CIRCLE K™

Tim Hortons

SUBWAY

Walmart 



NE Corner: Little Farm Blvd and Old Hwy 2, Trenton



Applegrove Acres
68 single family and town homes
by Klemencic Homes

1

105 single family homes
by Staikos Homes

2

Old Hwy 2

Little Farm Blvd

Staikos Commons
Commercial development

3

New development

7

New development

6

2nd Dug Hill Rd

Appledene Estates
160 apts., 66 town homes, 77 single family homes
by Staikos Homes

4

Hillside Meadows
132 single family homes & 120 apts.
by Klemencic Homes

5

Google

Imagery ©2021 CNES / Airbus, Maxar Technologies, USDA Farm Service Agency, Map data ©2021

NE Corner: Little Farm Blvd and Old Hwy 2, Trenton



PROPERTY HIGHLIGHTS

- Located in Trenton West at the north east corner of Little Farm Blvd and Old Hwy 2
- Shadow anchored by Walmart
- High growth residential market
- Minutes from the QHC Trenton Hospital and from Hwy 401
- Suggested uses: grocery, medical, quick service restaurants, automotive, drive thru, financial, healthcare and wellness, and many more retail or other commercial uses

PROPERTY DETAILS

| | |
|---------------|---|
| Type: | For lease |
| Size: | 20,000-32,000 sq.ft. available |
| Land size: | Approximately 4 acres available for retail commercial |
| Availability: | 2023 |
| Net Rent: | TBD |
| TMI: | TBD |

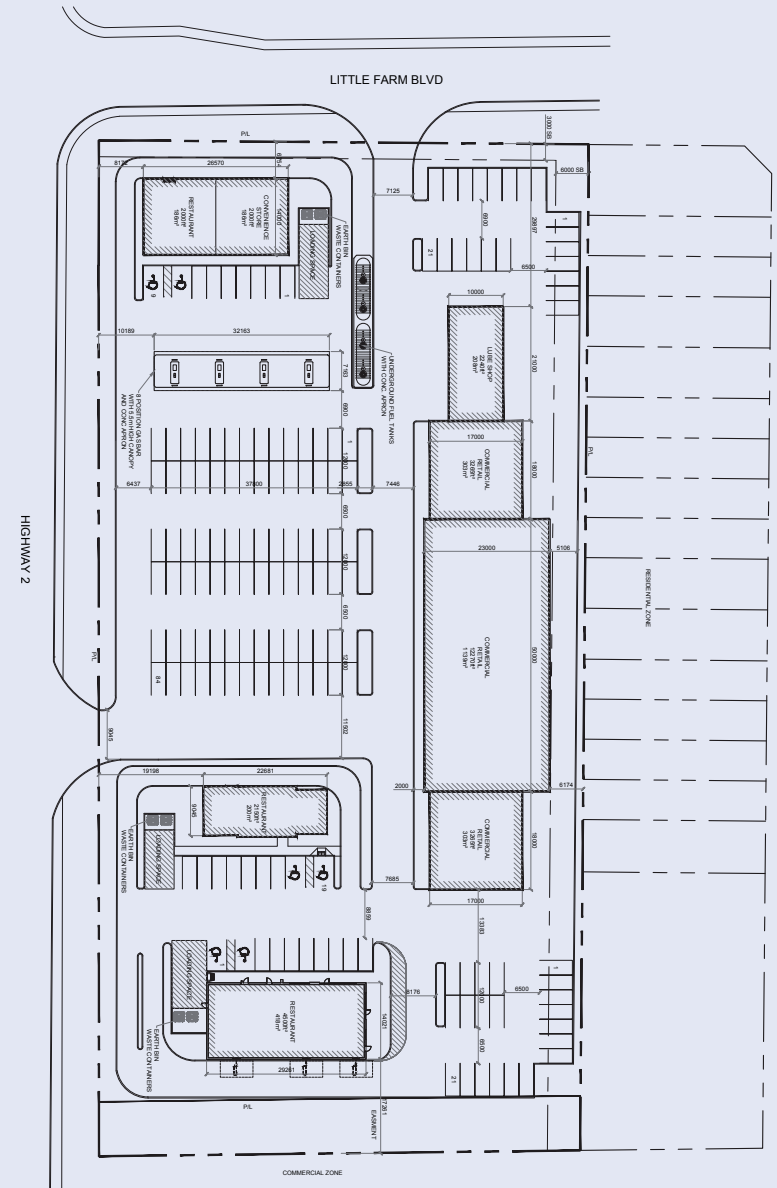

NE Corner: Little Farm Blvd and Old Hwy 2, Trenton

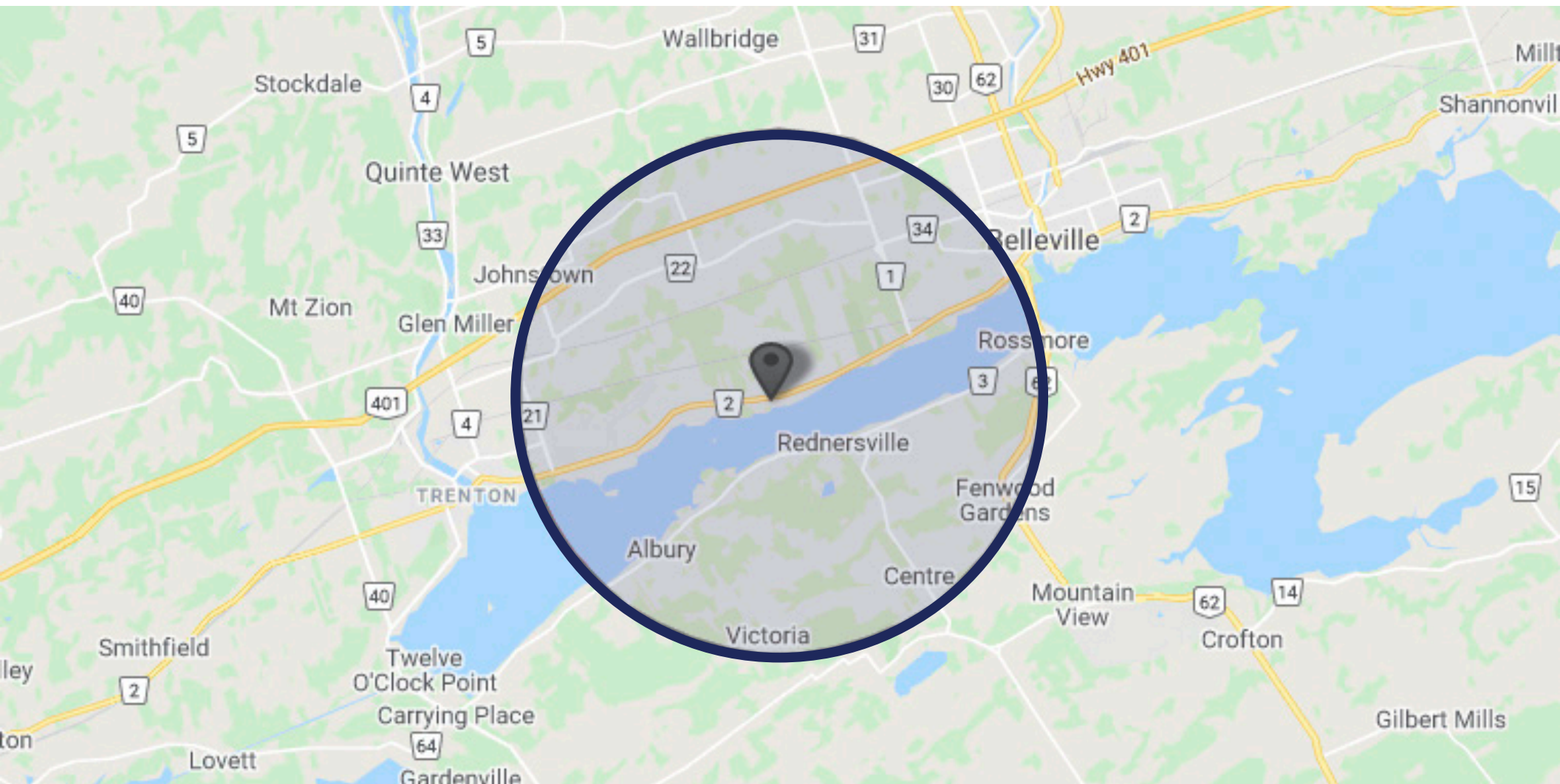

AREA DEMOGRAPHICS

Within 7 km radius of property



POPULATION
15,401



AVERAGE INCOME
\$96,250*

* Annually per household



MEDIAN AGE
48.3

**LANDLORD &
DEVELOPER | SERVICES:**

SARI SAMARAH*

President & CEO

416.269.6747 x101

sari.samarah@valueinsightrealty.com

Little Farm Blvd
Old Hwy 2



2nd Duq Hill Rd

valueinsightrealty.com

© 2021 Value Insight Realty Inc. | Brokerage

No warranty or representation, expressed or implied, is made as to the accuracy of the information contained herein, and same is submitted subject to errors, omissions, change of price, rental or other conditions, withdrawal without notice, and to any specific listing condition, imposed by the property owner(s). *Broker of Record