

SCALE 1" = 200'

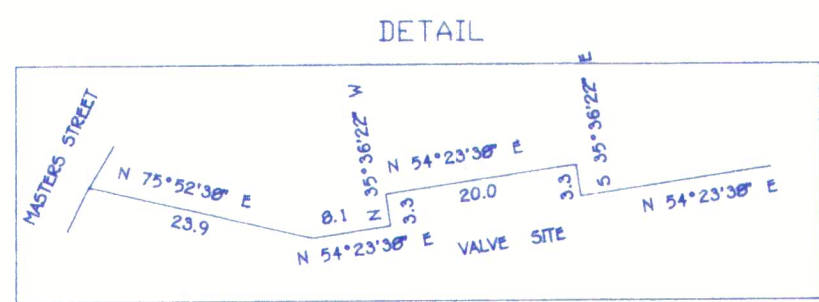

OLIVER HALL
A-203

A.B. & M. SECT. 35
A - 410

143.27 ACRES

26.71 ACRES TOTAL

ENRON GAS PROCESSING CO.
(92)1011/020 BCDR
CALLED 45.598 AC.

CHARLES PRESCOT
A-354

ADRIAN GUBERT, TRUSTEE
970/928 BCDR

NOTES:

THIS SURVEY PREPARED WITHOUT THE BENEFIT OF A CURRENT TITLE REPORT.

THERE ARE SEVERAL PIPELINES AND FACILITIES ON THIS TRACT.

THE CHANNEL INDUSTRIES LEASE CONTAINS AN OFFICE SITE AND FACILITIES THAT ARE NOT SHOWN.

THERE IS A PHILLIPS PIPELINE COMPANY PUMP STATION WITHIN THIS TRACT.

BEFORE SALE OR CONSTRUCTION THIS SURVEYOR ADVISES A CURRENT TITLE REPORT BE FURNISHED AND ALL PIPELINE COMPANIES CONTACTED TO LOCATE LINES.

RIGHT-OF-WAY ON MASTERS STREET ESTABLISHED ACCORDING TO F. G. AKERS 1965 SURVEY.

BEARING BASE - COMMON LINE OF ABSTRACT 410 AND ABSTRACT 354 LOCAL ORIENTATION OF N 27°00' W

N 27°00' W - 970.0

N 27°00' W - 1310.84

FND 1\"/>

FND 1\"/>

FND 1\"/>

FND 1\"/>

FND 1\"/>

FND 1\"/>

FND 1\"/>

FND 1\"/>

FND 1\"/>

FND 1\"/>

FND 1\"/>

FND 1\"/>

FND 1\"/>

FND 1\"/>

FND 1\"/>

SURVEY PLAT SHOWING 143.27 ACRES OF LAND OUT OF THE C. H. BOOTH 249 ACRE TRACT IN THE A.B. & M. SURVEY, SECTION 35, ABSTRACT 410, BRAZORIA COUNTY, TEXAS. SEE ATTACHED FIELD NOTES.

PLAT PREPARED FROM AN ACTUAL SURVEY MADE ON THE GROUND IN JANUARY AND MAY, 1994.

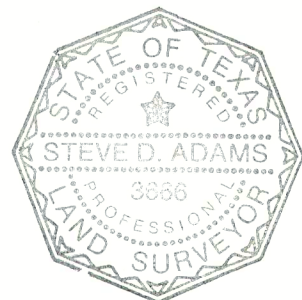

STEVE D. ADAMS, REGISTERED PROFESSIONAL LAND SURVEYOR NO. 3666
P.O. BOX 114 ALVIN, TEXAS 77512 713/331-3523

CHARLES O'DONNELL
A - 494

BRISCOE PROD. CO.
396/466 BCDR