

# Mission Plaza | 50th & Indiana Shopping Center for Lease



## EGENBACHER

Commercial Properties

3501 50th St., Lubbock, Texas 79413

Suite 208 • 2,856 sf • \$10.00 psf/yr

Suite 222 • 1,262 sf • \$11.50 psf/yr

Lease Type • NNN (\$2.35 psf)

Lease Term • 3-5 years

### Property Description

Located within the long established Mission Plaza Shopping Center, featuring floor to ceiling windows across the store front, +160 parking spaces and pylon signage.

### Location Description

Daily traffic count of over 60,000 cars. Located in Central Lubbock on 50th Street just West of Market Street Grocery on Indiana.

### Contact

Randy Egenbacher, CCIM • 806.786.3420  
randy@ereproperties.com

Spencer Stanush • 210.393.3457  
spencer@ereproperties.com

see pages 2 - 5 for site plan, floor plans & demographics

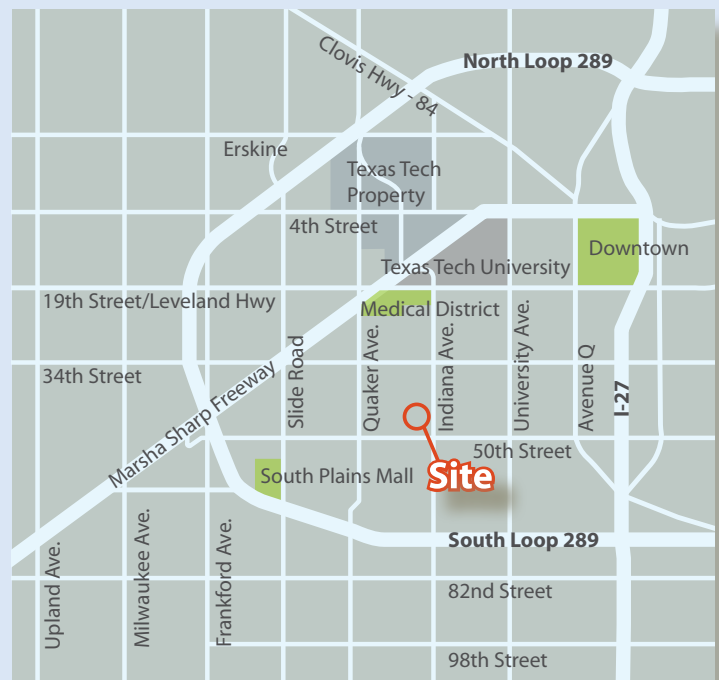

Disclaimer: The information contained herein has been obtained from sources believed reliable. However, Egenbacher Real Estate and/or its Agents have not verified it and make no guarantee, warranty or representation about it. The price, terms and the information contained herein are subject to change, and the Property is subject to be withdrawn from the market without notice.



**SURROUNDING AREA** | Mission Plaza for Lease





**SITE PLAN** | Mission Plaza for Lease



- 70' Bay Depth
- ±160 Parking Spaces
- Multiple Ingress Points
- Monument Signage

**Demographics**

1 Mile Radius		3 Mile Radius		5 Mile Radius	
Population	15,649	Population	129,555	Population	243,639
Average HH Income	\$98,415	Average HH Income	\$82,349	Average HH Income	\$88,619

FLOOR PLANS - Suite 208 | Mission Plaza for Lease

Suite 208 (can be demised)

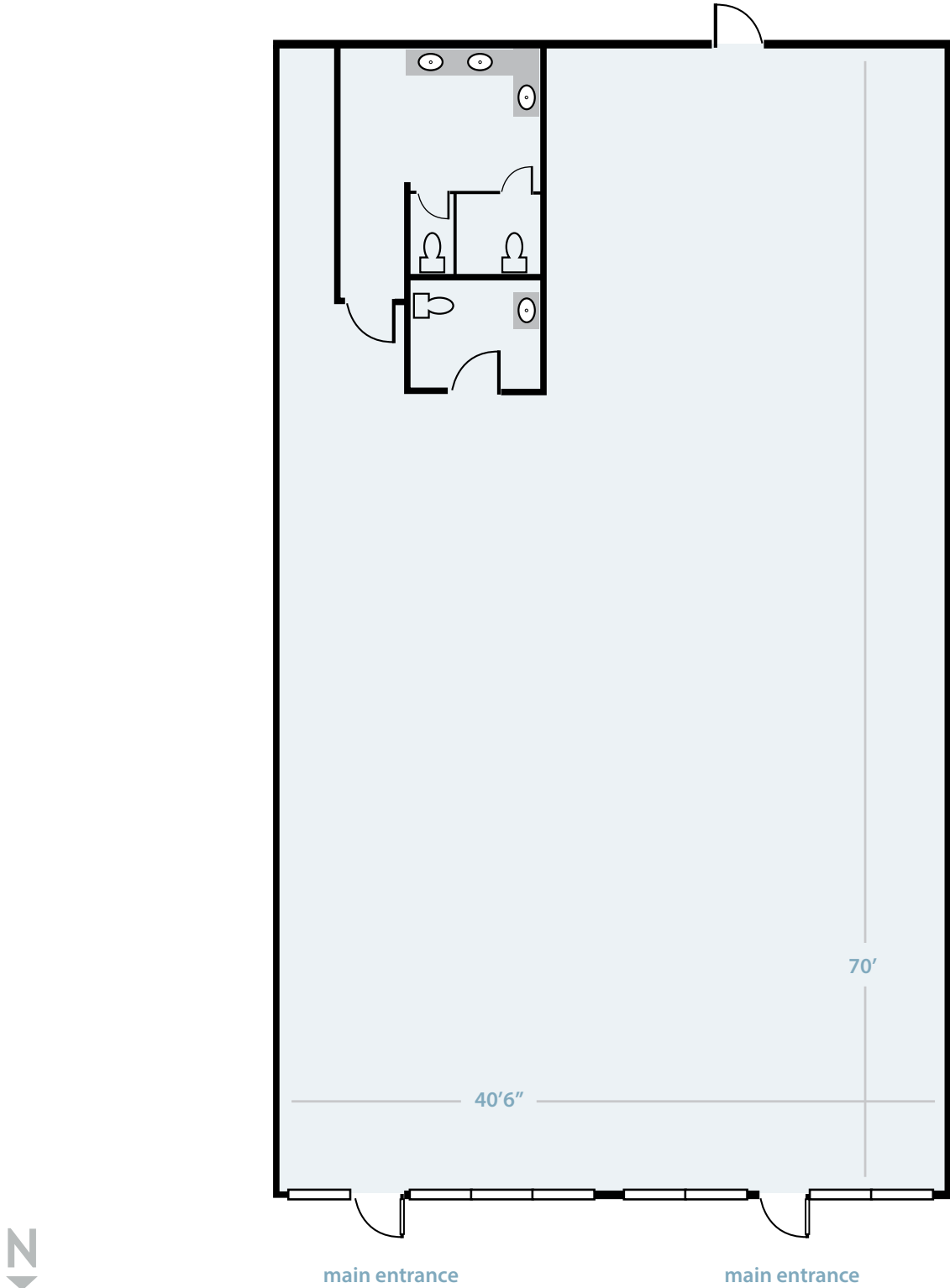

**FLOOR PLANS - Suite 222** | Mission Plaza for Lease

## Suite 222

