

9848 Firestone Blvd. Downey, California 90241

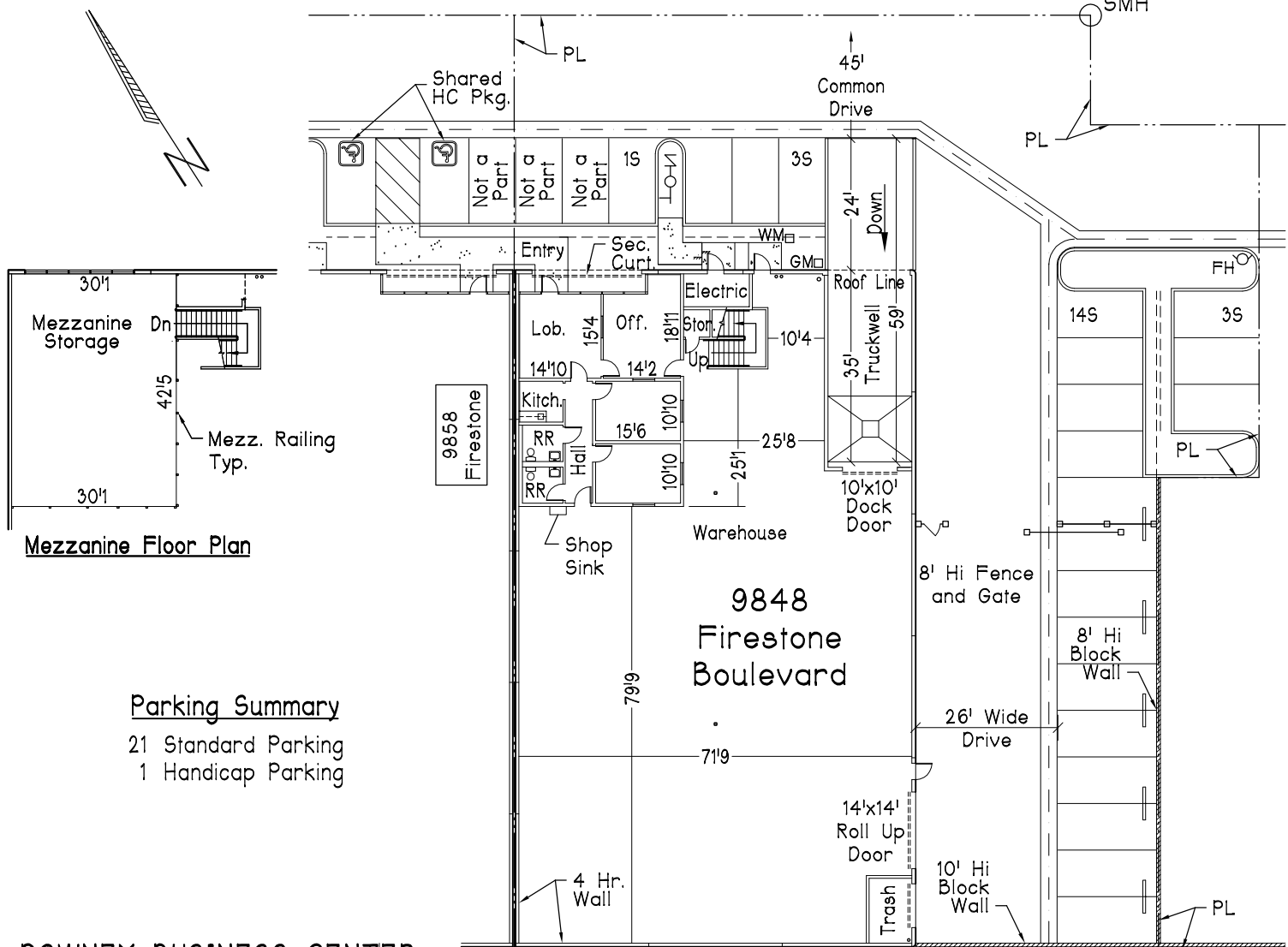

DOWNEY BUSINESS CENTER

- *Quality Concrete Tilt-up Distribution/Manufacturing Facility w/ Many Extra Features, Developed by Lyons & Lyons Properties.
- *Loading: Overnight 59' Concrete Truckwell Dock w/ Large 104' Turnaround Radius; (1) 10'x10' Dock High Door & Clear Path to Common Drive; (1) 14'x14' Ground Level Door.
- *Warehouse: High Piled Storage & Class 4 Commodity Rating (Class 5 Possible); .45/3000 Fire Sprinklers; Foiled Ceilings; 24'0" Clear Height; 3% Secured Vented Skylights including 2% Smoke Vent Skylights; Skylights w/ Security Grilles; Antique White Walls; Fluorescent Light Fixtures; Polished and Sealed 5" Thick Reinforced Concrete Slab.
- *Utility Services: 400 Amp, 480/277 Volt, 3 Phase, 4 Wire w/ Add'l Conduit Capacity; 2" Heavy Duty Water Service; Natural Gas Stubbed.
- *Ground Floor Office w/ Spacious 9' Ceilings; Central HVAC; Kitchen Unit with Microwave Outlet; Monitoring Windows; Polished Concrete Floor & Vinyl Basecove.
- *Mezzanine Storage w/ 125 PSF Capacity; VCT Floor & Vinyl Basecove; Can be built-out as Additional Office Subject to City Staff Approval.
- *Exclusive Parking Stalls; Heavy Duty Asphalt Paving.
- *Remote Controlled Exterior Metal Office Security Curtains; Secured Concrete Trash Enclosure Vault.
- *Experienced Landlord with Additional Buildings for Expansion.
- *Property Zone M1: Light Manufacturing.
- *Low City Business Fees.

**Total Sq. Ft.
w/ Mezzanine**
 10,293 Sq. Ft.

Building Footprint
 9,016 Sq. Ft.

**Ground Floor Office
(Excl. Entry Recess
& Shop RR)**
 1,160 Sq. Ft.

Mezzanine Storage
 1,277 Sq. Ft.

Scale: 1" = 30' 17057

David O. Roberts, P.E., Inc.
 17280 Newhope Street, #17
 Fountain Valley, CA 92708
 (949) 633-1621
 Email: dave@DORoberts.com