

PRICE REDUCTION!

~~**\$12,000,000**~~

\$10,800,000



10400 Pioneer Blvd, Santa Fe Springs

Brokers make no guarantees, representations, or warranties of any kind, expressed or implied. All information to be independently verified.

EXCLUSIVELY LISTED BY



JESSE LAIKIN

DRE # 00781096

Executive Vice President

📞 310-953-8054

✉️ JAL@LACommercial.com



JOSHUA SCHWARTZ

DRE # 02058318

Vice President

📞 424.218.9871

✉️ JS@LACommercial.com

FOR SALE



TOTAL SF: 48,481

~~\$12,000,000 (\$247.52 PSF)~~

\$10,800,000 (\$222.76PSF)

LA Commercial, Inc. is pleased to present the opportunity to acquire 10400 Pioneer Blvd, a high-image multi-tenant industrial/flex building located in the heart of Santa Fe Springs.

The 48,481 SF building is situated within the Town Center Business Park, offering a premier campus environment with proximity to restaurants, retail, and services. The property provides a unique opportunity for both investors and owner/users, with ±29,456 SF available (divisible to ±15,147 SF and ±14,309 SF) and the balance of the building leased to two established tenants.

Constructed in 1981, this multi-tenant facility offers modern industrial features including ±22' clear height warehouse, sprinklers, heavy power (1,000 amps, 277/480V, 3-phase, 4-wire), and finished office mezzanine. With 119 parking spaces (2.5:1 ratio) and multiple existing suites, the property is flexible for a variety of uses and configurations.

Offered at \$10,800,000 (\$222.76/SF), the asset presents a compelling combination of stable income for investment and/or immediate owner-user occupancy potential.



PROPERTY ADDRESS

10400 Pioneer Blvd, Santa Fe Springs, CA

APN

8009-026-026

BUILDING SQUARE FEET

48,481 SF

LOT SIZE

35,336 SF

PARKING:

119 Spaces

YEAR BUILT

1981

ZONING

Limited Manufacturing, Planned Overlay
[Zoning Map](#)

SPRINKLERS:

0.45 GPM/3000 SF (First Floor)
0.19 GPM/3000 SF (Mezzanine)



JESSE LAIKIN
DRE # 00781096
Executive Vice President
☎ 310-953-8054
✉ JAL@LACommercial.com

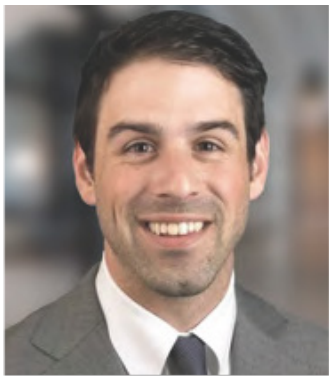

JOSHUA SCHWARTZ
DRE # 02058318
Vice President
☎ 424.218.9871
✉ JS@LACommercial.com



Property Name: Town Center Business Park
Address: 10400 Pioneer Blvd, Santa Fe Springs, CA 90670
Cross Streets: Pioneer Blvd/Telegraph Rd

PRICE REDUCTION- \$10,800,000
Multi-Tenant Industrial/Flex For Sale
Leased Investment & Owner User
29,456 SF (Divisible) Available For An Owner User
Adjacent to Restaurants, Retail, & Services Amenities

Sale Price:	\$10,800,000.00	Sprinklered:	Yes	Office SF / #:	18,518 SF / 40
Sale Price/SF:	\$222.77	Clear Height:	22'	Restrooms:	10
Available SF:	48,481 SF	GL Doors/Dim:	6	Office HVAC:	Heat & AC
Prop Lot Size:	0.81 Ac / 35,284 SF	DH Doors/Dim:	0	Finished Ofc Mezz:	12,654 SF
Taxes:	\$81,550 / 2024	A: 1000 V: 277/480 O: 3 W: 4		Include In Available:	Yes
Yard:	No	Construction Type:	Concrete	Unfinished Mezz:	0 SF
Zoning:	ML-PD	Const Status/Year Blt:	Existing / 1981	Include In Available:	No
		Whse HVAC:	No	Possession:	60 Days
		Parking Spaces: 119 / Ratio: 2.5:1		Vacant:	No
		Rail Service:	No	To Show:	Call broker
		Specific Use:	Warehouse/Office	Market/Submarket:	MidCounties
				APN#:	8009-026-031

Listing Company: LA Commercial, Inc
Agents: [Jesse A. Laikin 310-953-8054](#), [Joshua Schwartz 818-912-1364](#)



Listing #: 43246546

FTCF: CB000N000S300/OAA

Notes: Total bldg is 48,481 SF, multi-tenant, with 29,456 SF available & is divisible to 15,147 SF & 14,309 SF, with the balance of space leased to two other tenants. Currently 4 units, can be divided into more. Premier campus environment. Office square footage components are approximate, based on demo. Needs to be verified. Multiple power panels, Buyer to verify all aspects & information provided herein.

RENT ROLL

10400 Pioneer Blvd, Santa Fe Springs, CA

Suite #	Tenant Name	Type of Business	SF	Lease Expiration Date	Total Current Monthly Rent	Rent Per Square Foot	NNN	Rent Increases	Options	Tenant Since
1 	Meyer Asset	General Office, Light Manufacturing, Warehousing	6,140	1/31/2027	\$ 5,990.00	\$ 0.98	Yes 12.6% \$2,727.75/mo.	February 2026 - \$6,230.00	No	2011
2-7 	Custom Building Products	General Office, Lab Spaces, Warehousing	29,456	12/31/2025	\$ 29,837.69	\$ 1.01	Yes 60.75% \$13,153.38/mo.	No	Vacating	2005
8-9 	Southeast Area Social Services Funding Authority (SASSFA)	General Office and Client Training	12,885	2/28/2028	\$ 24,845.00	\$ 1.93	Yes 26.57% \$5,753.48/mo.	March 2026- \$25,715.00 March 2027- \$26,615.00	No	2006

-  Myers Asset
-  SASSFA
-  Custom Building Products



*Lines and SF are approximate

- Myers Asset 6,140 SF (1,536 Mezzanine)
- SASSFA 12,885 SF (2,987 SF Mezzanine)
- Custom Building Products 29,456 SF (8,195 SF Mezzanine)

Proximity To:

Los Angeles/Long Beach Ports
Distance: ±18 miles
Estimated Drive Time: 25–30 minutes

Downtown Los Angeles
Distance: ±12 miles
Estimated Drive Time: 20–25 minutes

John Wayne Airport (SNA)
Distance: ±25 miles
Estimated Drive Time: 30–35 minutes

Los Angeles International Airport (LAX)
Distance: ±22 miles
Estimated Drive Time: 30 minutes

Long Beach Airport (LGB)
Distance: ±10 miles
Estimated Drive Time: 15–20 minutes

Citadel Outlets (Commerce)
Distance: ±6 miles
Estimated Drive Time: 10 minutes

Disneyland Resort
Distance: ±12 miles
Estimated Drive Time: 20 minutes

A POSSIBLE CONFIGURATION OF CBP SPACE (29,456 SF)

10400 Pioneer Blvd, Santa Fe Springs, CA

10400 PIONEER BLVD, SUITE 3
SANTA FE SPRINGS, CA 90670
LEVEL 1 FLOOR PLAN



0 8 16 32 64

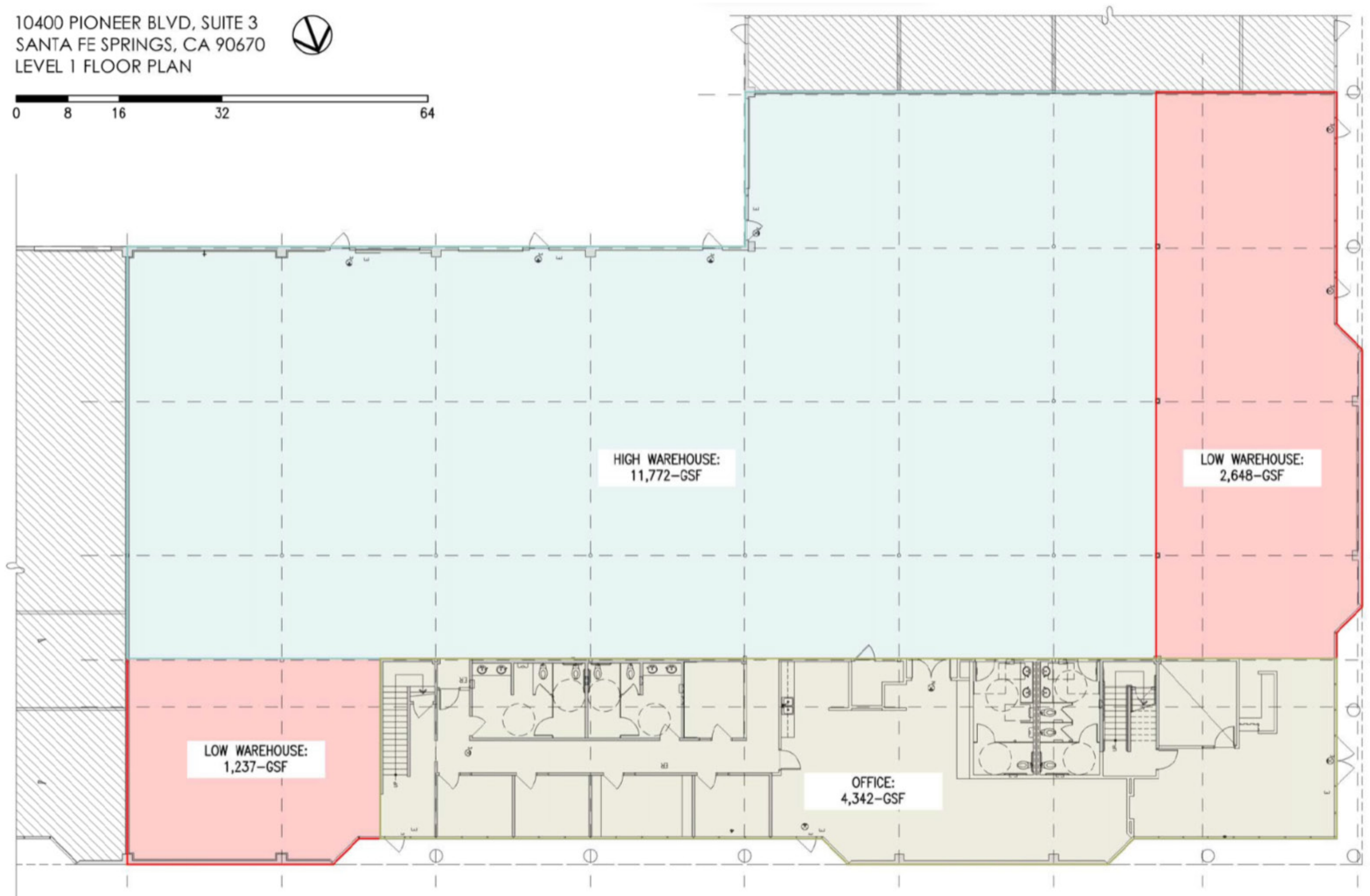

Current Configuration (Not Shown)

Warehouse: +/- 5,910 SF

1st Floor Office/Lab: +/- 15,550 SF

2nd Floor Office: +/- 8,410 SF

Potential Configuration (Shown)

Link to: [Proposed Demolition](#)

Warehouse: +/- 15,657 SF *

1st Floor Office/Lab: +/- 4,342 SF

2nd Floor Office: +/- 8,410 SF

*High Clear (22ft): 11,772 SF
Low Clear (10 ft): 3,885 SF













JESSE LAIKIN

DRE # 00781096

Executive Vice President

☎ 310-953-8054

✉ JAL@LACommercial.com

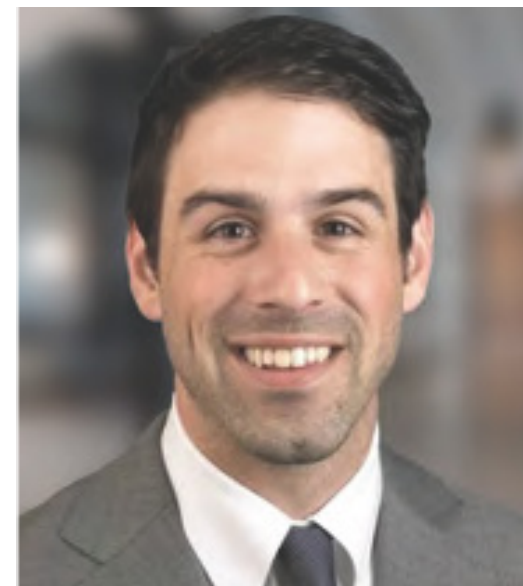

JOSHUA SCHWARTZ

DRE # 02058318

Vice President

☎ 424.218.9871

✉ JS@LACommercial.com

DISCLAIMERS

The information contained in the following Offering Memorandum is proprietary and strictly confidential. It is intended to be reviewed only by the party receiving it from LA Commercial Real Estate Services and should not be made available to any other person or entity without the written consent of LA Commercial Real Estate Services. This Offering Memorandum has been prepared to provide summary, unverified information to prospective purchasers, and to establish only a preliminary level of interest in the subject property. The information contained herein is not intended to replace a thorough due diligence investigation. LA Commercial Real Estate Services has not conducted any independent investigation and makes no representations or warranties regarding the income or expenses of the property, the future financial performance of the property, the size and square footage of the property and its improvements, the compliance with applicable laws and regulations, or the physical condition of the property. The information provided in this Offering Memorandum has been obtained from sources believed to be reliable; however, LA Commercial Real Estate Services does not verify, and will not verify, any of the information contained herein, and makes no representation or warranty regarding the accuracy or completeness of the information. All potential buyers are advised to take appropriate measures to independently verify all information set forth herein.

This information has been secured from sources we believe to be reliable, but we make no representations or warranties, expressed or implied, as to the accuracy of the information. References to square footage or age are approximate. Buyer must verify the information and bears all risk for any inaccuracies. Any projections, opinions, assumptions or estimates used herein are for example purposes only and do not represent the current or future performance of the property. Brokers make no guarantees, representations, or warranties of any kind, expressed or implied. All information to be independently verified.