

# RETAIL PAD SITE

Build-to-suit / Ground Lease

Up to 20,000± SF

South China  
Community Church

Village St

Old Windsor Rd

ENR  
202

32

Hannaford Dr



PAD SITE

## 33 Hannaford Drive, China

### Property Description

We are pleased to offer this retail pad sit for build-to-suit or ground lease at the Hannaford in China, Maine. Located along Route 202 & Route 32, the pad is approved for a 20,000± SF single-story building.



#### Broker Contact

Charlie Craig

Broker | Partner

207.415.1415

charles@dunhamgroup.com



## Property Overview

|                    |                  |
|--------------------|------------------|
| Available Pad Size | Up to 20,000± SF |
| Parking            | In common        |
| Zoning             | Residential      |
| Co-tenants         | Hannaford        |

**FOR GROUND LEASE : \$75,000/YEAR**



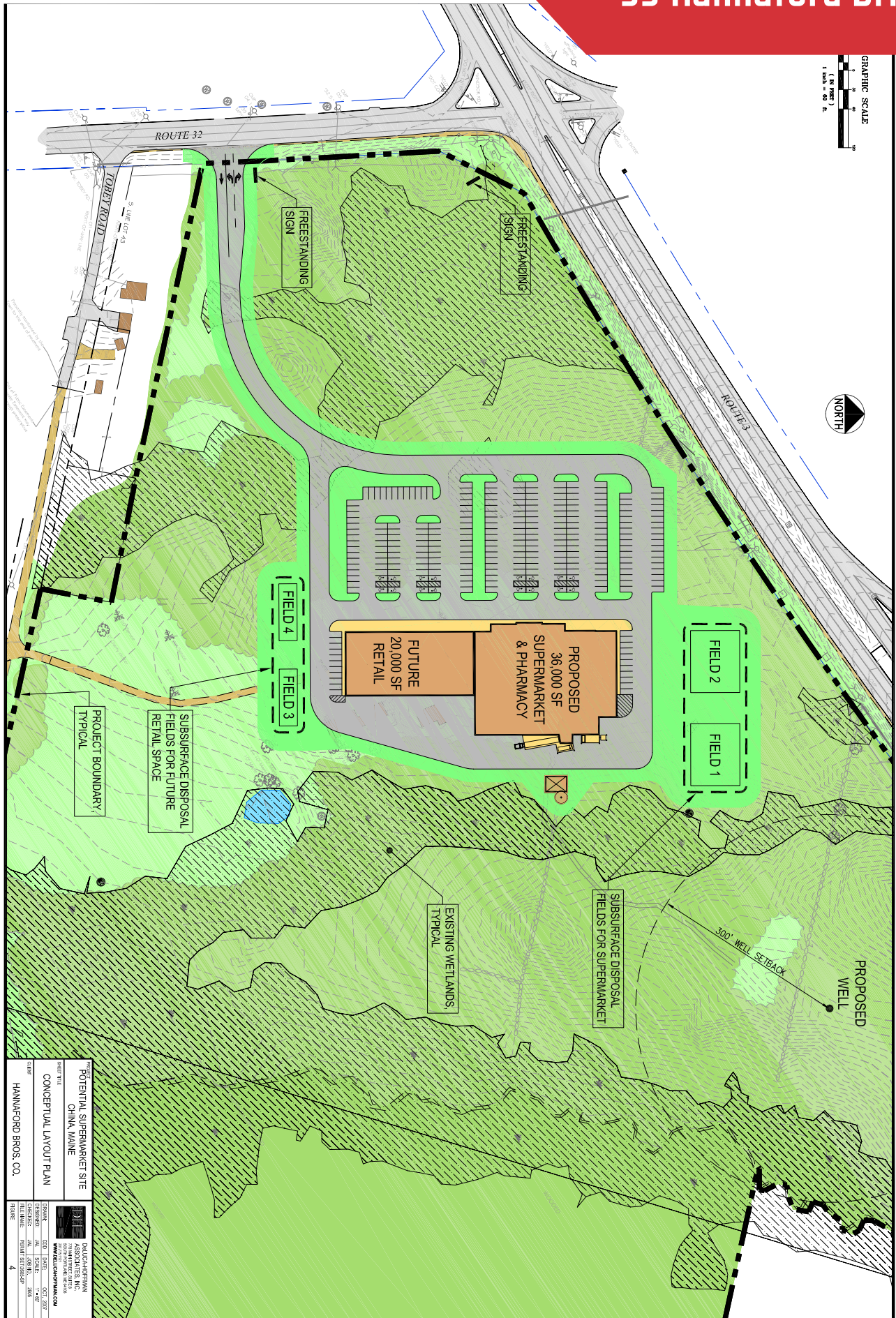

|  |   |
|--|---|
| <b>POTENTIAL SUPERMARKET SITE</b><br>CHINA, MAINE  |   |
| <b>CONCEPTUAL LAYOUT PLAN</b>  |   |
| DATE: 10/20/2017<br>DRAWN BY: JAC<br>CHECKED BY: JAC<br>FILE NAME: 33HANNAFORD.SW                    | SCALE: 1" = 60'<br>STATE: MAINE<br>DATE: OCT 2017<br>PROJECT: 33 HANNAFORD DRIVE<br>SHEET NO: 4 |
| DUNHAM GROUP<br>ASSOCIATES, INC.<br>200 MONUMENT SQUARE<br>PORTLAND, ME 04101<br>WWW.DUNHAMGROUP.COM |   |

The information contained herein has been given to us by the owner of the property or other sources we deem reliable. We have no reason to doubt its accuracy, but we do not guarantee it. All information should be verified prior to purchase or lease.