

PROFESSIONAL OFFICE SPACE AVAILABLE FOR LEASE

770 E. Shaw Avenue
Fresno, California

New Tenant Rent Incentive

Call Broker for Details

For information, please contact:

Scott Christensen | Vice President - Office Division | t 559-447-6230 | schristensen@pearsonrealty.com | CA RE Lic. #01415793

NEWMARK
PEARSON COMMERCIAL

Independently Owned and Operated
Corporate License #00020875
newmarkpearson.com

FRESNO OFFICE
7480 N. Palm Ave. #101
Fresno, CA 93711
t 559-432-6200

VISALIA OFFICE
3447 S. Demaree St.
Visalia, CA 93277
t 559-732-7300

The distributor of this communication is performing acts for which a real estate license is required. The information contained herein has been obtained from sources deemed reliable but has not been verified and no guarantee, warranty or representation, either express or implied, is made with respect to such information. Terms of sale or lease and availability are subject to change or withdrawal without notice.

PROFESSIONAL OFFICE SPACE

PROPERTY DESCRIPTION

Professionally managed & maintained three-story office complex with quiet & peaceful open air atrium/courtyard area. All amenities for employees to enjoy daily including shopping, restaurants, banking & daily services all within walking distance. Easy access to Highway 41 & FAX bus service on Shaw Avenue. Abundant on-site common *(some covered)* parking. On-site security team.

PROPERTY DETAILS

Lease Rate:	Full Service Lease. <i>Call broker for lease rates and further details.</i>
Tenant Improvements:	Negotiable
Lease Term:	3 year minimum preferred
Parking Description:	321 surface stalls, plus 8 surface handicap stalls
Zoning:	Commercial, General Office

HIGHLIGHTS

- Complete Renovation, Millions Spent on Award Winning Improvements
 - Finest East Shaw Property *(High Image Building)*
 - Strategically Located Directly Across from the High End Super Regional Center: Fashion Fair Mall, Near Freeway 41, Major Banks & Dining
 - High Visibility *(64,000 Average Daily Vehicle Traffic Count, Over 23.3 Million Annually)*
 - ADA Compliant
 - Suites can accommodate various size requirements
 - 8,000± square foot Event Center
-

CONCIERGE SERVICES

- “Enhanced deterrence” security program - Sheriff’s Department located within the building
 - Concierge staff provide in-house construction, management, maintenance and security. All working exclusively for owner and dedicated to better serve tenants
 - Lounge, conference and catering facilities available
-

PROFESSIONAL OFFICE SPACE

Availability

FIRST FLOOR

Suite 110-116:	8,016± RSF
Suite 130:	2,351± RSF
Suite 131:	3,171± RSF
Suite 132:	2,257± RSF

SECOND FLOOR

Suite 218:	2,199± RSF
Suite 240:	1,979± RSF

THIRD FLOOR

Suite 304:	3,439± RSF
Suite 310:	2,683± RSF
Suite 315:	5,411± RSF
Suite 320 *:	7,872± RSF
Suite 324 *:	1,009± RSF
Suite 325 *:	1,607± RSF
Suite 326 *:	2,381± RSF
Suite 330:	8,081± RSF

*Could be combined up to 12,869± SF

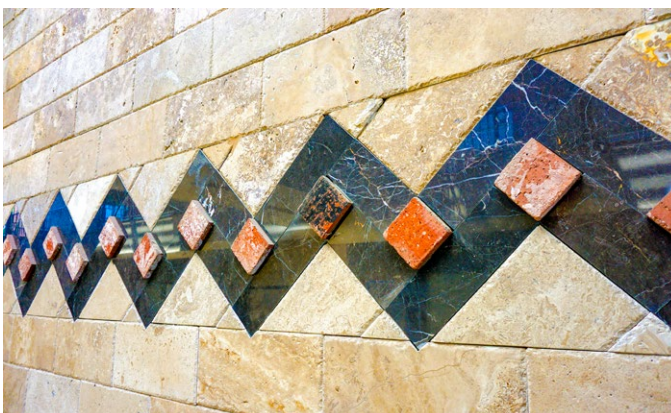

NEWMARK
PEARSON COMMERCIAL

Scott Christensen
Vice President - Office Division
t 559-447-6230
schristensen@pearsonrealty.com
CA RE Lic. #01415793

Independently Owned and Operated | Corporate License #00020875 | newmarkpearson.com

FRESNO OFFICE: 7480 N. Palm Ave. #101, Fresno, CA 93711, t 559-432-6200 | VISALIA OFFICE: 3447 S. Demaree St., Visalia, CA 93277, t 559-732-7300

The distributor of this communication is performing acts for which a real estate license is required. The information contained herein has been obtained from sources deemed reliable but has not been verified and no guarantee, warranty or representation, either express or implied, is made with respect to such information. Terms of sale or lease and availability are subject to change or withdrawal without notice.

PROFESSIONAL OFFICE CENTER

Floor Plan | 1st Floor *(Not to Scale)*

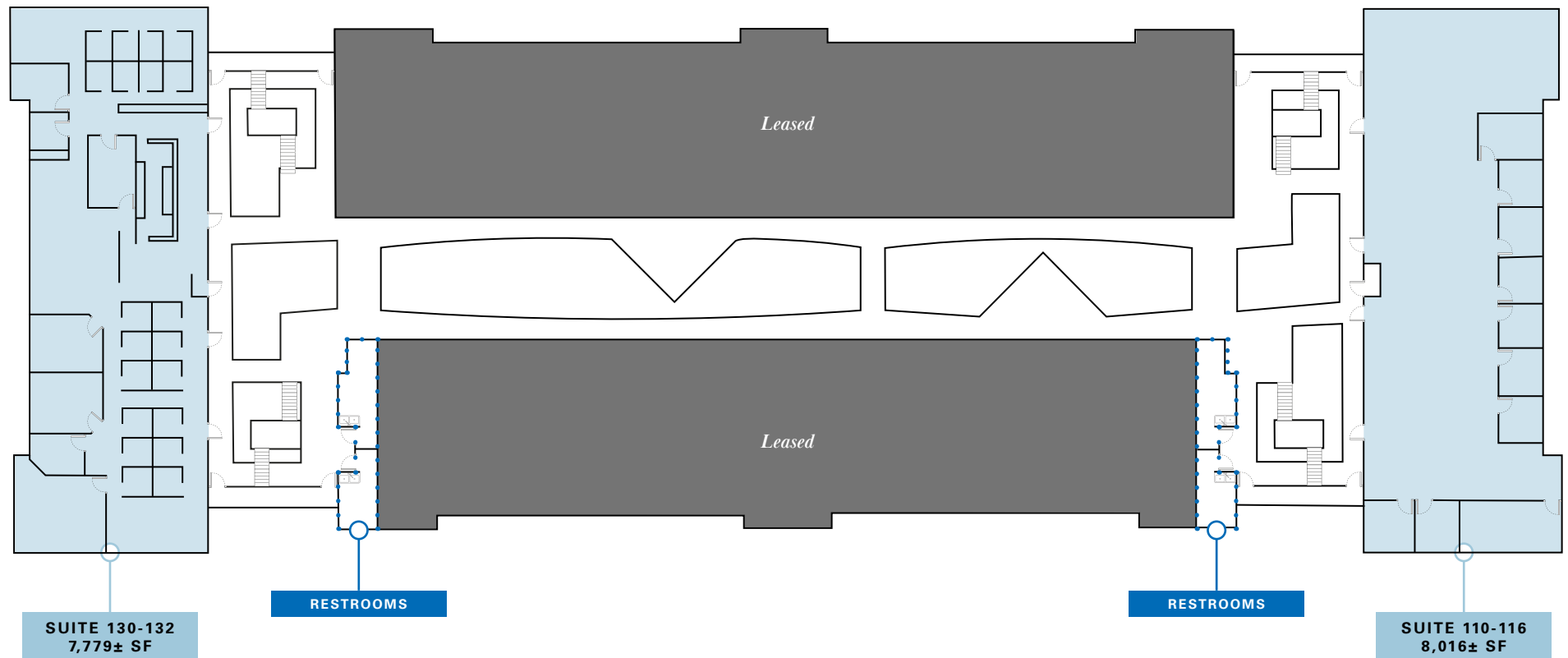

NEWMARK
PEARSON COMMERCIAL

Scott Christensen
Vice President - Office Division
t 559-447-6230
schristensen@pearsonrealty.com
CA RE Lic. #01415793

Independently Owned and Operated | Corporate License #00020875 | newmarkpearson.com

FRESNO OFFICE: 7480 N. Palm Ave. #101, Fresno, CA 93711, t 559-432-6200 | **VISALIA OFFICE:** 3447 S. Demaree St., Visalia, CA 93277, t 559-732-7300

The distributor of this communication is performing acts for which a real estate license is required. The information contained herein has been obtained from sources deemed reliable but has not been verified and no guarantee, warranty or representation, either express or implied, is made with respect to such information. Terms of sale or lease and availability are subject to change or withdrawal without notice.

PROFESSIONAL OFFICE CENTER

Floor Plan | 2nd Floor *(Not to Scale)*

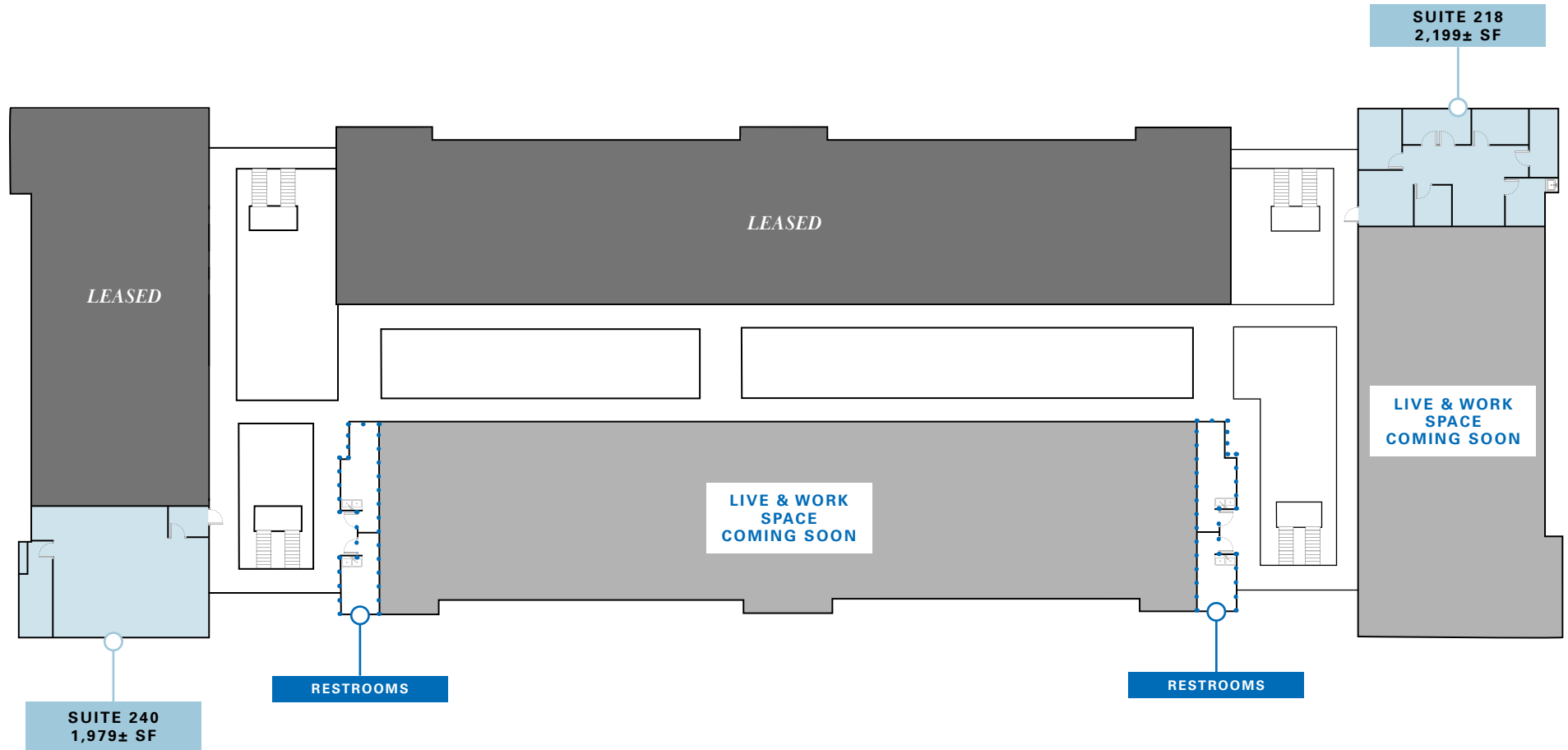

NEWMARK
PEARSON COMMERCIAL

Scott Christensen
Vice President - Office Division
t 559-447-6230
schristensen@pearsonrealty.com
CA RE Lic. #01415793

Independently Owned and Operated | Corporate License #00020875 | newmarkpearson.com

FRESNO OFFICE: 7480 N. Palm Ave. #101, Fresno, CA 93711, t 559-432-6200 | **VISALIA OFFICE:** 3447 S. Demaree St., Visalia, CA 93277, t 559-732-7300

The distributor of this communication is performing acts for which a real estate license is required. The information contained herein has been obtained from sources deemed reliable but has not been verified and no guarantee, warranty or representation, either express or implied, is made with respect to such information. Terms of sale or lease and availability are subject to change or withdrawal without notice.

PROFESSIONAL OFFICE CENTER

Floor Plan | 3rd Floor *(Not to Scale)*

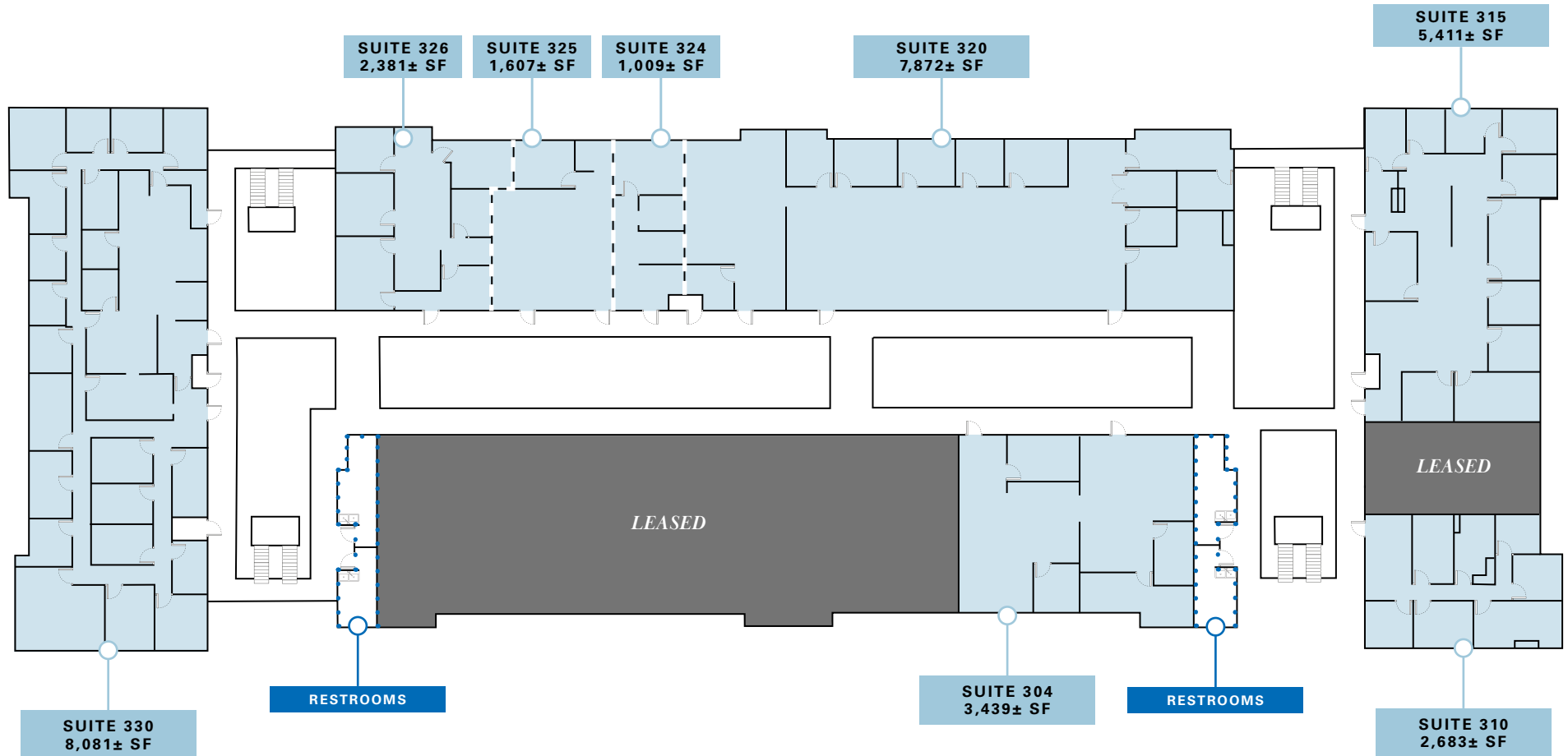

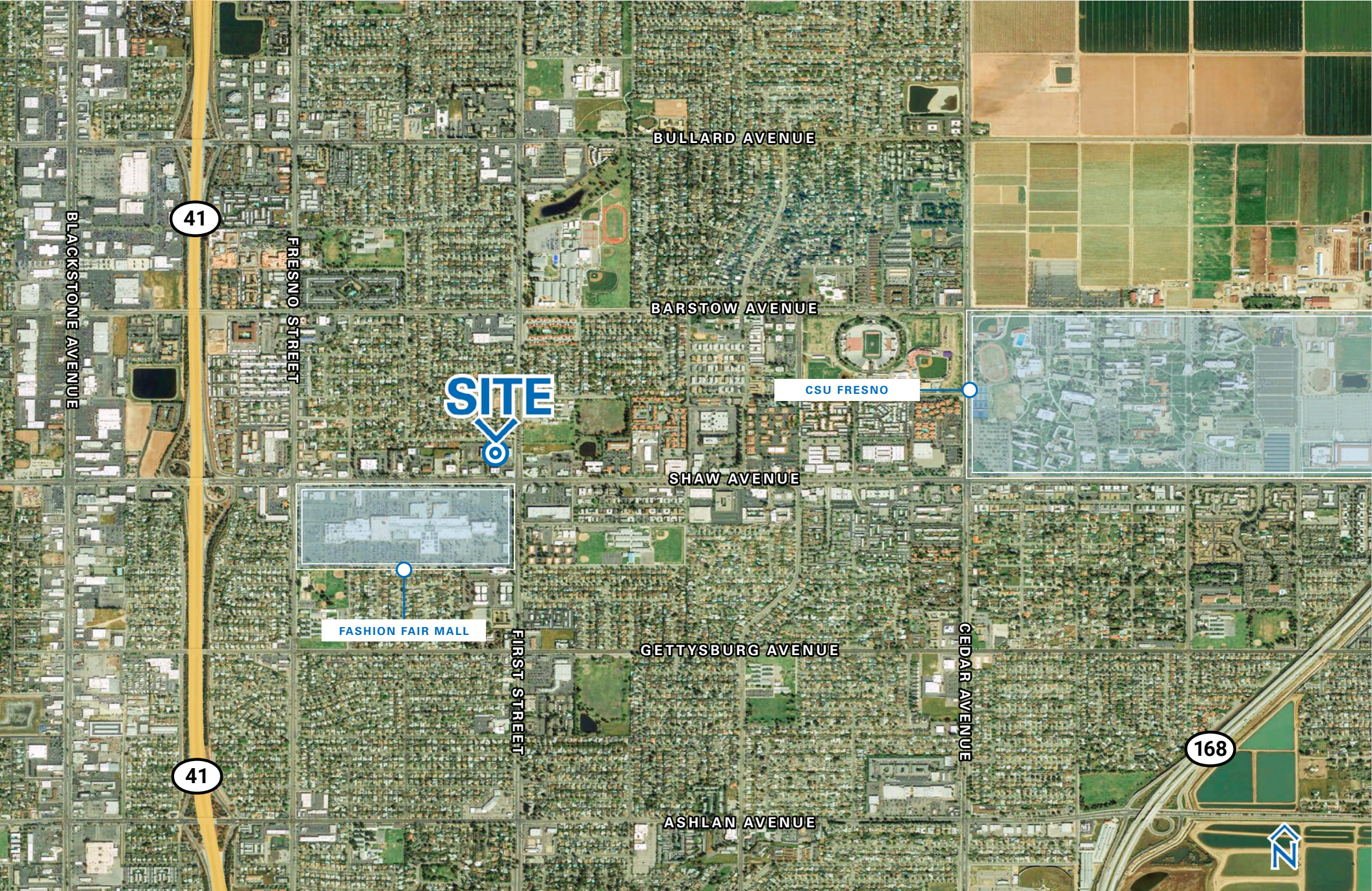

NEWMARK
PEARSON COMMERCIAL

Independently Owned and Operated
Corporate License #00020875
newmarkpearson.com

FRESNO OFFICE
7480 N. Palm Ave. #101
Fresno, CA 93711
t 559-432-6200

VISALIA OFFICE
3447 S. Demaree St.
Visalia, CA 93277
t 559-732-7300

The distributor of this communication is performing acts for which a real estate license is required. The information contained herein has been obtained from sources deemed reliable but has not been verified and no guarantee, warranty or representation, either express or implied, is made with respect to such information. Terms of sale or lease and availability are subject to change or withdrawal without notice.



For information, please contact:

Scott Christensen

Vice President - Office Division

t 559-447-6230

schristensen@pearsonrealty.com

CA RE Lic. #01415793

NEWMARK
PEARSON COMMERCIAL

Independently Owned and Operated
Corporate License #00020875
newmarkpearson.com

FRESNO OFFICE
7480 N. Palm Ave. #101
Fresno, CA 93711
t 559-432-6200

VISALIA OFFICE
3447 S. Demaree St.
Visalia, CA 93277
t 559-732-7300

The distributor of this communication is performing acts for which a real estate license is required. The information contained herein has been obtained from sources deemed reliable but has not been verified and no guarantee, warranty or representation, either express or implied, is made with respect to such information. Terms of sale or lease and availability are subject to change or withdrawal without notice.