

**280** N. MIDLAND  
**AVENUE**  
SADDLE BROOK, NJ

**Zuckerberg's**  
Industrial Park

**17,736 SF | BUILDING M-1**

Warehouse /  
Flex Space

Excellent  
highway  
access

Major  
upgrades  
throughout  
park

Professionally  
owned &  
managed by

**SITEX**  
GROUP

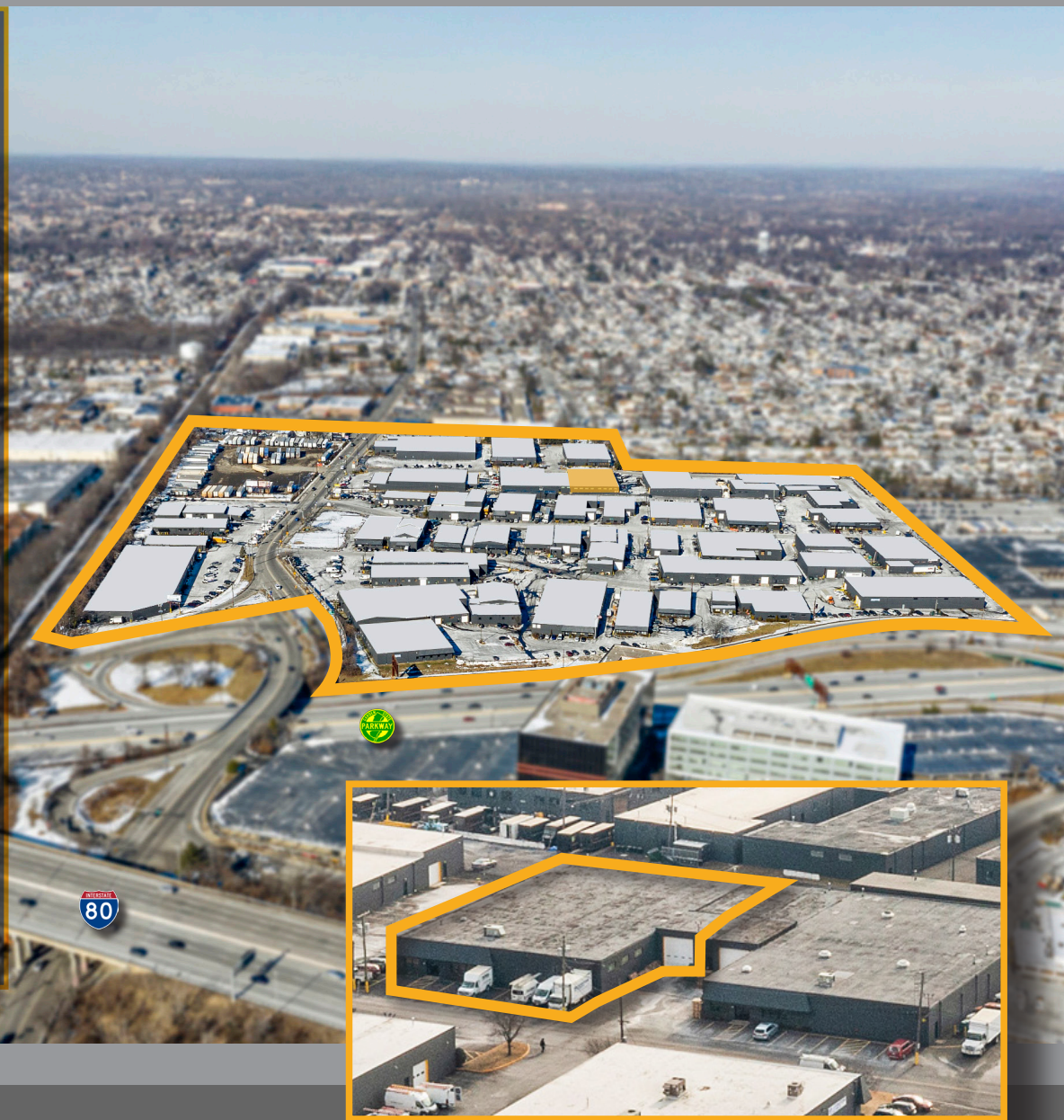





**NAI James E. Hanson**  
COMMERCIAL REAL ESTATE SERVICES, WORLDWIDE

 For *more* information

**Kenneth D. Lundberg, SIOR**  
Senior Vice President  
201 488 5800 x138  
klundberg@naihanson.com

**Patrick Lennon**  
Vice President  
201 488 5800 x109  
plennon@naihanson.com

**Lorenzo Lambiase, MBA, CCIM**  
Associate Vice President  
201 488 5800 x176  
llambiase@naihanson.com

FOLLOW US!      | NJ Offices: Teterboro | Parsippany | [naihanson.com](http://naihanson.com) | Member of NAI Global with 325+ Offices Worldwide

The information contained herein has been obtained from sources considered to be reliable, but no guarantee of its accuracy is made by NAI James E. Hanson

# FLOOR PLAN

**Total Space**  
**±17,736 SF**

**Warehouse**  
**±15,535 SF**

**Office**  
**2,201 SF**

**One (1)**  
**Drive-in**

**Ceiling Height**  
**12'4"**

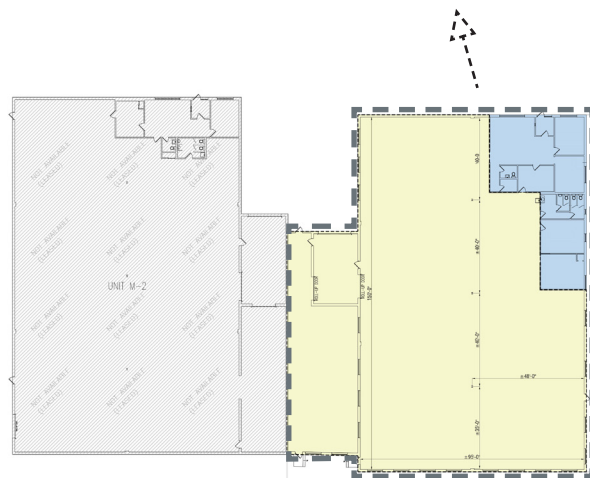
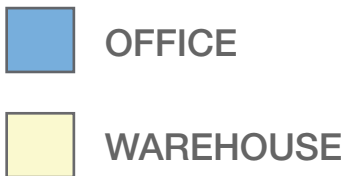
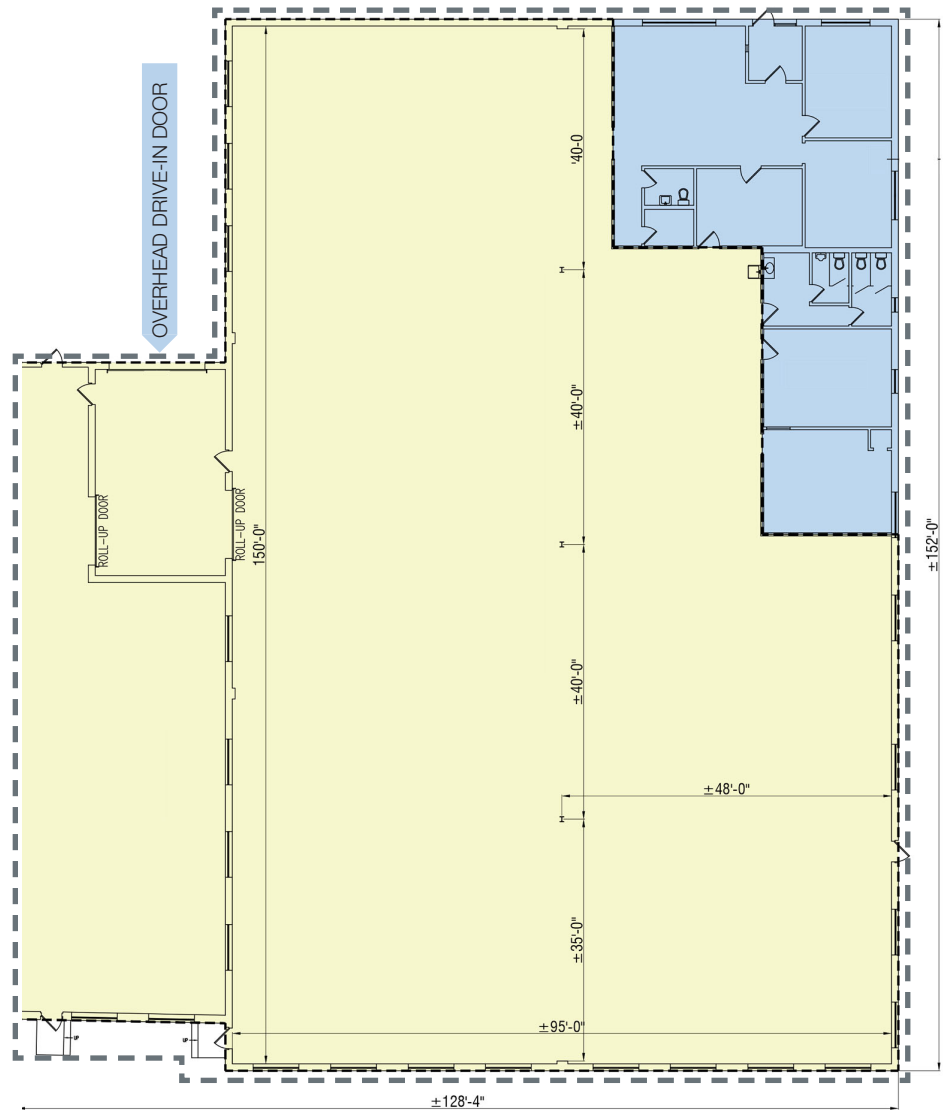



# REGIONAL MAP

# Zuckerberg's Industrial Park

## At the Crossroads of Bergen County

Access building via N. Midland Ave  
Click [HERE](#) for directions



GW Bridge  
10.5 miles



Lincoln Tunnel  
14.7 miles



Pulaski Skyway  
18.0 miles



Holland Tunnel  
18.8 miles



Mario Cuomo Bridge  
22.4 miles



Newark Airport  
23.7 miles



Port Newark  
24.5 miles

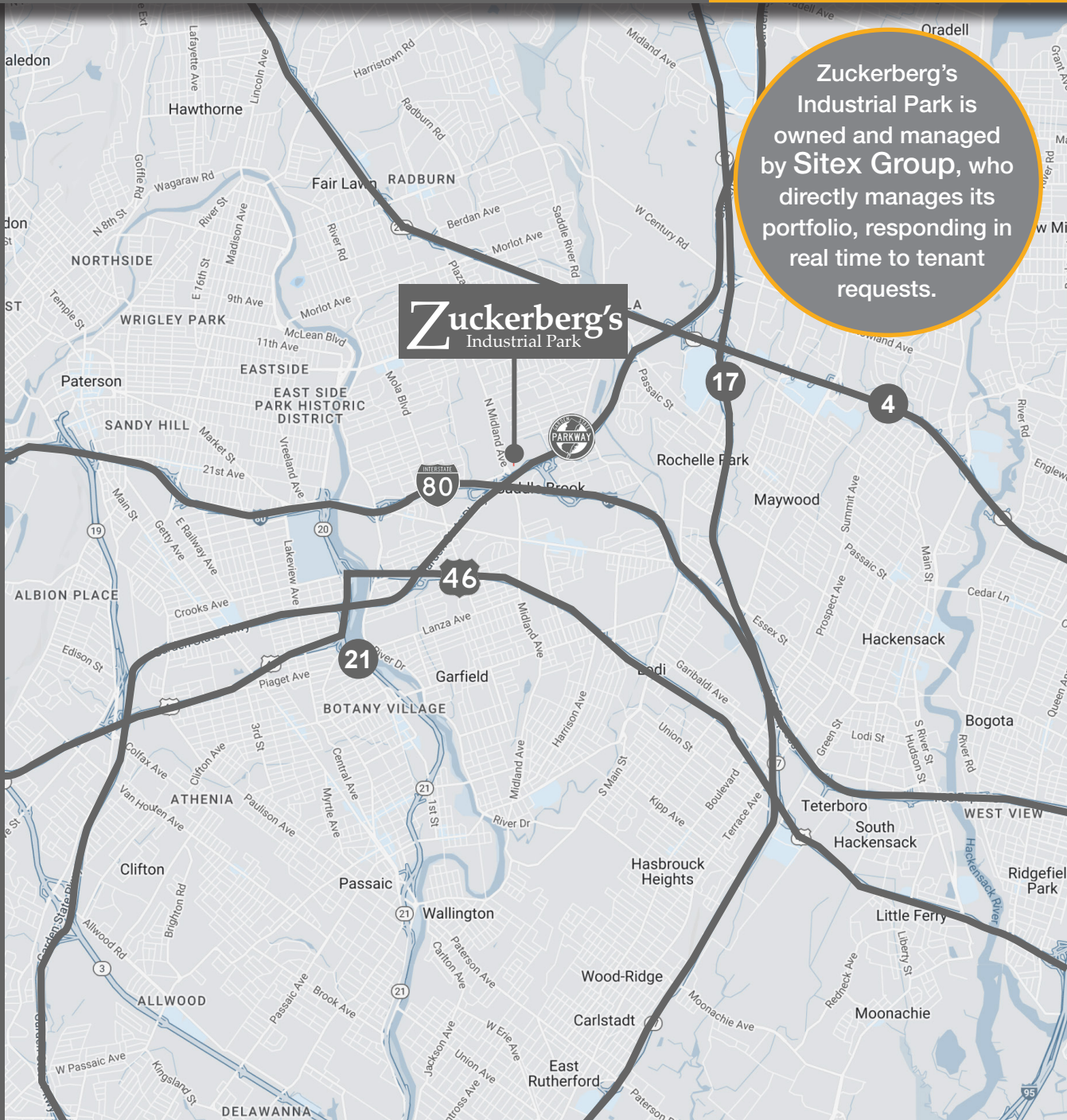

Zuckerberg's Industrial Park is owned and managed by Sitex Group, who directly manages its portfolio, responding in real time to tenant requests.

For leasing information, call 201 488 5800

Ken Lundberg x138 / Pat Lennon x109 / Lorenzo Lambiase x176

**NAI James E. Hanson**  
COMMERCIAL REAL ESTATE SERVICES, WORLDWIDE

FOLLOW US! [f](#) [@](#) [X](#) [in](#) [v](#) | NJ Offices: Teterboro | Parsippany | [naihanson.com](#) | Member of NAI Global with 325+ Offices Worldwide

The information contained herein has been obtained from sources considered to be reliable, but no guarantee of its accuracy is made by NAI James E. Hanson