

SR 52 PASCO JUNCTION

NEW RETAIL DEVELOPMENT FOR LEASE

NEC SR 52 & CORPORATE LAKE BLVD
SAN ANTONIO, FL 33576



equity | brokerage

J. BENJAMIN MCLEISH
VICE PRESIDENT
MOBILE 813.334.4733
DIRECT 813.490.9817
BMCLEISH@EQUITY.NET

The information contained herein has been obtained from the property owner or other sources that we deem reliable. Although we have no reason to doubt its accuracy, no representation or warranty is made regarding the information, and the property is offered "as is". The submission may be modified or withdrawn at any time by the property owner.

PROPERTY HIGHLIGHTS

- PROPOSED GROCERY ANCHORED CENTER
- SUITES FROM 1,400± SF
- 3 OUT PARCELS
- LOCATED IN PASCO'S CONNECTED CITY CORRIDOR
- NEW LIGHTED INTERSECTION TO INCLUDE OTHER BIG BOX RETAILERS
- 8,000 NEW HOMES PLANNED/UNDER CONSTRUCTION WITHIN THE TRADE AREA

SR 52 PASCO JUNCTION

NEW DEVELOPMENT FOR LEASE
NEC SR 52 & CORPORATE LAKE BLVD
SAN ANTONIO, FL 33576

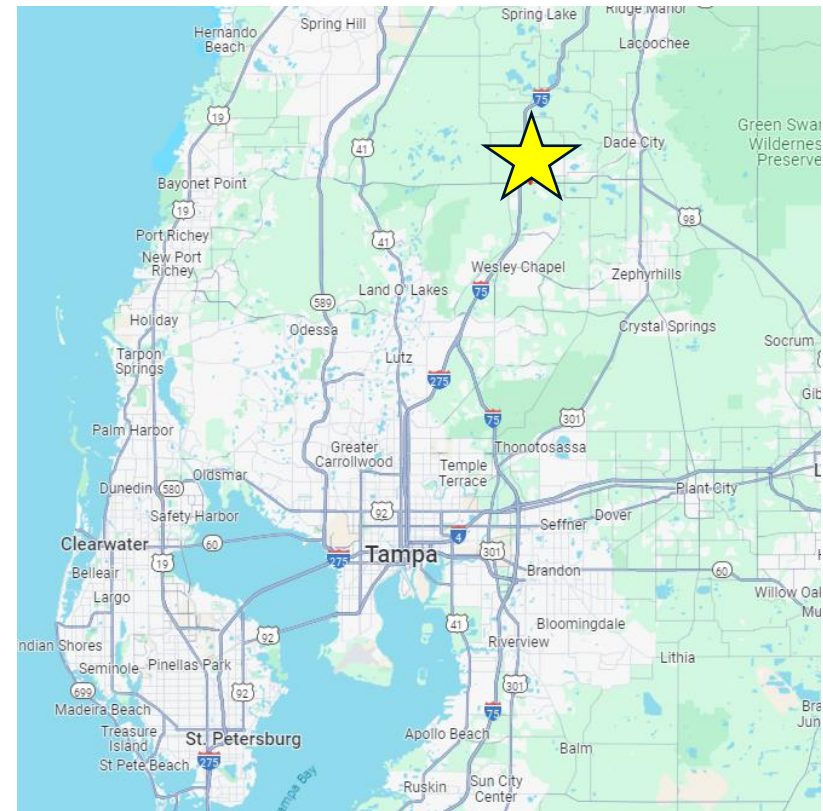

SITE PLAN

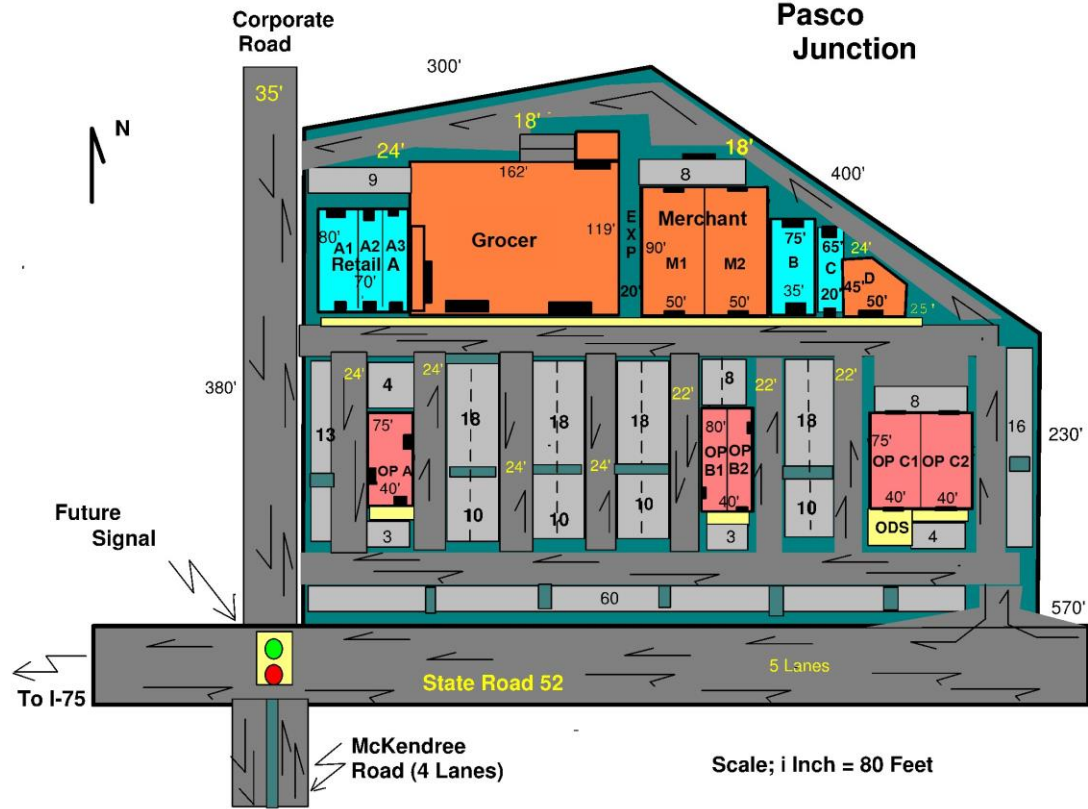
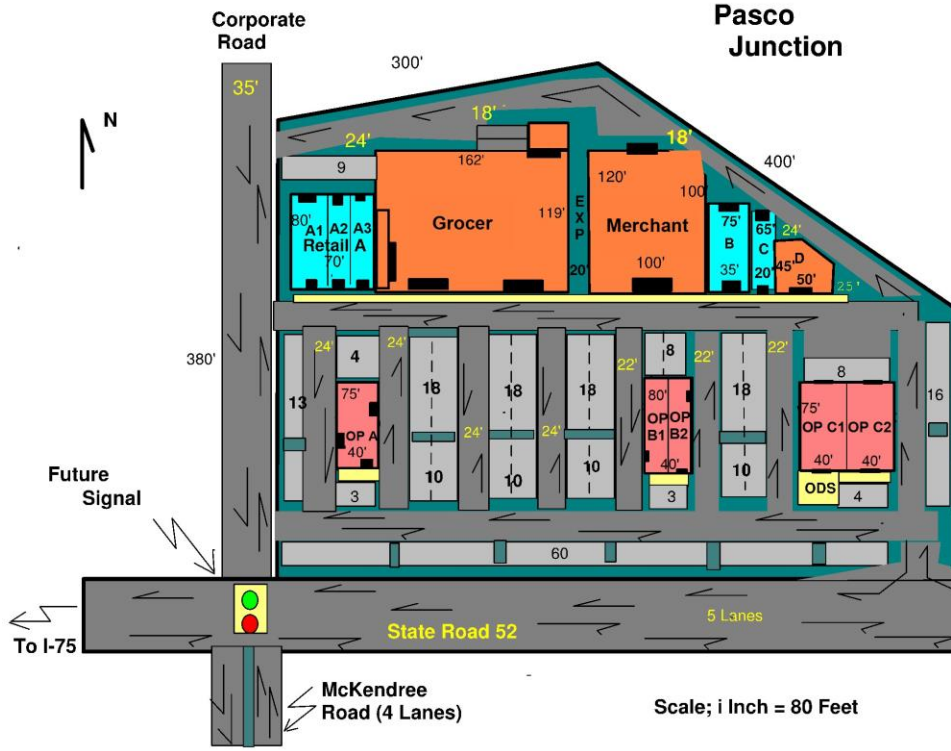

5-MILE RADIUS DEMOS

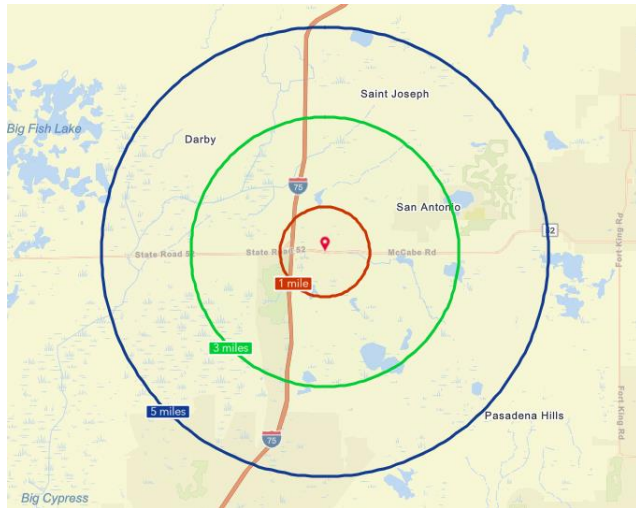

31,496
Population



Average
Household Size



Median Age

\$106,021
Median Household Income

KEY FACTS

BUSINESS



Total Businesses



Total Employees

EDUCATION



4.3%

No High School
Diploma



24.5%

High School
Graduate



27.5%

Some
College



43.6%

Bachelor's/Grad/Prof
Degree

J. BENJAMIN MCLEISH
VICE PRESIDENT
MOBILE 813.334.4733
DIRECT 813.490.9817
BMCLEISH@EQUITY.NET

INCOME



\$46,172

Per Capita
Income



\$106,021

Median
Household
Income



\$590,997

Median Net
Worth

EMPLOYMENT



71.1%

White
Collar



14.8%

Blue
Collar



14.1%

Services

equity | brokerage

The information contained herein has been obtained from the property owner or other sources that we deem reliable. Although we have no reason to doubt its accuracy, no representation or warranty is made regarding the information, and the property is offered "as is." The submission may be modified or withdrawn at any time by the property owner.